

Drawer

Artesia, NM 88210

SUBMIT IN TR. DATE\*

JUN 15 1982

Form approved,  
Budget Bureau No. 42-R1425.UNITED STATES  
DEPARTMENT OF THE INTERIOR

O. C. D.

GEOLOGICAL SURVEY

ARTESIA, OFFICE

## APPLICATION FOR PERMIT TO DRILL, DEEPEN, OR PLUG BACK

## 1a. TYPE OF WORK

DRILL ☒DEEPEN ☐PLUG BACK ☐

## b. TYPE OF WELL

OIL  
WELL ☐GAS  
WELL ☒

OTHER

SINGLE  
ZONE ☐MULTIPLE  
ZONE ☐

## 2. NAME OF OPERATOR

Yates Petroleum Corporation

## 3. ADDRESS OF OPERATOR

207 S. 4th, Artesia, New Mexico 88210

## 4. LOCATION OF WELL (Report location clearly and in accordance with any State requirements.)

At surface

660' FNL and 660' FEL

At proposed prod. zone

same

## 14. DISTANCE IN MILES AND DIRECTION FROM NEAREST TOWN OR POST OFFICE\*

3 miles NE of Roswell, NM

## 15. DISTANCE FROM PROPOSED\*

LOCATION TO NEAREST

PROPERTY OR LEASE LINE, FT.

(Also to nearest drlg. unit line, if any)

660'

## 18. DISTANCE FROM PROPOSED LOCATION\*

TO NEAREST WELL, DRILLING, COMPLETED,  
OR APPLIED FOR, ON THIS LEASE, FT.

## 19. PROPOSED DEPTH

4150'

## 21. ELEVATIONS (Show whether DF, RT, GR, etc.)

3542.5' GL

17. NO. OF ACRES ASSIGNED  
TO THIS WELL

160

## 20. ROTARY OR CABLE TOOLS

Rotary

## 22. APPROX. DATE WORK WILL START\*

ASAP

## 23. PROPOSED CASING AND CEMENTING PROGRAM

SIZE OF HOLE	SIZE OF CASING	WEIGHT PER FOOT	SETTING DEPTH	QUANTITY OF CEMENT
14 3/4"	10 3/4"	40.5# J-55	800'	circulated (appr. 675sx)
7 7/8"	4 1/2"	9.5#	TD	350 sx

We propose to drill and test the Abo and intermediate formations. Approximately 800' of surface casing will be set and cement circulated to shut off gravel and caving. If needed (lost circulation) 8 5/8" intermediate casing will be run to 1500' and cemented with enough cement calculated to tie back into the surface casing. If commercial, production casing will be run and cemented with adequate cover, perforated and stimulated as needed for production.

MUD PROGRAM: FW gel and LCM to 800', Brine to 3000', Salt gel/starch to TD.

BOP PROGRAM: BOP's will be installed at the offset and tested daily.

GAS NOT DEDICATED.

NOTE: LEASE EXPIRES 7-1-82

IN ABOVE SPACE DESCRIBE PROPOSED PROGRAM: If proposal is to deepen or plug back, give data on present productive zone and proposed new productive zone. If proposal is to drill or deepen directionally, give pertinent data on subsurface locations and measured and true vertical depths. Give blowout preventer program, if any.

24.

SIGNED

TITLE Regulatory Manager

DATE 5/20/82

(This space for Federal or State office use)

PERMIT NO.

GEORGE H. STEWART

APPROVAL DATE

APPROVED BY OR

TITLE

DATE

CONDITIONS OF APPROVAL, IF ANY:

JAMES A. GILLHAM  
DISTRICT SUPERVISOR

NEW MEXICO OIL CONSERVATION COMMISSION  
WELL LOCATION AND ACREAGE DEDICATION PLAT

Form C-102  
Supersedes C-128  
Effective 1-1-65

All distances must be from the outer boundaries of the Section

Operator <b>YATES PETROLEUM CORPORATION</b>			Lease <b>Adell "UJ" Federal</b>			Well No. <b>1</b>
Unit Letter <b>D</b>	Section <b>7</b>	Township <b>10 South</b>	Range <b>25 East</b>	County <b>Chaves</b>		
Actual Footage Location of Well: <b>660</b> feet from the <b>North</b> line and <b>660</b> feet from the <b>East</b> line						
Ground Level Elev. <b>3542.5'</b>	Producing Formation <b>Abo</b>		Pool <b>Wildcat</b>		Dedicated Acreage: <b>160</b> Acres	

- Outline the acreage dedicated to the subject well by colored pencil or hatchure marks on the plat below.
- If more than one lease is dedicated to the well, outline each and identify the ownership thereof (both as to working interest and royalty).
- If more than one lease of different ownership is dedicated to the well, have the interests of all owners been consolidated by communitization, unitization, force-pooling, etc?

☒ Yes ☐ No If answer is "yes," type of consolidation \_\_\_\_\_

If answer is "no," list the owners and tract descriptions which have actually been consolidated. (Use reverse side of this form if necessary.) \_\_\_\_\_

No allowable will be assigned to the well until all interests have been consolidated (by communitization, unitization, forced-pooling, or otherwise) or until a non-standard unit, eliminating such interests, has been approved by the Commission.

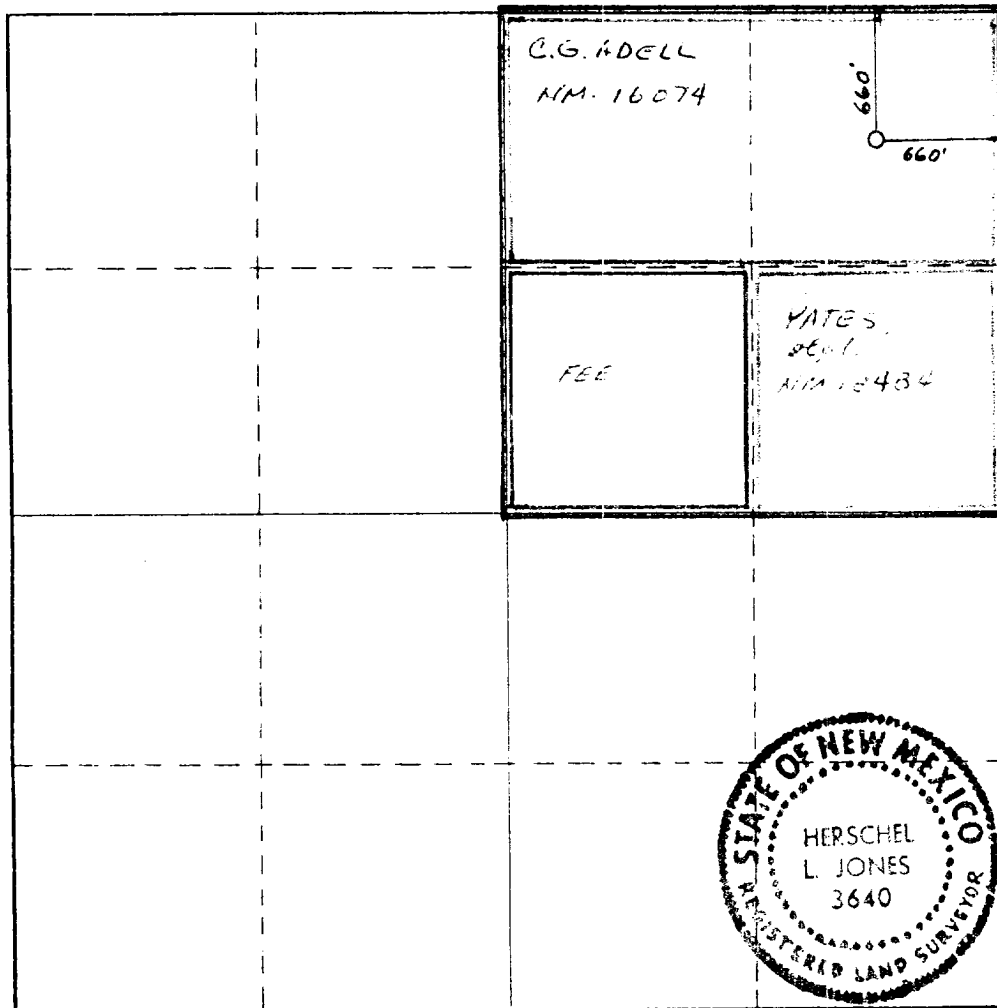

CERTIFICATION

I hereby certify that the information contained herein is true and complete to the best of my knowledge and belief.

Name  
**Gliserio Rodriguez**  
Position  
**Regulatory Manager**  
Company  
**Yates Petroleum Corp.**  
Date  
**5/20/82**

I hereby certify that the well location shown on this plat was plotted from field notes of actual surveys made by me or under my supervision, and that the same is true and correct to the best of my knowledge and belief.

Date Surveyed  
**May 18, 1982**  
Registered Professional Engineer and/or Land Surveyor  
**Herschel L. Jones**  
Certificate No.  
**3640**

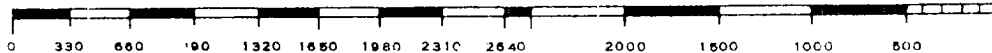

UNITED STATES PETROLEUM CORPORATION  
Well "UJ" Federal #1  
660' FNL and 660' FEL  
Sec. 7-T10S-R25E

In conjunction with Form 9-331C, Application for Permit to Drill subject well, United States Petroleum Corporation submits the following ten items of pertinent information in accordance with USGS requirements.

1. The geologic surface formation is alluvium gravel w/caliche deposits.
2. The estimated tops of geologic markers are as follows:

<u>San Andres</u>	<u>490'</u>
<u>Glorieta</u>	<u>1368'</u>
<u>Fullerton</u>	<u>2778'</u>
<u>Abo</u>	<u>3513'</u>
<u>TD</u>	<u>4150'</u>

3. The estimated depths at which anticipated water, oil or gas formations are expected to be encountered:

Water: 175'

Oil or Gas: 3525'

4. Proposed Casing Program: See Form 9-331C.
5. Pressure Control Equipment: See Form 9-331C and Exhibit B.
6. Mud Program: See Form 9-331C.
7. Auxiliary Equipment: Kelly Cock; pit level indicators and flow sensor equipment; sub with full-opening valve on floor, drill pipe connection.
8. Testing, Logging and Coring Program:

Samples: 10' out from under surface

DST's: none

Coring: none

Logging: CNL-FDC TD to csg w/GR-CNL to surface & DLL from TD to casing

9. No abnormal pressures or temperatures are anticipated.
10. Anticipated starting date: As soon as possible after approval.

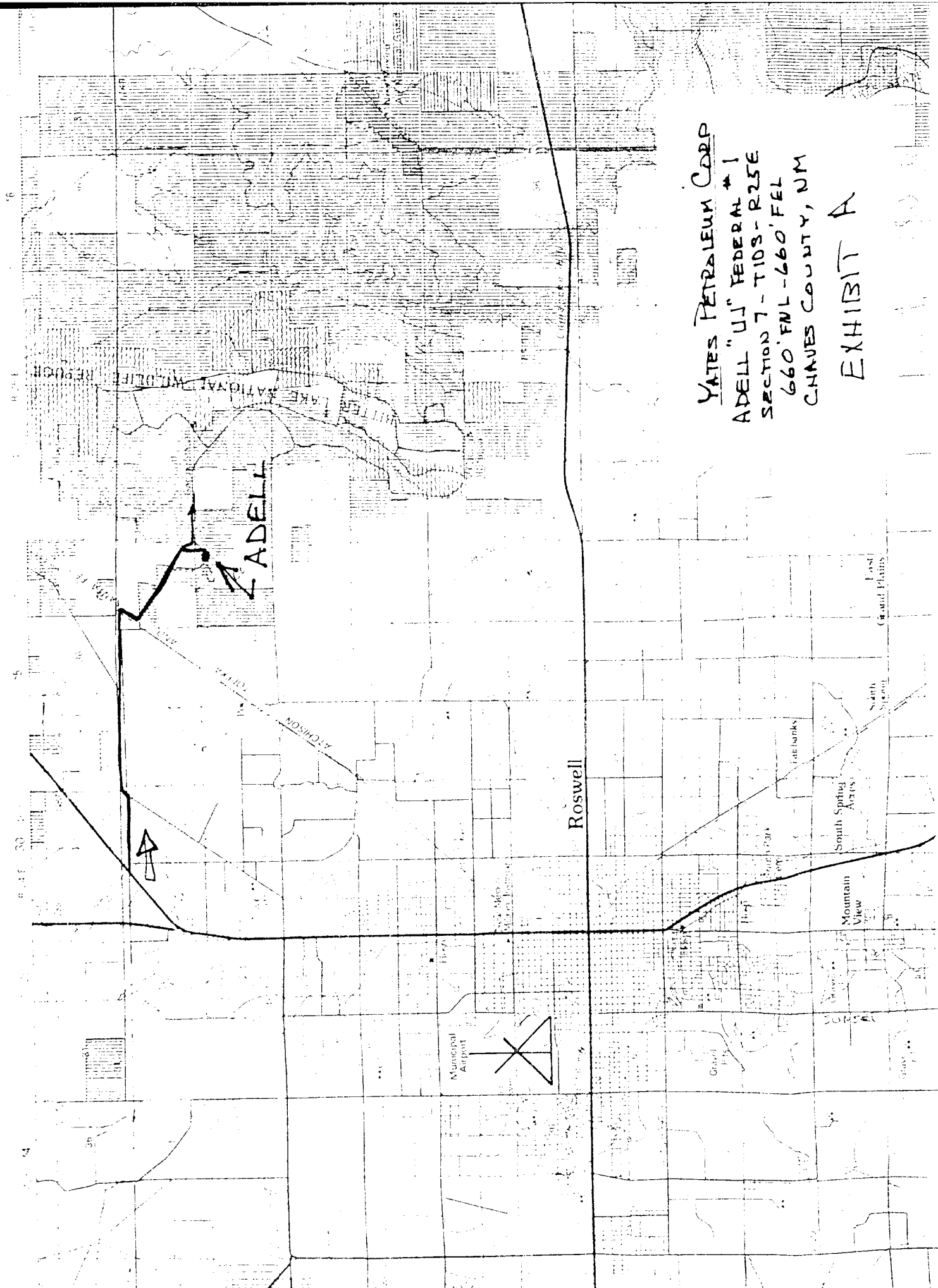

YATES PETROLEUM CORP  
ADELL "UJ" FEDERAL #1  
SECTION 7-T103-R25E  
660' FNL-660' FEL  
CHAVES COUNTY, NM

EXHIBIT A

## EXHIBIT B

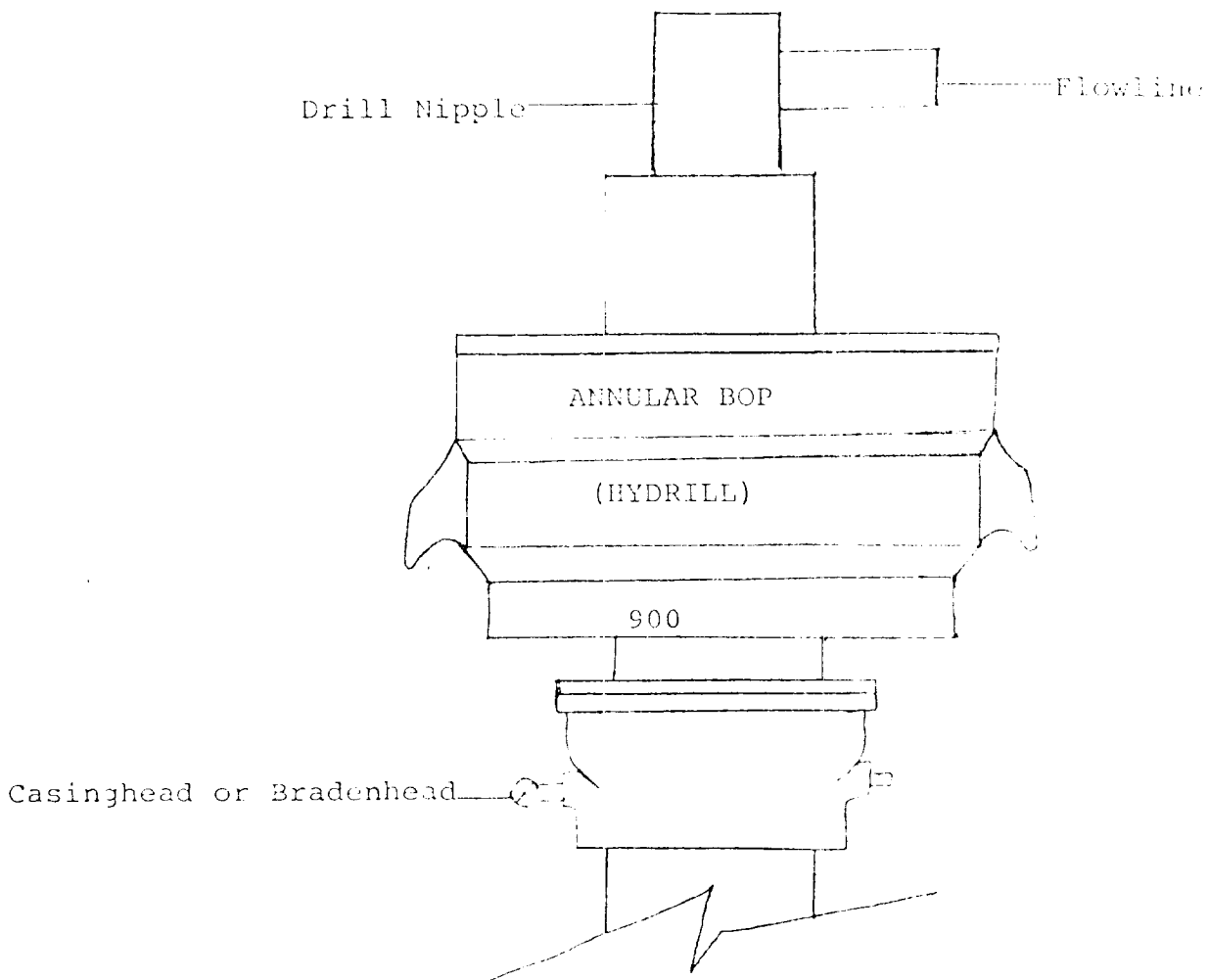

### THE FOLLOWING CONSTITUTE MINIMUM BLOWOUT PREVENTER REQUIREMENTS

1. All preventers to be hydraulically operated with secondary manual controls installed prior to drilling out from under casing.
2. All connections from operating manifolds to preventers to be all steel. Hole or tube a minimum of one inch in diameter.
3. The available closing pressure shall be at least 15% in excess of that required with sufficient volume to operate the BOP's.
4. All connections to and from preventer to have a pressure rating equivalent to that of the BOP's.
5. Hole must be kept filled on trips below intermediate casing. Operator ~~not~~ responsible for blowouts resulting from not keeping hole full.

# EXHIBIT C.

## YATES PETROLEUM CORPORATION

