

NO. OF COPIES RECEIVED	6
DISTRIBUTION	
SANTA FE	1
FILE	1
U.S.G.S.	5
LAND OFFICE	1
OPERATOR	1

RECEIVED
NEW MEXICO OIL CONSERVATION COMMISSION

JUN 21 1982

O. C. D.
ARTESIA, OFFICE

Amended
Location

30-005-61654
Form C-101
Revised 1-1-65

5A. Indicate Type of Lease STATE <input checked="" type="checkbox"/> FEE <input type="checkbox"/>
5. State Oil & Gas Lease No. LG-6679

APPLICATION FOR PERMIT TO DRILL, DEEPEN, OR PLUG BACK			
1a. Type of Work b. Type of Well DRILL <input checked="" type="checkbox"/> DEEPEN <input type="checkbox"/> PLUG BACK <input type="checkbox"/> OIL WELL <input type="checkbox"/> GAS WELL <input checked="" type="checkbox"/> OTHER <input type="checkbox"/> SINGLE ZONE <input checked="" type="checkbox"/> MULTIPLE ZONE <input type="checkbox"/>		7. Unit Agreement Name	
2. Name of Operator MESA PETROLEUM CO. ✓		8. Farm or Lease Name IRIS STATE	
3. Address of Operator 1000 VAUGHN BUILDING/MIDLAND, TEXAS 79703-4493		9. Well No. 1	
4. Location of Well UNIT LETTER E LOCATED 1980 FEET FROM THE NORTH LINE AND 660 FEET FROM THE WEST LINE OF SEC. 21 TWP. 7S RGE. 23E NMPM		10. Field and Pool, or Wildcat UNDESIGNATED ABO	
		12. County CHAVES	
		19. Proposed Depth 3400'	
		19A. Formation ABO	
		20. Rotary or C.T. ROTARY	
21. Elevations (Show whether DF, RT, etc.) 3946' GR		21A. Kind & Status Plug. Bond BLANKET	
		21B. Drilling Contractor DUAL DRILLING	
		22. Approx. Date Work will start JUNE 29, 1982	

23. PROPOSED CASING AND CEMENT PROGRAM					
SIZE OF HOLE	SIZE OF CASING	WEIGHT PER FOOT	SETTING DEPTH	SACKS OF CEMENT	EST. TOP
12 1/4"	8 5/8"	24#	1400'	700/300	SURFACE
7 7/8"	4 1/2"	10.5#	3400'	500	ISOLATE WTR. O&C

Propose to drill 12 1/4" hole to approximately 1400' more or less and set 8 5/8" surface casing and cement to surface. Will reduce hole to 7 7/8", nipple up RAM type BOP's and drill to total depth. Drilling medium will be air, foam, or mud as required.

Operator's Gas Sales Are Dedicated.

APPROVAL VALID FOR 120 DAYS
PERMIT EXPIRES 12-22-82
UNLESS DRILLING UNDERWAY

XC: NMOCD (6), TLS, CEN RCDS, ACCTG, MEC, LAND, ROSWELL, REM, FILE (PARTNERS)

IN ABOVE SPACE DESCRIBE PROPOSED PROGRAM: IF PROPOSAL IS TO DEEPEN OR PLUG BACK, GIVE DATA ON PRESENT PRODUCTIVE ZONE AND PROPOSED NEW PRODUCTIVE ZONE. GIVE BLOWOUT PREVENTER PROGRAM, IF ANY.

I hereby certify that the information above is true and complete to the best of my knowledge and belief.

Signed R. E. Mark Title REGULATORY COORDINATOR Date 6-18-82

(This space for State Use)

APPROVED BY Miles Williams TITLE OIL AND GAS INSPECTOR DATE JUN 22 1982
CONDITIONS OF APPROVAL, IF ANY:

Posted ID-T
Amended for
6-25-82

Operator: Mesa Petroleum Co. Lease: Iris State Well No.: #1

Unit Letter: E Section: 21 Township: 7 South Range: 23 East County: Chaves

Actual Footage Location of Well: 660 feet from the West line and 1980 feet from the North line

Ground Level Elev.: 3946 Producing Formation: ABO Pool: UNDESIGNATED Dedicated Acreage: NW/4 160 Acres

1. Outline the acreage dedicated to the subject well by colored pencil or hatchure marks on the plat below.
2. If more than one lease is dedicated to the well, outline each and identify the ownership thereof (both as to working interest and royalty).
3. If more than one lease of different ownership is dedicated to the well, have the interests of all owners been consolidated by communitization, unitization, force-pooling, etc?

☐ Yes ☐ No If answer is "yes," type of consolidation _____

If answer is "no," list the owners and tract descriptions which have actually been consolidated. (Use reverse side of this form if necessary.) _____

No allowable will be assigned to the well until all interests have been consolidated (by communitization, unitization, forced-pooling, or otherwise) or until a non-standard unit, eliminating such interests, has been approved by the Division.

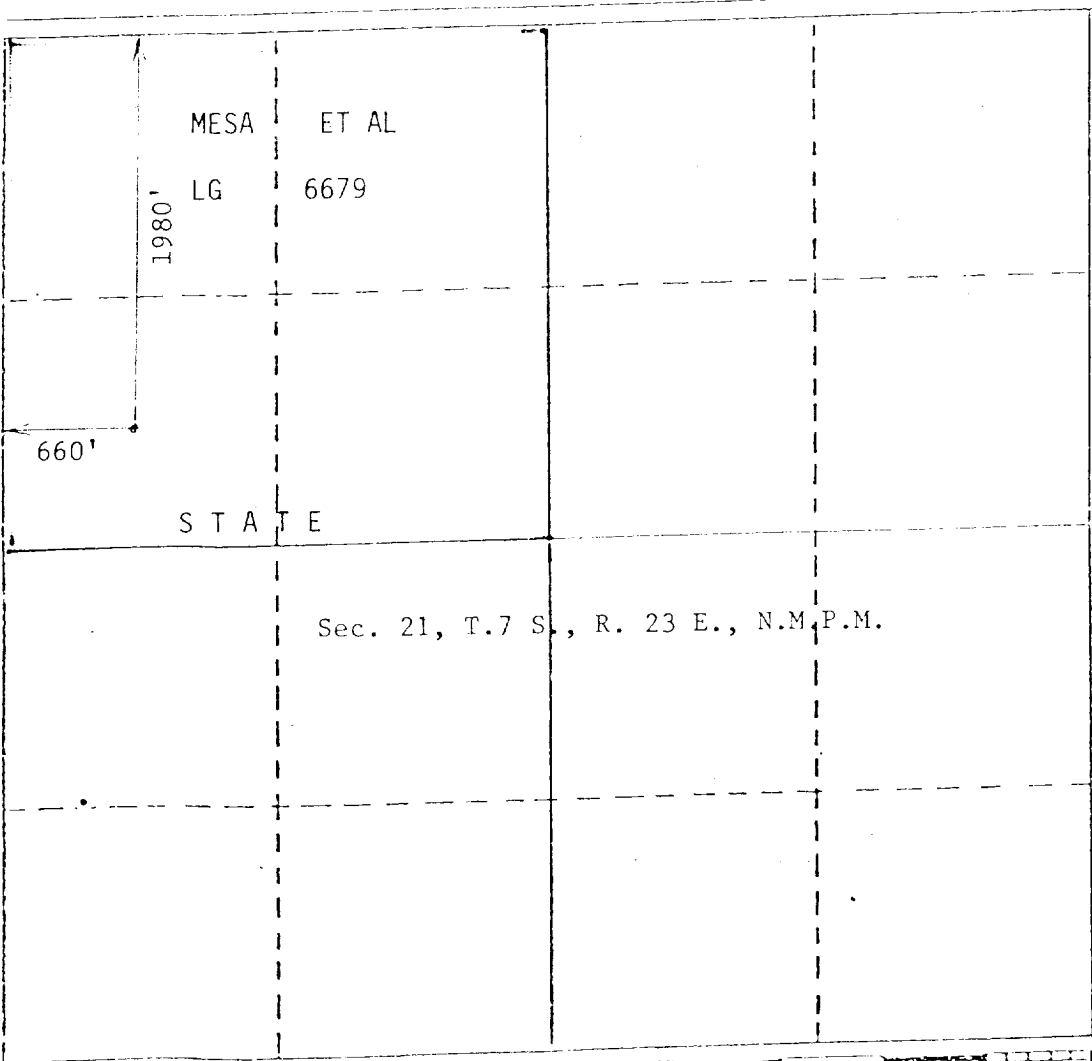

CERTIFICATION

I hereby certify that the information contained herein is true and complete to the best of my knowledge and belief.

R. E. Mathis

Name: R. E. MATHIS

Position: REGULATORY COORDINATOR

Company: MESA PETROLEUM CO.

Date: JUNE 18, 1982

I hereby certify that the well location shown on this plat was plotted from field notes of actual surveys made by me or under my supervision, and that the same is true and correct to the best of my knowledge and belief.

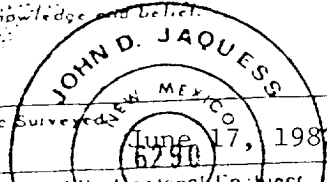

John D. Jaquess, P.E. & L.S.

Certificate No.: 6290

