

UNITED STATES
DEPARTMENT OF THE INTERIOR

GEOLOGICAL SURVEY

AMENDED

APPLICATION FOR PERMIT TO DRILL, DEEPEN, OR PLUG BACK

1a. TYPE OF WORK

DRILL ☒DEEPEN ☐PLUG BACK ☐

b. TYPE OF WELL

OIL
WELL ☐GAS
WELL ☒

OTHER

APR 19 1983

MULTIPLE
ZONE ☐

2. NAME OF OPERATOR

Mesa Petroleum Co.

O. C. D.

3. ADDRESS OF OPERATOR

P.O. Box 2009 / Amarillo, Texas 79189

ARTESIA OFFICE

4. LOCATION OF WELL (Report location clearly and in accordance with any State requirements.)*

At surface

1444' FSL & 1950' FWL SW 1/4 SW 1/4 K

At proposed prod. zone
same

14. DISTANCE IN MILES AND DIRECTION FROM NEAREST TOWN OR POST OFFICE*

26 miles Northwest of Roswell, New Mexico

OIL & GAS
U.S. GEOLOGICAL SURVEY
ROSWELL, NEW MEXICO

15. DISTANCE FROM PROPOSED*

LOCATION TO NEAREST

PROPERTY OR LEASE LINE, FT.

(Also to nearest drlg. unit line, if any)

1444' / 1445'

16. NO. OF ACRES IN LEASE

2459.68

17. NO. OF ACRES ASSIGNED

TO THIS WELL

160

18. DISTANCE FROM PROPOSED LOCATION*

TO NEAREST WELL, DRILLING, COMPLETED,
OR APPLIED FOR, ON THIS LEASE, FT.

3000'

19. PROPOSED DEPTH

3200'

20. ROTARY OR CABLE TOOLS

Rotary

21. ELEVATIONS (Show whether DF, RT, GR, etc.)

3958' GA

22. APPROX. DATE WORK WILL START*

April 20, 1983

23.

PROPOSED CASING AND CEMENTING PROGRAM

SIZE OF HOLE	SIZE OF CASING	WEIGHT PER FOOT	SETTING DEPTH	QUANTITY OF CEMENT
12"	8 5/8"	24#	1200'	700/300 surface
7 7/8"	4 1/2"	10.5#	3200'	300 cover all pay

Propose to drill 12 1/4" hole to approximately 1200' to set 8 5/8" surface casing and cement to surface. Will nipple up ram type BOP's and reduce hole to 7 7/8" to drill to total depth. Drilling medium will be freshwater mud as required. After log evaluation, 4 1/2" casing may be run and cemented with sufficient kinds and amounts to isolate and seal off any fresh water, oil or gas zones encountered.

Operator's Gas Sales are dedicated.

NOTE: original location was 990' FSL & 990' FWL - moved to present location due to Geology.

XC: BLM(O+6), CEN RCDS, ACCTG, MAT CONT, OPS(FILE), MIDLAND, ROSWELL, PARTNERS

IN ABOVE SPACE DESCRIBE PROPOSED PROGRAM: If proposal is to deepen or plug back, give data on present productive zone and proposed new productive zone. If proposal is to drill or deepen directionally, give pertinent data on subsurface locations and measured and true vertical depths. Give blowout preventer program, if any.

24.

SIGNED

R. F. Mathis

TITLE

REGULATORY COORDINATOR

DATE

APRIL 13, 1983

(This space for Federal or State office use)

PERMIT NO.

APPROVAL DATE

APPROVED BY

James A. Gillham

TITLE

ACTING DISTRICT MANAGER

DATE

4-14-83

CONDITIONS OF APPROVAL, IF ANY:

*See Instructions On Reverse Side

NSL - 1688 appx 4-21-83

All distances must be from the outer boundaries of the Section.

Operator Mesa Petroleum Co.,			Lease China Federal		Well No. 15
Well Letter K	Section 19	Township 7 South	Range 23 East	County Chaves	
Actual Postage Location of Well: 1444			South		1950 West
feet from the		line and	feet from the		line
Ground Level Elev. 3958	Producing Formation ABO	Pool West Pecos Slope ABO	Dedicated Acreage: SW $\frac{1}{4}$ 160 Acres		

1. Outline the acreage dedicated to the subject well by colored pencil or hatchure marks on the plat below.
2. If more than one lease is dedicated to the well, outline each and identify the ownership thereof (both as to working interest and royalty).
3. If more than one lease of different ownership is dedicated to the well, have the interests of all owners been consolidated by communitization, unitization, force-pooling, etc?

☐ Yes ☐ No If answer is "yes," type of consolidation _____

If answer is "no," list the owners and tract descriptions which have actually been consolidated. (Use reverse side of this form if necessary.) _____

No allowable will be assigned to the well until all interests have been consolidated (by communitization, unitization, forced-pooling, or otherwise) or until a non-standard unit, eliminating such interests, has been approved by the Division.

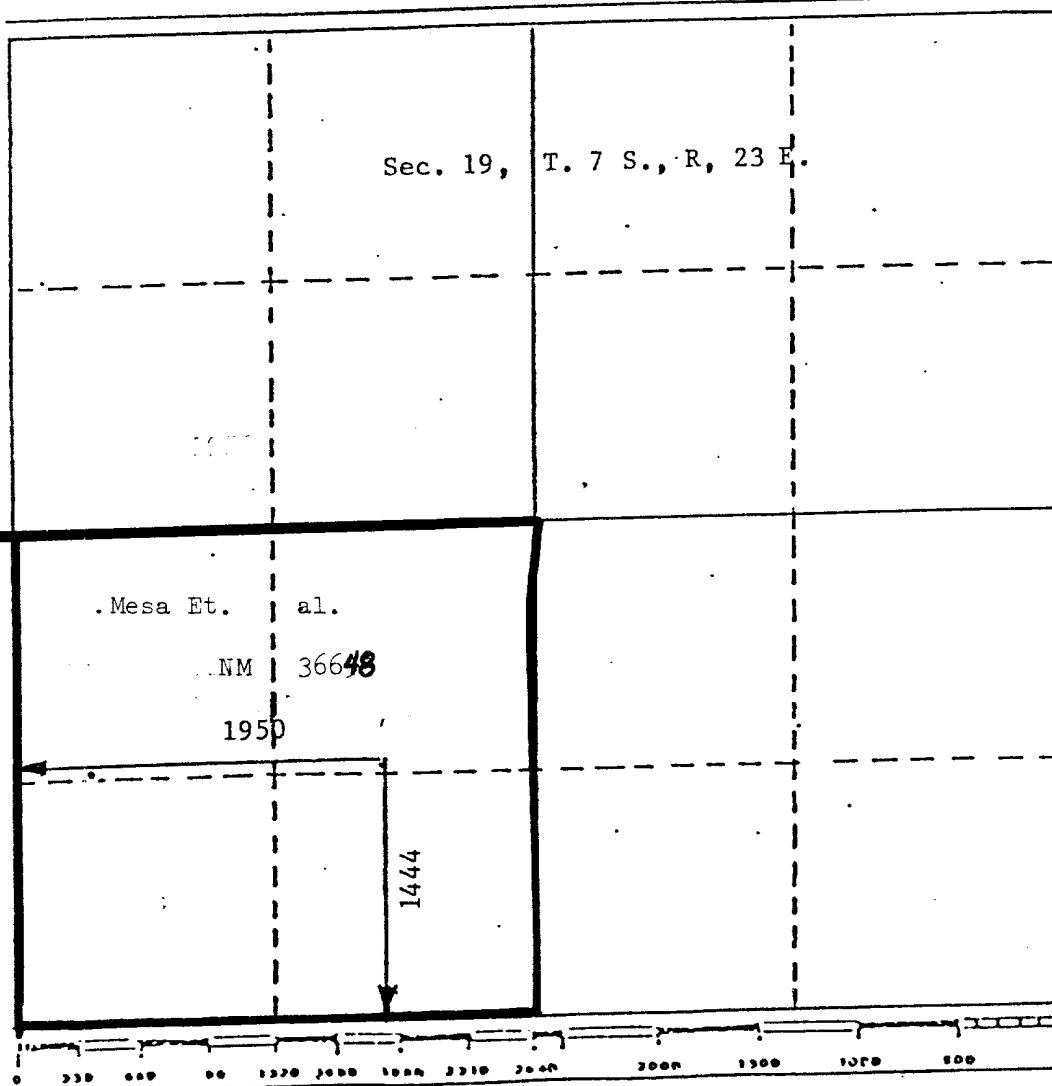

CERTIFICATION

I hereby certify that the information contained herein is true and complete to the best of my knowledge and belief.

Lloyd Reed
Name

Lloyd Reed

Position

Regulatory Agent

Company

Mesa Petroleum Company

Date

April 14, 1983

I hereby certify that the well location shown on this plat was plotted from field notes of actual surveys made by me or under my supervision, and that the same is true and correct to the best of my knowledge and belief.

JOHN D. JAQUES
NEW MEXICO
4-13-83
Registered Professional Engineer
and Surveyor
John D. Jaques, P.E. & L.S.
Certificate No. 6290

APPLICATION FOR PERMIT TO DRILL (AMENDED)

MESA PETROLEUM CO.
CHINA FEDERAL #15
1444' FSL & 1950' FWL, SEC 19, T7S, R23E
CHAVES COUNTY, NEW MEXICO

LEASE NO. NM-36648

In conjunction with Form 9331-C, Application For Permit to Drill subject well, the following additional information is provided:

1. Applicable portions of the GENERAL REQUIREMENTS FOR OIL AND GAS OPERATIONS ON FEDERAL LEASES, Roswell District, Geological Survey of September 1, 1980 will be adhered to.

2. Geological markers are estimated as follows:

San Andres	Surface
Glorieta	481
Tubb	2031
ABO	2772

3. Hydrocarbon bearing strata may occur in the Abo formation(s). No fresh water is expected to be encountered below 1000'.

4. The Casing and Blowout Preventer Program will be determined by hole conditions as encountered. See Exhibit VI. Anticipate drilling with freshwater/mud using ram type preventer and rotating head for well control. The 8 5/8" casing will be set at approximately 1200' to protect any fresh water zones and cemented to the surface. The 4 1/2" production casing will be set at total depth or shallower depending upon the depth of the deepest commercial hydrocarbon bearing strata encountered. Sufficient amounts and kinds of cement would be used to ensure any water, gas, or oil zones encountered are isolated and shut off down to the casing point if run.

5. No drill stem test or coring program is planned. The logging program may consist of a GR-CNL from surface total depth and FDC from casing point to total depth.

6. Anticipated drilling time is ten days with completion operations to follow as soon as a completion unit is available.

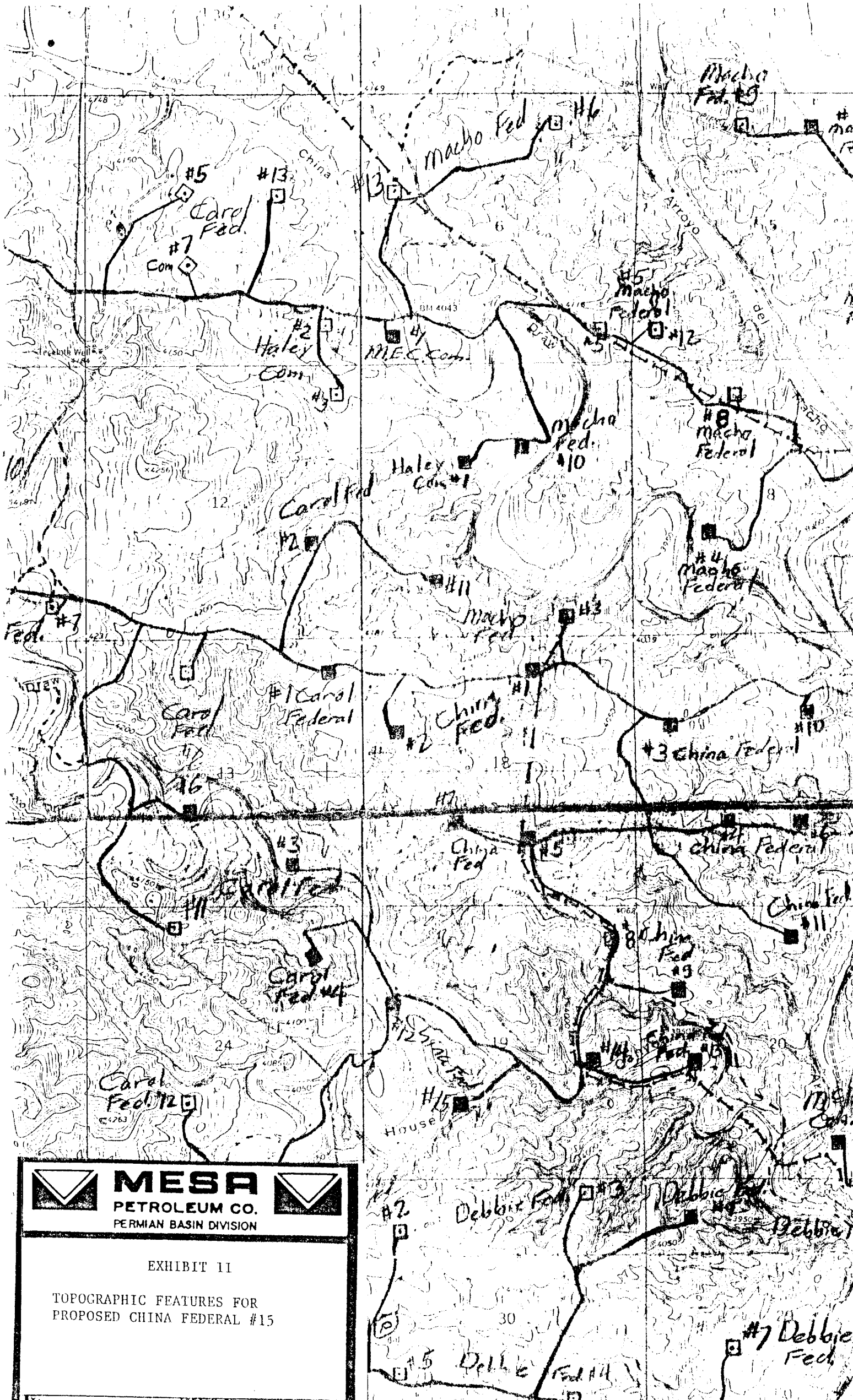

MESA
PETROLEUM CO.
PERMIAN BASIN DIVISION



EXHIBIT 11

TOPOGRAPHIC FEATURES FOR
PROPOSED CHINA FEDERAL #15

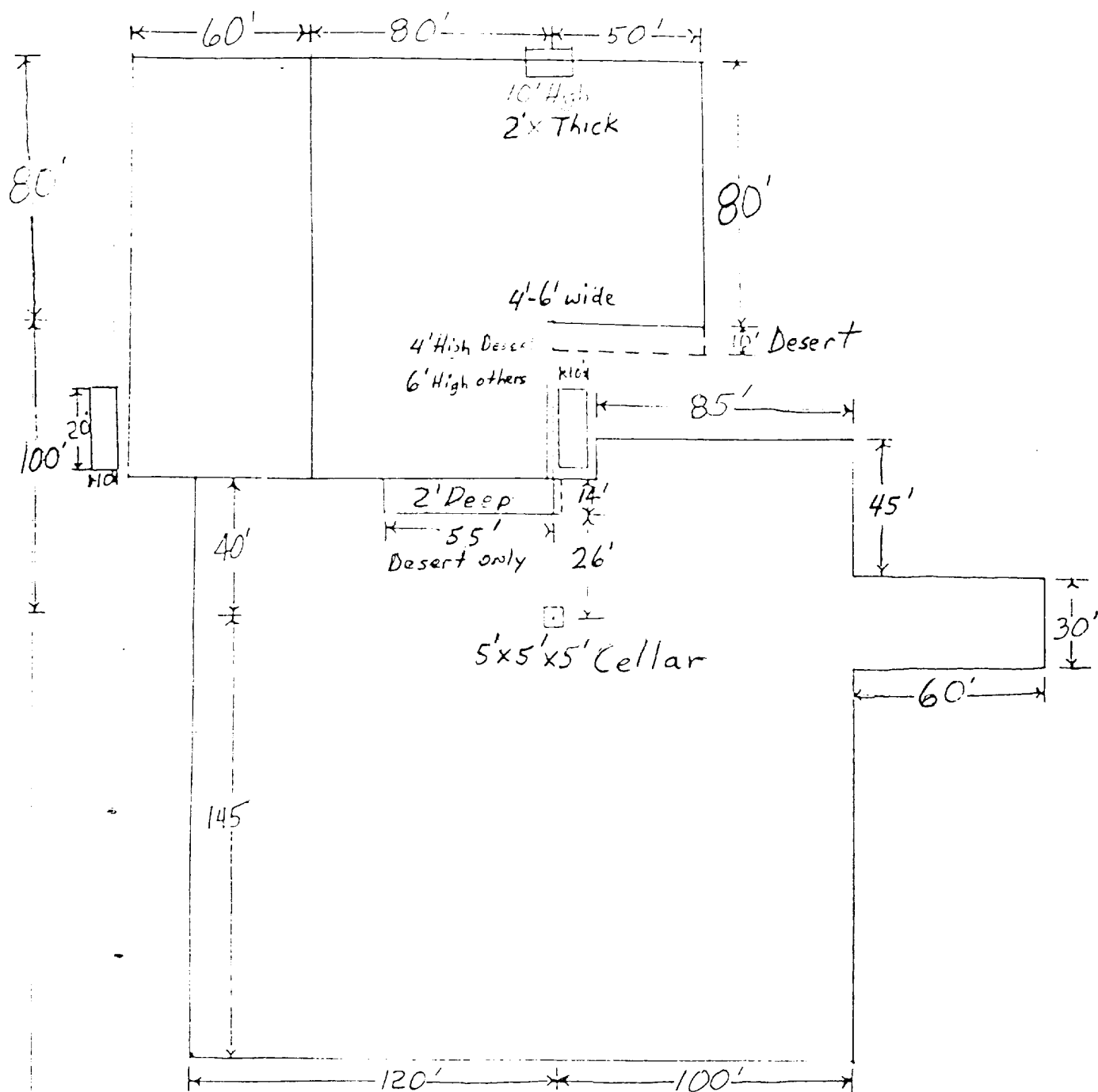

6"-8" Watered & Compacted Caliche
ON PAD & ROAD IF NEEDED



MESA
PETROLEUM CO.
PERMIAN BASIN DIVISION



EXHIBIT V

FOR PROPOSED CHINA FEDERAL #15