

30-005-61691

Form C-101
Revised 1-1-65

NEW MEXICO OIL CONSERVATION COMMISSION

JUL 6 1982

O. C. D.
ARTESIA, OFFICE

NO. OF COPIES RECEIVED	5
DISTRIBUTION	
SANTA FE	1
FILE	1
U.S.G.S.	21
LAND OFFICE	
OPERATOR	1

5A. Indicate Type of Lease
STATE <input type="checkbox"/> FEE <input checked="" type="checkbox"/>
5. State Oil & Gas Lease No.

APPLICATION FOR PERMIT TO DRILL, DEEPEN, OR PLUG BACK

1a. Type of Work		7. Unit Agreement Name	
b. Type of Well DRILL <input checked="" type="checkbox"/> DEEPEN <input type="checkbox"/> PLUG BACK <input type="checkbox"/> OIL WELL <input type="checkbox"/> GAS WELL <input checked="" type="checkbox"/> OTHER <input type="checkbox"/> SINGLE ZONE <input checked="" type="checkbox"/> MULTIPLE ZONE <input type="checkbox"/>		8. Farm or Lease Name HALEY COM	
2. Name of Operator MESA PETROLEUM CO. ✓		9. Well No. 1	
3. Address of Operator 1000 VAUGHN BUILDING/MIDLAND, TEXAS 79703-4493		10. Field and Pool, or Wildcat X UNDESIGNATED ABO	
4. Location of Well UNIT LETTER F LOCATED 1980 FEET FROM THE NORTH LINE AND 1980 FEET FROM THE WEST LINE OF SEC. 7 TWP. 7S RGE. 23E NMPM		12. County CHAVES	
19. Proposed Depth 3100'		19A. Formation ABO	20. Rotary or C.T. ROTARY
21. Elevations (Show whether DF, RT, etc.) 4022'	21A. Kind & Status Plug. Bond BLANKET	21B. Drilling Contractor DUAL DRILLING	22. Approx. Date Work will start JULY 22, 1982

PROPOSED CASING AND CEMENT PROGRAM

SIZE OF HOLE	SIZE OF CASING	WEIGHT PER FOOT	SETTING DEPTH	SACKS OF CEMENT	EST. TOP
12 1/4"	8 5/8"	24#	1400'	700/300	SURFACE
7 7/8"	4 1/2"	10.5#	3100'	300	COVER ABO

Propose to drill 12 1/4" hole to approximately 1400' to set 8 5/8" surface casing and cement to surface. Will nipple up ram type BOP's and reduce hole to 7 7/8" to drill to total depth. Drilling medium will be air, foam, or mud as required. After log evaluation, 4 1/2" casing may be run and cemented with sufficient kinds and amounts to isolate and seal off any fresh water, oil or gas zones encountered.

Operator's Gas Sales are dedicated.

APPROVAL VALID FOR 180 DAYS
PERMIT EXPIRES 1-9-83
UNLESS DRILLING UNDERWAY
fasted ID-I
API & NL Book
7-9-82

XC: NMOCD (6), TLS, CEN RCDS, ACCTG, MEC, LAND, ROSWELL, REM, FILE (PARTNERS

IN ABOVE SPACE DESCRIBE PROPOSED PROGRAM: IF PROPOSAL IS TO DEEPEN OR PLUG BACK, GIVE DATA ON PRESENT PRODUCTIVE ZONE AND PROPOSED NEW PRODUCTIVE ZONE. GIVE BLOWOUT PREVENTER PROGRAM, IF ANY.

I hereby certify that the information above is true and complete to the best of my knowledge and belief.

Signed Michael P. Winston Title OPERATIONS MANAGER Date 7-2-82

(This space for State Use)

APPROVED BY W.A. Gressett TITLE SUPERVISOR, DISTRICT II DATE JUL 9 1982

CONDITIONS OF APPROVAL, IF ANY:

Notify N.M.O.C.C. in sufficient time to witness cementing

8 5/8"

All distances must be from the outer boundaries of the Section.

Operator Mesa Petroleum Co.		Lease Haley Com.		Well No. 1	
Initial Letter F	Section 7	Township 7 S.	Range 23 E.	County Chaves	
Actual Footage Location of Well:					
1980 feet from the North		1980 feet from the West		Dedicated Acreage:	
Ground Level Elev. 4022	Producing Formation ABO	Pool UNDESIGNATED		NW/4	160 Acres

1. Outline the acreage dedicated to the subject well by colored pencil or hatchure marks on the plat below.
2. If more than one lease is dedicated to the well, outline each and identify the ownership thereof (both as to working interest and royalty).
3. If more than one lease of different ownership is dedicated to the well, have the interests of all owners been consolidated by communitization, unitization, force-pooling, etc?

☐ Yes ☐ No If answer is "yes," type of consolidation COMMUNITIZATION IN PROGRESS

If answer is "no," list the owners and tract descriptions which have actually been consolidated. (Use reverse side of this form if necessary.)
No allowable will be assigned to the well until all interests have been consolidated (by communitization, unitization, forced-pooling, or otherwise) or until a non-standard unit, eliminating such interests, has been approved by the Division.

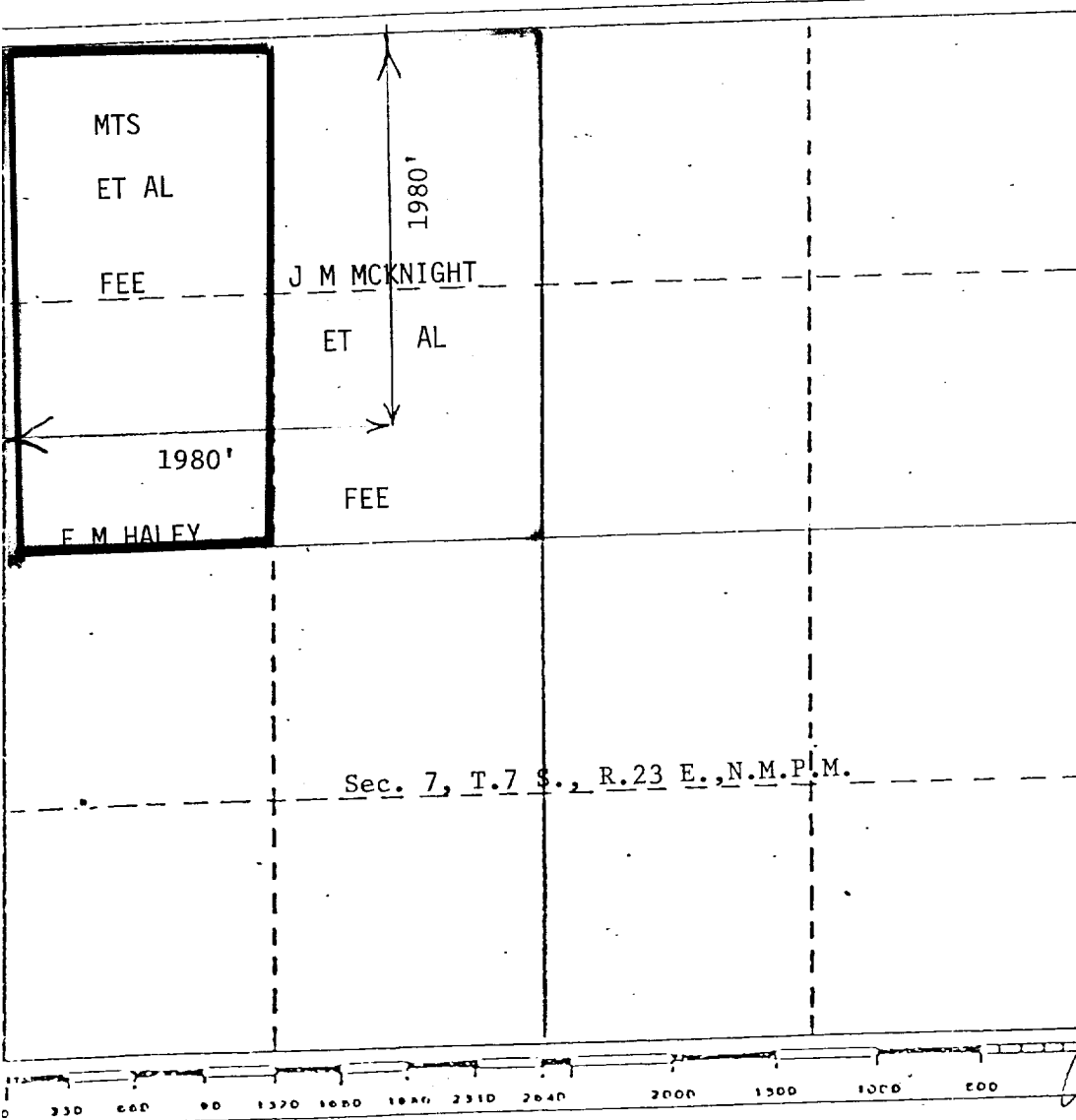

CERTIFICATION

I hereby certify that the information contained herein is true and complete to the best of my knowledge and belief.

Michael P. Houston

Name
MICHAEL P. HOUSTON
Position
OPERATIONS MANAGER
Company
MESA PETROLEUM CO.
Date
JULY 2, 1982

I hereby certify that the well location shown on this plat was plotted from field notes of actual surveys made by me or under my supervision, and that the same is true and correct to the best of my knowledge and belief.

Date Surveyed
6-29-82
Registered Professional Engineer and/or Land Surveyor
John D. Jaques, P.E. & L.S.
Certificate No.
6290