

NO. OF COPIES RECEIVED	7
DISTRIBUTION	
SANTA FE	1
FILE	1
U.S.G.S.	2
LAND OFFICE	1
OPERATOR	2

JUL 12 1982

O. C. D.

APPLICATION FOR PERMIT TO DRILL, DEEPEN, OR PLUG BACK

Type of Work

Type of Well DRILL ☒ DEEPEN ☐ PLUG BACK ☐  
OIL WELL ☒ GAS WELL ☐ OTHER ☐ SINGLE ZONE ☐ MULTIPLE ZONE ☐

Name of Operator

Yates Petroleum Corporation

Address of Operator

207 South 4th St., Artesia, NM

Location of Well

UNIT LETTER E LOCATED 1650 FEET FROM THE North LINE  
330' FEET FROM THE West LINE OF SEC. 32 TWP. 6 RGE. 26 NMPM

5A. Indicate Type of Lease

STATE ☒ FEDERAL ☐

5. State Oil & Gas Lease No.

LC-3591

7. Unit Agreement Name

8. Farm or Lease Name

Tamarack "QF" St

9. Well No.

2

10. Field and Pool, or Wildcat

Linda S.A.

12. County

Chaves

11. Elevations (Show whether DF, RT, etc.)

3660' GL

21A. Kind & Status Plug. Bond

Blanket

19. Proposed Depth

1150

19A. Formation

San Andres

20. Rotary or C.T.

Rotary

21B. Drilling Contractor

Fishing Tool #1

22. Approx. Date Work will start

ASAP

PROPOSED CASING AND CEMENT PROGRAM

SIZE OF HOLE	SIZE OF CASING	WEIGHT PER FOOT	SETTING DEPTH	SACKS OF CEMENT	EST. TOP
9 7/8"	7"	K-55	860	575 SX	circulate
6 1/4"	4 1/4"	9.5# J-55	TD 1150	200 SX	circulate

Plan to drill and test the lower S.A. formation. Will set conductor pipe at surface and 860' of 7" casing. Then will go TD and run 4 1/4" perforate and stimulate as needed for production.

MUD PROGRAM: FW Gel to 806'; Fresh water to TD

BOP PROGRAM: BOP's will be installed on 7" casing and tested

fasted ID-T  
API + NL Book  
7-16-82

APPROVAL VALID FOR 150 DAYS  
PERMIT EXPIRES 1-13-83  
UNLESS DRILLING UNDERWAY

ABOVE SPACE DESCRIBE PROPOSED PROGRAM: IF PROPOSAL IS TO DEEPEN OR PLUG BACK, GIVE DATA ON PRESENT PRODUCTIVE ZONE AND PROPOSED NEW PRODUCTION ZONE. GIVE BLOWOUT PREVENTER PROGRAM, IF ANY.

I hereby certify that the information above is true and complete to the best of my knowledge and belief.

Signed Sharon Roberts Title Regulatory Manager

Date July 9, 1982

(This space for State Use)

PROVED BY Mike Wilbur TITLE OIL AND GAS INSPECTOR

DATE

JUL 13 1982

CONDITIONS OF APPROVAL, IF ANY:

Notify N.M.O.C.C. in sufficient  
time to witness cementing  
the 7" casing

NEW MEXICO OIL CONSERVATION COMM. ON  
WELL LOCATION AND ACREAGE DEDICATION PLAT

Form C-102  
Supersedes C-128  
Effective 1-1-65

All distances must be from the outer boundaries of the Section.

Operator Yates Petroleum Corporation			Lease Tamarack "OF" State		Well No. 2
Unit Letter E	Section 32	Township 6 South	Range 26 East	County Chaves	
Actual Footage Location of Well: 1650 feet from the North line and 330 feet from the West line					
Ground Level Elev. 3660	Producing Formation San Andres		Pool Linda S.A.	Dedicated Acreage: 40 Acres	

1. Outline the acreage dedicated to the subject well by colored pencil or hachure marks on the plat below.
2. If more than one lease is dedicated to the well, outline each and identify the ownership thereof (both as to working interest and royalty).
3. If more than one lease of different ownership is dedicated to the well, have the interests of all owners been consolidated by communitization, unitization, force-pooling, etc?

☐ Yes ☐ No If answer is "yes," type of consolidation \_\_\_\_\_

If answer is "no," list the owners and tract descriptions which have actually been consolidated. (Use reverse side of this form if necessary.) \_\_\_\_\_

No allowable will be assigned to the well until all interests have been consolidated (by communitization, unitization, forced-pooling, or otherwise) or until a non-standard unit, eliminating such interests, has been approved by the Commission.

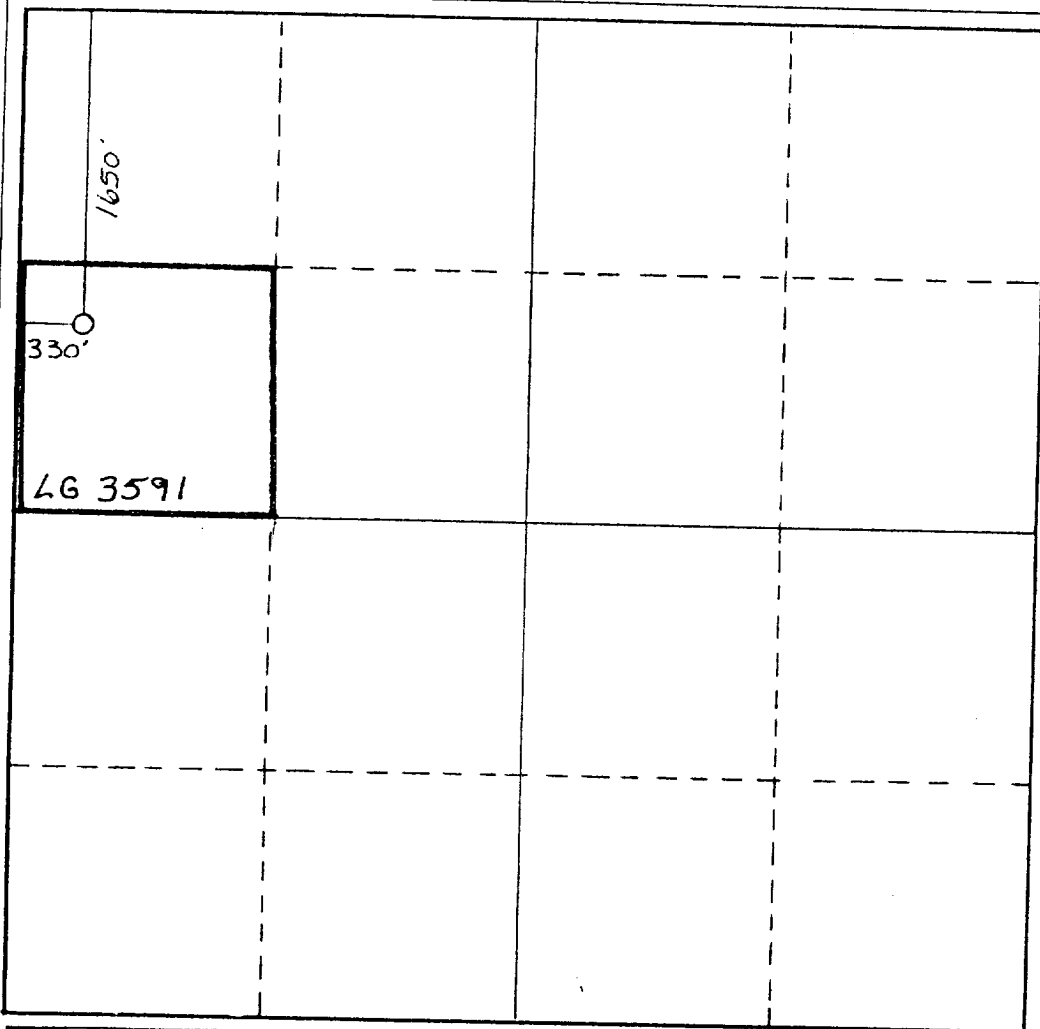

CERTIFICATION

I hereby certify that the information contained herein is true and complete to the best of my knowledge and belief.

Name  
Gliserio Rodriguez  
Position  
Regulatory Manager  
Company  
Yates Petroleum Corp.  
Date  
July 10, 1982

I hereby certify that the well location shown on this plat was plotted from field notes of actual survey made by me or under my supervision and that the same is true and correct to the best of my knowledge and belief.

July 9, 1982  
Date Surveyed  
Registered Professional Engineer and/or Land Surveyor

Certificate No. 7977

# CATHEAD

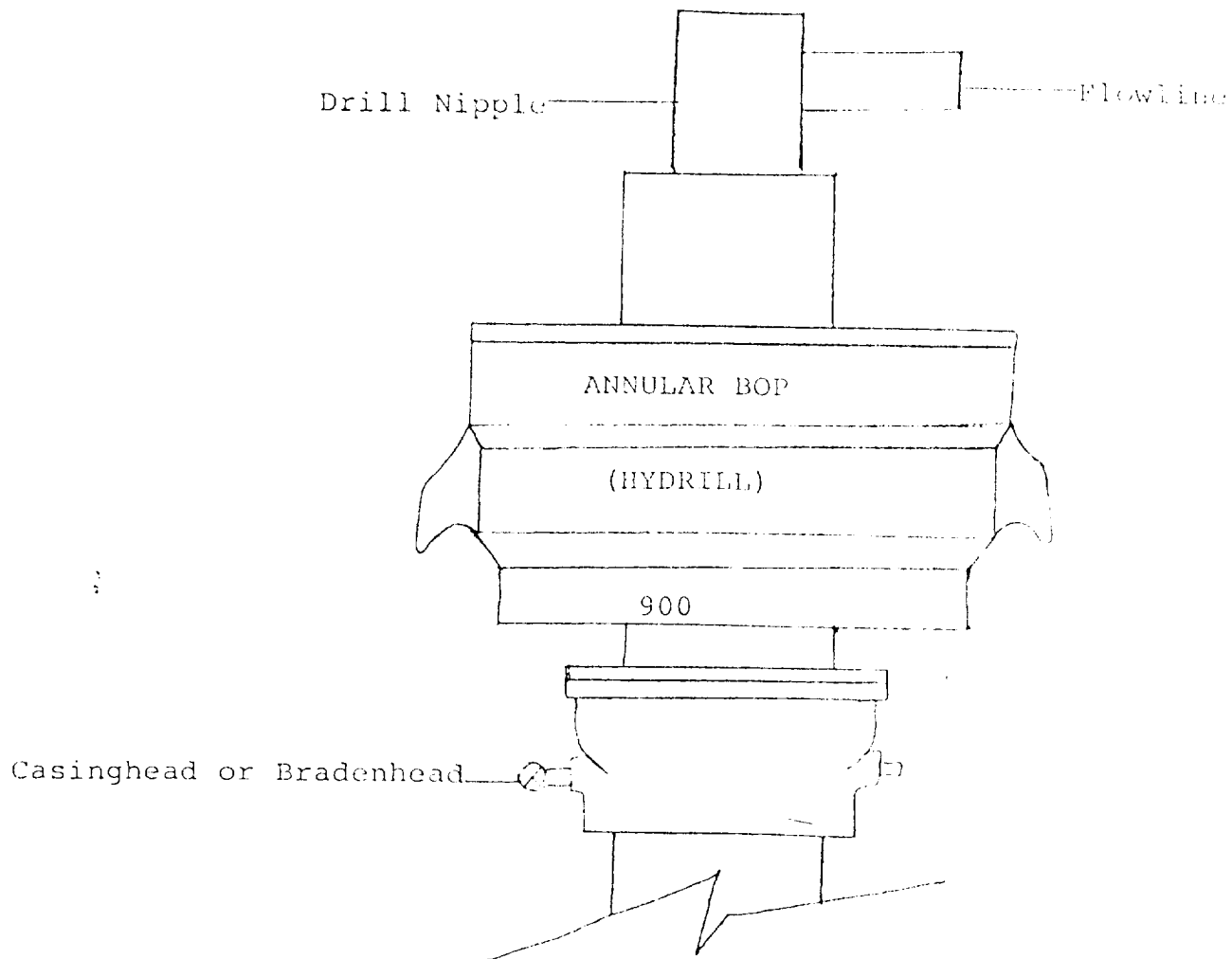

## THE FOLLOWING CONSTITUTE MINIMUM BLOWOUT PREVENTER REQUIREMENTS

1. All preventers to be hydraulically operated with secondary manual controls installed prior to drilling out from under casing.
2. All connections from operating manifolds to preventers to be all steel. Hole or tube a minimum of one inch in diameter.
3. The available closing pressure shall be at least 15% in excess of that required with sufficient volume to operate the BOP's.
4. All connections to and from preventer to have a pressure rating equivalent to that of the BOP's.
5. Hole must be kept filled on trips below intermediate casing.