

NO. OF COPIES RECEIVED	5
DISTRIBUTION	
SANTA FE	1
FILE	1
U.S.G.S.	21
LAND OFFICE	
OPERATOR	1

NEW MEXICO OIL CONSERVATION COMMISSION

RECEIVED

30-005-61716  
Form O-101  
Revised 1-1-81

JUL 16 1982

O. C. D.  
ARTESIA, OFFICE

5A. Indicate Type of Lease
STATE <input type="checkbox"/> FEE <input checked="" type="checkbox"/>

5. State Oil & Gas Lease No.

APPLICATION FOR PERMIT TO DRILL, DEEPEN, OR PLUG BACK

1a. Type of Work		7. Unit Agreement Name	
b. Type of Well OIL WELL <input checked="" type="checkbox"/> GAS WELL <input type="checkbox"/> OTHER <input type="checkbox"/>		8. Farm or Lease Name Stevens Pedco	
2. Name of Operator PETROLEUM DEVELOPMENT CORPORATION		9. Well No. #1	
3. Address of Operator 9720-B Candelaria, N.E., Albuquerque, New Mexico, 87112		10. Field and Pool, or Wildcat Wildcat - 1/24-50	
4. Location of Well UNIT LETTER <u>I</u> LOCATED <u>1,980</u> FEET FROM THE <u>South</u> LINE AND <u>660'</u> FEET FROM THE <u>East</u> LINE OF SEC. <u>28</u> TWP. <u>7S</u> RGE. <u>26E</u> NMPM		12. County Chaves	
19. Proposed Depth 5,400'		19A. Formation Montoya	
21. Elevations (Show whether DF, RT, etc.) 3,735' G.L.		20. Rotary or C.T. Rotary	
21A. Kind & Status Plug. Bond Blanket-Active		22. Approx. Date Work will start August 1, 1982	
21B. Drilling Contractor Salazar Drilling Co.			

PROPOSED CASING AND CEMENT PROGRAM

SIZE OF HOLE	SIZE OF CASING	WEIGHT PER FOOT	SETTING DEPTH	SACKS OF CEMENT	EST. TOP
11"	8-5/8"	23#	1,100'	500	Surface
7-7/8"	4 1/2"	10.5#	5,400'	350	3,000'

1. Drill 11" hole to 1,100'; set 8-5/8" casing; bring cement to surface.
2. Drill 7-7/8" hole to 5,400' to Granite. Run 4 1/2", 10.5# casing if warranted.
3. Utilize a double ram BOP below 1,100'.
4. Drill with water using mud as hole conditions dictate.  
Gas is not dedicated.

Partial ID-1  
API & BK  
7-23-82

APPROVAL VALID FOR 180 DAYS  
PERMIT EXPIRES 1-23-83  
UNLESS DRILLING UNDERWAY

IN ABOVE SPACE DESCRIBE PROPOSED PROGRAM; IF PROPOSAL IS TO DEEPEN OR PLUG BACK, GIVE DATA ON PRESENT PRODUCTIVE ZONE AND PROPOSED NEW PRODUCTIVE ZONE, GIVE BLOWOUT PREVENTER PROGRAM, IF ANY.

I hereby certify that the information above is true and complete to the best of my knowledge and belief.

Signed Jim C. Johnson Title Field Manager Date 7/15/82  
(This space for State Use).

APPROVED BY [Signature] TITLE OIL AND GAS INSPECTOR DATE JUL 23 1982  
CONDITIONS OF APPROVAL, IF ANY:

All distances must be from the outer boundaries of the Section.

RECEIVED

Petroleum Development Corporation			Lease Stevens Pedco		JUL 20 1982		Well No. #1
Section I	Section 28	Township 7 South	Range 26 East	County Chaves			
Tool Footage Location of Well:							
660.0		feet from the east	Line and 1980.0	feet from the south		ARTESIA, OFFICE	
Ground Level Elev. 3735.0	Producing Formation Montoya		Pool Wildcat			Dedicated Acreage: 40 Acres	

1. Outline the acreage dedicated to the subject well by colored pencil or hatchure marks on the plat below.
2. If more than one lease is dedicated to the well, outline each and identify the ownership thereof (both as to working interest and royalty).
3. If more than one lease of different ownership is dedicated to the well, have the interests of all owners been consolidated by communitization, unitization, force-pooling, etc?

☐ Yes ☐ No If answer is "yes," type of consolidation \_\_\_\_\_

If answer is "no," list the owners and tract descriptions which have actually been consolidated. (Use reverse side of this form if necessary.) \_\_\_\_\_

No allowable will be assigned to the well until all interests have been consolidated (by communitization, unitization, forced-pooling, or otherwise) or until a non-standard unit, eliminating such interests, has been approved by the Division.

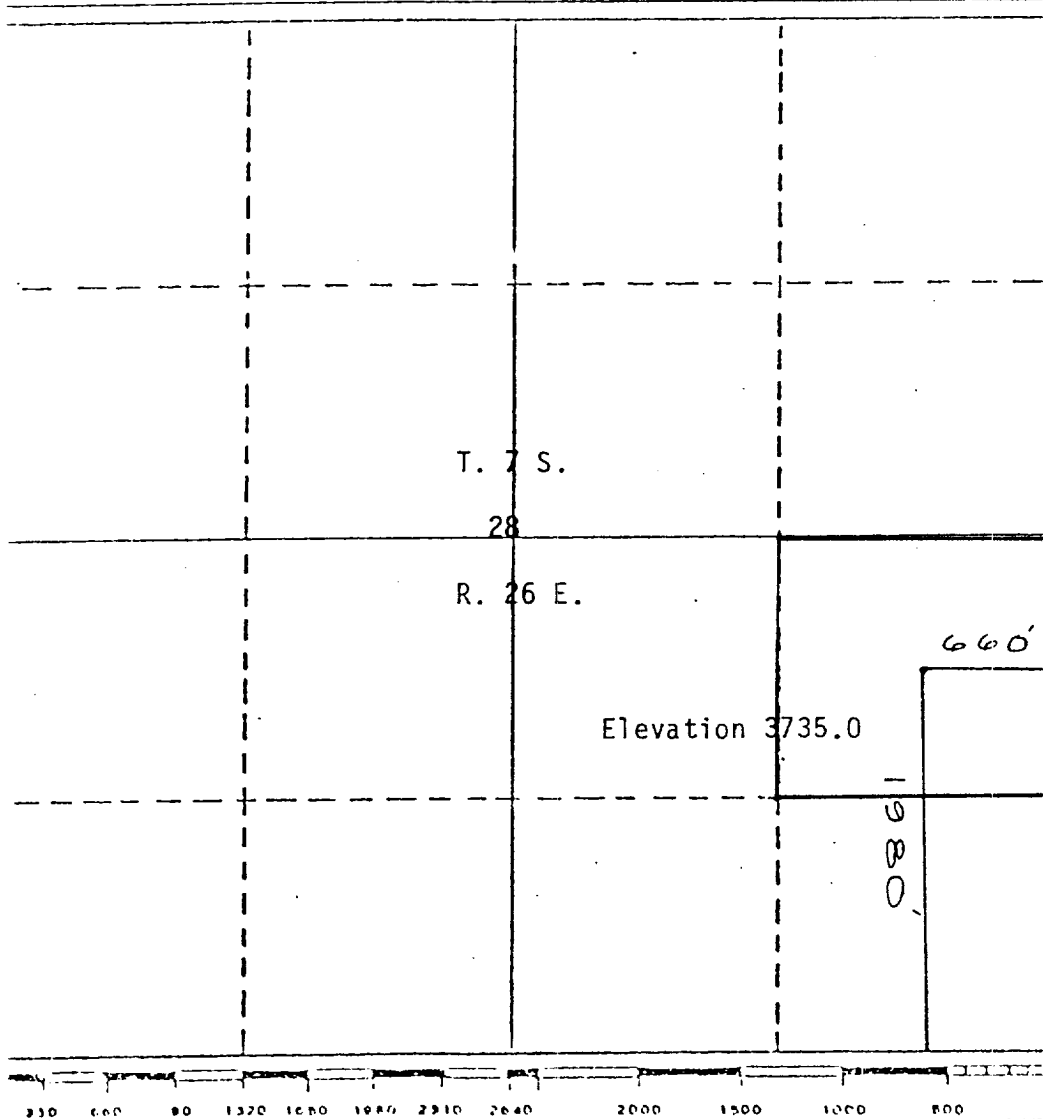

## CERTIFICATION

I hereby certify that the information contained herein is true and complete to the best of my knowledge and belief.

Name

Darryl Samples

Position

Agent

Company

Petroleum Development Corp.

Date

6/30/82

I hereby certify that the well location shown on this plat was plotted from field notes of actual surveys made by me or under my supervision and that the same is true and correct to the best of my knowledge and belief.

Date Surveyed

6/30/82

Registered Professional Engineer  
and/or Land Surveyor

Richard B. Wright

Certificate No.

7929