

UNITED STATES DEPARTMENT OF THE INTERIOR
GEOLOGICAL SURVEY

NM OIL CONS. COMM. DD
Artesia, NM 88210

Budget Bureau No. 42 R-425

30-005-61720

APPLICATION FOR PERMIT TO DRILL, DEEPEN, OR PLUG BACK

1a. TYPE OF WORK

DRILL ☒

DEEPEN ☐

PLUG BACK ☐

b. TYPE OF WELL

OIL WELL ☐

GAS WELL ☒

OTHER ☐

SINGLE ZONE ☒

RECEIVED

MULTIPLE ZONE ☐

2. NAME OF OPERATOR

MESA PETROLEUM CO.

JUL 26 1982

3. ADDRESS OF OPERATOR

1000 VAUGHN BUILDING/MIDLAND, TEXAS 79701-0900

4. LOCATION OF WELL (Report location clearly and in accordance with any State requirements.)
At surface 660' FNL & 990' FEL NE 1/4 NE 1/4 A

At proposed prod. zone

SAME

14. DISTANCE IN MILES AND DIRECTION FROM NEAREST TOWN OR POST OFFICE*

32 miles Northwest of Roswell, New Mexico

15. DISTANCE FROM PROPOSED*

LOCATION TO NEAREST

PROPERTY OR LEASE LINE, FT.

(Also to nearest dirg. unit line, if any)

660' / 660'

16. NO. OF ACRES IN LEASE

1941.5

17. NO. OF ACRES ASSIGNED TO THIS WELL

160

18. DISTANCE FROM PROPOSED LOCATION*

TO NEAREST WELL, DRILLING, COMPLETED,

OR APPLIED FOR, ON THIS LEASE, FT.

3300'

19. PROPOSED DEPTH

3200'

20. ROTARY OR CABLE TOOLS

ROTARY

21. ELEVATIONS (Show whether DF, RT, GR, etc.)

3946' GR

22. APPROX. DATE WORK WILL START*

JULY 21, 1982

23. PROPOSED CASING AND CEMENTING PROGRAM

SIZE OF HOLE	SIZE OF CASING	WEIGHT PER FOOT	SETTING DEPTH	QUANTITY OF CEMENT
12 1/4"	8 5/8"	40.5#	950'	700/300 SURFACE
7 7/8"	4 1/2"	10.5#	3200'	300 COVER ABO

Propose to drill 12 1/4" hole to approximately 1400' to set 8 5/8" surface casing and cement to surface. Will nipple up ram type BOP's and reduce hole to 7 7/8" to drill to total depth. Drilling medium will be air, foam, or mud as required. After log evaluation, 4 1/2" casing may be run and cemented with sufficient kinds and amounts to isolate and seal off any fresh water, oil or gas zones encountered.

Operator's Gas Sales are dedicated.

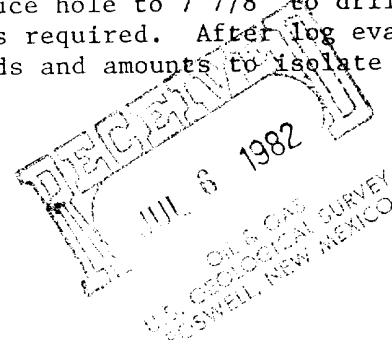

XC: MMS (7), TLS, CEN RCDS, ACCTG, MEC, LAND, ROSWELL, REM. FILE. (PARTNERS
IN ABOVE SPACE DESCRIBE PROPOSED PROGRAM: If proposal is to deepen or plug back, give data on present productive zone and proposed new productive zone. If proposal is to drill or deepen directionally, give pertinent data on subsurface locations and measured and true vertical depths. Give blowout preventer program, if any.

24. SIGNED R. E. MONTES / [Signature] TITLE REGULATORY COORDINATOR DATE 6-30-82

(This space for Federal or State office use)

PERMIT (Orig. Sgd.) GEORGE H. STEWART

APPROVAL DATE

APPROVED BY

TITLE

DATE

CONDITIONS OF APPROVAL, IF ANY:

Postul ID-1
APZ + BK
7-30-82

All distances must be from the outer boundaries of the Section.

RECEIVED

Operator Mesa Petroleum Co.			Lease Debbie Federal		Well No. 6
Unit Letter A	Section 29	Township 7 S.	Range 23 E.	County Chaves	
Actual Footage Location of Well: 660 feet from the North line and 990 feet from the East line					
Ground Level Elev. 3946	Producing Formation ABO		Pool UNDESIGNATED		Dedicated Acreage: NE/4 160 Acres

1. Outline the acreage dedicated to the subject well by colored pencil or hatchure marks on the plat below.
2. If more than one lease is dedicated to the well, outline each and identify the ownership thereof (both as to working interest and royalty).
3. If more than one lease of different ownership is dedicated to the well, have the interests of all owners been consolidated by communitization, unitization, force-pooling, etc?

☐ Yes ☐ No If answer is "yes," type of consolidation _____

If answer is "no," list the owners and tract descriptions which have actually been consolidated. (Use reverse side of this form if necessary.) _____

No allowable will be assigned to the well until all interests have been consolidated (by communitization, unitization, forced-pooling, or otherwise) or until a non-standard unit, eliminating such interests, has been approved by the Division.

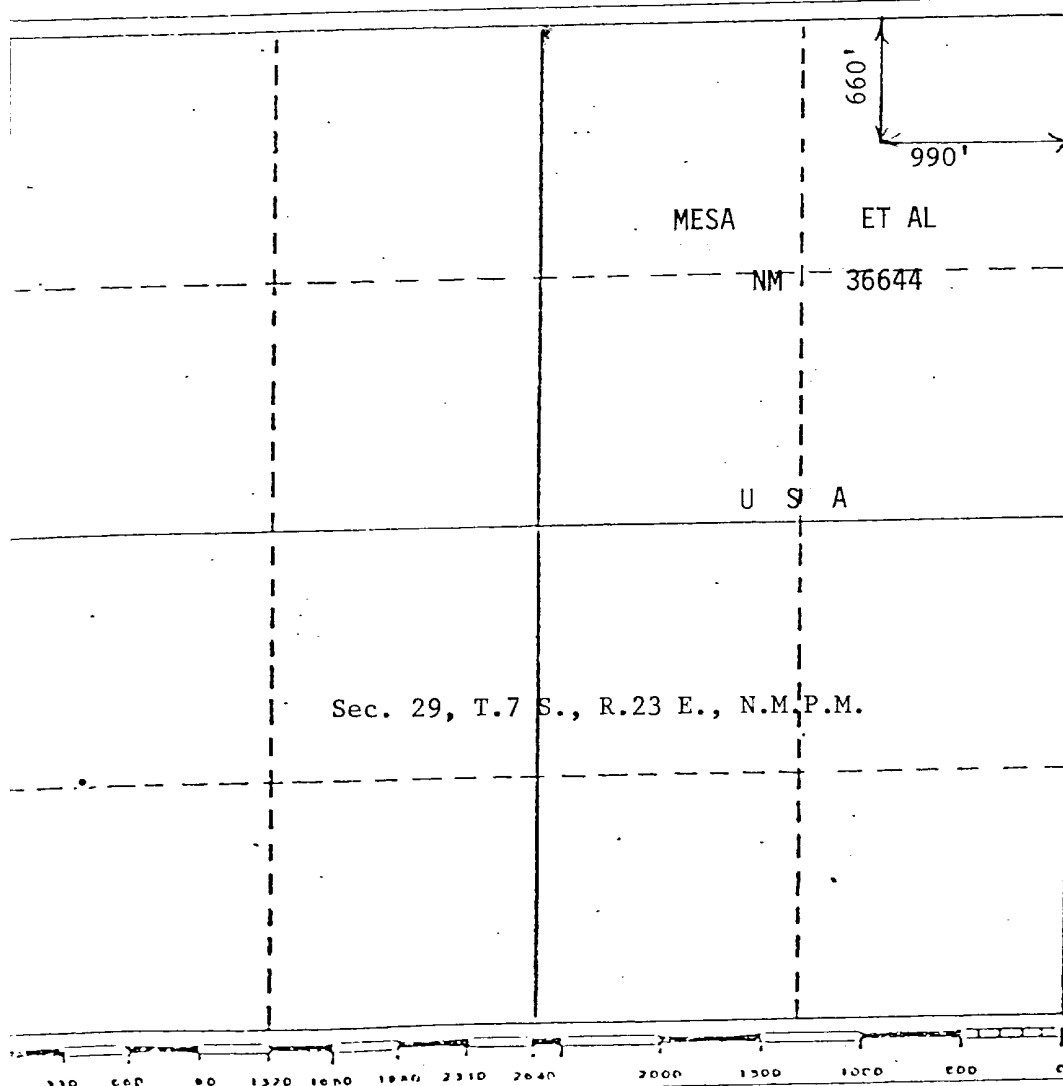

CERTIFICATION

I hereby certify that the information contained herein is true and complete to the best of my knowledge and belief.

R. E. Mathis

Name
R. E. MATHIS

Position
REGULATORY COORDINATOR

Company
MESA PETROLEUM CO.

Date
JUNE 30, 1982

I hereby certify that the well location shown on this plat was plotted from field notes of actual surveys made by me or under my supervision, and that the same is true and correct to the best of my knowledge and belief.

Date Surveyed
6-28-82

Registered Professional Engineer and/or Land Surveyor
JOHN D. JAQUES
6290

Certificate No. **6290**

APPLICATION FOR PERMIT TO DRILL

MESA PETROLEUM CO.
DEBBIE FEDERAL #6
660' FNL & 990' FEL, SEC 29, T7S, R23E
CHAVES COUNTY, NEW MEXICO

LEASE NO. NM-36644

In conjunction with Form 9331-C, Application For Permit to Drill subject well, the following additional information is provided:

1. Applicable portions of the GENERAL REQUIREMENTS FOR OIL AND GAS OPERATIONS ON FEDERAL LEASES, Roswell District, Geological Survey of September 1, 1980 will be adhered to.

2. Geological markers are estimated as follows:

SEVEN RIVERS	Surface
SAN ANDRES	670
GLORIETA	848
TUBB	2196
ABO	2581

3. Hydrocarbon bearing strata may occur in the Abo formation(s). No fresh water is expected to be encountered below 1400'.

4. The Casing and Blowout Preventer Program will be determined by hole conditions as encountered. See Exhibit VI. Anticipate drilling with air or foam using ram type preventer and rotating head for well control. The 8 5/8" casing will be set at approximately 1400' to protect any fresh water zones and cemented to the surface. The 4 1/2" production casing will be set at total depth or shallower depending upon the depth of the deepest commercial hydrocarbon bearing strata encountered. Sufficient amounts and kinds of cement would be used to ensure any water, gas, or oil zones encountered are isolated and shut off down to the casing point if run.

5. No drill stem test or coring program is planned. The logging program may consist of a GR-CNL from surface total depth and FDC from casing point to total depth.

6. Anticipated drilling time is ten days with completion operations to follow as soon as a completion unit is available.

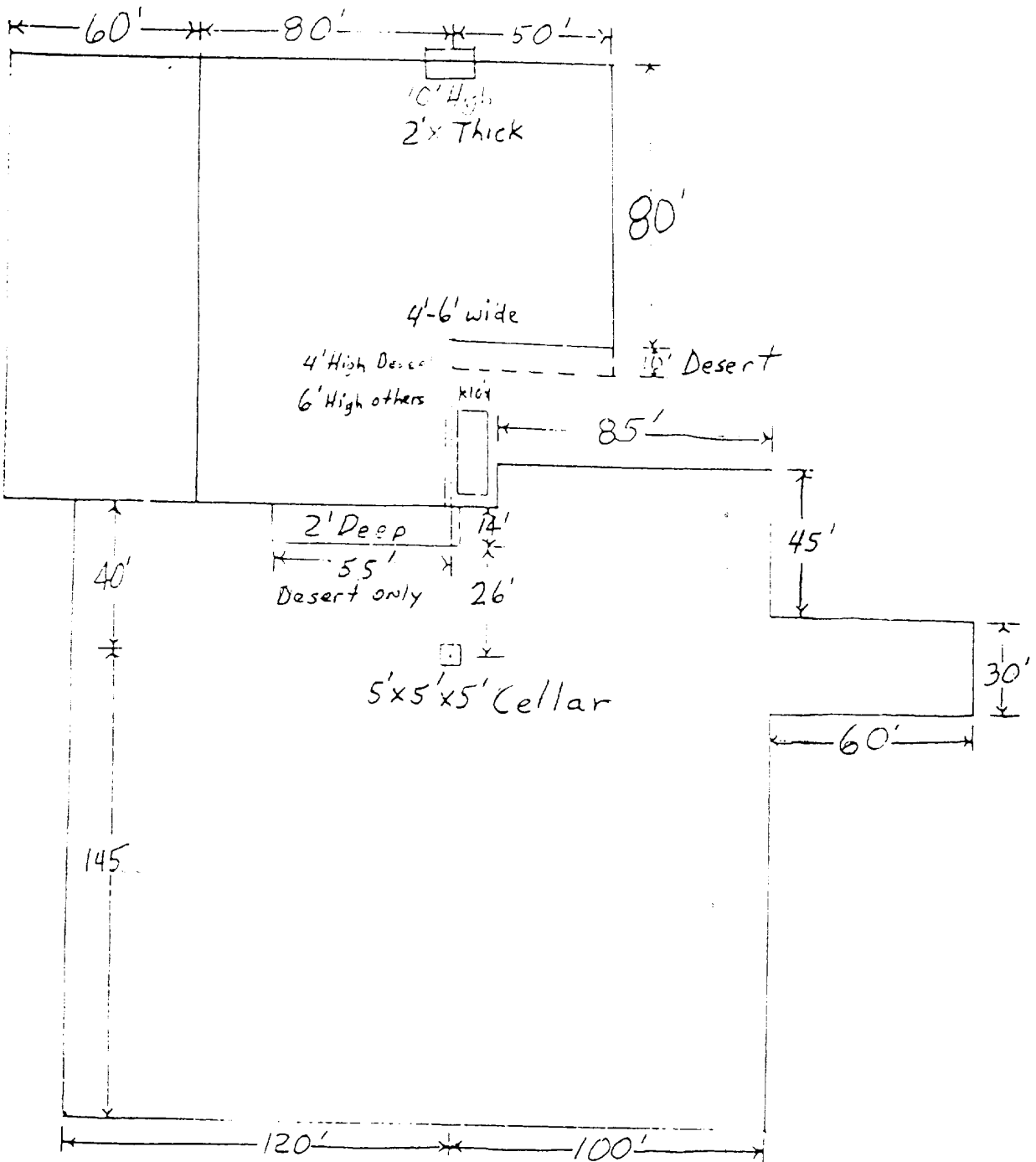

6"-8" Watered & Compacted Caliche
ON PAD & ROAD IF NEEDED

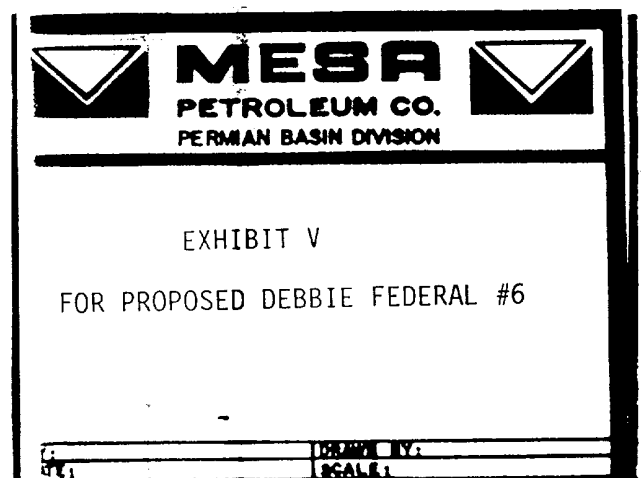

Blow-out Preventers hydril and choke manifold are all 900 Series

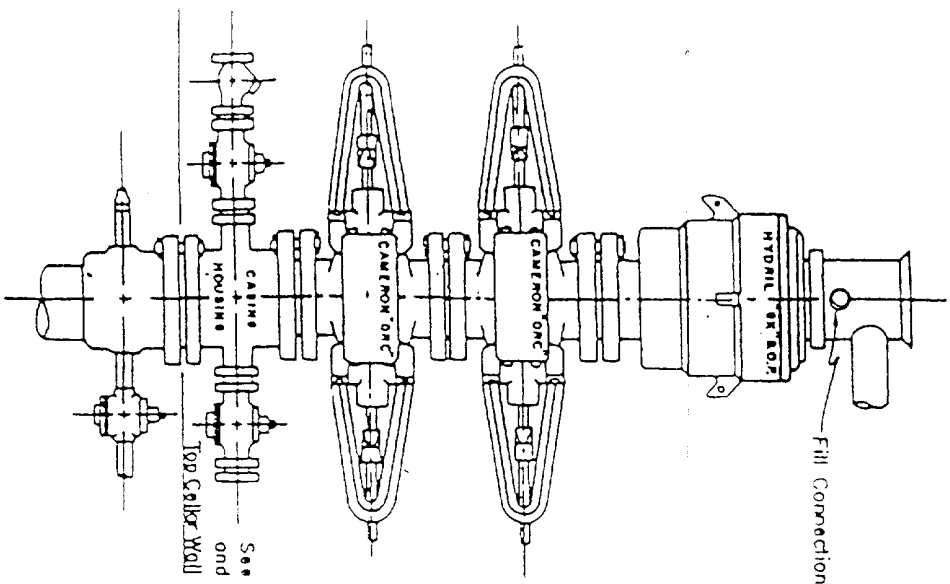

3,000 PSI WORKING PRESSURE
BLOW-OUT PREVENTER HOOK-UP

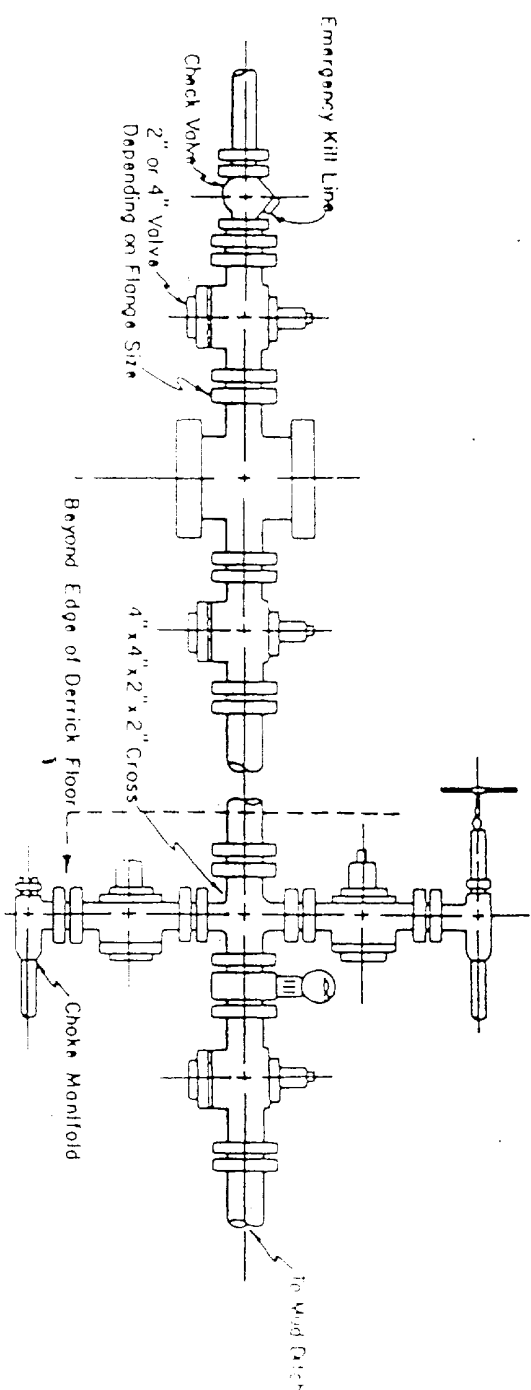

3,000 PSI WORKING PRESSURE KILL, CHOKE, AND FILL CONNECTIONS

DETAIL OF 4\"/>

Minimum assembly for 3,000 PSI working pressure will consist of three preventers.
The bottom and middle preventers may be Cameron.

NOTE: HYDRIL, not installed on shallow low pressure wells.
RAM type BOPs are API 10\"/>



E X H I B I T

V I