

NO. OF COPIES RECEIVED	
DISTRIBUTION	
SANTA FE	1
FILE	1
U.S.G.S.	2
LAND OFFICE	1
OPERATOR	1

NEW MEXICO OIL CONSERVATION COMMISSION

RECEIVED

Form C-101
Revised 1-1-65

AUG 11 1982

O. C. D.
ARTESIA, OFFICE5A. Indicate Type of Lease
STATE ☒ FEE ☐

5. State Oil & Gas Lease No.

LG-6679

APPLICATION FOR PERMIT TO DRILL, DEEPEN, OR PLUG BACK

1a. Type of Work		7. Unit Agreement Name	
b. Type of Well DRILL <input checked="" type="checkbox"/> DEEPEN <input type="checkbox"/> PLUG BACK <input type="checkbox"/> OIL WELL <input type="checkbox"/> GAS WELL <input checked="" type="checkbox"/> OTHER <input type="checkbox"/> SINGLE ZONE <input checked="" type="checkbox"/> MULTIPLE ZONE <input type="checkbox"/>		8. Farm or Lease Name IRIS STATE	
2. Name of Operator MESA PETROLEUM CO. ✓		9. Well No. 3	
3. Address of Operator 1000 VAUGHN BUILDING/MIDLAND, TEXAS 79703-4493		10. Field and Pool, or Wildcat UNDESIGNATED ABO	
4. Location of Well UNIT LETTER 0 LOCATED 990 FEET FROM THE SOUTH LINE AND 1980 FEET FROM THE EAST LINE OF SEC. 21 TWP. 7S RGE. 23E NMPM		12. County CHAVES	
19. Proposed Depth 3400'		19A. Formation ABO	
20. Rotary or C.T. ROTARY			
21. Elevations (Show whether DF, RT, etc.) 3912' GR	21A. Kind & Status Plug. Bond BLANKET	21B. Drilling Contractor DUAL DRILLING	22. Approx. Date Work will start AUGUST 19, 1982

23.

PROPOSED CASING AND CEMENT PROGRAM

SIZE OF HOLE	SIZE OF CASING	WEIGHT PER FOOT	SETTING DEPTH	SACKS OF CEMENT	EST. TOP
12 1/4"	8 5/8"	24#	1400'	300/300/300	SURFACE
7 7/8"	4 1/2"	10.5#	3400'	500/500	ISOLATE WTR, O&G

Propose to drill 12 1/4" hole to approximately 1400' more or less and set 8 5/8" surface casing and cement to surface. Will reduce hole to 7 7/8", nipple up RAM type BOP's and drill to total depth. Drilling medium will be air, foam, or mud as required.

Operator's Gas Sales are Dedicated.

APPROVAL VALID FOR 180 DAYS
PERMIT EXPIRES 2-16-83
UNLESS DRILLING UNDERWAY

XC: NMOCD (6), TLS, CEN RCDS, ACCTG, MEC, LAND, ROSWELL, REM, FILE (PARTNERS)

IN ABOVE SPACE DESCRIBE PROPOSED PROGRAM: IF PROPOSAL IS TO DEEPEN OR PLUG BACK, GIVE DATA ON PRESENT PRODUCTIVE ZONE AND PROPOSED NEW PRODUCTIVE ZONE. GIVE BLOWOUT PREVENTER PROGRAM, IF ANY.

I hereby certify that the information above is true and complete to the best of my knowledge and belief.

Signed R. E. Nathan Title REGULATORY COORDINATOR Date 8-9-82

(This space for State Use)

APPROVED BY Mike Walker TITLE OIL AND GAS INSPECTOR
Notify N.M.O.C.C. in sufficient time to witness cementing
DATE 8-16-82

CONDITIONS OF APPROVAL, IF ANY:

All distances must be from the outer boundaries of the Section.

AUG 11 1982

Operator Mesa Petroleum Co.			Lease Iris State		
Unit Letter 0	Section 21	Township 7 South	Range 23 East	County Chaves	O. C. D. ARTESIA, OFFICE
Actual Postage Location of Well: <div style="display: flex; justify-content: space-between;"> 990 feet from the South line and 1980 feet from the East line </div>					
Ground Level Elev. 3912	Producing Formation ABO	Pool UNDESIGNATED		Dedicated Acreage: SE/4 160 Acres	

1. Outline the acreage dedicated to the subject well by colored pencil or hatchure marks on the plat below.
2. If more than one lease is dedicated to the well, outline each and identify the ownership thereof (both as to working interest and royalty).
3. If more than one lease of different ownership is dedicated to the well, have the interests of all owners been consolidated by communitization, unitization, force-pooling, etc?

☐ Yes ☐ No If answer is "yes," type of consolidation _____

If answer is "no," list the owners and tract descriptions which have actually been consolidated. (Use reverse side of this form if necessary.) _____

No allowable will be assigned to the well until all interests have been consolidated (by communitization, unitization, forced-pooling, or otherwise) or until a non-standard unit, eliminating such interests, has been approved by the Division.

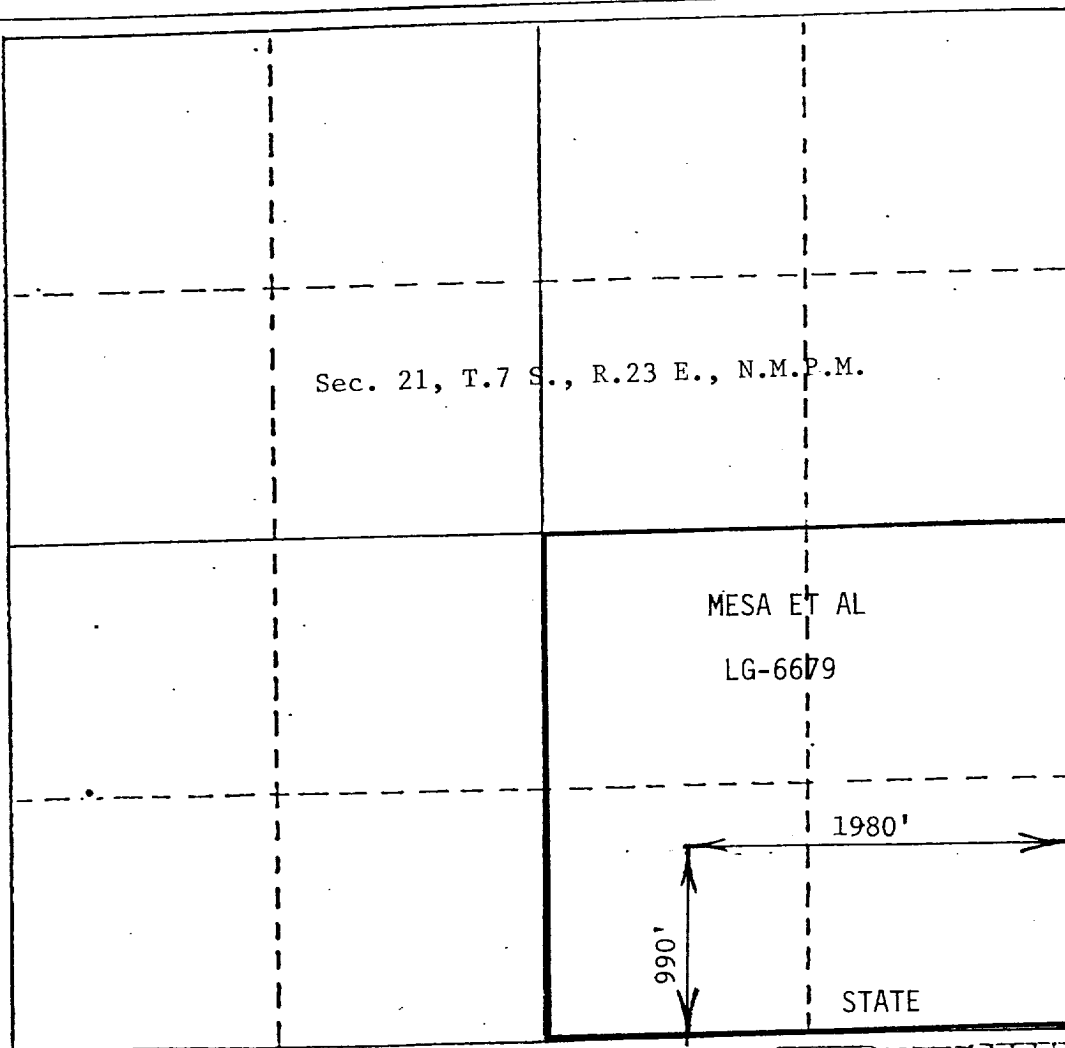

CERTIFICATION

I hereby certify that the information contained herein is true and complete to the best of my knowledge and belief.

R. E. Mathis

Name
R. E. MATHIS
Position
REGULATORY COORDINATOR
Company
MESA PETROLEUM CO.
Date
AUGUST 9, 1982

I hereby certify that the well location shown on this plat was plotted from field notes of actual surveys made by me or under my supervision, and that the same is true and correct to the best of my knowledge and belief.

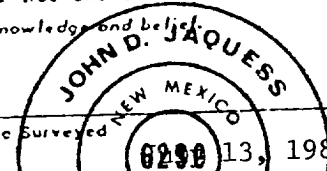

Date Surveyed
6290 13, 1982
Registered Professional Surveyor
and/or Land Use Surveyor
John D. Jaquess
John D. Jaquess, P.E. & L.S.
Certificate No.
6290