

| | |
|------------------------|-------------------------------------|
| NO. OF COPIES RECEIVED | |
| DISTRIBUTION | |
| SANTA FE | <input checked="" type="checkbox"/> |
| FILE | <input checked="" type="checkbox"/> |
| U.S.G.S. | <input checked="" type="checkbox"/> |
| LAND OFFICE | <input checked="" type="checkbox"/> |
| OPERATOR | |

NEW MEXICO OIL CONSERVATION COMMISSION

NOV 5 1982

O. C. C.
ARTESIA, OFFICEForm C-101
Revised 1-1-65

5A. Indicate Type of Lease

STATE ☒ REC ☐

5. State Oil & Gas Lease No.

LG-6679

APPLICATION FOR PERMIT TO DRILL, DEEPEN, OR PLUG BACK

| | | | |
|---|--|--|--|
| a. Type of Work AMENDED LOCATION | | 7. Unit Agreement Name | |
| b. Type of Well DRILL <input checked="" type="checkbox"/> DEEPEN <input type="checkbox"/> PLUG BACK <input type="checkbox"/> | | 8. Farm or Lease Name IRIS STATE | |
| c. Name of Operator MESA PETROLEUM CO. | | 9. Well No. 3 | |
| d. Address of Operator 1000 VAUGHN BUILDING/MIDLAND, TEXAS 79703-4493 | | 10. Field and Pool, or Wildcat UNDESIGNATED ABO | |
| e. Location of Well UNIT LETTER 0 LOCATED 660 FEET FROM THE SOUTH LINE | | 12. County CHAVES | |
| 19. Proposed Depth 3400' | | 19A. Formation ABO | |
| 20. Rotary or C.T. ROTARY | | 21. Elevations (Show whether DF, RT, etc.) 3912' GR | |
| 21A. Kind & Status Plug. Bond BLANKET | | 21B. Drilling Contractor DUAL DRILLING | |
| 22. Approx. Date Work will start AUGUST 19, 1982 | | | |

| 23. PROPOSED CASING AND CEMENT PROGRAM | | | | | |
|--|----------------|-----------------|---------------|-----------------|------------------|
| SIZE OF HOLE | SIZE OF CASING | WEIGHT PER FOOT | SETTING DEPTH | SACKS OF CEMENT | EST. TOP |
| 12 1/4" | 8 5/8" | 24# | 1400' | 300/300/300 | SURFACE |
| 7 7/8" | 4 1/2" | 10.5# | 3400' | 500/500 | ISOLATE WTR. 084 |

Propose to drill 12 1/4" hole to approximately 1400' more or less and set 8 5/8" surface casing and cement to surface. Will reduce hole to 7 7/8", nipple up RAM type BOP's and drill to total depth. Drilling medium will be air, foam, or mud as required.

Operator's Gas Sales are Dedicated.

APPROVAL VALID FOR 180 DAYS
PERMIT EXPIRES 5-10-83
UNLESS DRILLING UNDERWAY

XC: NMOCD (6), TLS, CEN RCDS, ACCTG, MEC, LAND, ROSWELL, REM, FILE (PARTNERS)

N ABOVE SPACE DESCRIBE PROPOSED PROGRAM; IF PROPOSAL IS TO DEEPEN OR PLUG BACK, GIVE DATA ON PRESENT PRODUCTIVE ZONE AND PROPOSED NEW PRODUCTIVE ZONE. GIVE BLOWOUT PREVENTER PROGRAM, IF ANY.

I hereby certify that the information above is true and complete to the best of my knowledge and belief.

Signed [Signature] Title REGULATORY COORDINATOR Date 5 NOV. 82

(This space for State Use)

APPROVED BY [Signature] TITLE Notify N.M.O.C.C. in sufficient time to witness cementing the casing DATE NOV 10 1982
CONDITIONS OF APPROVAL, IF ANY:

STATE OF NEW MEXICO
ENERGY AND MINERALS DEPARTMENTOIL CONSERVATION
O. BOX 2088
SANTA FE, NEW MEXICO 87501

All distances must be from the outer boundaries of the Section.

| | | | | | |
|---|-----------------------------------|----------------------------|-------------------------|-------------------------|---|
| Operator Mesa Petroleum Co. | | Lease Iris State | | Well No. #3 | |
| Unit Letter 0 | Section 21 | Township 7 South | Range 23 East | County Chaves | |
| Actual Postage Location of Well: 660 feet from the South line and 1980 feet from the East line | | | | | |
| Ground Level Elev. 3911 | Producing Formation ABO | | Pool Und. ABO | | Dedicated Acreage: SE 1/4 160 acres |

1. Outline the acreage dedicated to the subject well by colored pencil or hatchure marks on the plat below.
2. If more than one lease is dedicated to the well, outline each and identify the ownership thereof (both as to working interest and royalty).
3. If more than one lease of different ownership is dedicated to the well, have the interests of all owners been consolidated by communitization, unitization, force-pooling, etc?

☐ Yes ☐ No If answer is "yes" type of consolidation _____

If answer is "no," list the owners and tract descriptions which have actually been consolidated. (Use reverse side of this form if necessary.) _____

No allowable will be assigned to the well until all interests have been consolidated (by communitization, unitization, forced-pooling, or otherwise) or until a non-standard unit, eliminating such interests, has been approved by the Division.

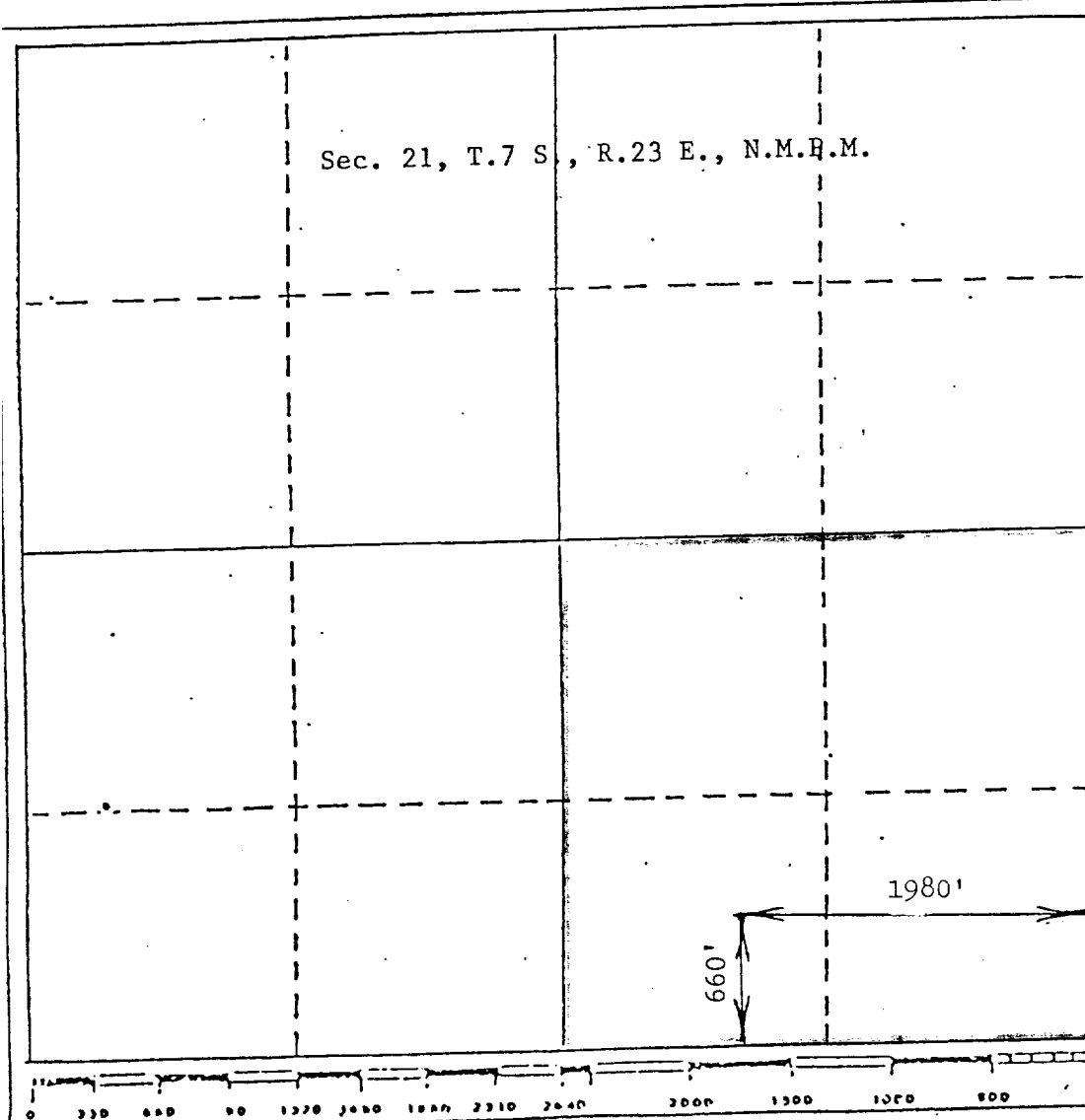

CERTIFICATION

I hereby certify that the information contained herein is true and complete to the best of my knowledge and belief.

Name

Position

Company

Date

W. D. Reed
Regulatory Agent
Mesa Pet. Co.
5 Nov. 82

I hereby certify that the well location shown on this plat was plotted from field notes of actual surveys made by me or under my supervision, and that the same is true and correct to the best of my knowledge and belief.

Date Surveyed

Registered Professional Engineer
and/or Land Surveyor

John D. Jaquess, P.E. & L.S.

Certificate No.

6290