

NO. OF COPIES RECEIVED		
DIST. IDBUTION		
SANTA FE		
FILE		
U.S.G.S.		
LAND OFFICE		
OPERATOR		

NEW MEXICO OIL CONSERVATION COMMISSION

Form C-101
Revised 1-1-65

AUG 1 1982

APPROVED

5A. Indicate Type of Lease	
STATE <input type="checkbox"/>	FEE <input checked="" type="checkbox"/>
5. State Oil & Gas Lease No.	

APPLICATION FOR PERMIT TO DRILL, DEEPEN, OR PLUG BACK

1a. Type of Work		7. Unit Agreement Name	
b. Type of Well DRILL <input checked="" type="checkbox"/> DEEPEN <input type="checkbox"/> PLUG BACK <input type="checkbox"/> OIL WELL <input type="checkbox"/> GAS WELL <input checked="" type="checkbox"/> OTHER <input type="checkbox"/> SINGLE ZONE <input checked="" type="checkbox"/> MULTIPLE ZONE <input type="checkbox"/>		8. Farm or Lease Name ERMA	
2. Name of Operator MESA PETROLEUM CO.		9. Well No. 1	
3. Address of Operator 1000 VAUGHN BUILDING/MIDLAND, TEXAS 79703-4493		10. Field and Pool, or Wildcat WILDCAT ABO	
4. Location of Well UNIT LETTER M LOCATED 660 FEET FROM THE SOUTH LINE AND 660 FEET FROM THE WEST LINE OF SEC. 1 TWP. 10S RGE. 24E NMPM		12. County CHAVES	
19. Proposed Depth 4100'		19A. Formation ABO	
20. Rotary or C.T. ROTARY		21. Elevations (Show whether DF, RT, etc.) 3559' GR	
21A. Kind & Status Plug. Bond BLANKET		21B. Drilling Contractor TOM BROWN DRILLING	
22. Approx. Date Work will start SEPTEMBER 1, 1982			

PROPOSED CASING AND CEMENT PROGRAM

SIZE OF HOLE	SIZE OF CASING	WEIGHT PER FOOT	SETTING DEPTH	SACKS OF CEMENT	EST. TOP
14 3/4"	10 3/4"	40.5#	950'	700/300	SURFACE
9 1/2"	7 5/8"/7"	26.4#/23#	1600'	700/300	TIE BACK
7 7/8/6 1/2/6 1/4"	4 1/2"/5 1/2"	10.5#/15.5#	4100'	300	COVER ABO

Propose to drill 14 3/4" hole with mud or air to approximately 950' and run 10 3/4" casing. Will cement to surface and test casing with cementing head to 600 psi. Will reduce hole to 9 1/2" and drill on mud or air to approximately 1600' and run 7 5/8" casing if circulation has been lost and cement with sufficient amounts to tie-back to 10 3/4" casing. Will then reduce hole to 6 1/2" or 6 1/4", test BOP's and casing and drill to total depth. If hole conditions are favorable, the 7 5/8" casing will be omitted and the hole will be reduced to 7 7/8" and drilled to total depth. Either 4 1/2" or 5 1/2" casing will be run as production casing depending upon hole sized drilled to TD.

Operator's gas sales are dedicated.

APPROVAL VALID FOR _____ DAYS
PERMIT EXPIRES _____
UNLESS DRILLING UNDERWAY
8 26 82

XC: NMOCD (6), TLS, CEN RCDS, ACCTG, MEC, LAND, ROSWELL, REM, FILE (PARTNERS)

IN ABOVE SPACE DESCRIBE PROPOSED PROGRAM: IF PROPOSAL IS TO DEEPEN OR PLUG BACK, GIVE DATA ON PRESENT PRODUCTIVE ZONE AND PROPOSED NEW PRODUCTIVE ZONE. GIVE BLOWOUT PREVENTER PROGRAM, IF ANY.

I hereby certify that the information above is true and complete to the best of my knowledge and belief.

Signed R. E. MONTAGNA Title REGULATORY COORDINATOR Date 8-23-82

(This space for State Use)

APPROVED BY Mike Walker TITLE OIL AND GAS INSPECTOR DATE AUG 26 1982

CONDITIONS OF APPROVAL, IF ANY:

time to witness completion

OIL CONSERVATION DIVISION

STATE OF NEW MEXICO
ENERGY AND MINERALS DEPARTMENTP. O. BOX 2088
SANTA FE, NEW MEXICO 8750Form C-102
Revised 10-1-78

All distances must be from the outer boundaries of the Section.

Operator Mesa Petroleum Co.		Lease Erma		Well No. #1	
Unit Letter M	Section 1	Township 10 South	Range 24 East	County Chaves	
Actual Postage Location of Well: 660 South 660 West feet from the line and feet from the line					
Ground Level Elev. 3559	Producing Formation ABO	Pool WILDCAT		Dedicated Acreage: SW/4 160 Acres	

1. Outline the acreage dedicated to the subject well by colored pencil or hatchure marks on the plat below.
2. If more than one lease is dedicated to the well, outline each and identify the ownership thereof (both as to working interest and royalty).
3. If more than one lease of different ownership is dedicated to the well, have the interests of all owners been consolidated by communitization, unitization, force-pooling, etc?

☐ Yes ☐ No If answer is "yes," type of consolidation _____

If answer is "no," list the owners and tract descriptions which have actually been consolidated. (Use reverse side of this form if necessary.) _____

No allowable will be assigned to the well until all interests have been consolidated (by communitization, unitization, forced-pooling, or otherwise) or until a non-standard unit, eliminating such interests, has been approved by the Division.

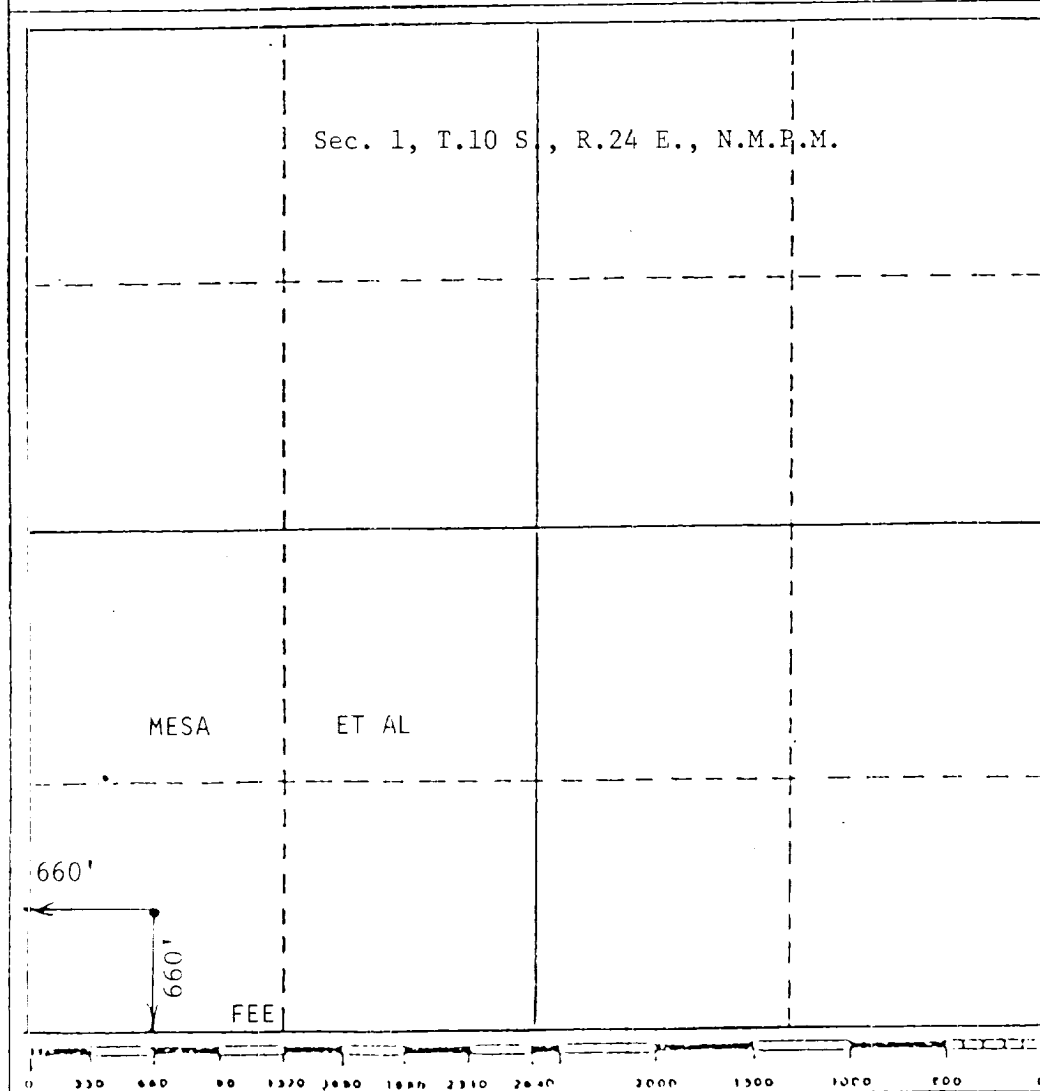

CERTIFICATION

I hereby certify that the information contained herein is true and complete to the best of my knowledge and belief.

R. E. Mathis

Name

R. E. MATHIS

Position

REGULATORY COORDINATOR

Company

MESA PETROLEUM CO.

Date

AUGUST 23, 1982

I hereby certify that the well location shown on this plat was plotted from field notes of actual surveys made by me or under my supervision, and that the same is true and correct to the best of my knowledge and belief.

Date Surveyed

AUGUST 19, 1982

Registered Professional Engineer and/or Land Surveyor

John D. Jaques
John D. Jaques, P.E. & L.S.
Certificate No.

6290