

UNITED STATES  
DEPARTMENT OF THE INTERIOR  
BUREAU OF LAND MANAGEMENT

FORM APPROVED  
OMB No. 1004-0135  
Expires November 30, 2000

9/5F

**SUNDRY NOTICES AND REPORTS ON OIL AND GAS WELLS**  
**Do not use this form for proposals to drill or reenter an abandoned well. Use Form 3160-3 (APB) for such proposals.**

**Oil Cons.**  
**N.M. Div-Dist. 2**  
**1301 W. Grand Avenue**  
**Artesia, NM 88210**

**SUBMIT IN TRIPLICATE - Other instructions on reverse side**

1. Type of Well <input type="checkbox"/> Oil Well <input checked="" type="checkbox"/> Gas Well <input type="checkbox"/> Other		5. Lease Serial No. NM-16784
2. Name of Operator Yates Petroleum Corporation		6. If Indian, Allottee or Tribe Name
3a. Address 105 South Fourth Street, Artesia, NM 88210	3b. Phone No. (include area code) (505) 248-1471	7. If Unit or CA/Agreement, Name and/or No.
4. Location of Well (Footage, Sec., T., R., M., or Survey Description) 1980' FNL and 660' FEL, Unit H Section 26, T7S-R25E		8. Well Name and No. Verbena "UV" Deep Federal #1
		9. API Well No. 30-00561748
		10. Field and Pool, or Exploratory Area Wildcat
		11. County or Parish, State Chaves County, New Mexico

12. CHECK APPROPRIATE BOX(ES) TO INDICATE NATURE OF NOTICE, REPORT, OR OTHER DATA

TYPE OF SUBMISSION	TYPE OF ACTION			
<input checked="" type="checkbox"/> Notice of Intent	<input type="checkbox"/> Acidize	<input checked="" type="checkbox"/> Deepen	<input type="checkbox"/> Production (Start/Resume)	<input type="checkbox"/> Water Shut-Off
<input type="checkbox"/> Subsequent Report	<input type="checkbox"/> Alter Casing	<input type="checkbox"/> Fracture Treat	<input type="checkbox"/> Reclamation	<input type="checkbox"/> Well Integrity
<input type="checkbox"/> Final Abandonment Notice	<input type="checkbox"/> Casing Repair	<input type="checkbox"/> New Construction	<input type="checkbox"/> Recomplete	<input checked="" type="checkbox"/> Other <u>Change Name</u>
	<input type="checkbox"/> Change Plans	<input type="checkbox"/> Plug and Abandon	<input type="checkbox"/> Temporarily Abandon	
	<input type="checkbox"/> Convert to Injection	<input type="checkbox"/> Plug Back	<input type="checkbox"/> Water Disposal	

13. Describe Proposed or Completed Operations (clearly state all pertinent details, including estimated starting date of any proposed work and approximate duration thereof. If the proposal is to deepen directionally or recomple horizontally, give subsurface locations and measured and true vertical depths of all pertinent markers and zones. Attach the Bond under which the work will be performed or provide the Bond No. on file with BLM/BIA. Required subsequent reports shall be filed within 30 days following completion of the involved operations. If the operation results in a multiple completion or recompletion in a new interval, a Form 3160-4 shall be filed once testing has been completed. Final Abandonment Notices shall be filed only after all requirements, including reclamation, have been completed, and the operator has determined that the site is ready for final inspection.)

Yates Petroleum Corporation wishes to change the name of this well from Verbena "UV" Federal #1 to Verbena "UV" Deep Federal #1.

Yate's plan is to use a pulling unit to squeeze off the old Abo perfs then move in a drilling rig and drill out the cement plugs in the 4 1/2" casing to deepen the well about 1,000' to a new TD of 5,250' +/- . After the well has been deepened & logged, a 2 7/8" FJ casing will be run to TD and cemented back to the 3,000'. The mud that will be used is 9.2 - 9.5 ppg brine water with a 55-70 cp viscosity.

The well will be completed with a pulling unit and the well will have completions attempted in the Strawn @ 5,100', the Cisco @ 4,900', and Wolfcamp @ 4,600". This well is an active producer & producing about 2 mcfpd from the Abo Sands in August 2002.

SEE ATTACHED PLATS. Thank you.

14. I hereby certify that the foregoing is true and correct	
Name (Printed/Typed) Clifton R. May	Title Regulatory Agent
Signature <i>Clifton R. May</i>	Date September 4, 2002
APPROVED	
THIS SPACE FOR FEDERAL OR STATE USE	
Approved by ORIG. SGD, DAVID R. GLASS	Title Date
Conditions of approval, if any, attached. Approval of this notice does not warrant or certify that the applicant holds legal or equitable title to those rights in the subject lease which would entitle the applicant to conduct operations thereon.	Office
Title 18 U.S.C. Section 1001 makes it a crime for any person knowingly and willfully to make to any department or agency of the United States any false, fictitious or fraudulent statements or representations as to any matter within its jurisdiction.	

**1625 N. French Dr., Hobbs, NM 88240**

State of New Mexico  
Energy, Minerals & Natural Resources Department

Form C-102  
Revised August 15, 2000

## District II

**811 South First, Artesia, NM 88210**

OIL CONSERVATION DIVISION  
1220 South St. Francis Dr.  
Santa Fe, NM 87505

Submit to Appropriate District Office  
State Lease - 4 Copies  
Fee Lease - 3 Copies

### District III

1000 Rio Brazos Rd., Aztec, NM 87410

### District IV

**1220 S. St. Francis Dr., Santa Fe, NM 87505**

☐ AMENDED REPORT

# WELL LOCATION AND ACREAGE DEDICATION PLAT

<sup>1</sup> API Number <b>30-005-61748</b>		<sup>2</sup> Pool Code	<sup>3</sup> Pool Name <b>Wildcat Basement</b>
<sup>4</sup> Property Code	<sup>5</sup> Property Name <b>VEBENA "UV" DEEP FEDERAL</b>		<sup>6</sup> Well Number <b>1</b>
<sup>7</sup> OGRID No. <b>025575</b>	<sup>8</sup> Operator Name <b>Yates Petroleum Corporation</b>		<sup>9</sup> Elevation <b>3671.7'</b>

## 10 Surface Location

UL or lot no.	Section	Township	Range	Lot Idn	Feet from the	North/South line	Feet from the	East/West line	County
H	26	7S	25E		1980	North	660	East	Chaves

<sup>11</sup> Bottom Hole Location If Different From Surface

Bottle Hole Location if Different From Surface									
UL or lot no.	Section	Township	Range	Lot Idn	Feet from the	North/South line	Feet from the	East/West line	County

<sup>12</sup> Dedicated Acres <b>320-N/2</b>	<sup>13</sup> Joint or Infill	<sup>14</sup> Consolidation Code	<sup>15</sup> Order No.
---	-------------------------------	----------------------------------	-------------------------

NO ALLOWABLE WILL BE ASSIGNED TO THIS COMPLETION UNTIL ALL INTERESTS HAVE BEEN CONSOLIDATED OR A NON-STANDARD UNIT HAS BEEN APPROVED BY THE DIVISION

<div style="position: relative; height: 100px;"> <div style="position: absolute; top: 0; right: 0; width: 50px; height: 50px; border: 1px solid black; border-radius: 50%; text-align: center; line-height: 50px;"> 1980' </div> <div style="position: absolute; bottom: 0; right: 0; width: 50px; height: 50px; border: 1px solid black; border-radius: 50%; text-align: center; line-height: 50px;"> 660' </div> </div>		<div style="border: 1px solid black; padding: 5px;"> 17 OPERATOR CERTIFICATION  I hereby certify that the information contained herein is true and complete to the best of my knowledge and belief.  <div style="font-family: cursive; font-size: 1.2em; margin-top: 5px;">Clifton R. May</div> <div style="border-top: 1px solid black; margin-top: 5px;">Signature</div> <div style="border-top: 1px solid black; margin-top: 5px;">Clifton R. May</div> <div style="border-top: 1px solid black; margin-top: 5px;">Printed Name</div> <div style="border-top: 1px solid black; margin-top: 5px;">Regulatory Agent</div> <div style="border-top: 1px solid black; margin-top: 5px;">Title</div> <div style="border-top: 1px solid black; margin-top: 5px;">9/4/2002</div> <div style="border-top: 1px solid black; margin-top: 5px;">Date</div> </div>	
		<div style="border: 1px solid black; padding: 5px;"> 18 SURVEYOR CERTIFICATION  I hereby certify that the well location shown on this plat was plotted from field notes of actual surveys made by me or under my supervision, and that the same is true and correct to the best of my belief.  <div style="border-top: 1px solid black; margin-top: 5px;">REFER TO ORIGINAL PLAT</div> <div style="border-top: 1px solid black; margin-top: 5px;">Date of Survey</div> <div style="border-top: 1px solid black; margin-top: 5px;">Signature and Seal of Professional Surveyor:</div> <div style="border-top: 1px solid black; margin-top: 5px;">Certificate Number</div> </div>	

NEW MEXICO OIL CONSERVATION COMMISSION  
LOCATION AND ACREAGE DEDICATION PLAT

Form C-102  
Supersedes C-128  
Effective 1-1-65

All distances must be from the outer boundaries of the Section.

Operator <b>YATES PETROLEUM CORPORATION</b>				Lease <b>Verbena "UV" Federal</b>		Well No. <b>1</b>
Unit Letter <b>H</b>	Section <b>26</b>	Township <b>7 South</b>	Range <b>25 East</b>	County <b>Chaves</b>		
Actual Footage Location of Well: <b>1980</b> feet from the <b>North</b> line and <b>660</b> feet from the <b>East</b> line						
Ground Level Elev. <b>3671.7'</b>	Producing Formation <b>Abo</b>		Pool <b>Pceos Slope Abo</b>		Dedicated Acreage: <b>160</b> Acres	

1. Outline the acreage dedicated to the subject well by colored pencil or hachure marks on the plat below.
2. If more than one lease is dedicated to the well, outline each and identify the ownership thereof (both as to working interest and royalty).
3. If more than one lease of different ownership is dedicated to the well, have the interests of all owners been consolidated by communitization, unitization, force-pooling, etc?

☐ Yes ☒ No If answer is "yes," type of consolidation \_\_\_\_\_

If answer is "no," list the owners and tract descriptions which have actually been consolidated. (Use reverse side of this form if necessary.) \_\_\_\_\_

No allowable will be assigned to the well until all interests have been consolidated (by communitization, unitization, forced-pooling, or otherwise) or until a non-standard unit, eliminating such interests, has been approved by the Commission.

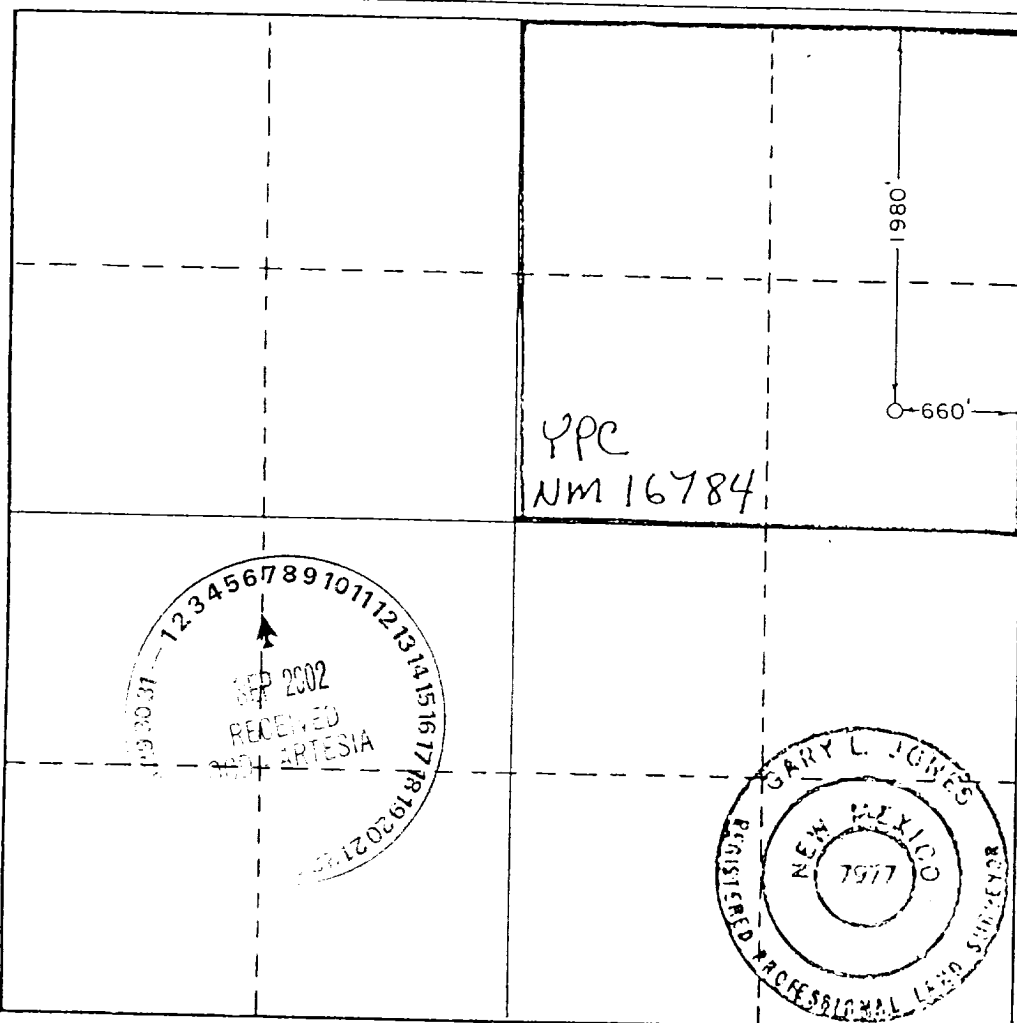

CERTIFICATION

I hereby certify that the information contained herein is true and complete to the best of my knowledge and belief.

*Cy Cowan*

Name

Cy Cowan

Position

Regulatory Coordinator

Company

Yates Petroleum Corp.

Date

8/2/82

I hereby certify that the well location shown on this plat was plotted from field notes of actual surveys made by me or under my supervision, and that the same is true and correct to the best of my knowledge and belief.

Date Surveyed

July 27, 1982

Registered Professional Engineer and/or Land Surveyor

*Gary L. Jones*

Certificate No.

7977

0 330 660 990 1320 1650 1980 2310 2640 2970 3300 3630 3960 4290 4620 4950 5280 5610 5940 6270 6600

WELLNAME: Verbena "UV" Federal FIELD: Pecos Slope  
 LOCATION: 1980' FNL + 660' FEL, Sec 26, T7S, R25S, Chaves Co, NM  
 ELEV: 3,671' ZERO: \_\_\_\_\_ AGL: \_\_\_\_\_ KB: 3,680'  
 START DATE: 9/25/82 COMPLETION DATE: \_\_\_\_\_  
 COMMENTS: \_\_\_\_\_

CASING PROGRAM	
SIZE/WT/GR/CONN	DEPTH SET
10 3/4" 40.5 #11 J-55, STJ	845'
4 1/2" 9.50 #11 J-55, STJ	4,249'
2 7/8" 6.50 #11 N-80, FJ	5,250'

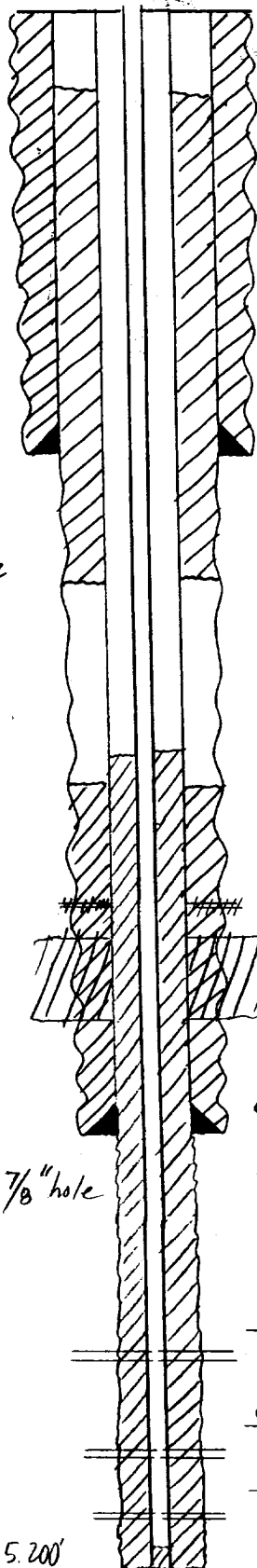

14 3/4" hole

TOC: ?

After

10 3/4" set @ 845' CMTD w/ 575 SACKS  
CMT circ to surface

7 7/8" hole

1" f/ 1,350' w/ 250 SACKS

TOC: 3,000' +/-  
TOC: 3,550'

Abo

3,728' - 3,730' 4 holes, shot 10/9/82, sg20 w/ 50 SCKS  
10/12/82, re-sg20 w/ 500 SCKS 10/15/82  
3,894' - 4,035', 12 holes, shot 10/9/82  
sg20 w/ 200+ SCKS fraced down 2 7/8" tbg

4 1/2" set @ 4,249' CMTD w/ 350 SACKS

DATE: 8/26/02 JWP

- SKETCH NOT TO SCALE -

3 7/8" hole

Wolfcamp

4,600' +/-

CISCO

4,900' +/-

STRAWN

5,100' +/-

PBTB: 5,200'

2 7/8" CSG @ 5,250' w/ 100+ SACKS of CMT

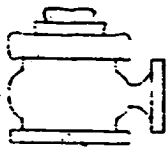

# Yates Petroleum Corporation

BOP-2

## Typical 2,000 psi Pressure System Schematic Double Ram Preventer Stack

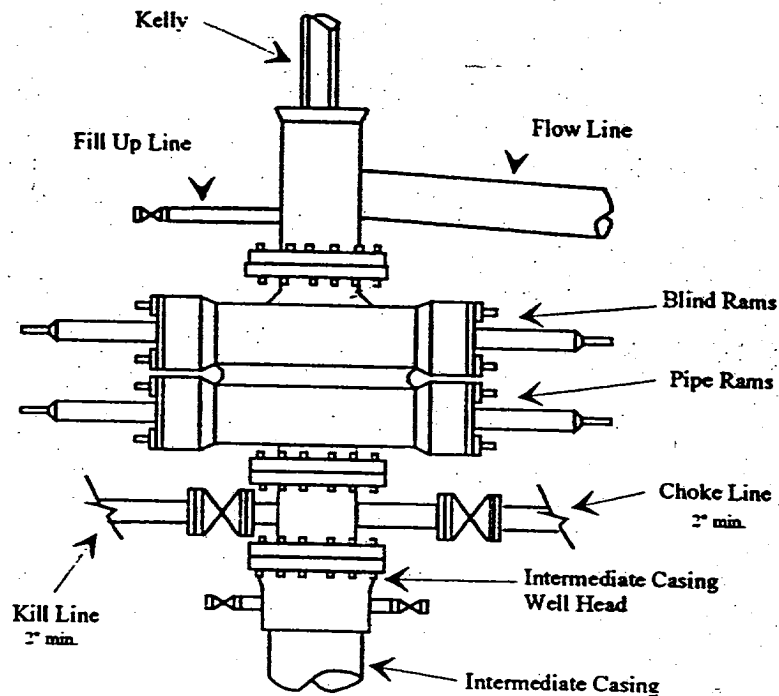

Typical 2,000 psi choke manifold assembly with at least these minimum features

