

Drawer DD
Artesia, NM 88210 UNITED STATES
DEPARTMENT OF THE INTERIOR

GEOLOGICAL SURVEY

APPLICATION FOR PERMIT TO DRILL, DEEPEN, OR PLUG BACK

1a. TYPE OF WORK

DRILL ☒

DEEPEN ☐

PLUG BACK ☐

b. TYPE OF WELL

OIL
WELL ☐

GAS
WELL ☒

OTHER

RECEIVED
ZONE ☒

MULTIPLE
ZONE ☐

2. NAME OF OPERATOR

DEPCO, Inc. ✓

3. ADDRESS OF OPERATOR

800 Central, Odessa, Texas 79761

4. LOCATION OF WELL (Report location clearly and in accordance with any State requirements.)

At surface

A-660' FN & EL, Sec. 20, T-5S, R-25E

At proposed prod. zone

14. DISTANCE IN MILES AND DIRECTION FROM NEAREST TOWN OR POST OFFICE*

43 miles NNE of Roswell, New Mexico

15. DISTANCE FROM PROPOSED*

LOCATION TO NEAREST
PROPERTY OR LEASE LINE, FT.
(Also to nearest drlg. unit line, if any)

18. DISTANCE FROM PROPOSED LOCATION*

TO NEAREST WELL, DRILLING, COMPLETED,
OR APPLIED FOR, ON THIS LEASE, FT.

16. NO. OF ACRES IN LEASE

19. PROPOSED DEPTH

4230'

17. NO. OF ACRES ASSIGNED
TO THIS WELL

160

20. ROTARY OR CABLE TOOLS

Rotary

21. ELEVATIONS (Show whether DF, RT, GR, etc.)

3811 GR

23. to BOPM 8/13/82

PROPOSED CASING AND CEMENTING PROGRAM

SIZE OF HOLE	SIZE OF CASING	WEIGHT PER FOOT	SETTING DEPTH	QUANTITY OF CEMENT
14 3/4"	10 3/4"	40.50#	974'	Circ.
7 7/8"	4 1/2"	10.50#	4230'	675 ex. w/DV Collar @ 1790'

Mud Program: See letter from Marrs Mud Company

BOP Program: See Exhibit "D"

Transwestern pipeline Company will purchase gas

RECEIVED

AUG 13 1982

OIL & GAS
MINERALS MGMT. SERVICE
ROSWELL, NEW MEXICO

IN ABOVE SPACE DESCRIBE PROPOSED PROGRAM: If proposal is to deepen or plug back, give data on present productive zone and proposed new productive zone. If proposal is to drill or deepen directionally, give pertinent data on subsurface locations and measured and true vertical depths. Give blowout preventer program, if any.

24.

SIGNED

R. L. Denny

R. L. Denny

TITLE Chief Production Clerk

DATE 8-4-82

(This space for Federal or State office use)

W. B. S. G. GEORGE H. STEWART

PERMIT NO.

APPROVAL DATE

APPROVED BY

TITLE

DATE

CONDITIONS OF APPROVAL, IF ANY:

JOHN A. OILMAN
DISTRICT SUPERVISOR

*See Instructions On Reverse Side

All dimensions must be from the outer boundaries of the State.

Operator Depco		Lease Rose Federal		Well No. #1
Unit Letter A	Section 20	Township 5 South	Range 25 East	County Chaves
Actual Postage Location of Well: 660 feet from the North line and 660 feet from the East line				
Ground Level Elev. 3811	Producing Formation Abo		Pool Pecos Slopes Abo	Dedicated Acres: 160 Acres

1. Outline the acreage dedicated to the subject well by colored pencil or hatchure marks on the plat below.

2. If more than one lease is dedicated to the well, outline each and identify the ownership thereof (both as to working interest and royalty).

3. If more than one lease of different ownership is dedicated to the well, have the interests of all owners been consolidated by communitization, unitization, force-pooling, etc?

☐ Yes ☐ No If answer is "yes," type of consolidation _____

If answer is "no," list the owners and tract descriptions which have actually been consolidated. (Use reverse side of this form if necessary.) _____

No allowable will be assigned to the well until all interests have been consolidated (by communitization, unitization, forced-pooling, or otherwise) or until a non-standard unit, eliminating such interests, has been approved by the Division.

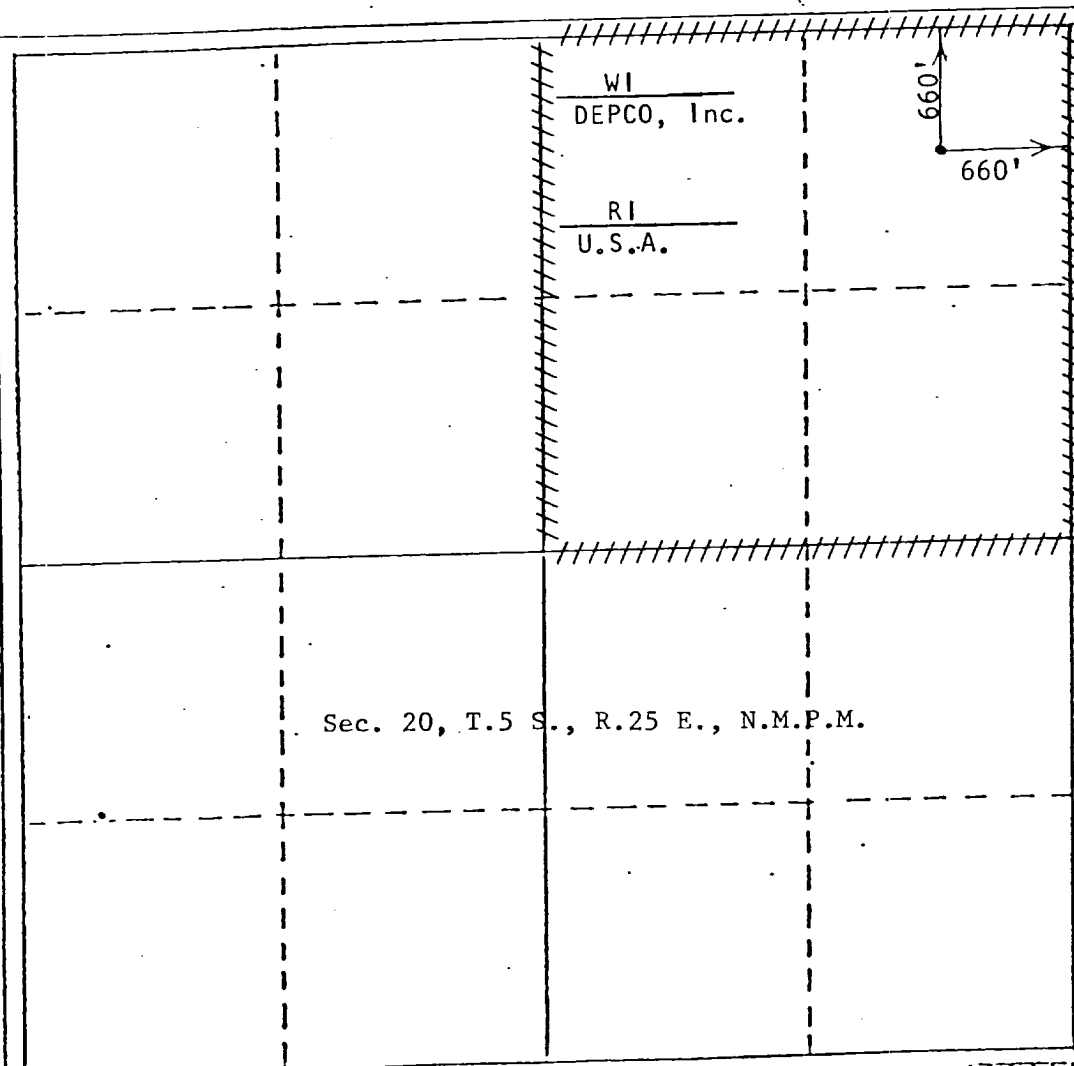

CERTIFICATION

I hereby certify that the information contained herein is true and complete to the best of my knowledge and belief.

*R. L. Denney*Name
R. L. DenneyPosition
Chief Production ClerkCompany
DEPCO, Inc.Date
8-4-82

I hereby certify that the well location shown on this plat was plotted from field notes of actual surveys made by me or under my supervision, and that the same is true and correct to the best of my knowledge and belief.

Date Surveyed
July 30, 1982Registered Professional Engineer and/or Land Surveyor
6290

John D. Jaquess, P.E. & L.S.

Certificate No.
6290

DEPCO, Inc.
800 CENTRAL
ODESSA, TEXAS

APPLICATION FOR DRILLING

DEPCO, INC.
No. 1 Rose Federal
CHAVES COUNTY, NEW MEXICO

In conjunction with Form 9-331C, Application for permit to drill, DEPCO, INC. submits the following items of pertinent information in accordance with USGS requirements.

1. The estimated tops of geologic markers are as follows:

San Andres	580'
Glorieta	1590'
Tubb	3060'
Abo	3630'

2. The depths at which anticipated water, oil or gas formations are expected to be encountered:

Water:	Approximately 950 feet or less
Gas:	Abo 3630'

3. Proposed casing program: See Form 9-331C.
4. Pressure Control Equipment: See Form 9-331C and Exhibit D.
5. Mud Program: See Form 9-331C and attached letter from Marrs Mud Company.
6. Auxiliary Equipment: Blowout Preventer, Inside Blowout Preventer, Kelley Cock.
7. Testing, Logging and Coring Program:

Drill Stem Test:	Abo
	10-foot samples from surface casing to TD
Logging:	Dual Laterolog and Compensated Neutron/Density
	With Gamma Ray and Caliper
8. No abnormal pressures or temperatures are anticipated.
9. Anticipated starting date: As soon as possible.

T. 5S.

Exhibit A
DEPI Inc.
Rose Federal #1
660 FN & EL
Sec. 20, T5S, R25E
Chaves Co., NM36408

1:050,000
FEET

12

7

8

13

18

17

Middle Spring

Davis
3900

R 24 E
R 25 E

3918

3900

3869

3837

3863

3850

3850

3800

3850

Plot layout for Rig No. 3

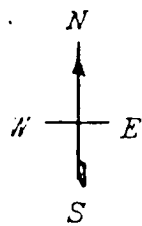

No Scale

Exhibit C
DEPCO, Inc.
Rose Federal #1
660 FN & EL
Sec. 20, T5S, R25E
Chaves Co., NM36408

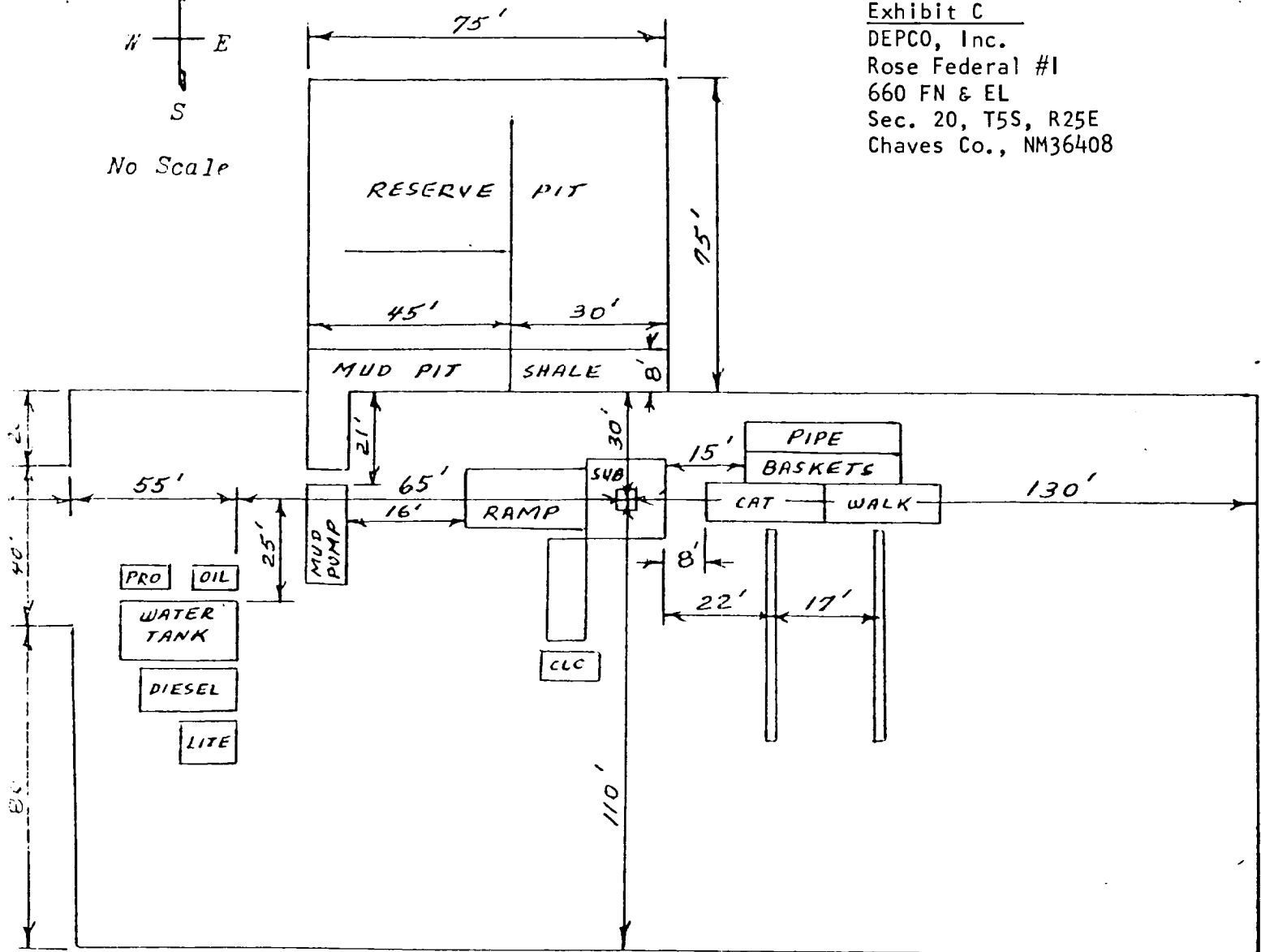

Cellar - 5' x 5' x 5'

This Rig equipped with Schaffer type "E" 10" series 900 BOP with 4" blind rams, kill line and choke manifold. Koomey hydraulic controls and accumulator with remote controls.

Maintain six (6) foot spacing between oil tank, water tank, diesel tank and light plant.

Twenty (20) foot by Forty(40) foot stinger area at west end of location.

WEL DRILLING CO., INC. BLOWOUT PREVENTER SPECIFICATION

Exhibit D
DEPCO, Inc.
Rose Federal #1
660 FN & EL
Sec. 20, T5S, R25E
Chaves Co., NM36408

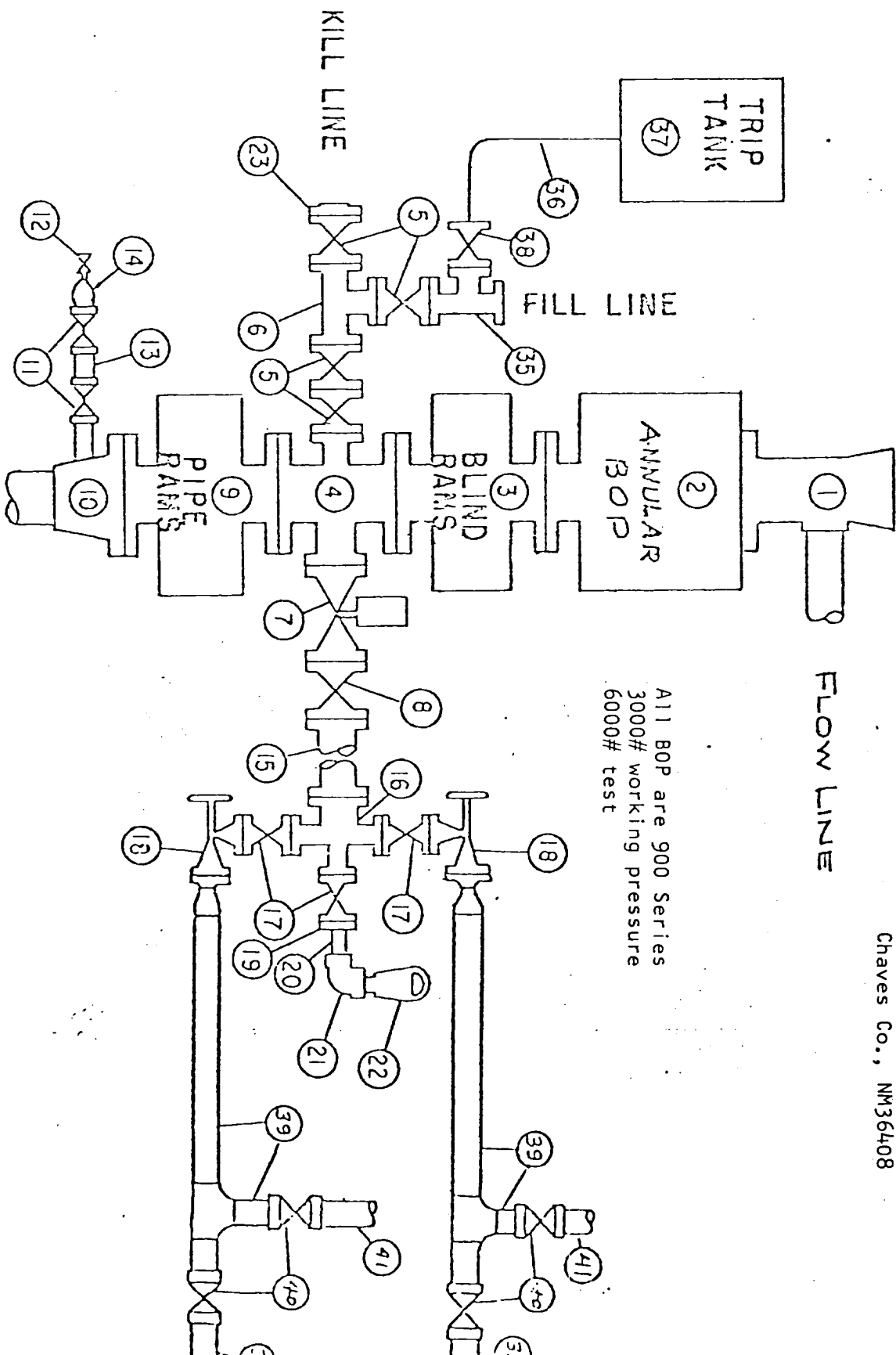

All BOP are 900 Series
3000# working pressure
6000# test

9/15/73