

SEP 10 1982

30-005-61783
Form C-101
Revised 10-1-78

NO. OF COPIES RECEIVED	
DISTRIBUTION	
SANTA FE	
FILE	
U.S.G.S.	
LAND OFFICE	
OPERATOR	

O. C. D.
ARTESIA, OFFICE

APPLICATION FOR PERMIT TO DRILL, DEEPEN, OR PLUG BACK

1a. Type of Work

b. Type of Well

DRILL ☒ DEEPEN ☐ PLUG BACK ☐

OIL WELL ☐ GAS WELL ☒ OTHER ☐

SINGLE ZONE ☐ MULTIPLE ZONE ☐

2. Name of Operator
STEVENS OPERATING CORPORATION

3. Address of Operator
P. O. Box 2408, Roswell, New Mexico 88201

4. Location of Well

UNIT LETTER G LOCATED 1980 FEET FROM THE North LINE

AND 1980 FEET FROM THE East LINE OF SEC. 29 TWP. 7S RGE. 26E N14PM

5A. Indicate Type of Lease
STATE ☐ FEDERAL ☒

5. State Oil & Gas Lease No.

7. Unit Agreement Name

8. Name of Lease Name
Diamond "A"

9. Well No.
1

10. 11, 13 and 16, or Wildcat
Undesignated Abo

12. County
Chaves

11. Elevations (show whether DE, KT, etc.) 3574.9 GR	21A. Kind & Status Plug. Bond Statewide	21B. Drilling Contractor Horizon	22. Approx. Date Work will start October 4, 1982
---------------------------------------------------------	--------------------------------------------	-------------------------------------	-----------------------------------------------------

23. PROPOSED CASING AND CEMENT PROGRAM					
SIZE OF HOLE	SIZE OF CASING	WEIGHT PER FOOT	SETTING DEPTH	SACKS OF CEMENT	EST. TOP
11"	8 5/8"	23.0	800-700 ft.	Circulate to Surface	
7 5/8"	4 1/2"	10.5	4500 ft.	Circulate to Surface	

1. Drill 11" hole to 700 ft. set 8 5/8" casing, bring cement to surface.
2. Drill 7 7/8" hole to 4500 ft. top of Wolfcamp; run 4 1/2" casing if warranted.
3. Utilize a double ram blowout preventer below 700 ft.
4. Drill with water using a mud as hole conditions dictate. Gas is not dedicated.

APPROVAL VALID FOR 180 DAYS
PERMIT EXPIRES 3-24-83
UNLESS DRILLING UNDERWAY

ABOVE SPACE DESCRIBE PROPOSED PROGRAM; IF PROPOSAL IS TO DEEPEN OR PLUG BACK, GIVE DATA ON PRESENT PRODUCTIVE ZONE AND PROPOSED NEW PRODUCTIVE ZONE. GIVE BLOWOUT PREVENTER PROGRAM, IF ANY.

I hereby certify that the information above is true and complete to the best of my knowledge and belief.

Signed [Signature] Title Production Coordinator Date September 9, 1982

(This space for State Use)

APPROVED BY [Signature] TITLE OIL AND GAS INSPECTOR DATE SEP 24 1982

CONDITIONS OF APPROVAL, IF ANY:

* As Noted Above

Notify N.M.O.C.C. in sufficient time to witness cementing the 3 5/8" casing

NEW MEXICO OIL CONSERVATION COMMISSION
WELL LOCATION AND ACREAGE DEDICATION PLAT

Form C-10
Supersedes C-12H
Effective 1-1-65

All distances must be from the outer boundaries of the Section

Operator Stevens Operating Co.			Lease Diamond "A"		Well No. 1
Tract Letter G	Section 29	Township 7 South	Range 26 East	County Chaves	
Acreage For Lease (in Acres) Well					
1980 feet from the north line and		1980 feet from the east line			
Ground Level Elev. 3573.9'	Producing Formation Abo	Permit No. Undesignated Abo	Estimated Acreage 160 Acres		

1. Outline the acreage dedicated to the subject well by colored pencil or hatchure marks on the plat below.
2. If more than one lease is dedicated to the well, outline each and identify the ownership thereof (both as to working interest and royalty). **See Exhibit "A" of Operating Agreement - Attached**
3. If more than one lease of different ownership is dedicated to the well, have the interests of all owners been consolidated by communitization, unitization, force-pooling, etc?

☒ Yes ☐ No If answer is "yes," type of consolidation Joint Operating Agreement & Forced Pooling OCD Order R-7063

If answer is "no," list the owners and tract descriptions which have actually been consolidated (Use reverse side of this form if necessary.) _____

No allowable will be assigned to the well until all interests have been consolidated (by communitization, unitization, forced-pooling, or otherwise) or until a non-standard unit, eliminating such interests, has been approved by the Commission.

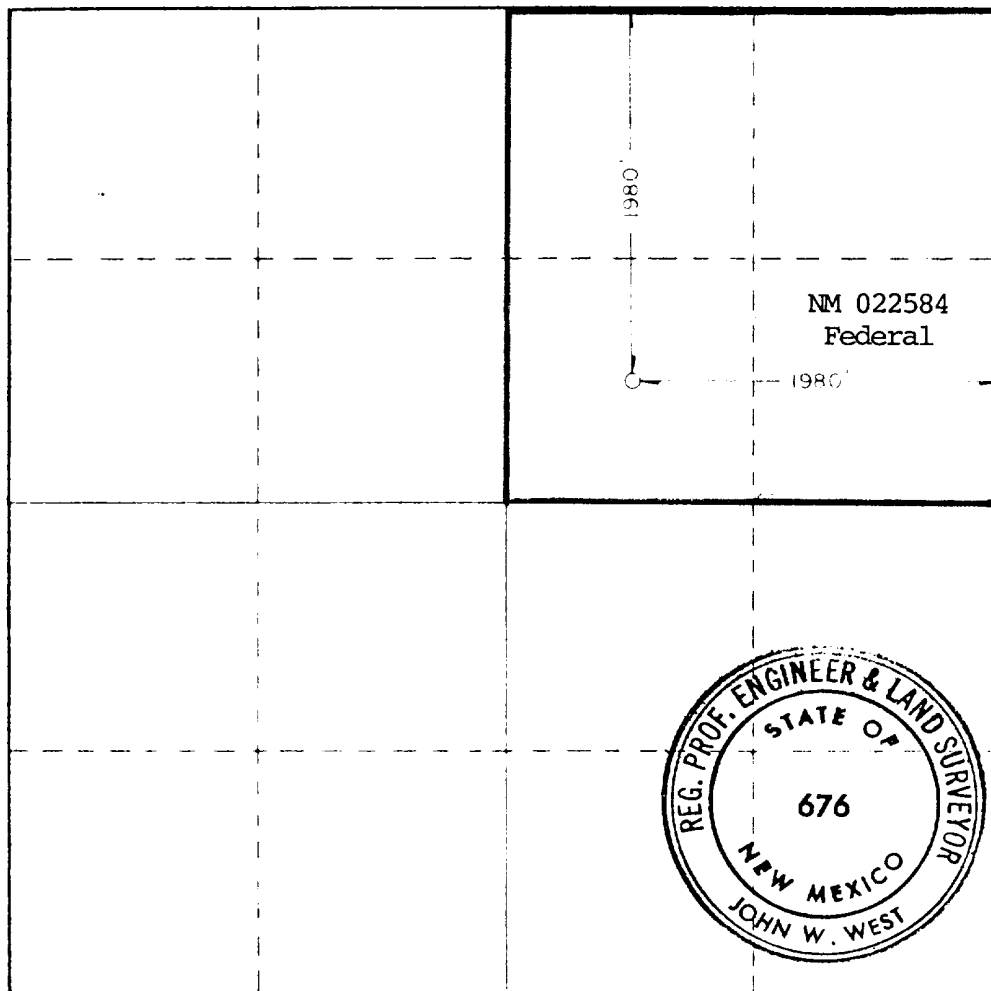

CERTIFICATION

I hereby certify that the information contained herein is true and complete to the best of my knowledge and belief.

Pat Thompson
Name

Pat Thompson
Position

Production Coordinator

Company

Stevens Operating Corporation

Date

9-14-82

I hereby certify that the well location shown on this plat was plotted from field notes of actual surveys made by me or under my supervision, and that the same is true and correct to the best of my knowledge and belief.

Date of Survey
6-7-82

Registered Professional Engineer
and Land Surveyor

John W. West

Certificate No. **JOHN W. WEST 676**
PATRICK A. ROMERO 6863
Ronald J. Eidson 3239

330 660 990 1320 1650 1980 2310 2640 2970 3300 3630 3960 4290 4620 4950 5280 5610 5940 6270 6600 6930 7260 7590 7920 8250 8580 8910 9240 9570 9900

EXHIBIT "A"

ATTACHED TO AND MADE A PART OF OPERATING AGREEMENT
DATED March 12, 1982
BY AND BETWEEN STEVENS OPERATING CORPORATION AS "OPERATOR"
AND THE HEREIN LISTED PARTIES AS "NON-OPERATORS"

I. 1. Lands Subject to Agreement:

Township 7 South, Range 26 East, NMPM
Section 29: NE/4
Containing 160.00 acres more or less
Chaves County, New Mexico

2. Depth Restriction:

Drill to a depth of 4500'

3. Drilling Unit for First Well:

SE $\frac{1}{4}$ NE $\frac{1}{4}$ of Section 29

II. Percent Interest of Parties Under the Agreement:

	<u>ACRES</u>	<u>% OF UNIT</u>
STEVENS OIL COMPANY	21.9140625	13.6962890
RIO PETROL, INC.	13.1484375	8.2177734
ROBERT R. WALKER	14.6093750	9.1308593
JOHN D. CADIGAN	1.4609375	.9130859
CURTIS STEVENS	7.3046875	4.5654297
CORONA OIL COMPANY	30.0000000	18.7500000
MTS LIMITED PARTNERSHIP	30.0000000	18.7500000
YATES PETROLEUM CORPORATION	29.0937500	18.1835938
ABO PETROLEUM CORPORATION	4.1562500	2.5976563
YATES DRILLING COMPANY	4.1562500	2.5976563
MARTIN YATES III	4.1562500	2.5976563
	<u>160.0000000</u>	<u>100.0000000%</u>

III. Leasehold Interest of Each Party:

1. Lessor:	United States
Present Lessee:	Sun Oil Company (Stevens Operating Corporation Farm-in)
Serial No. of Lease	NM-022584
Expiration Date:	HBP
Description:	<u>Township 7 South, Range 26 East, NMPM</u> <u>Section 29: SE/4NE/4</u> Containing 40 acres more or less
2. Lessor:	Diamond "A" Cattle Co.
Present Lessee:	Stevens Oil Company
Serial No. of Lease:	Fee
Expiration Date:	May 29, 1984
Description:	<u>Township 7 South, Range 26 East, NMPM</u> <u>Section 29: All that part lying west</u> <u>of the center line of the Pecos River</u> <u>in the W/2NE/4</u> Containing 73.75 acres more or less

Diamond "A" #1

3. Lessor: Everett Land and Cattle Company
a New Mexico Corporation
- Present Lessee: Yates Petroleum Corporation 70%
Yates Drilling Company 10%
ABO Petroleum Corporation 10%
Martin Yates III 10%
- Serial No. of Lease: Fee
- Expiration Date: October 28, 1989
- Description: Township 7 South, Range 26 East, NMPM
Section 29: N/2NE/4 & SW/4NE/4
Containing 120 acres more or less
4. Lessor: Laura B. Lodewick, John W. Lodewick,
Richard B. Lodewick, and Patricia
Lodewick
- Present Lessee: MTS Limited Partnership
Corona Oil Company
- Serial No. of Lease: Fee
- Expiration Date: November 6, 1985
- Description: Township 7 South, Range 26 East, NMPM
Section 29: N/2NE/4 & SW/4NE/4
Containing 120 acres more or less
5. Lessor: Carolyn Clark Wiggin and Farris Clark
Hignett and Edythe M. Clark
- Present Lessee: MTS Limited Partnership
Corona Oil Company
- Serial No. of Lease: Fee
- Expiration Date: November 7, 1985
- Description: Township 7 South, Range 26 East, NMPM
Section 29: N/2NE/4 & SW/4NE/4
Containing 120 acres more or less
6. Lessor: The Robert L. Nobel Trust, by William
M. Nobel and Robert L. Nobel, Jr.,
Company Trustees
- Present Lessee: MTS Limited Partnership
Corona Oil Company
- Serial No. of Lease: Fee
- Expiration Date: October 7, 1985
- Description: Township 7 South Range 26 East, NMPM
Section 29: N/2NE/4 & SW/4NE/4
Containing 120 acres more or less