

STATE OF NEW MEXICO
ENERGY AND MINERALS DEPARTMENT

OIL CONSERVATION DIVISION

Form C-101
Revised 10-1-78

NO. OF COPIES RECEIVED	
DISTRIBUTION	
SANTA FE	<input checked="" type="checkbox"/>
FILE	<input checked="" type="checkbox"/>
U.S.G.S.	<input checked="" type="checkbox"/>
LAND OFFICE	<input checked="" type="checkbox"/>
OPERATOR	<input checked="" type="checkbox"/>

SANTA FE, NEW MEXICO 87501

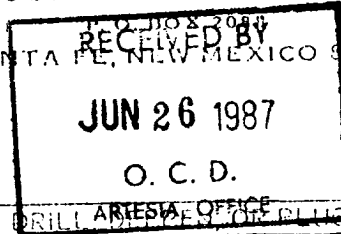

5A. Indicate Type of Lease
STATE ☒ FEDERAL ☐
5. State Oil & Gas Lease No.
LG 4920

APPLICATION FOR PERMIT TO DRILL OR RE-ENTER OF PLUG BACK

1a. Type of Work DRILL <input type="checkbox"/> DEEPEN <input type="checkbox"/> PLUG BACK <input checked="" type="checkbox"/>		7. Unit Agreement Name
b. Type of Well OIL WELL <input type="checkbox"/> GAS WELL <input checked="" type="checkbox"/> OTHER Re-Completion <input type="checkbox"/> SINGLE ZONE <input type="checkbox"/> MULTIPLE ZONE <input type="checkbox"/>		8. Farm or Lease Name Ibis XU State
2. Name of Operator Yates Petroleum Corporation		9. Well No. 1
3. Address of Operator 105 South 4th St., Artesia, NM 88210		10. Field and Pool, or Wildcat Wildcat
4. Location of Well UNIT LETTER <u>A</u> LOCATED <u>660</u> FEET FROM THE <u>North</u> LINE AND <u>990</u> FEET FROM THE <u>East</u> LINE OF SEC. <u>23</u> TWP. <u>9S</u> RGE. <u>26E</u> T14N R10E		12. County Chaves
11. Elevations (Show whether D.F., K.T., etc.) 3794.8' GR		13. Proposed Depth 6025'
21A. Kind & Status Plug. Bond Blanket		14A. Formation Wolfcamp
21B. Drilling Contractor		20. History of C.T. Pulling Unit
22. Approx. Date Work will start		

PROPOSED CASING AND CEMENT PROGRAM

SIZE OF HOLE	SIZE OF CASING	WEIGHT PER FOOT	SETTING DEPTH	SACKS OF CEMENT	EST. TOP
14-3/4"	10-3/4"	40.5#	990'	700 sx (in place)	
7-7/8"	4-1/2"	9.5 & 10.5#	6005'	910 sx (in place)	

Propose to abandon interval 5896-5910' by setting CIBP at 5850' and cap w/35' cement.
Wolfcamp intervals 5220-45' and 5410-20' will be individually perforated and acidized
as needed to establish production.

IN ABOVE SPACE DESCRIBE PROPOSED PROGRAM; IF PROPOSAL IS TO DEEPEN OR PLUG BACK, GIVE DATA ON PRESENT PRODUCTIVE ZONE AND PROPOSED NEW PRODUCTIVE ZONE; GIVE PLUGGING PREVENTER PROGRAM, IF ANY.

I hereby certify that the information above is true and complete to the best of my knowledge and belief.

Signed Les A. Clements Title Production Supervisor Date 6/26/87

(This space for State Use)

Original Signed By
Les A. Clements

APPROVED BY _____ TITLE _____ DATE _____
Supervisor District II

CONDITIONS OF APPROVAL, IF ANY:

JUN 30 1987

OIL CONSERVATION DIVISION

STATE OF NEW MEXICO
ENERGY AND MINERALS DEPARTMENTP. O. BOX 2088
SANTA FE, NEW MEXICO 87501Form C-102
Revised 10-1-78

All distances must be from the outer boundaries of the Section.

Operator YATES PETROLEUM CORPORATION		Lease IBIS "XU" STATE		Well No. 1			
Unit Letter A	Section 23	Township 9 South	Range 26 East	County Chaves			
Actual Footage Location of Well:							
660	feet from the	North	line and	990	feet from the	East	line
Ground Level Elev. 3794.8' GR	Producing Formation Wolfcamp		Pool Wildcat -	Dedicated Acreage: 320			Acres

1. Outline the acreage dedicated to the subject well by colored pencil or fracture marks on the plat below.
2. If more than one lease is dedicated to the well, outline each and identify the ownership thereof (both as to working interest and royalty).
3. If more than one lease of different ownership is dedicated to the well, have the interests of all owners been consolidated by communitization, unitization, force-pooling, etc?

☐ Yes ☐ No If answer is "yes," type of consolidation _____

If answer is "no," list the owners and tract descriptions which have actually been consolidated. (Use reverse side of this form if necessary.) _____

No allowable will be assigned to the well until all interests have been consolidated (by communitization, unitization, forced-pooling, or otherwise) or until a non-standard unit, eliminating such interests, has been approved by the Division.

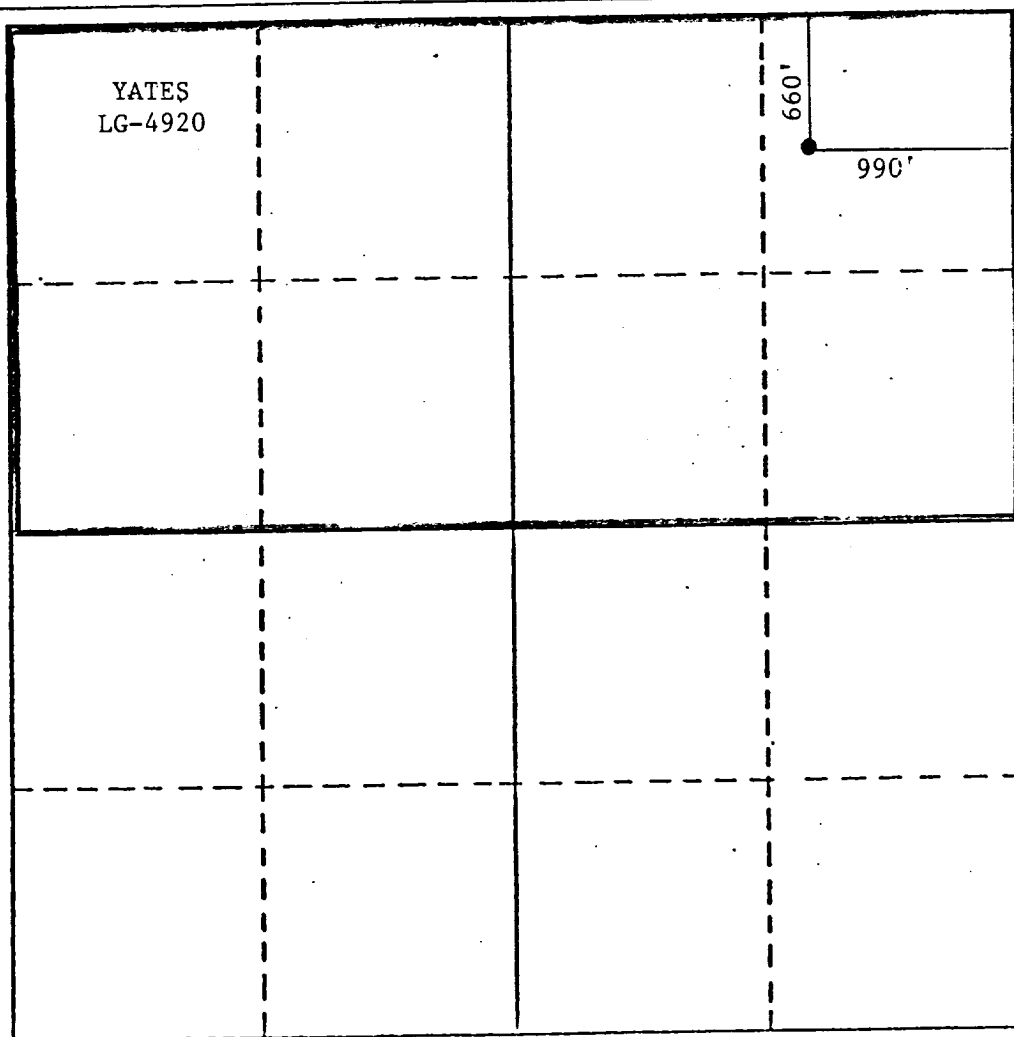

CERTIFICATION

I hereby certify that the information contained herein is true and complete to the best of my knowledge and belief.

Name

Juanita Goodlett

Position

Production Supervisor

Company

Yates Petroleum Corporation

Date

6-26-87

I hereby certify that the well location shown on this plat was plotted from field notes of actual surveys made by me or under my supervision, and that the same is true and correct to the best of my knowledge and belief.

REFER TO ORIGINAL PLAT

Date Surveyed dated 8/24/83

Registered Professional Engineer
and/or Land Surveyor

Certificate No.

0 330 660 990 1320 1650 1980 2310 2640 2000 1500 1000 500 0