

OIL CONSERVATION DIVISION

STATE OF NEW MEXICO
ENERGY AND MINERALS DEPARTMENTP. O. BOX 2088
SANTA FE, NEW MEXICO 87501Form C-102
Revised 10-1-78

All distances must be from the outer boundaries of the Section.

Operator JOHN A. YATES, JR., OIL OPERATOR			Lease COMANCHE "PO" FEDERAL		Well No. 2-Y
Unit Letter D	Section 26	Township 10S	Range 25E	County Chaves	
Actual Footage Location of Well: 990 feet from the North line and 960 feet from the West line					
Ground Level Elev. 3767.5'	Producing Formation YESO		Pool WILDCAT	Dedicated Acreage: 40 Acres	

1. Outline the acreage dedicated to the subject well by colored pencil or hachure marks on the plat below.
2. If more than one lease is dedicated to the well, outline each and identify the ownership thereof (both as to working interest and royalty).
3. If more than one lease of different ownership is dedicated to the well, have the interests of all owners been consolidated by communitization, unitization, force-pooling, etc?

☐ Yes ☐ No If answer is "yes," type of consolidation _____

If answer is "no," list the owners and tract descriptions which have actually been consolidated. (Use reverse side of this form if necessary.) _____

No allowable will be assigned to the well until all interests have been consolidated (by communitization, unitization, forced-pooling, or otherwise) or until a non-standard unit, eliminating such interests, has been approved by the Division.

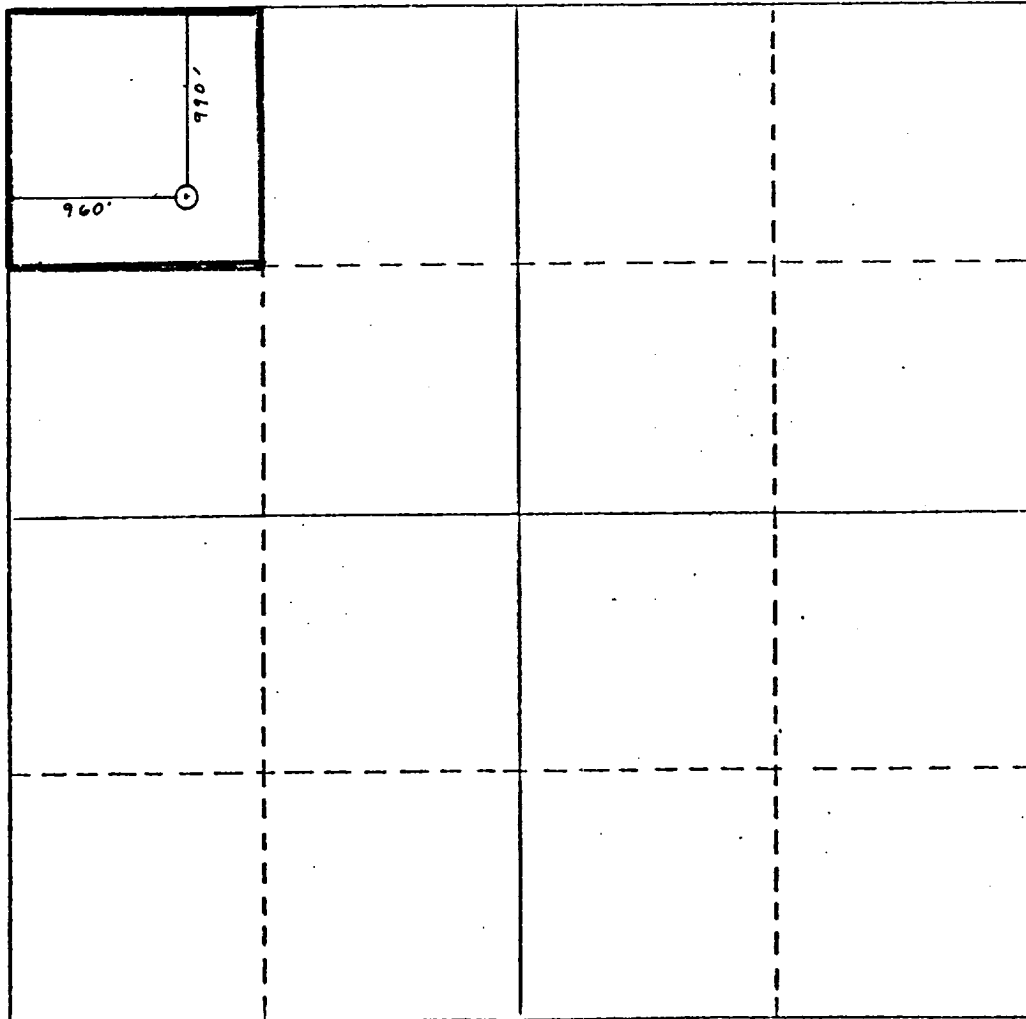

CERTIFICATION

I hereby certify that the information contained herein is true and complete to the best of my knowledge and belief.

Clifton R. May

Name

Clifton R. May

Position

Regulatory Agent

Company

John A. Yates, Jr., Oil Operator

Date

December 4, 1985

I hereby certify that the well location shown on this plat was plotted from field notes of actual surveys made by me or under my supervision, and that the same is true and correct to the best of my knowledge and belief.

November 7, 1985

Date Surveyed

Registered Professional Land Surveyor
and/or Licensed Surveyor

HERSCHEL

3640

Certificate No. **3640**

REGISTERED LAND SURVEYOR

0 330 660 990 1320 1650 1980 2310 2640 2970 3300 3630 3960 4290 4620 4950 5280 5610 5940 6270 6600