

NO. OF COPIES RECEIVED	
DISTRIBUTION	
SANTA FE	<input checked="" type="checkbox"/>
FILE	<input checked="" type="checkbox"/>
U.S.G.S.	<input checked="" type="checkbox"/>
LAND OFFICE	<input checked="" type="checkbox"/>
OPERATOR	<input checked="" type="checkbox"/>

RECEIVED BY O. BOX 2088
SANTA FE, NEW MEXICO 87501
JUL 18 1986
O. C. D.
ARTESIA OFFICE

5A. Indicate Type of Lease
STATE FEE

5. State Oil & Gas Lease No.

APPLICATION FOR PERMIT TO DRILL, DEEPEN, OR PLUG BACK

1a. Type of Work DRILL <input checked="" type="checkbox"/> DEEPEN <input type="checkbox"/> PLUG BACK <input type="checkbox"/>		7. Unit Agreement Name
b. Type of Well OIL WELL <input checked="" type="checkbox"/> GAS WELL <input type="checkbox"/> OTHER <input type="checkbox"/> SINGLE ZONE <input type="checkbox"/> MULTIPLE ZONE <input type="checkbox"/>		8. Farm or Lease Name DeKalb
2. Name of Operator Cibola Energy Corporation		9. Well No. 1
3. Address of Operator P. O. Box 1668, Albuquerque, New Mexico 87103		10. Field and Pool, or Wildcat LE Ranch San Andre
4. Location of Well UNIT LETTER <u>G</u> LOCATED <u>1650</u> FEET FROM THE <u>North</u> LINE AND <u>1650</u> FEET FROM THE <u>East</u> LINE OF SEC. <u>30</u> TWP. <u>10S</u> RGE. <u>28E</u> NMPM		12. County Chaves
19. Proposed Depth 2300'		19A. Formation San Andres
20. Rotary or C.T. Rotary		
21. Elevations (show whether DF, RT, etc.) 3738.7	21A. Kind & Status Plug. Bond One Well	21B. Drilling Contractor Rio Grande Drilling
22. Approx. Date Work will start July 25, 1986		

PROPOSED CASING AND CEMENT PROGRAM

SIZE OF HOLE	SIZE OF CASING	WEIGHT PER FOOT	SETTING DEPTH	SACKS OF CEMENT	EST. TOP
12 1/4"	8 5/8"	23#	300'	200 sx	surface
8"	4 1/2"	9.5#	2300'	125 sx	1500'

We plan to drill a 12 1/4" hole to 300' and set 8 5/8" casing, cementing with 200 sx Class C Cement. WOC 18 hrs. Then we will drill an 8" hole to TD (2300'). We will run 4 1/2" casing depending on the outcome of the logs.

APPROVAL VALID FOR 180 DAYS
PERMIT EXPIRES 1-25-87
UNLESS DRILLING UNDERWAY

Posted ID-1
NH-1 API
7-25-86

IN ABOVE SPACE DESCRIBE PROPOSED PROGRAM; IF PROPOSAL IS TO DEEPEN OR PLUG BACK, GIVE DATA ON PRESENT PRODUCTIVE ZONE AND PROPOSED NEW PRODUCTIVE ZONE. GIVE BLOWOUT PREVENTER PROGRAM, IF ANY.

I hereby certify that the information above is true and complete to the best of my knowledge and belief.

Signed Karen Arger Tweede Title Drilling Secretary Date 5/5/86

(This space for State Use)

APPROVED BY Les A. Clements TITLE Supervisor District II DATE JUL 25 1986

CONDITIONS OF APPROVAL, IF ANY:

NEW MEXICO OIL CONSERVATION COMMISSION
WELL LOCATION AND ACREAGE DEDICATION PLAT

Form No. 1
Supersedes O.C.C. Form No. 1
Effective 1/1/81

All distances must be from the outer boundaries of the Section

Section		Twp.		Rang.	
30		10 South		16 East	
Section		Twp.		Rang.	
37 1/2 feet		San Andres		L.E. Ranch San Andres	
Section		Twp.		Rang.	
37 1/2 feet		San Andres		L.E. Ranch San Andres	

- Outline the acreage dedicated to the subject well by colored pencil on the plat below.
- If more than one lease is dedicated to the well, outline each and identify the ownership thereof (both as to working interest and royalty).
- If more than one lease of different ownership is dedicated to the well, have the interests of all owners been consolidated by communitization, unitization, force-pooling, etc?

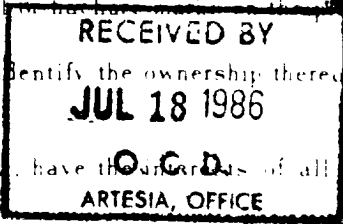

Yes No If answer is "yes," type of consolidation _____

If answer is "no," list the owners and tract descriptions which have actually been consolidated (Use reverse side of this form if necessary.) All leases held by operator and participating parties.

No allowable will be assigned to the well until all interests have been consolidated (by communitization, unitization, force-pooling, or otherwise) or until a non-standard unit, eliminating such interests, has been approved by the Commission.

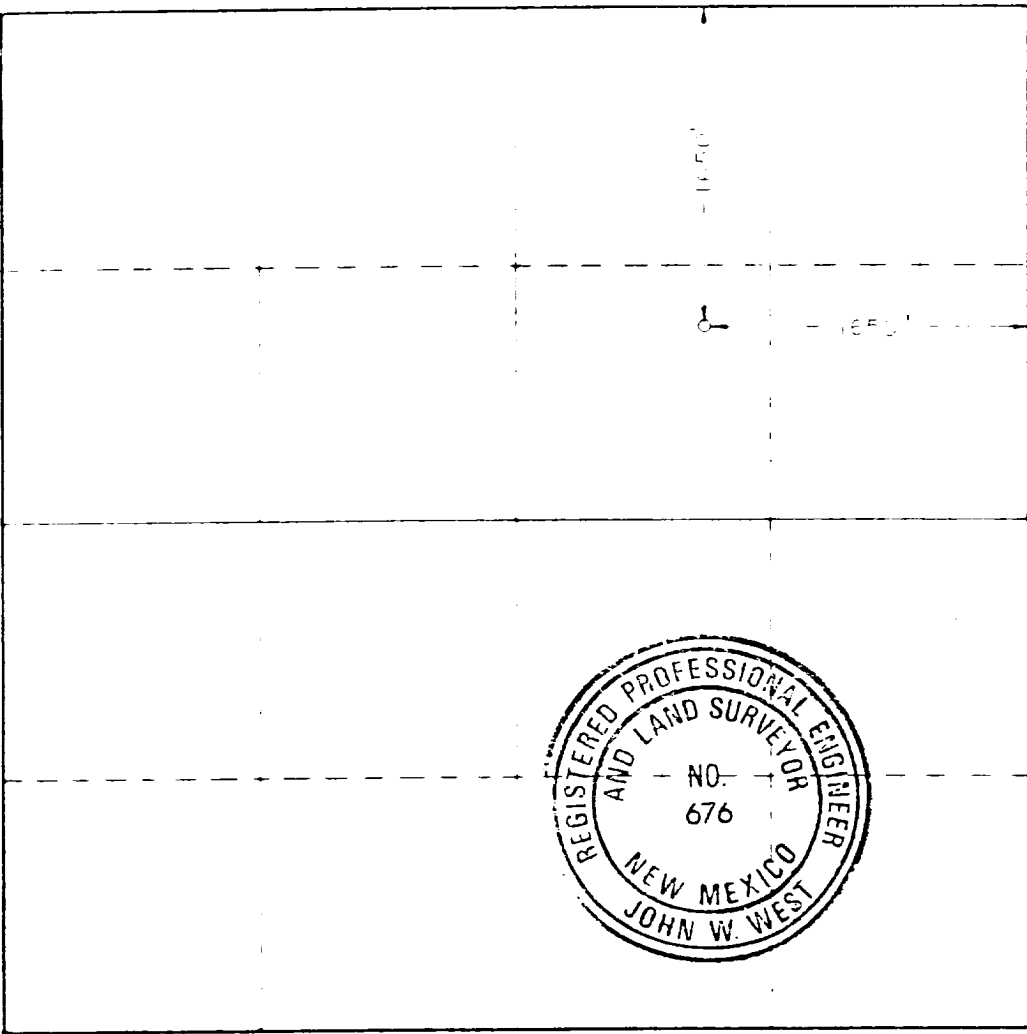

CERTIFICATION

I hereby certify that the information contained herein is true and complete to the best of my knowledge and belief.

Karen Azar

Karen Azar

Drlg Secretary

Cibola Energy Corp.

5/8/86

I hereby certify that the well location shown on this plat was plotted from field notes of actual surveys made by me or under my supervision, and that the same is true and correct to the best of my knowledge and belief.

Registered Professional Engineer
and Land Surveyor

John W. West

Certificate No. JOHN W. WEST, 676
RONALD J. EDSON, 3239