

NO. OF COPIES RECEIVED	
DISTRIBUTION	
SANTA FE	
FILE	
U.S.G.S.	
LAND OFFICE	
OPERATOR	

RECEIVED

NOV 30 '87

5A. Indicate Type of Lease
STATE FEE

5. State Oil & Gas Lease No.

APPLICATION FOR PERMIT TO DRILL, DEEPEN, OR PLUG BACK C. D.

1a. Type of Work ARTESIA, OFFICE		7. Unit Agreement Name
b. Type of Well DRILL <input checked="" type="checkbox"/> DEEPEN <input type="checkbox"/> PLUG BACK <input type="checkbox"/> OIL WELL <input checked="" type="checkbox"/> GAS WELL <input type="checkbox"/> OTHER <input type="checkbox"/> SINGLE ZONE <input checked="" type="checkbox"/> MULTIPLE ZONE <input type="checkbox"/>		8. Farm or Lease Name Alma Shields
2. Name of Operator N. Dale Nichols		9. Well No. 8
3. Address of Operator P.O. Box 1972, Midland, Texas 79702		10. Field and Pool, or Wildcat ACME (San Andres)
4. Location of Well UNIT LETTER <u>M</u> LOCATED <u>330</u> FEET FROM THE <u>South</u> LINE AND <u>990</u> FEET FROM THE <u>West</u> LINE OF SEC. <u>33</u> TWP. <u>7S</u> RGE. <u>28E</u> NMPM		12. County Chaves
19. Proposed Depth 1980'		19A. Formation San Andres
20. Rotary or C.T. Rotary		
21. Elevations (show whether DF, KT, etc.) 4002' GL	21A. Kind & Status Plug. Bond Blanket	21B. Drilling Contractor Self
		22. Approx. Date Work will start 12-10-87

23.

PROPOSED CASING AND CEMENT PROGRAM

SIZE OF HOLE	SIZE OF CASING	WEIGHT PER FOOT	SETTING DEPTH	SACKS OF CEMENT	EST. TOP
9 7/8"	7 5/8"	26.40	300'	125	Circulate
6 3/4"	5 1/2"	17.00	1920'	100	1450'
4 3/4"	Open-Hole	-	1920 - 1980	-	-

12-4-87

NO UNDERWAY

IN ABOVE SPACE DESCRIBE PROPOSED PROGRAM; IF PROPOSAL IS TO DEEPEN OR PLUG BACK, GIVE DATA ON PRESENT PRODUCTIVE ZONE AND PROPOSED NEW PRODUCTIVE ZONE. GIVE BLOWOUT PREVENTER PROGRAM, IF ANY.

I hereby certify that the information above is true and complete to the best of my knowledge and belief.

Signed N. Dale Nichols Title Operator Date 11-27-87

(This space for State Use)

Original Signed By
Mike Williams

APPROVED BY _____ TITLE _____ DATE NOV 30 1987
Oil & Gas Inspector

CONDITIONS OF APPROVAL, IF ANY:

All distances must be from the outer boundaries of the Section

Operator N. DALE NICHOLS			Lease ALMA SHIELDS		Well No. 8
Unit Letter M	Section 33	Township 7S	Range 27E	County CHAVES	
Actual Postage Location of Well: 330 feet from the SOUTH line and 990 feet from the WEST line					
Ground Level Elev. 4002	Producing Formation San Andres		Pool ACME (San Andres)		Dedicated Acreage: 40.0 Acres

1. Outline the acreage dedicated to the subject well by colored pencil or hachure marks on the plat below.
2. If more than one lease is dedicated to the well, outline each and identify the ownership thereof (both as to working interest and royalty).
3. If more than one lease of different ownership is dedicated to the well, have the interests of all owners been consolidated by communitization, unitization, force-pooling, etc?

Yes No If answer is "yes," type of consolidation _____

If answer is "no," list the owners and tract descriptions which have actually been consolidated. (Use reverse side of this form if necessary.) _____

No allowable will be assigned to the well until all interests have been consolidated (by communitization, unitization, forced-pooling, or otherwise) or until a non-standard unit, eliminating such interests, has been approved by the Division

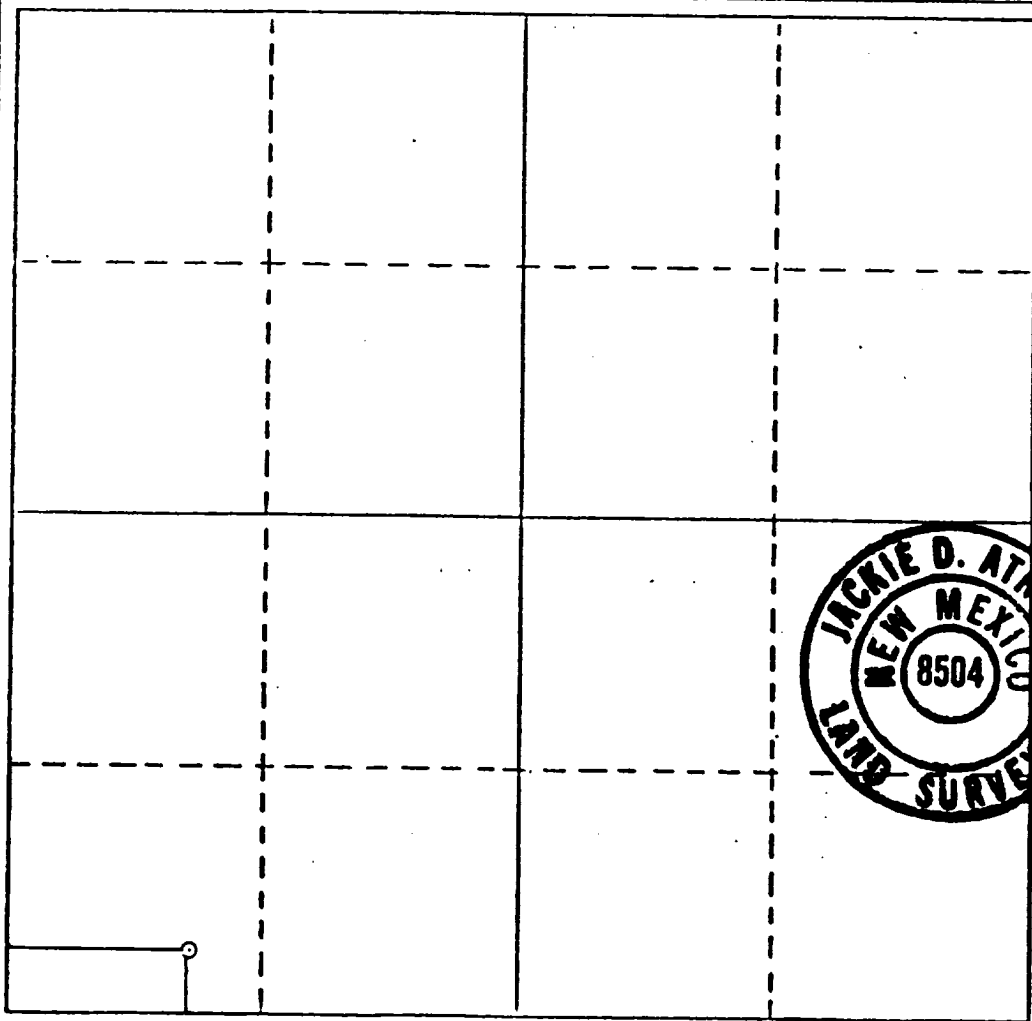

CERTIFICATION

I hereby certify that the information contained herein is true and complete to the best of my knowledge and belief.

N. Dale Nichols

Name
Operator
Position
N. Dale Nichols
Company
11-27-87
Date

I hereby certify that the well location shown on this plat was plotted from field notes of actual surveys made by me or under my supervision, and that the same is true and correct to the best of my knowledge and belief.

NOV. 16, 1987

Date Surveyed
Jackie D. Atkins
Registered Professional Engineer
and/or Land Surveyor

Certificate No.
PE-6403 LS-8504

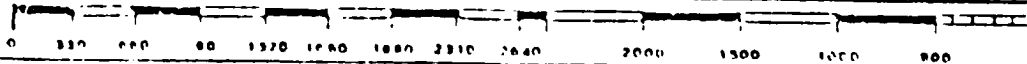

N. DALE NICHOLS

BOX 1972
MIDLAND, TEXAS 79702

REGAN BLOWOUT PREVENTOR

3000 # Test

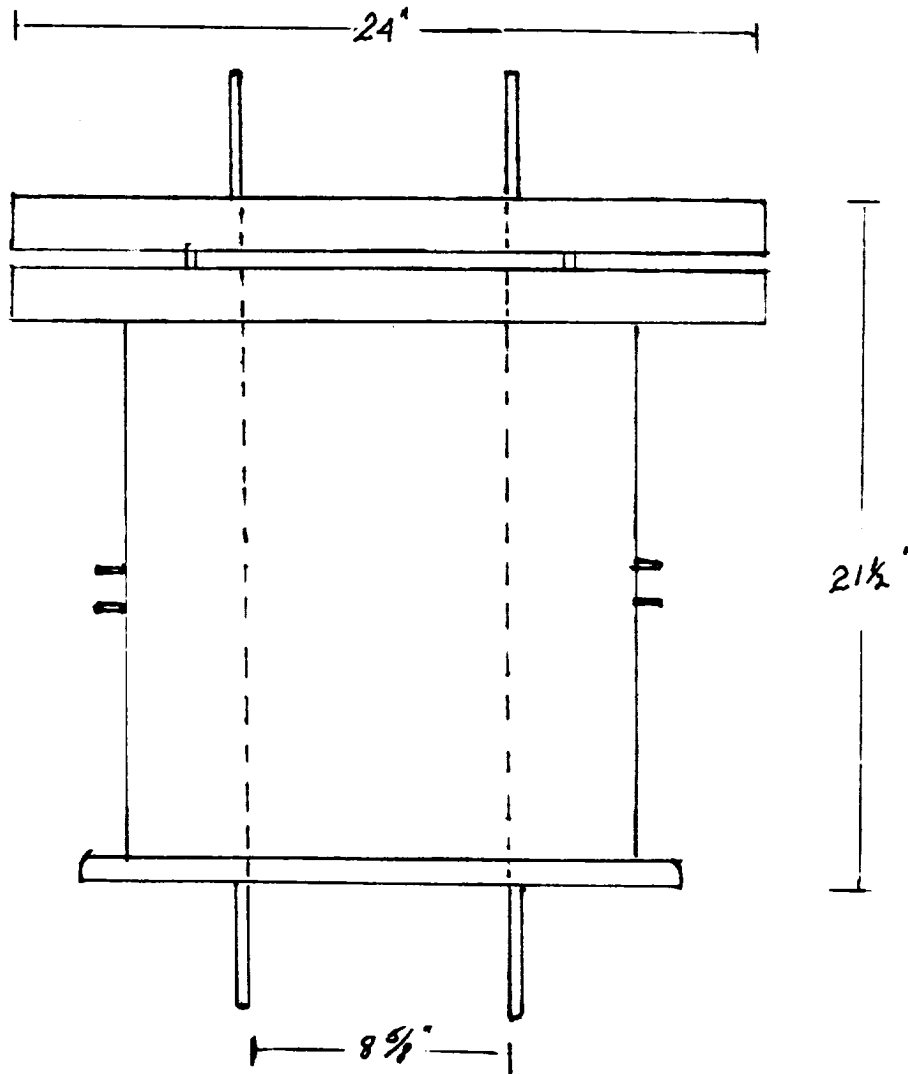

Operator N. Dale Nichols

Lease Alma Shields

Well 8