

NO. OF COPIES RECEIVED	
DISTRIBUTION	
SANTA FE	<input checked="" type="checkbox"/>
FILE	<input checked="" type="checkbox"/>
U.S.G.S.	<input checked="" type="checkbox"/>
LAND OFFICE	<input checked="" type="checkbox"/>
OPERATOR	<input checked="" type="checkbox"/>

RECEIVED
MAY 20 '88

O. C. D.
ARTESIA, OFFICE

5A. Indicate Type of Lease
STATE ☒ FEE ☐
5. State Oil & Gas Lease No.
L-6853

APPLICATION FOR PERMIT TO DRILL, DEEPEN, OR PLUG BACK

1a. Type of Work
b. Type of Well
OIL WELL ☐ GAS WELL ☒ OTHER ☐
2. Name of Operator
ELK OIL COMPANY
3. Address of Operator
Post Office Box 310, Roswell, New Mexico 88202-0310
4. Location of Well
UNIT LETTER N LOCATED 660 FEET FROM THE South LINE
AND 1980 FEET FROM THE West LINE OF SEC. 24 TWP. 9S RGE. 26E NMPM
19. Proposed Depth
6250
19A. Formation
Fusselman
20. Rotary or C.T.
Rotary
21. Elevations (show whether DF, RT, etc.)
3803' GR
21A. Kind & Status Plug. Bond
Blanket
21B. Drilling Contractor
Walters
22. Approx. Date Work will start
May 25, 1988

7. Unit Agreement Name
8. Farm or Lease Name
Runyan State
9. Well No.
3
10. Field and Pool, or Wildcat
Wildcat
Und. Poor Ranch Fusselman
12. County
Chaves

23. PROPOSED CASING AND CEMENT PROGRAM

SIZE OF HOLE	SIZE OF CASING	WEIGHT PER FOOT	SETTING DEPTH	SACKS OF CEMENT	EST. TOP
12 3/4	8 5/8	23	950	500 sxs	Circ.
7 7/8	5 1/2	15.5	6250	600 sxs	4200'

BLOWOUT PREVENTION PROGRAM

SEE ATTACHED

POST 10-1
N-8 H-12
527-88
180 DAYS
11/23/88
STILL BEING UNDERWAY

This acreage is dedicated to Transwestern Pipeline Company.

IN ABOVE SPACE DESCRIBE PROPOSED PROGRAM; IF PROPOSAL IS TO DEEPEN OR PLUG BACK, GIVE DATA ON PRESENT PRODUCTIVE ZONE AND PROPOSED NEW PRODUCTIVE ZONE. GIVE BLOWOUT PREVENTION PROGRAM, IF ANY.

I hereby certify that the information above is true and complete to the best of my knowledge and belief.

Signed _____ Title President Date May 20, 1988

(This space for State Use)
Original Signed By
Mike Williams
APPROVED BY _____ TITLE _____ DATE MAY 23 1988
CONDITIONS OF APPROVAL, IF ANY:

OIL CONSERVATION DIVISION

STATE OF NEW MEXICO
ENERGY AND MINERALS DEPARTMENTP. O. BOX 2088
SANTA FE, NEW MEXICO 87501Form C-102
Revised 10-1-78

All distances must be from the outer boundaries of the Section.

Operator ELK OIL Co.		Lease RUNYAN STATE		Well No. #3
Unit Letter N	Section 24	Township 9 SOUTH	Range 26 EAST	County CHAVES
Actual Footage Location of Well: 660 feet from the SOUTH line and 1980 feet from the WEST line				
Ground Level Elev. 3803	Producing Formation Fusselman	Pool Und. Foot Ranch Fusselman	Dedicated Acreage: 320 Acres	

1. Outline the acreage dedicated to the subject well by colored pencil or hatchure marks on the plat below.
2. If more than one lease is dedicated to the well, outline each and identify the ownership thereof (both as to working interest and royalty).
3. If more than one lease of different ownership is dedicated to the well, have the interests of all owners been consolidated by communitization, unitization, force-pooling, etc?

☐ Yes ☐ No If answer is "yes," type of consolidation _____

If answer is "no," list the owners and tract descriptions which have actually been consolidated. (Use reverse side of this form if necessary.) _____

No allowable will be assigned to the well until all interests have been consolidated (by communitization, unitization, forced-pooling, or otherwise) or until a non-standard unit, eliminating such interests, has been approved by the Division.

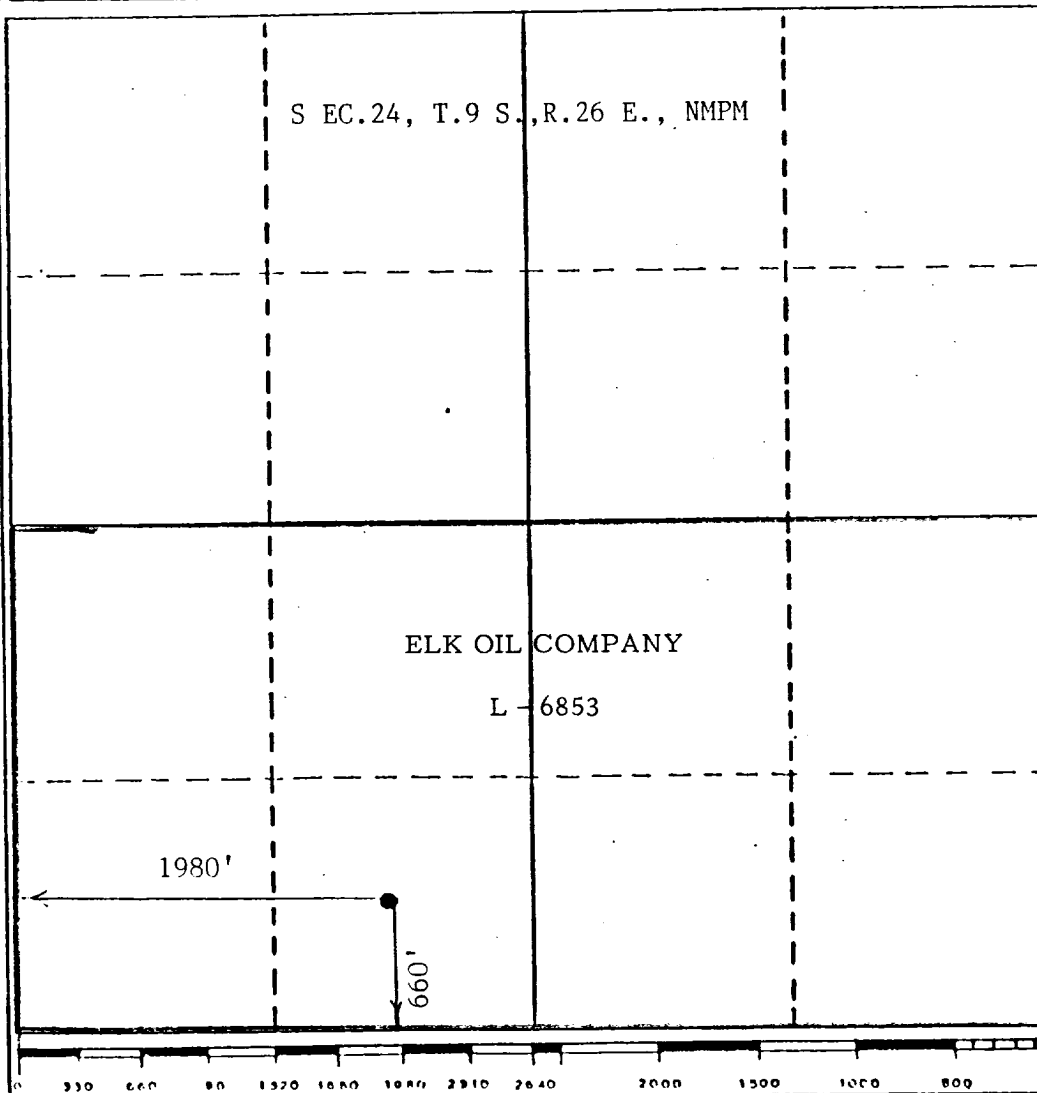

CERTIFICATION

I hereby certify that the information contained herein is true and complete to the best of my knowledge and belief.

Name
Joseph J. Kelly
Position
President
Company
ELK OIL COMPANY
Date
May 20, 1988

I hereby certify that the well location shown on this plat was plotted from field notes of actual surveys made by me or under my supervision, and that the same is true and correct to the best of my knowledge and belief.

Date Surveyed
MAY 19, 1988
Registered Professional Engineer
and/or Land Surveyor
John D. Jaquess
Certificate No. 6290
NEW MEXICO
L.S.

ELK OIL COMPANY
Runyan State #3
660' FSL, 1980' FWL
Section 24, Township 9 South, Range 26 East
Chaves County, New Mexico

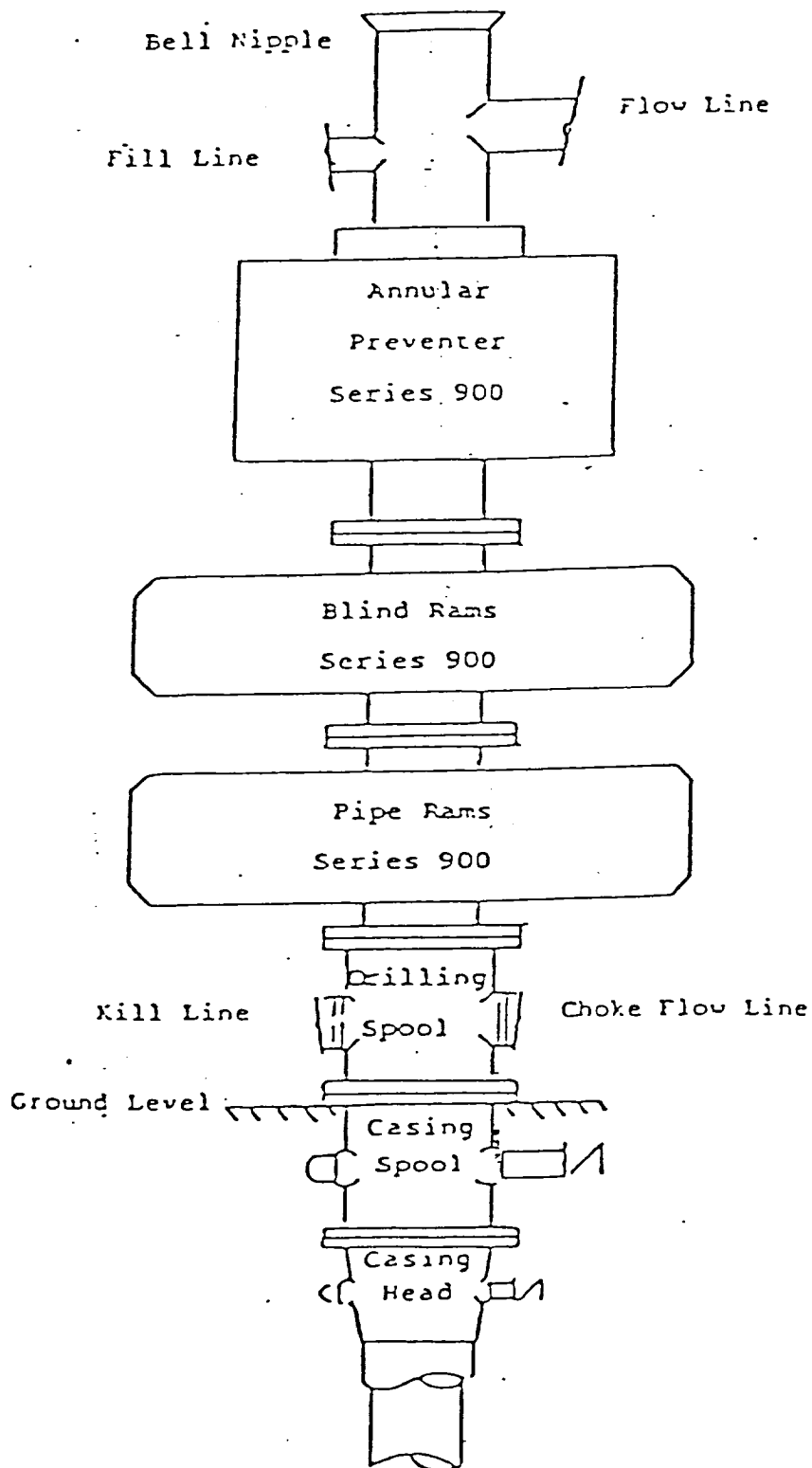

BLOWOUT PREVENTER STACK
3000# WP