

STATE OF NEW MEXICO
ENERGY AND MINERALS DEPARTMENT

NO. OF COPIES RECEIVED	
DISTRIBUTION	
SANTA FE	<input checked="" type="checkbox"/>
FILE	<input checked="" type="checkbox"/>
U.S.G.S.	
LAND OFFICE	<input checked="" type="checkbox"/>
OPERATOR	<input checked="" type="checkbox"/>

OIL CONSERVATION DIVISION

P. O. BOX 2088
SANTA FE, NEW MEXICO 87501

Form C-103
Revised 10-1-78

5a. Indicate Type of Lease
State ☒ Fee ☐

5. State Oil & Gas Lease No.
LG-5246

SUNDRY NOTICES AND REPORTS ON WELLS

(DO NOT USE THIS FORM FOR PROPOSALS TO DRILL OR TO DEEPEN OR PLUG BACK TO A RESERVOIR.
USE "APPLICATION FOR PERMIT -" (FORM C-101) FOR SUCH PROPOSALS.)

OIL WELL ☒ GAS WELL ☐ OTHER- ☐

1. Name of Operator
Yates Petroleum Corporation

OCT 04 '88

7. Unit Agreement Name

8. Farm or Lease Name
Pathfinder AFT State

2. Address of Operator
105 South Fourth Street - Artesia, NM 88210

O. C. D.
ARTESIA, OFFICE

9. Well No.
3

3. Location of Well
UNIT LETTER K 1650 FEET FROM THE South LINE AND 2310 FEET FROM

10. Field and Pool, or Wildcat
Wildcat

THE West LINE, SECTION 21 TOWNSHIP 10S RANGE 27E NMPM.

15. Elevation (Show whether DF, RT, GR, etc.)
3839.5' GR

12. County
Chaves

Check Appropriate Box To Indicate Nature of Notice, Report or Other Data
NOTICE OF INTENTION TO: SUBSEQUENT REPORT OF:

PERFORM REMEDIAL WORK ☐
TEMPORARILY ABANDON ☐
PULL OR ALTER CASING ☐
OTHER ☐

PLUG AND ABANDON ☐
CHANGE PLANS ☒
OTHER ☐

REMEDIAL WORK ☐
COMMENCE DRILLING OPNS. ☐
CASING TEST AND CEMENT JOBS ☐
OTHER ☐

ALTERING CASING ☐
PLUG AND ABANDONMENT ☐
OTHER ☐

7. Describe Proposed or Completed Operations (Clearly state all pertinent details, and give pertinent dates, including estimated date of starting any proposed work) SEE RULE 1103.

We propose to move the cable tool rig off the well and move a rotary rig on the well. We will continue to drill a 7-7/8" hole to our new proposed total depth of 7200' and test the Fusselman formation. If commercial, 5-1/2" 15.5# casing will be ran and cemented with adequate cover, perforated and stimulated as needed for production.

MUD PROGRAM: Brine to 4300', starch to TD

BOP PROGRAM: BOP's will be installed on the 8-5/8" casing and tested daily.

8. I hereby certify that the information above is true and complete to the best of my knowledge and belief.

SIGNED Clifton R. May

TITLE Permit Agent

DATE Oct. 4, 1988

Original Signed By
Mike Williams

APPROVED BY Mike Williams

TITLE

DATE OCT 6 1988

CONDITIONS OF APPROVAL, IF ANY:

**NEW MEXICO OIL CONSERVATION COMMISSION
WELL LOCATION AND ACREAGE DEDICATION PLAT**

Form C-102
Supersedes C-120
Effective 1-4-85

All distances must be from the outer boundaries of the Section.

Operator Yates Petroleum Corporation			Lease Pathfinder "AFT" State		Well No. 3
Unit Letter K	Section 21	Township 10 South	Range 27 East	County Chaves	
Actual Footage Location of Well: 1650 feet from the South line and 2310 feet from the West line					
Ground Level Elev. 3839.5	Producing Formation FUSSELMAN		Well WILDCAT		Dedicated Acreage 40 Acres

1. Outline the acreage dedicated to the subject well by colored pencil or hatchure marks on the plat below.
2. If more than one lease is dedicated to the well, outline each and identify the ownership thereof (both as to working interest and royalty).
3. If more than one lease of different ownership is dedicated to the well, have the interests of all owners been consolidated by communitization, unitization, force-pooling, etc?

☐ Yes ☐ No If answer is "yes," type of consolidation _____

If answer is "no," list the owners and tract descriptions which have actually been consolidated. (Use reverse side of this form if necessary.) _____

No allowable will be assigned to the well until all interests have been consolidated (by communitization, unitization, forced-pooling, or otherwise) or until a non-standard unit, eliminating such interests, has been approved by the Commission.

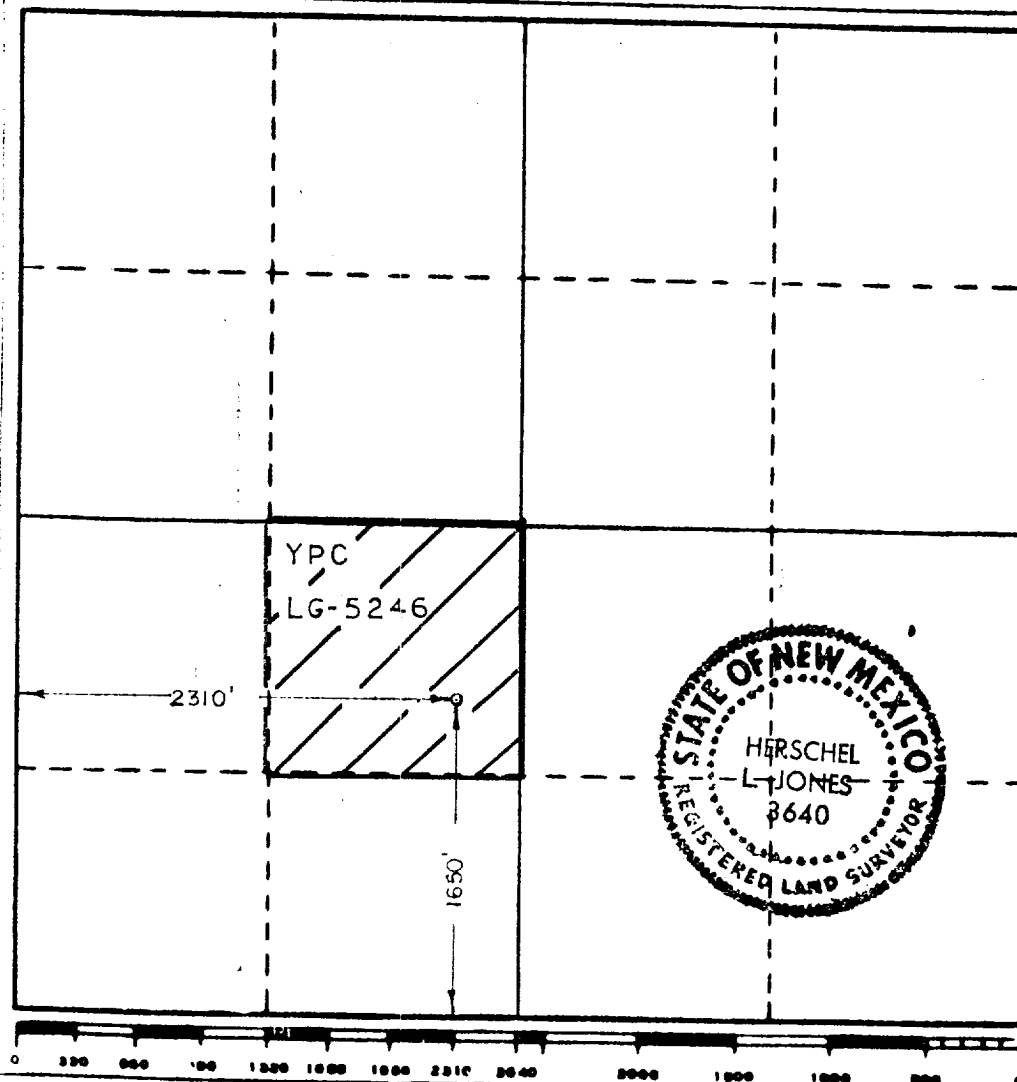

CERTIFICATION

I hereby certify that the information contained herein is true and complete to the best of my knowledge and belief.

Clifton R. May

Name
Clifton R. May

Position
Permit Agent

Company
Yates Petroleum Corporation

Date
October 4, 1988

I hereby certify that the well location shown on this plat was plotted from field notes of actual surveys made by me or under my supervision, and that the same is true and correct to the best of my knowledge and belief.

Date Surveyed
8/17/88

Registered Professional Engineer and/or Land Surveyor

Herschel L. Jones
Certificate No. **3640**

