

**MEXICO OIL CONSERVATION COMMISSION**  
**WELL LOCATION AND ACREAGE DEDICATION PLAT**

Form C-102  
 Supersedes C-128  
 Effective 1-1-65

**RECEIVED**

All distances must be from the outer boundaries of the Section

Operator <b>BHP Petroleum Company, Inc.</b>		Lease <b>Ervin Ranch State</b>		Well No. <b>1</b>	
Unit Letter <b>G</b>	Section <b>5</b>	Township <b>11 South</b>	Range <b>27 East</b>	County <b>Chaves O. C. D.</b>	
Actual Footage Location of Well: <b>1650</b> feet from the <b>south</b> line and <b>1650</b> feet from the <b>east</b> line				ARTESIA, OFFICE	
Ground Level Elev. <b>3697.4</b>	Producing Formation <b>Ordovician (Montoya)</b>	Pool <b>Wildcat</b>	Dedicated Acreage: <b>348</b> Acres		

1. Outline the acreage dedicated to the subject well by colored pencil or hachure marks on the plat below.
2. If more than one lease is dedicated to the well, outline each and identify the ownership thereof (both as to working interest and royalty).
3. If more than one lease of different ownership is dedicated to the well, have the interests of all owners been consolidated by communitization, unitization, force-pooling, etc?  
 Communitization agreement pending  
 State Land Office approval  
☒ Yes    ☐ No    If answer is "yes," type of consolidation \_\_\_\_\_

If answer is "no," list the owners and tract descriptions which have actually been consolidated. (Use reverse side of this form if necessary.) \_\_\_\_\_

No allowable will be assigned to the well until all interests have been consolidated (by communitization, unitization, forced-pooling, or otherwise) or until a non-standard unit, eliminating such interests, has been approved by the Commission.

DEDICATED ACREAGE 348 ac

Fee Lease

RI. - M.K. Rice

WI - BHP

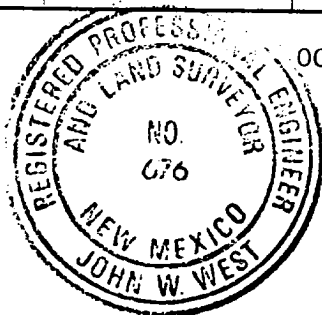
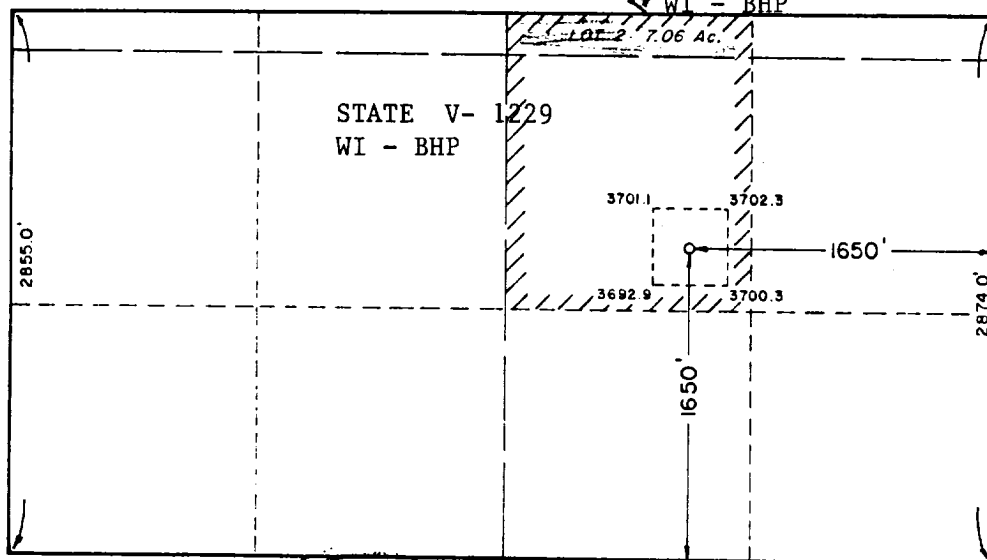

OCD ORDER NO. R-8728  
 CASE NO. 9461

Scale: 1" = 1000'

**AUG 16 1988**

**CERTIFICATION**

I hereby certify that the information contained herein is true and complete to the best of my knowledge and belief.

**Hal Crabb, III**

Name  
**Petroleum Engineer**  
 Position  
**BHP Petroleum Company Inc**  
 Company

Date **12/15/88**  
*Hal Crabb, III*

I hereby certify that the well location shown on this plat was plotted from field notes of actual surveys made by me or under my supervision, and that the same is true and correct to the best of my knowledge and belief.

Date Surveyed  
**August 11, 1988**

Registered Professional Engineer  
 and/or Land Surveyor

*John W. West*  
 Certificate No. **JOHN W. WEST 676**