

STATE OF NEW MEXICO
ENERGY AND MINERALS DEPARTMENT

OIL CONSERVATION DIVISION
P. O. BOX 2088
SANTA FE, NEW MEXICO 87501

30-005-62643
Form C-101
Revised 10-1-78

NO. OF COPIES RECEIVED	
DISTRIBUTION	
SANTA FE	<input checked="" type="checkbox"/>
FILE	<input checked="" type="checkbox"/>
U.S.G.S.	<input checked="" type="checkbox"/>
LAND OFFICE	<input checked="" type="checkbox"/>
OPERATOR	<input checked="" type="checkbox"/>

OCT 07 '88

O. C. D.

5A. Indicate Type of Lease

STATE ☐

FEE ☒

5. State Oil & Gas Lease No.

APPLICATION FOR PERMIT TO DRILL, DEEPEN, OR PLUG BACK

1a. Type of Work

b. Type of Well DRILL ☒

DEEPEN ☐

PLUG BACK ☐

OIL WELL ☒

GAS WELL ☐

OTHER

SINGLE ZONE ☒

MULTIPLE ZONE ☐

2. Name of Operator

Slash Four Enterprises, Inc.

3. Address of Operator

P.O. Box 1443, Roswell, New Mexico 88201

4. Location of Well

UNIT LETTER 0 LOCATED 330 FEET FROM THE South LINE

AND 2310

FEET FROM THE East LINE OF SEC. 22 TWP. 10S RGE. 27E NMPM

7. Unit Agreement Name

8. Farm or Lease Name

Toltec

9. Well No.

1

10. Field and Pool, or Wildcat

IND Diablo, SA

12. County

Chaves

19. Proposed Depth

2300'

19A. Formation

San Andres

20. Rotary or C.T.

Rotary

21. Elevations (Show whether DF, RT, etc.)

3838' G.L.

21A. Kind & Status Plug. Bond

One Well

21B. Drilling Contractor

United Drilling

22. Approx. Date Work will start

10/31/88

23. PROPOSED CASING AND CEMENT PROGRAM

SIZE OF HOLE	SIZE OF CASING	WEIGHT PER FOOT	SETTING DEPTH	SACKS OF CEMENT	EST. TOP

We propose to drill a 12 1/4" hole to approximately 450'. We will then run 8 5/8" 23# casing with 2 centralizers, insert float, and a Texas pattern guide shoe. The 8 5/8" casing will be cemented with enough class "c" cement to circulate cement to surface. We then plan to drill a 6 3/4" hole to T.D. After drilling to TD we will run porosity and resistivity logs. If the hole is dry we will plug and abandon it according to NMOC rules and regulations. If the hole is completed we plan to run 4 1/2" casing to TD and cement with enough class "c" to cover the top of the pay with at least 500' of cement.

POST 10-1
NL & API
10-28-88

APPROVAL VALID FOR 180 DAYS
PERMIT EXPIRES 4/28/89
UNLESS DRILLING UNDERWAY

IN ABOVE SPACE DESCRIBE PROPOSED PROGRAM: IF PROPOSAL IS TO DEEPEN OR PLUG BACK, GIVE DATA ON PRESENT PRODUCTIVE ZONE AND PROPOSED NEW PRODUCTIVE ZONE. GIVE BLOWOUT PREVENTER PROGRAM, IF ANY.

I hereby certify that the information above is true and complete to the best of my knowledge and belief.

Signed [Signature] Title President, Slash Four Ent., Inc. Date 10/6/88

(This space for State Use)

Original Signed By

Mike Williams

TITLE

DATE

OCT 28 1988

CONDITIONS OF APPROVAL, IF ANY:

All distances must be from the outer boundaries of the Section.

Operator Slash Four Enterprises			Lease Toltec			Well No. 1		
Unit Letter O	Section 22	Township 10 South	Range 27 East	County Chaves				
Actual Footage Location of Well:								
330		feet from the South		line and 2310		feet from the East		line
Ground Level Elev. 3838	Producing Formation SAN ANDRES		Pool UNB. DIABLO SA			Dedicated Acreage: 40 Acres		

1. Outline the acreage dedicated to the subject well by colored pencil or hatchure marks on the plat below.
2. If more than one lease is dedicated to the well, outline each and identify the ownership thereof (both as to working interest and royalty).
3. If more than one lease of different ownership is dedicated to the well, have the interests of all owners been consolidated by communitization, unitization, force-pooling, etc?

☒ Yes ☐ No If answer is "yes," type of consolidation COMMUNITIZATION

If answer is "no," list the owners and tract descriptions which have actually been consolidated. (Use reverse side of this form if necessary.)

No allowable will be assigned to the well until all interests have been consolidated (by communitization, unitization, forced-pooling, or otherwise) or until a non-standard unit, eliminating such interests, has been approved by the Division.

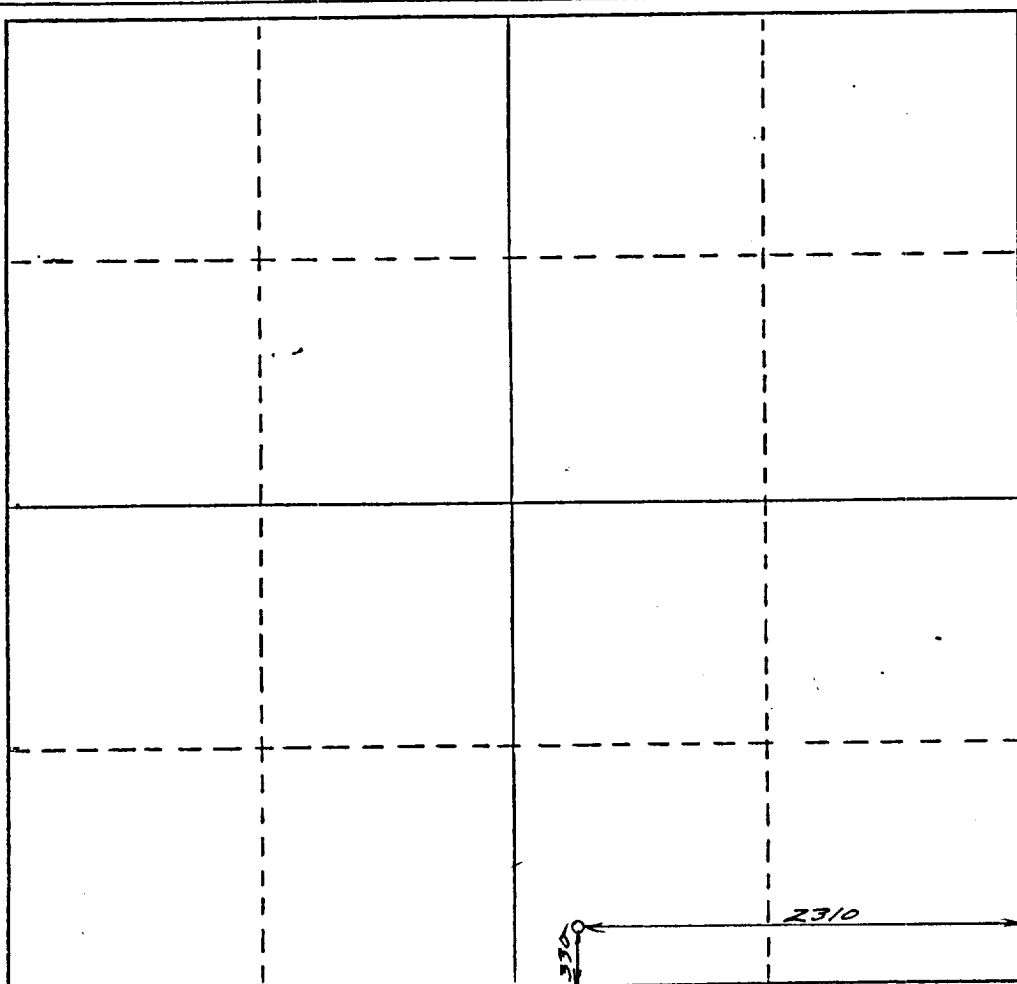

CERTIFICATION

I hereby certify that the information contained herein is true and complete to the best of my knowledge and belief.

Name
J. Phelps White IV

Position
President

Company
Slash Four Enterprises,

Date
9/14/88

I hereby certify that the well location shown on this plat was plotted from field notes of actual surveys made by me or under my supervision, and that the same is true and correct to the best of my knowledge and belief.

Date Surveyed
9/9/1988

P.R. Patton

Registered Land Surveyor
8112

Certificate No. **8112**

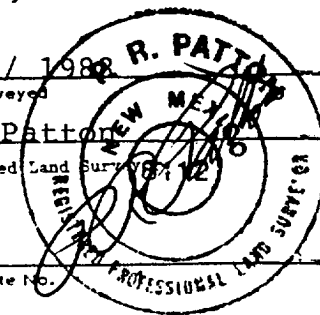

RECEIVED

OCT 27 '88

Attatchment for C-101

O. C. D.
ARTESIA, OFFICE

TOLTEC #1
330' fls, 2310' fel
Sec. 22, T10S, R28E
Chaves County, New Mexico

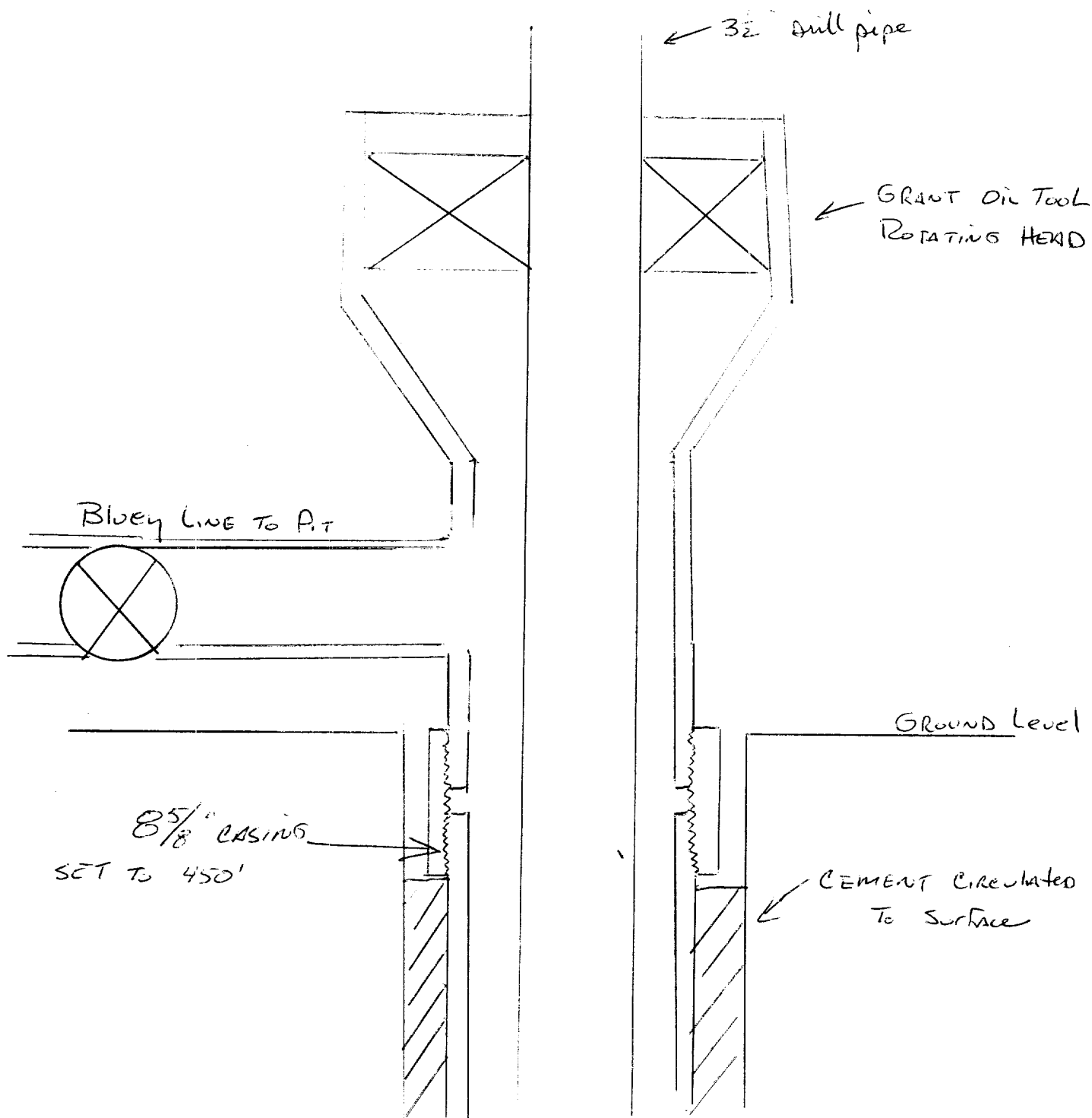

Blowout Prevention Device

SLASH FOUR ENTERPRISES, INC.

P.O. Box 1433, Roswell, New Mexico, 88201
(505) 622-1001

RECEIVED

OCT 27 '88

D.C.D.
ARTESIA OFFICE

October 25, 1988

Re: Toltec #1
330'fsl & 2310'fel
Sec. 22, T10S, R27E
Chaves Co., New Mexico

Mike Williams
NMOCD
P.O. Drawer DD
Artesia, New Mexico 88210

Dear Mike:

In response to your phone call today I have enclosed a diagram of the blowout prevention device which will be used by United Drilling Co. on the subject well.

You had asked about our plans for protecting the fresh water in the area. The C-101 which was submitted for the well shows that we plan to run 450' of 8 5/8" casing and circulate cement to the surface. 450' of casing will be more than adequate to cover any fresh water zones which have been encountered in the Diablo field or other wells in the immediate area.

We plan to drill the well with air/foam so there is no mud program. If mud is required due to unforeseen conditions we will use a native brine.

If you have any other questions regarding the application or drilling program, please give me a call so I can correct, or answer them as soon as possible.

Thanks:

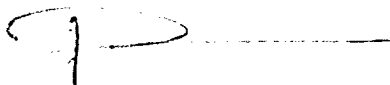

Phelps White