

NO. OF COPIES RECEIVED	
DISTRIBUTION	
SANTA FE	
FILE	
U.S.G.S.	
LAND OFFICE	
OPERATOR	

NOV 23 '88

5A. Indicate Type of Lease
STATE <input checked="" type="checkbox"/> FEE <input type="checkbox"/>
5. State Oil & Gas Lease No.
LG 6319

APPLICATION FOR PERMIT TO DRILL, DEEPEN, OR PLUG BACK

1a. Type of Work		* <u>REVISED</u>	
b. Type of Well		DRILL <input checked="" type="checkbox"/> DEEPEN <input type="checkbox"/> PLUG BACK <input type="checkbox"/>	
OIL WELL <input type="checkbox"/> GAS WELL <input checked="" type="checkbox"/> OTHER		SINGLE ZONE <input checked="" type="checkbox"/> MULTIPLE ZONE <input type="checkbox"/>	
2. Name of Operator			
BHP PETROLEUM COMPANY INC.			
3. Address of Operator			
6 Desta Drive, Ste.3200 Midland, Texas 79705-5510			
4. Location of Well			
UNIT LETTER <u>L</u> LOCATED <u>1980'</u> FEET FROM THE <u>South</u> LINE			
AND <u>990'</u> FEET FROM THE <u>West</u> LINE OF SEC. <u>36</u> TWP. <u>10S</u> RGE. <u>26E</u> NMPM			
12. County			
Chaves			
19. Proposed Depth		19A. Formation	20. Rotary or C.T.
6700'		Ellenburger	Rotary
21. Elevations (Show whether DF, RT, etc.)		21A. Kind & Status Plug. Bond	21B. Drilling Contractor
3706.6'		Statewide	Peterson Drilling
		22. Approx. Date Work will start	On Approval Date

23.

PROPOSED CASING AND CEMENT PROGRAM

SIZE OF HOLE	SIZE OF CASING	WEIGHT PER FOOT	SETTING DEPTH	SACKS OF CEMENT	EST. TOP
12-1/4"	8-5/8"	24.0# J-55	1200'±	650	Circulate
7-7/8"	5-1/2"	15.5# J-55	6500'±	200	5800'

*Revised to change deepest objective from Montoya to Ellenburger.

Propose to drill to about 6700' to test Ellenburger and shallower formations.

If commercial production is indicated, the well will be completed in the deepest favorable formation, by cementing production casing, selectively perforating and stimulating. Run 2-7/8" tubing and test well.

See attached "Supplemental Data".

APPROVAL VALID FOR 180 DAYS
5/28/89
UNLESS DRILLING UNDERWAY.

IN ABOVE SPACE DESCRIBE PROPOSED PROGRAM; IF PROPOSAL IS TO DEEPEN OR PLUG BACK, GIVE DATA ON PRESENT PRODUCTIVE ZONE AND PROPOSED NEW PRODUCTIVE ZONE. GIVE BLOWOUT PREVENTER PROGRAM, IF ANY.

I hereby certify that the information above is true and complete to the best of my knowledge and belief.

Signed Jerry W. Long Title Agent for BHP Date November 22, 1988
(This space for State Use)

Original Signed By

APPROVED BY Mike Williams TITLE DATE NOV 28 1988

CONDITIONS OF APPROVAL, IF ANY:

NEW MEXICO OIL CONSERVATION COMMISSION
WELL LOCATION AND ACREAGE DEDICATION PLAT
*REVISED to change objective formation.

Form O-1-1
Supersedes O-1-1a
Effective 1-1-88

All distances must be from the outer boundaries of the Section

Operator BHP Petroleum (American) Company Inc.		Lease Yates 36 State		Well No. 1
Unit Letter L	Section 36	Township 10 South	Range 26 East	County Chaves
Actual Footage Location of Well: 1980 feet from the South line and 990 feet from the West line				
Ground Level Elev. 3706.6	Producing Formation Ellenburger	Pool Wildcat Ellenburger	Dedicated Acreage: (W $\frac{1}{2}$) 320 Acres	

1. Outline the acreage dedicated to the subject well by colored pencil or hachure marks on the plat below.
2. If more than one lease is dedicated to the well, outline each and identify the ownership thereof (both as to working interest and royalty). Single Lease
3. If more than one lease of different ownership is dedicated to the well, have the interests of all owners been consolidated by communitization, unitization, force-pooling, etc?

☐ Yes ☐ No If answer is "yes," type of consolidation NA

If answer is "no," list the owners and tract descriptions which have actually been consolidated. (Use reverse side of this form if necessary.)

No allowable will be assigned to the well until all interests have been consolidated (by communitization, unitization, forced-pooling, or otherwise) or until a non-standard unit, eliminating such interests, has been approved by the Commission.

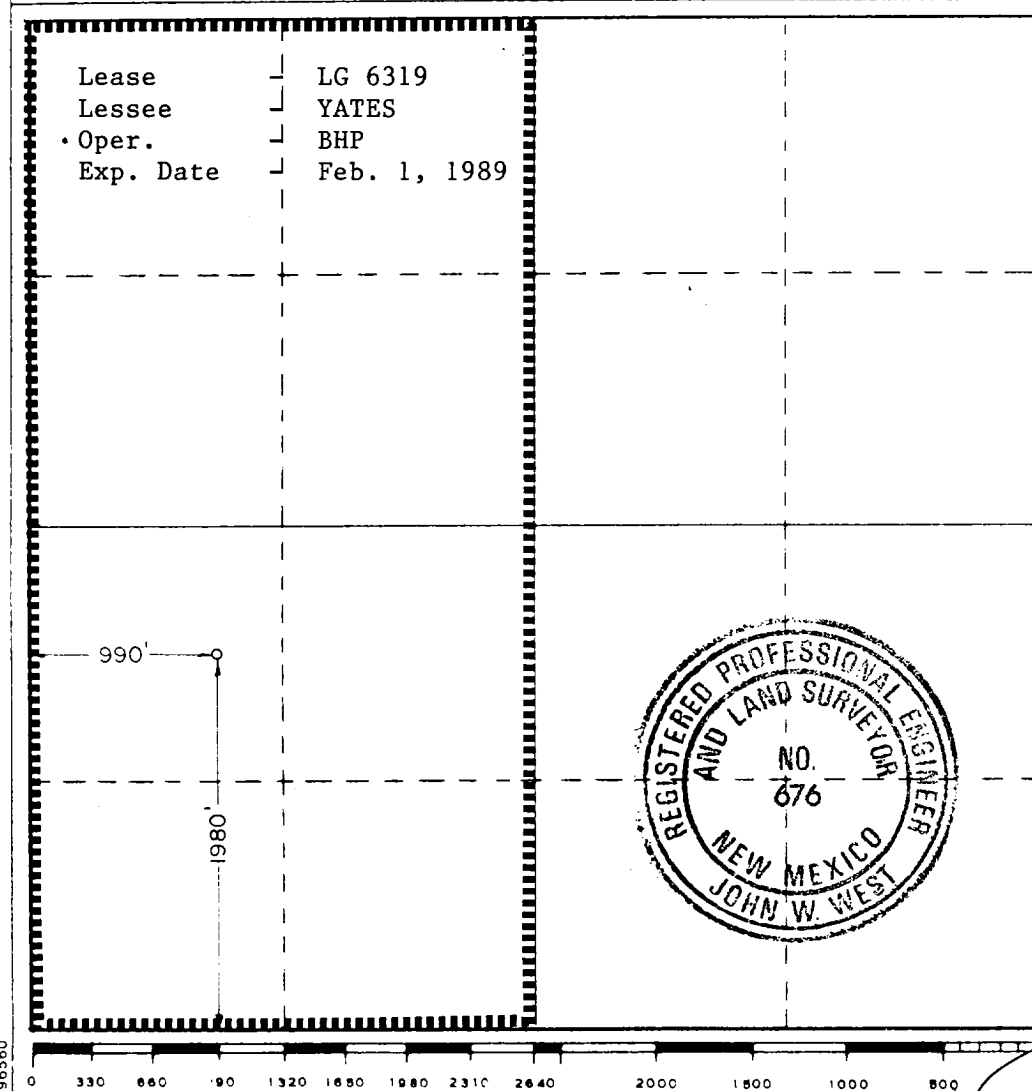

CERTIFICATION

I hereby certify that the information contained herein is true and complete to the best of my knowledge and belief.

Jerry W. Long
Name

JERRY W. LONG

Position

Agent for BHP

Company

BHP PETROLEUM COMPANY INC.

Date

November 22, 1988

I hereby certify that the well location shown on this plat was plotted from field notes of actual surveys made by me or under my supervision, and that the same is true and correct to the best of my knowledge and belief.

Date Surveyed

Nov. 15, 1988

Registered Professional Engineer and/or Land Surveyor

John W. West

Certificate No. JOHN W. WEST, 676

RONALD J. EIDSON, 3239