

STATE OF NEW MEXICO
ENERGY AND MINERALS DEPARTMENT

OIL CONSERVATION DIVISION

P. O. BOX 2088
SANTA FE, NEW MEXICO 87501

RECEIVED

DEC 05 '88

O.C.D.

30-005-62652
Form C-101
Revised 10-1-78

NO. OF COPIES RECEIVED	
DISTRIBUTION	
SANTA FE	<input checked="" type="checkbox"/>
FILE	<input checked="" type="checkbox"/>
U.S.G.S.	<input checked="" type="checkbox"/>
LAND OFFICE	<input checked="" type="checkbox"/>
OPERATOR	<input checked="" type="checkbox"/>

5A. Indicate Type of Lease
STATE ☒ FEE ☐

5. State Oil & Gas Lease No.
L-6853

APPLICATION FOR PERMIT TO DRILL, DEEPEN, OR PLUG BACK

1a. Type of Work DRILL <input checked="" type="checkbox"/> DEEPEN <input type="checkbox"/> PLUG BACK <input type="checkbox"/>		7. Unit Agreement Name
b. Type of Well OIL WELL <input type="checkbox"/> GAS WELL <input checked="" type="checkbox"/> OTHER <input type="checkbox"/> SINGLE ZONE <input type="checkbox"/> MULTIPLE ZONE <input type="checkbox"/>		8. Farm or Lease Name W.R. State
2. Name of Operator ELK OIL COMPANY		9. Well No. 4
3. Address of Operator P. O. Box 310, Roswell, New Mexico 88202-0310		10. Field and Pool, or Wildcat Und. Floor Ranch Pre-Permi
4. Location of Well UNIT LETTER <u>P</u> LOCATED <u>990</u> FEET FROM THE <u>East</u> LINE AND <u>660</u> FEET FROM THE <u>South</u> LINE OF SEC. <u>24</u> TWP. <u>9S</u> RGE. <u>26E</u> NMPM		12. County Chaves
19. Proposed Depth 6300		19A. Formation Fusselman
20. Rotary or C.T. Rotary		
21. Elevations (show whether DF, KI, etc.) 3804 Grd.	21A. Kind & Status Plug. Bond Blanket	21B. Drilling Contractor WEK
		22. Approx. Date Work will start December 5, 1988

23.

PROPOSED CASING AND CEMENT PROGRAM

SIZE OF HOLE	SIZE OF CASING	WEIGHT PER FOOT	SETTING DEPTH	SACKS OF CEMENT	EST. TOP
12 1/4	8 5/8	24	1000	500	circ.
7 7/8	5 1/2	15.5	6300	600	4200

BLOWOUT PREVENTION PROGRAM

See Attached

APPROVAL VALID FOR 180 DAYS
PERMIT EXPIRES 6/6/89
UNLESS DRILLING UNDERWAY

POST ID-1
NL & APT
12-9-88

This acreage is dedicated to Transwestern Pipeline Company.

4. ABOVE SPACE DESCRIBE PROPOSED PROGRAM; IF PROPOSAL IS TO DEEPEN OR PLUG BACK, GIVE DATA ON PRESENT PRODUCTIVE ZONE AND PROPOSED NEW PRODUCTIVE ZONE. GIVE BLOWOUT PREVENTION PROGRAM, IF ANY.

I hereby certify that the information above is true and complete to the best of my knowledge and belief.

Signed Joseph J. Kelly Title President Date 12/1/88

(This space for State Use)

Original Signed By

APPROVED BY Mike Williams TITLE DATE DEC 6 1988

CONDITIONS OF APPROVAL, IF ANY:

NSL-2609
APPP-11-23-88

OIL CONSERVATION DIVISION

P. O. BOX 2088

Form C-102
Revised 10-1-78

STATE OF NEW MEXICO
ENERGY AND MINERALS DEPARTMENT

SANTA FE, NEW MEXICO 87501

All distances must be from the outer boundaries of the Section.

Operator ELK OIL			Lease W-R STATE			Well No. #4		
Well Letter P	Section 24	Township 9 SOUTH	Range 26 EAST	County CHAVES				
Actual Footage Location of Well: 660 feet from the SOUTH line and 990 feet from the EAST line								
Ground Level Elev. 3804	Producing Formation Fusselman		Pool Und. Foor Ranch Pre-Permian			Dedicated Acres 320. Acres		

1. Outline the acreage dedicated to the subject well by colored pencil or hatchure marks on the plat below.
2. If more than one lease is dedicated to the well, outline each and identify the ownership thereof (both as to working interest and royalty).
3. If more than one lease of different ownership is dedicated to the well, have the interests of all owners been consolidated by communitization, unitization, force-pooling, etc?

☐ Yes ☐ No If answer is "yes;" type of consolidation _____

If answer is "no," list the owners and tract descriptions which have actually been consolidated. (Use reverse side of this form if necessary.) _____

No allowable will be assigned to the well until all interests have been consolidated (by communitization, unitization, forced-pooling, or otherwise) or until a non-standard unit, eliminating such interests, has been approved by the Division.

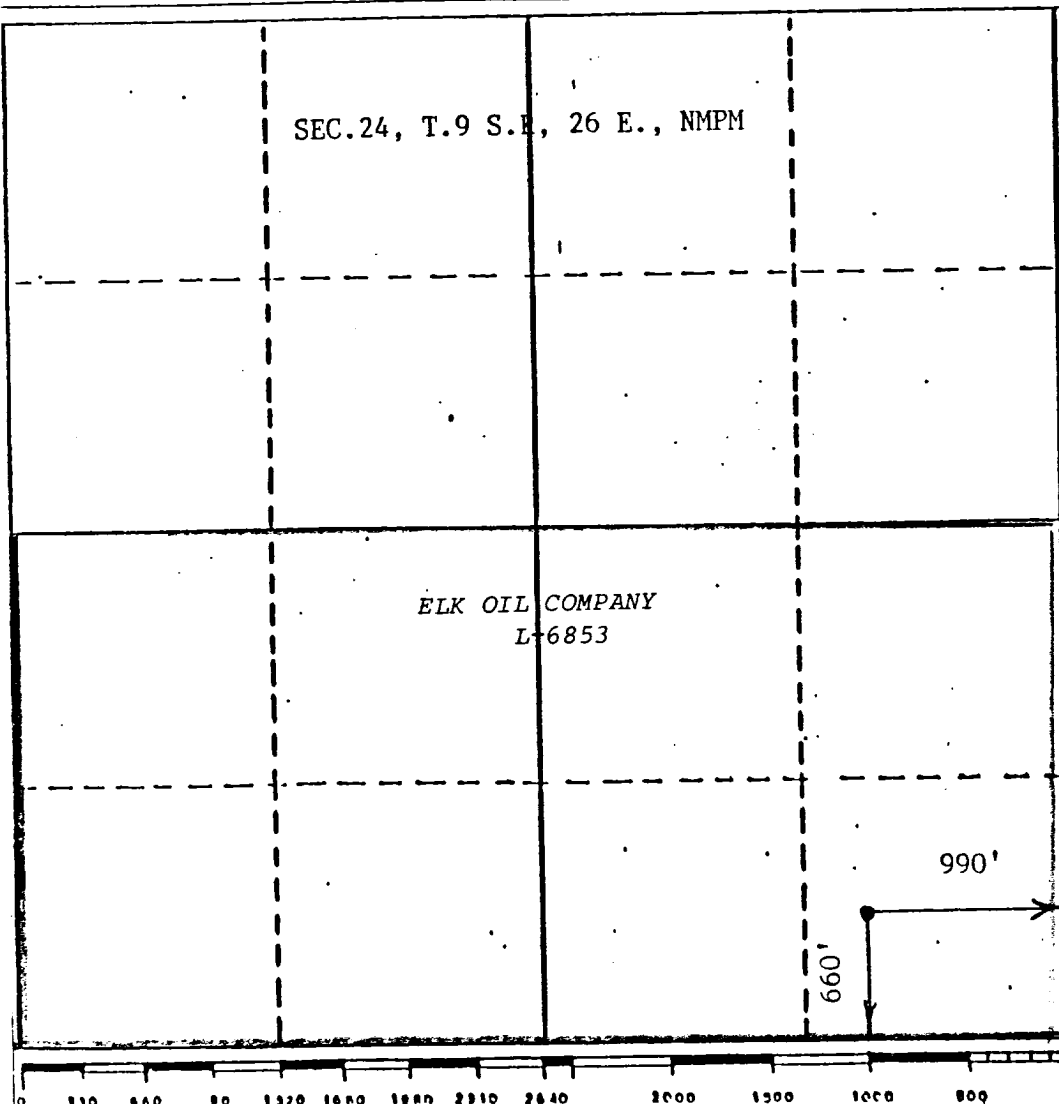

CERTIFICATION

I hereby certify that the information contained herein is true and complete to the best of my knowledge and belief.

Name
Joseph J. Kelly
Position
President
Company
ELK OIL COMPANY
Date
December 2, 1988

I hereby certify that the well location shown on this plat was plotted from field notes of actual surveys made by me or under my supervision, and that the same is true and correct to the best of my knowledge and belief.

JOHN D. JAQUES
Date Surveyed
DECEMBER 1, 1988
Registered Professional Engineer
on Oil and Gas Surveying
JOHN D. JAQUES P.E. & L.S.
Certificate No. **6290**

ELK OIL COMPANY
W.R. State #4
990 FEL, 660 FSL
Section 24, Township 9 South, Range 26 East
Chaves County, New Mexico

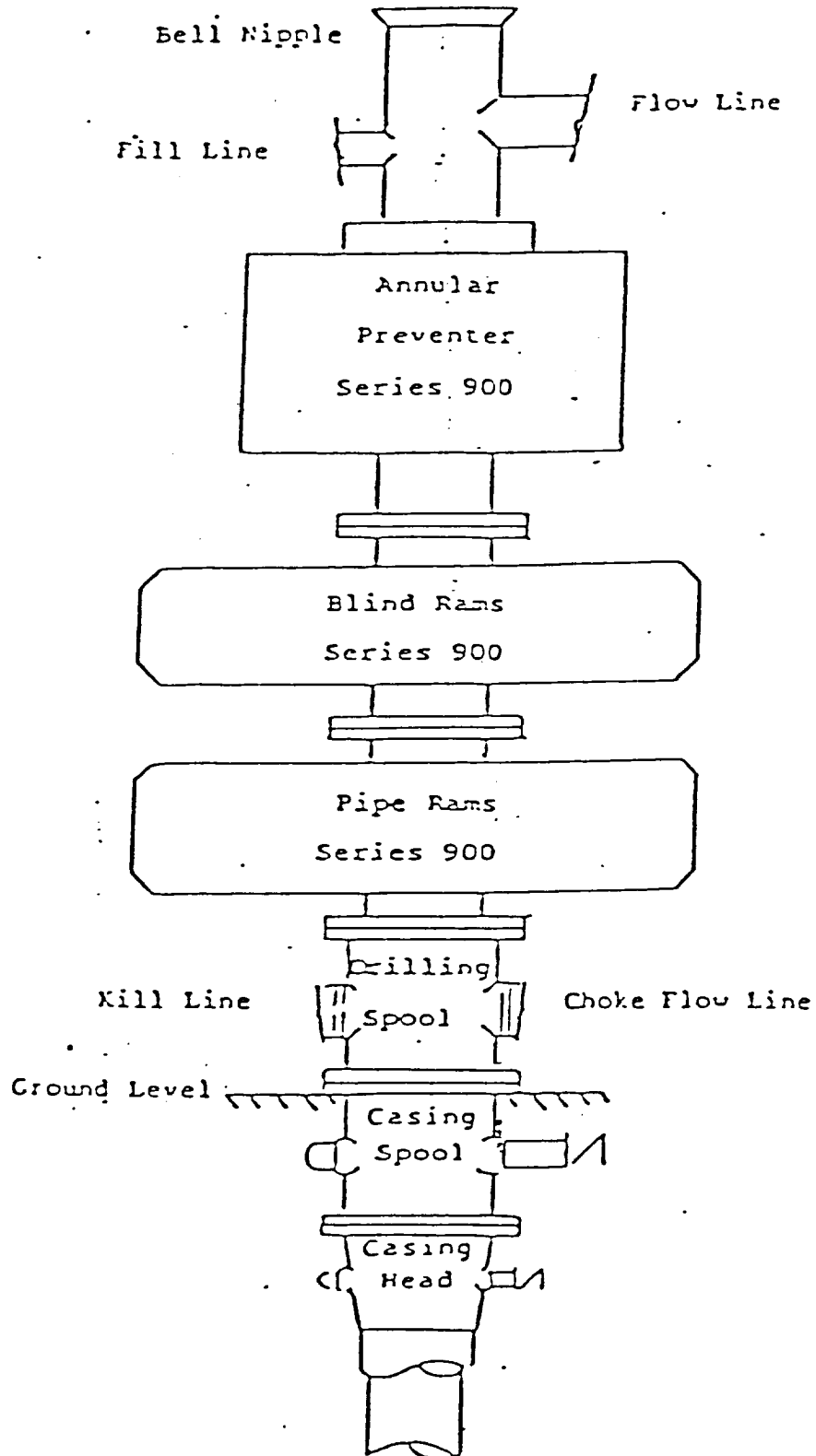

BLOWOUT PREVENTER STACK