

DEC 23 '88

O. C. D.
ARTESIA, OFFICE30-045-62659
Form C-101
Revised 10-1-78

NO. OF COPIES RECEIVED	
DISTRIBUTION	
SANTA FE	<input checked="" type="checkbox"/>
FILE	<input checked="" type="checkbox"/>
U.S.G.S.	<input checked="" type="checkbox"/>
LAND OFFICE	<input checked="" type="checkbox"/>
OPERATOR	<input checked="" type="checkbox"/>

5A. Indicate Type of Lease	
STATE <input checked="" type="checkbox"/>	FEE <input type="checkbox"/>
5. State Oil & Gas Lease No.	
LG-4928	

APPLICATION FOR PERMIT TO DRILL, DEEPEN, OR PLUG BACK

1a. Type of Work			
b. Type of Well DRILL <input checked="" type="checkbox"/> DEEPEN <input type="checkbox"/> PLUG BACK <input type="checkbox"/>			
OIL WELL <input checked="" type="checkbox"/> GAS WELL <input type="checkbox"/> OTHER <input type="checkbox"/> SINGLE ZONE <input type="checkbox"/> MULTIPLE ZONE <input type="checkbox"/>			
2. Name of Operator Yates Petroleum Corporation ✓			
3. Address of Operator 105 South Fourth Street - Artesia, NM 88210			
4. Location of Well UNIT LETTER 0 LOCATED 660 FEET FROM THE South LINE AND 1650 FEET FROM THE East LINE OF SEC. 31 TWP. 9S RGE. 27E NMPM			
5. Elevations (Show whether DF, RT, etc.) 3616.0 GR 3916			
21A. Kind & Status Plug. Bond Blanket		21B. Drilling Contractor Undesignated	
19. Proposed Depth 2200'		19A. Formation San Andres	
20. Rotary or C.T. Cable Tool		22. Approx. Date Work will start ASAP	

PROPOSED CASING AND CEMENT PROGRAM

SIZE OF HOLE	SIZE OF CASING	WEIGHT PER FOOT	SETTING DEPTH	SACKS OF CEMENT	EST. TOP
12-1/2"	8-5/8"	24# J-55	Approx. 550'	400 sacks	Circulate
8"	5-1/2"	14# J-55	TD	300 sacks	

We propose to drill and test the San Andres formation. Approximately 550' of surface casing will be set and cement circulated. If commercial, production casing will be run and cemented with adequate cover, perforated and stimulated as needed for production.

POST ID-1
NL & API
12-30-88

APPROVAL VALID FOR 180 DAYS
EXPIRATION DATE 6/27/89
UNLESS DRILLING UNDERWAY

IN ABOVE SPACE DESCRIBE PROPOSED PROGRAM; IF PROPOSAL IS TO DEEPEN OR PLUG BACK, GIVE DATA ON PRESENT PRODUCTIVE ZONE AND PROPOSED NEW PRODUCTIVE ZONE, GIVE BLOWOUT PREVENTER PROGRAM, IF ANY.

I hereby certify that the information above is true and complete to the best of my knowledge and belief.

Signed Clifton R May Title Permit Agent Date December 23, 1988

(This space for State Use)

Original Signed By
Mike Williams

APPROVED BY _____ TITLE _____ DATE DEC 27 1988

CONDITIONS OF APPROVAL, IF ANY:

**NEW MEXICO OIL CONSERVATION COMMISSION
WELL LOCATION AND ACREAGE DEDICATION PLAT**

Form C-102
Supersedes C-128
Effective 1-1-65

All distances must be from the outer boundaries of the Section.

Operator Yates Petroleum Corporation			Lease LG-4928 Dragonfly State Unit		Well No. 2
Unit Letter 0	Section 31	Township 9South	Range 27 East	County Chaves	
Actual Footage Location of Well: 660 feet from the South line and 1650 feet from the East line					
Ground Level Elev. 3616.0' 39/16	Producing Formation SAN ANDRES		Pool WILDCAT SAN ANDRES	Dedicated Acreage: 40 Acres	

1. Outline the acreage dedicated to the subject well by colored pencil or hachure marks on the plat below.
2. If more than one lease is dedicated to the well, outline each and identify the ownership thereof (both as to working interest and royalty).
3. If more than one lease of different ownership is dedicated to the well, have the interests of all owners been consolidated by communitization, unitization, force-pooling, etc?

☐ Yes ☐ No If answer is "yes," type of consolidation _____

If answer is "no," list the owners and tract descriptions which have actually been consolidated. (Use reverse side of this form if necessary.) _____

No allowable will be assigned to the well until all interests have been consolidated (by communitization, unitization, forced-pooling, or otherwise) or until a non-standard unit, eliminating such interests, has been approved by the Commission.

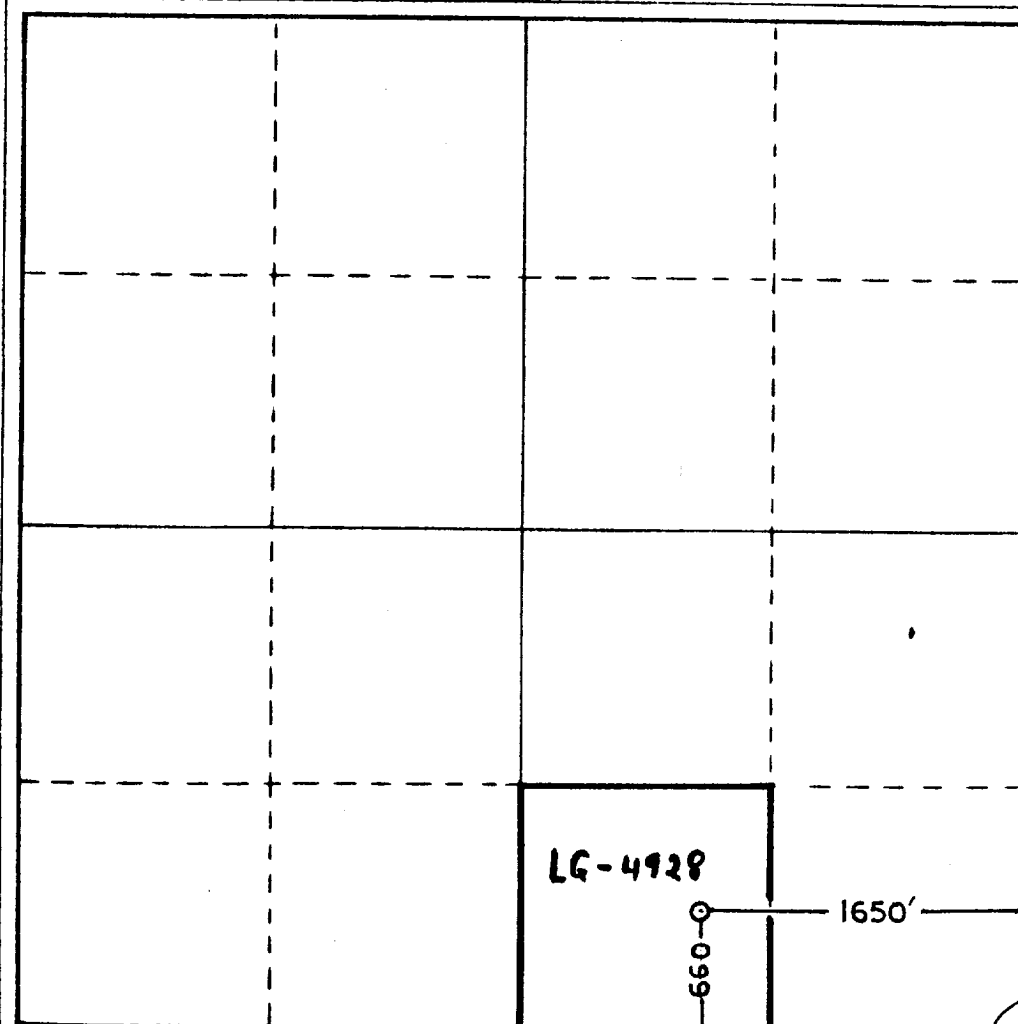

CERTIFICATION

I hereby certify that the information contained herein is true and complete to the best of my knowledge and belief.

Clifton R. May
Name

Clifton R. May

Position
Permit Agent

Company
Yates Petroleum Corporation

Date
12-23-88

I hereby certify that the well location shown on this plat was plotted from field notes of actual surveys made by me or under my supervision, and that the same is true and correct to the best of my knowledge and belief.

December 23, 1988

Date Signed

Recorded and Indexed in the
and for Land Surveyors

L. JONES
3640

Certified and
RECORDED LAND SURVEYOR 3640