

STATE OF NEW MEXICO  
ENERGY AND MINERALS DEPARTMENT

OIL CONSERVATION DIVISION

P. O. BOX 2088

SANTA FE, NEW MEXICO 87501

MAR 03 '89

O. C. D.

ARTESIA OFFICE

30-005-62680  
Form C-101  
Revised 10-1-78

NO. OF COPIES RECEIVED	
DISTRIBUTION	
SANTA FE	<input checked="" type="checkbox"/>
FILE	<input checked="" type="checkbox"/>
U.S.G.S.	<input checked="" type="checkbox"/>
LAND OFFICE	<input checked="" type="checkbox"/>
OPERATOR	<input checked="" type="checkbox"/>

5A. Indicate Type of Lease  
STATE ☒ FEE ☐

5. State Oil & Gas Lease No.  
L-6276

APPLICATION FOR PERMIT TO DRILL, DEEPEN, OR PLUG BACK

1a. Type of Work

DRILL ☒

DEEPEN ☐

PLUG BACK ☐

b. Type of Well

OIL WELL ☐

GAS WELL ☒

OTHER

SINGLE ZONE ☒

MULTIPLE ZONE ☐

2. Name of Operator

CARL A. SCHELLINGER

3. Address of Operator

P. O. BOX 447, Roswell, NM 88202

4. Location of Well

UNIT LETTER I LOCATED 1980 FEET FROM THE South LINE

AND 660

FEET FROM THE East LINE OF SEC. 5 TWP. 9-South RGE. 27-East NMPM

7. Unit Agreement Name

CAMPBELL STATION UNIT

8. Farm or Lease Name

CAMPBELL STATION UNIT

9. Well No.

UWD 6

10. Field and Pool, or Wildcat  
FOOR RANCH PENN, NORTH

12. County  
CHAVES

19. Proposed Depth  
6500'

19A. Formation  
Pennsylvanian

20. Rotary or C.T.  
Rotary

11. Elevations (Show whether DF, RT, etc.)

3877 GR.

21A. Kind & Status Plug. Band  
Blanket

21B. Drilling Contractor

22. Approx. Date Work will start  
March 21, 1989

PROPOSED CASING AND CEMENT PROGRAM

SIZE OF HOLE	SIZE OF CASING	WEIGHT PER FOOT	SETTING DEPTH	SACKS OF CEMENT	EST. TOP
12 1/4"	8 5/8"	23#	1450'	350	Circ.
7 7/8"	5 1/2"	15.5#	6500'	300	

We propose to drill through the Pennsylvanian and to evaluate all intermediate zones.

Mud Program: 0-1450' Fresh water and native mud.  
1450-4500' SW gel, X-PEL-G, Vis 28-33  
4500-6500' SW gel, X-PEL-G, Wt. 9.8-10.2#, Vis 31-45

Blowout preventer diagram is attached.

POST ID-1  
NN-API  
3-10-89

APPROVAL VALID FOR 180 DAYS  
PERMIT DATES 3/2/89  
UNLESS CANCELLED UNDERWAY

ABOVE SPACE DESCRIBE PROPOSED PROGRAMS IF PROPOSAL IS TO DEEPEN OR PLUG BACK, GIVE DATA ON PRESENT PRODUCTIVE ZONE AND PROPOSED NEW PRODUCTIVE ZONE. GIVE BLOWOUT PREVENTER PROGRAM, IF ANY.

I hereby certify that the information above is true and complete to the best of my knowledge and belief.

Signed Carl Schellinger Title Operator Date March 2, 1989

(This space for State Use)

Original Signed By  
Mike Williams

PROVED BY \_\_\_\_\_ TITLE \_\_\_\_\_ DATE MAR 7 1989

NOTIONS OF APPROVAL, IF ANY:

## OIL CONSERVATION DIVISION

STATE OF NEW MEXICO  
ENERGY AND MINERALS DEPARTMENTP. O. BOX 2088  
SANTA FE, NEW MEXICO 87501Form C-102  
Revised 10-1-70

All distances must be from the outer boundaries of the Section.

Operator <b>CARL SCHELLINGER</b>		Lease <b>CAMPBELL STATION UNIT</b>		Well No. <b>#6</b>
Unit Letter <b>I</b>	Section <b>5</b>	Township <b>9 SOUTH</b>	Range <b>27 EAST</b>	County <b>CHAVES</b>
Actual Footage Location of Well: <b>660</b> feet from the <b>EAST</b> line and <b>1980</b> feet from the <b>SOUTH</b> line				
Ground Level Elev. <b>3877</b>	Producing Formation <b>Pennsylvanian</b>	Pool <b>UDD</b> <b>Foor Ranch Penn, North</b>	Dedicated Acreage <b>320.00</b> Acres	

1. Outline the acreage dedicated to the subject well by colored pencil or hatchure marks on the plat below.
2. If more than one lease is dedicated to the well, outline each and identify the ownership thereof (both as to working interest and royalty).
3. If more than one lease of different ownership is dedicated to the well, have the interests of all owners been consolidated by communitization, unitization, force-pooling, etc?

☐ Yes ☐ No If answer is "yes," type of consolidation \_\_\_\_\_

If answer is "no," list the owners and tract descriptions which have actually been consolidated. (Use reverse side of this form if necessary.) \_\_\_\_\_

No allowable will be assigned to the well until all interests have been consolidated (by communitization, unitization, forced-pooling, or otherwise) or until a non-standard unit, eliminating such interests, has been approved by the Division.

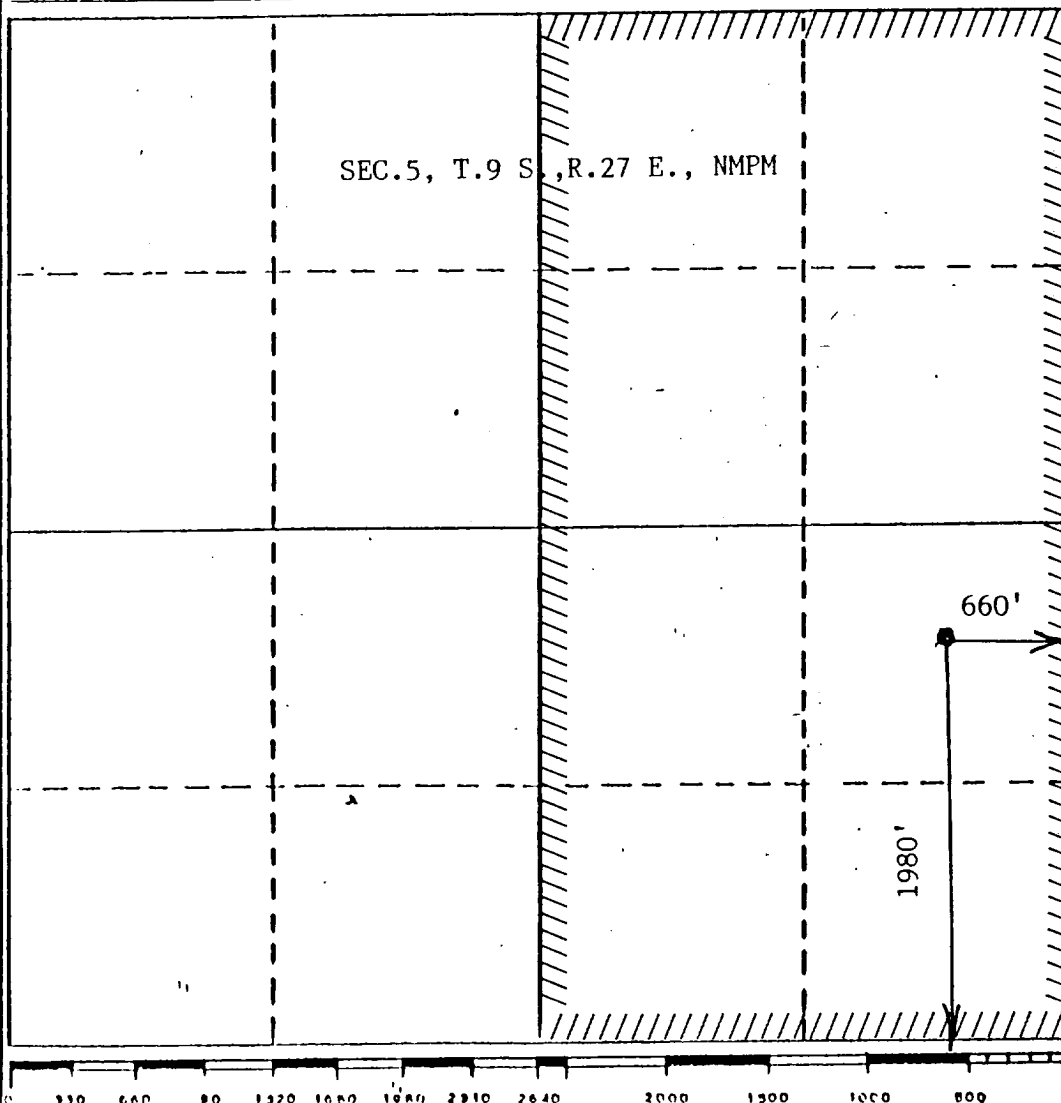

## CERTIFICATION

I hereby certify that the information contained herein is true and complete to the best of my knowledge and belief.

Name  
**CARL A. SCHELLINGER**  
Position  
**OPERATOR**  
Company

Date  
**March 2, 1989**

I hereby certify that the well location shown on this plat was plotted from field notes of actual surveys made by me or under my supervision, and that the same is true and correct to the best of my knowledge and belief.

Date Surveyed  
**FEBRUARY 28, 1989**  
Registered Professional Engineer and/or Land Surveyor  
**JOHN D. JAQUES, P.E. & L.S.**  
Certificate No. **6290**

CARL A. SCHELLINGER  
CAMPBELL STATION UNIT No. 6  
Unit I Section 5, T-9-S, R-27-E  
Chaves County, New Mexico

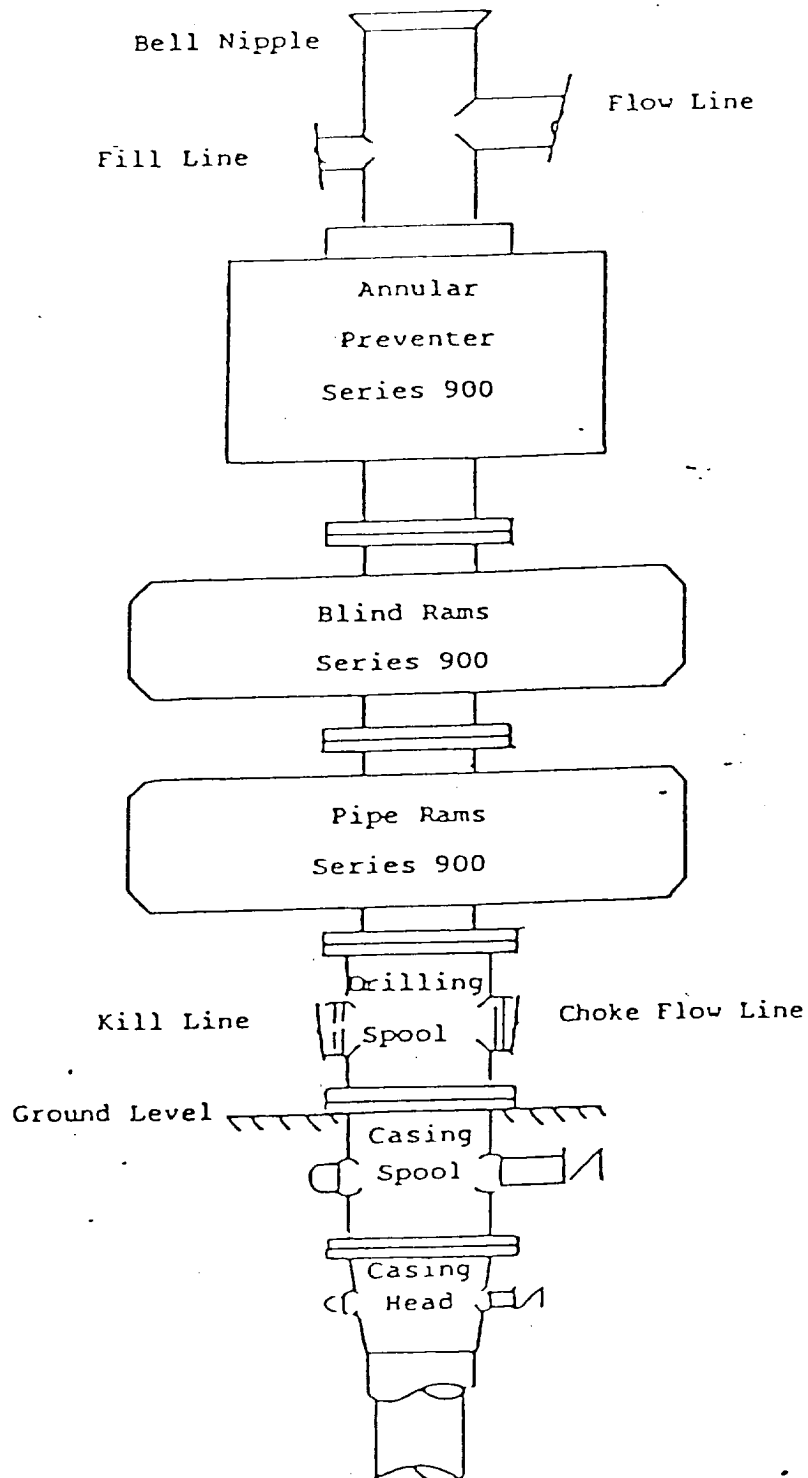

BLOWOUT PREVENTER STACK  
3000# WP