

Submit to Appropriate  
District Office  
State Lease - 6 copies  
Fee Lease - 5 copies

State of New Mexico  
Energy, Minerals and Natural Resources Department

Santa Fe	
File	
BLM	
Land Office	
B of M	
Operator	

Form C-101  
Revised 1-1-89

RECEIVED  
OIL CONSERVATION DIVISION

DISTRICT I  
P.O. Box 1980, Hobbs, NM 88240

DISTRICT II  
P.O. Drawer DD, Artesia, NM 88210

DISTRICT III  
1000 Rio Brazos Rd., Aztec, NM 87410  
O. C. D.  
ARTESIA, OFFICE

JUL 03 '89 Santa Fe, New Mexico 87504-2088

APPRO. (Assigned by OCD on New Wells)

30-005-62786

5. Indicate Type of Lease

STATE ☒ FEE ☐

6. State Oil & Gas Lease No.

L-6853

7. Lease Name or Unit Agreement Name

W.R. State

8. Well No.

5

9. Pool name or Wildcat

Wildcat San Andres

APPLICATION FOR PERMIT TO DRILL, DEEPEN, OR PLUG BACK

1a. Type of Work:

DRILL ☒

RE-ENTER ☐

DEEPEN ☐

PLUG BACK ☐

b. Type of Well:

OIL  
WELL ☒

GAS  
WELL ☐

OTHER ☐

SINGLE  
ZONE ☐

MULTIPLE  
ZONE ☐

2. Name of Operator

ELK OIL COMPANY

3. Address of Operator

P. O. BOX 310, ROSWELL, NEW MEXICO 88202-0310

4. Well Location

Unit Letter I : 1980 Feet From The South Line and 660 Feet From The East Line

Section 24 Township 9S Range 26E NMPM Chaves County

10. Proposed Depth

2,200'

11. Formation

San Andres

12. Rotary or C.T.

Cable Tool

13. Elevations (Show whether DF, RT, GR, etc.)

3800 Gr.

14. Kind & Status Plug. Bond

Blanket OK

15. Drilling Contractor

Hammond Drlg.

16. Approx. Date Work will start

7/15/89

17. PROPOSED CASING AND CEMENT PROGRAM

SIZE OF HOLE	SIZE OF CASING	WEIGHT PER FOOT	SETTING DEPTH	SACKS OF CEMENT	EST. TOP
12 1/4	8 5/8"	24#	Approx. 400'	300 sx.	circulate
7 7/8	5 1/2"	14#	TD	300 sx.	

Propose to drill and test the San Andres formation. Approximately 400' of surface casing will be set and cement circulated. If commercial, production casing will be run and cemented, perforated, and stimulated.

MUD PROGRAM: Cable tool operation.

POSTED-1  
NL & API  
7-7-89

APPROVAL VALID FOR 180 DAYS  
EXPIRATION DATE 1-5-90  
UNLESS DRILLING UNDERWAY

IN ABOVE SPACE DESCRIBE PROPOSED PROGRAM: IF PROPOSAL IS TO DEEPEN OR PLUG BACK, GIVE DATA ON PRESENT PRODUCTIVE ZONE AND PROPOSED NEW PRODUCTIVE ZONE. GIVE BLOWOUT PREVENTER PROGRAM, IF ANY.

I hereby certify that the information above is true and complete to the best of my knowledge and belief.

SIGNATURE

Joseph J. Kelly

TITLE

President

DATE 6/30/89

TYPE OR PRINT NAME

TELEPHONE NO.

(This space for State Use)

ORIGINAL SIGNED BY

MIKE WILLIAMS

APPROVED BY

SUPERVISOR, DISTRICT II

TITLE

DATE

JUL 5 1989

CONDITIONS OF APPROVAL, IF ANY:

## OIL CONSERVATION DIVISION

STATE OF NEW MEXICO  
ENERGY AND MINERALS DEPARTMENTP. O. BOX 2088  
SANTA FE, NEW MEXICO 87501Form C-102  
Revised 10-1-78

All distances must be from the outer boundaries of the Section.

Operator <b>ELK OIL COMPANY</b>		Lease <b>W-R STATE</b>		Well No. <b>5</b>	
Unit Letter <b>I</b>	Section <b>24</b>	Township <b>9 SOUTH</b>	Range <b>26 EAST</b>	County <b>CHAVES</b>	
Actual Footage Location of Wells 1980 feet from the <b>SOUTH</b> line and <b>660</b> feet from the <b>EAST</b> line					
Ground Level Elev. <b>3800</b>	Producing Formation <b>San Andres</b>		Pool <b>Wildcat EA</b>		Dedicated Acreage <b>40</b> Acres

1. Outline the acreage dedicated to the subject well by colored pencil or hatchure marks on the plat below.
2. If more than one lease is dedicated to the well, outline each and identify the ownership thereof (both as to working interest and royalty).
3. If more than one lease of different ownership is dedicated to the well, have the interests of all owners been consolidated by communitization, unitization, force-pooling, etc?

☐ Yes ☐ No If answer is "yes," type of consolidation \_\_\_\_\_

If answer is "no," list the owners and tract descriptions which have actually been consolidated. (Use reverse side of this form if necessary.) \_\_\_\_\_

No allowable will be assigned to the well until all interests have been consolidated (by communitization, unitization, forced-pooling, or otherwise) or until a non-standard unit, eliminating such interests, has been approved by the Division

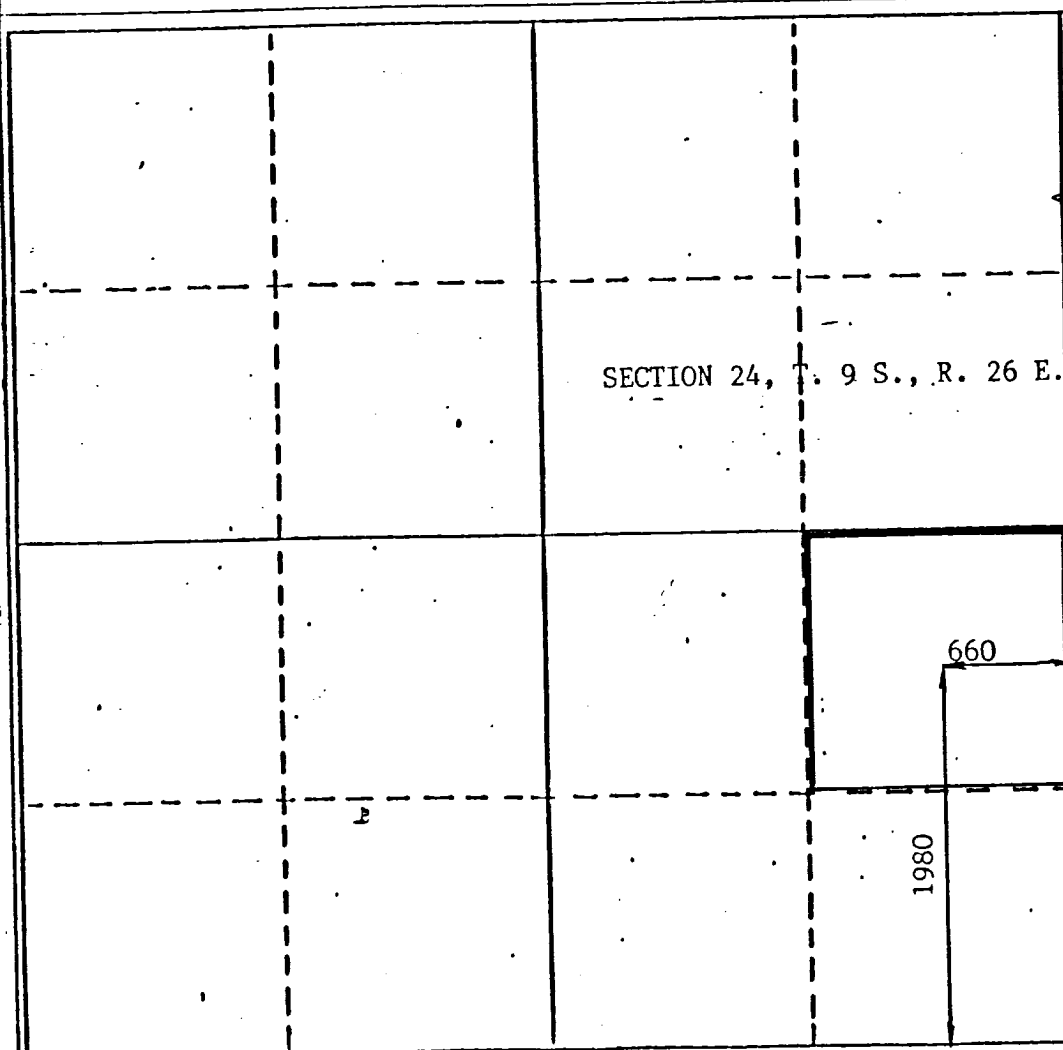

## CERTIFICATION

I hereby certify that the information contained herein is true and complete to the best of my knowledge and belief.

Name  
**JOSEPH J. KELLY**Position  
**PRESIDENT**Company  
**ELK OIL COMPANY**Date  
**6/30/89**

I hereby certify that the well location shown on this plat was plotted from field notes of actual surveys made by me or under my supervision, and that the same is true and correct to the best of my knowledge and belief.

Date Surveyed  
**JUNE 29, 1989**

Registered Professional Engineer and/or Land Surveyor

John D. Jaquess, P.E. &amp; L.S.

Certificate No. **6290**