

OIL CONSERVATION DIVISION

STATE OF NEW MEXICO
ENERGY AND MINERALS DEPARTMENTP. O. BOX 2088
SANTA FE, NEW MEXICO 87501Form C-102
Revised 10-1-78

All distances must be from the outer boundaries of the Section.

Operator COLLINS OIL & GAS CORP.		Lease GULF STATE		Well No. 2
Unit Letter J	Section 14	Township 14 SOUTH	Range 29 EAST	County CHAVES
Actual Postage Location of Well: 1980 feet from the EAST line and 1650 feet from the SOUTH line				
Ground Level Elev. 3762	Producing Formation QUEEN	Pool DOUBLE L (QUEEN)	Dedicated Acreage: 40 Acres	

1. Outline the acreage dedicated to the subject well by colored pencil or hatchure marks on the plat below.
2. If more than one lease is dedicated to the well, outline each and identify the ownership thereof (both as to working interest and royalty).
3. If more than one lease of different ownership is dedicated to the well, have the interests of all owners been consolidated by communitization, unitization, force-pooling, etc?

☐ Yes ☐ No If answer is "yes," type of consolidation _____

If answer is "no," list the owners and tract descriptions which have actually been consolidated. (Use reverse side of this form if necessary.) _____

No allowable will be assigned to the well until all interests have been consolidated (by communitization, unitization, forced-pooling, or otherwise) or until a non-standard unit, eliminating such interests, has been approved by the Division.

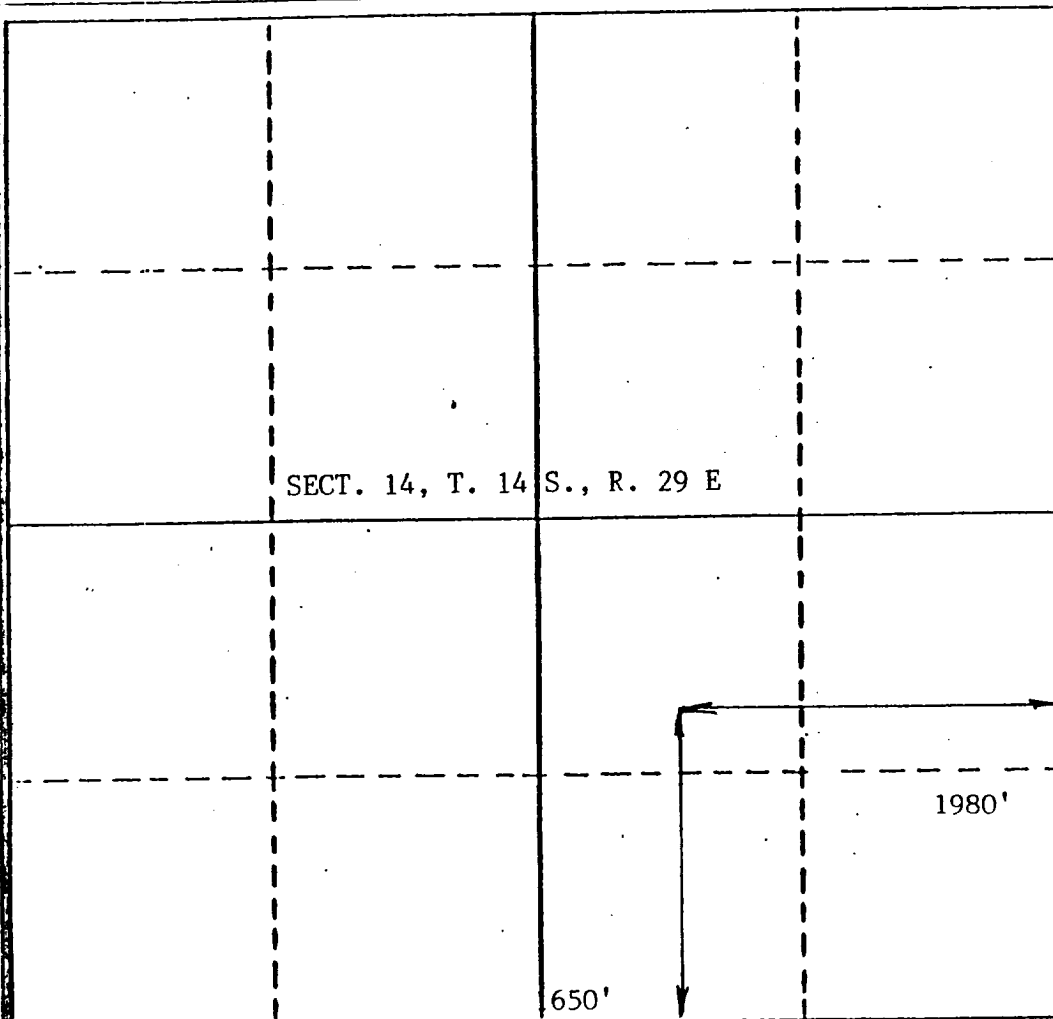

CERTIFICATION

I hereby certify that the information contained herein is true and complete to the best of my knowledge and belief.

Name

Ray W. Collins

Position

Pres.

Company

Collins Oil & Gas Corporation

Date

9-17-89

I hereby certify that the well location shown on this plat was plotted from field notes of actual surveys made by me or under my supervision, and that the same is true and correct to the best of my knowledge and belief.

JOHN D. JAQUESS
NEW MEXICO
Date Surveyed: SEPTEMBER 13, 1989
Registered Professional Engineer
and/or Land Surveyor
John D. Jaquess
Professional A.E. & L.S.
Certificate No. 6290

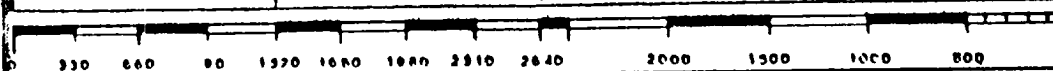

RV 22 11 11