

STATE OF NEW MEXICO
ENERGY AND MINERALS DEPARTMENT

OIL CONSERVATION DIVISION
P. O. BOX 2088
SANTA FE, NEW MEXICO 87501

30-005-62738
Form C-101
Revised 10-1-78

NO. OF COPIES RECEIVED	
DISTRIBUTION	
SANTA FE	
FILE	
U.S.G.S.	
LAND OFFICE	
OPERATOR	

OCT 31 '89

O. C. D.

APPLICATION FOR PERMIT TO DRILL, DEEPEN, OR PLUG BACK

1a. Type of Work DRILL <input checked="" type="checkbox"/> DEEPEN <input type="checkbox"/> PLUG BACK <input type="checkbox"/>		7. Unit Agreement Name	
b. Type of Well OIL WELL <input checked="" type="checkbox"/> GAS WELL <input type="checkbox"/> OTHER <input type="checkbox"/> SINGLE ZONE <input checked="" type="checkbox"/> MULTIPLE ZONE <input type="checkbox"/>		8. Farm or Lease Name Denton	
2. Name of Operator Horizon Oil & Gas Co. ✓		9. Well No.	
3. Address of Operator P.O. Box 7, Spearman, Texas 79081		10. Field and Pool, or Wildcat Wildcat Montoya	
4. Location of Well UNIT LETTER I LOCATED 1650 FEET FROM THE South LINE AND 660 FEET FROM THE East LINE OF SEC. 23 TWP. 5 S RGE. 27 E NMPM		12. County Chaves	
19. Proposed Depth 7550'		19A. Formation Montoya	20. Rotary or C.T. Rotary
21. Elevations (Show whether DF, RT, etc.) 4079	21A. Kind & Status Plug. Bond Single Well	21B. Drilling Contractor Norton Drilling Co.	22. Approx. Date Work will start Upon Approval

PROPOSED CASING AND CEMENT PROGRAM

SIZE OF HOLE	SIZE OF CASING	WEIGHT PER FOOT	SETTING DEPTH	SACKS OF CEMENT	EST. TOP
11 1/4"	8 5/8"	24#	1800'	550	Surface
7 7/8"	5 1/2" or 4 1/2"	15.5# or 11.6#	7550'	As Needed	6000'

- I. Drill 11" hole to Approximately 1850', Set 8 5/8" Surface Casing to 1800'.
Circulate cement to surface. Set Blow Out Preventor as Shown on attached Schematic.
Pressure test as required.
- II. Drill 7 7/8" hole to 7550'. If Well is Commercial, set 5 1/2" or 4 1/2" Casing for Production.
If Non-Commercial, plug as required by State.

APPROVAL VALID FOR 180 DAYS
PERMIT EXPIRES 5-3-90
UNLESS DRILLING UNDERWAY

Filed ID
APR 11
11-10-89

IN ABOVE SPACE DESCRIBE PROPOSED PROGRAM; IF PROPOSAL IS TO DEEPEN OR PLUG BACK, GIVE DATA ON PRESENT PRODUCTIVE ZONE AND PROPOSED NEW PRODUCTIVE ZONE. GIVE BLOWOUT PREVENTER PROGRAM, IF ANY.

I hereby certify that the information above is true and complete to the best of my knowledge and belief.

Signed Mike Williams Title Production Manager Date 10-30-89

(This space for State Use Only)
MIKE WILLIAMS

APPROVED BY SUPERVISOR, DISTRICT 18 TITLE DATE NOV 3 1989

CONDITIONS OF APPROVAL, IF ANY:

APPROVALS: APPROVED BY: [Signature]
DATE: [Date]
[Signature]
[Signature]

Submit to Appropriate
District Office
State Lease - 4 copies
Fee Lease - 3 copies

State of New Mexico
Energy, Minerals and Natural Resources Department

Form C-102
Revised 1-1-89

OIL CONSERVATION DIVISION

DISTRICT I
P.O. Box 1980, Hobbs, NM 88240

P.O. Box 2088
Santa Fe, New Mexico 87504-2088

DISTRICT II
P.O. Drawer DD, Artesia, NM 88210

DISTRICT III
1000 Rio Brazos Rd., Aztec, NM 87410

WELL LOCATION AND ACREAGE DEDICATION PLAT

All Distances must be from the outer boundaries of the section

Operator HORIZON OIL & GAS COMPANY			Lease DENTON		Well No. 1
Unit Letter I	Section 23	Township 5-SOUTH	Range 27-EAST	County CHAVES	
Actual Footage Location of Well: 1650' feet from the SOUTH line and 660' feet from the EAST line					
Ground level Elev. 4079'		Producing Formation Montoya		Pool Wild Cat	Dedicated Acreage: 40 Acres

1. Outline the acreage dedicated to the subject well by colored pencil or hatchure marks on the plat below.
2. If more than one lease is dedicated to the well, outline each and identify the ownership thereof (both as to working interest and royalty).
3. If more than one lease of different ownership is dedicated to the well, have the interest of all owners been consolidated by communization, unitization, force-pooling, etc.?
☐ Yes ☐ No If answer is "yes" type of consolidation _____
If answer is "no" list the owners and tract descriptions which have actually been consolidated. (Use reverse side of this form if necessary.) _____
No allowable will be assigned to the well until all interests have been consolidated (by communization, unitization, forced-pooling, or otherwise) or until a non-standard unit, eliminating such interest, has been approved by the Division.

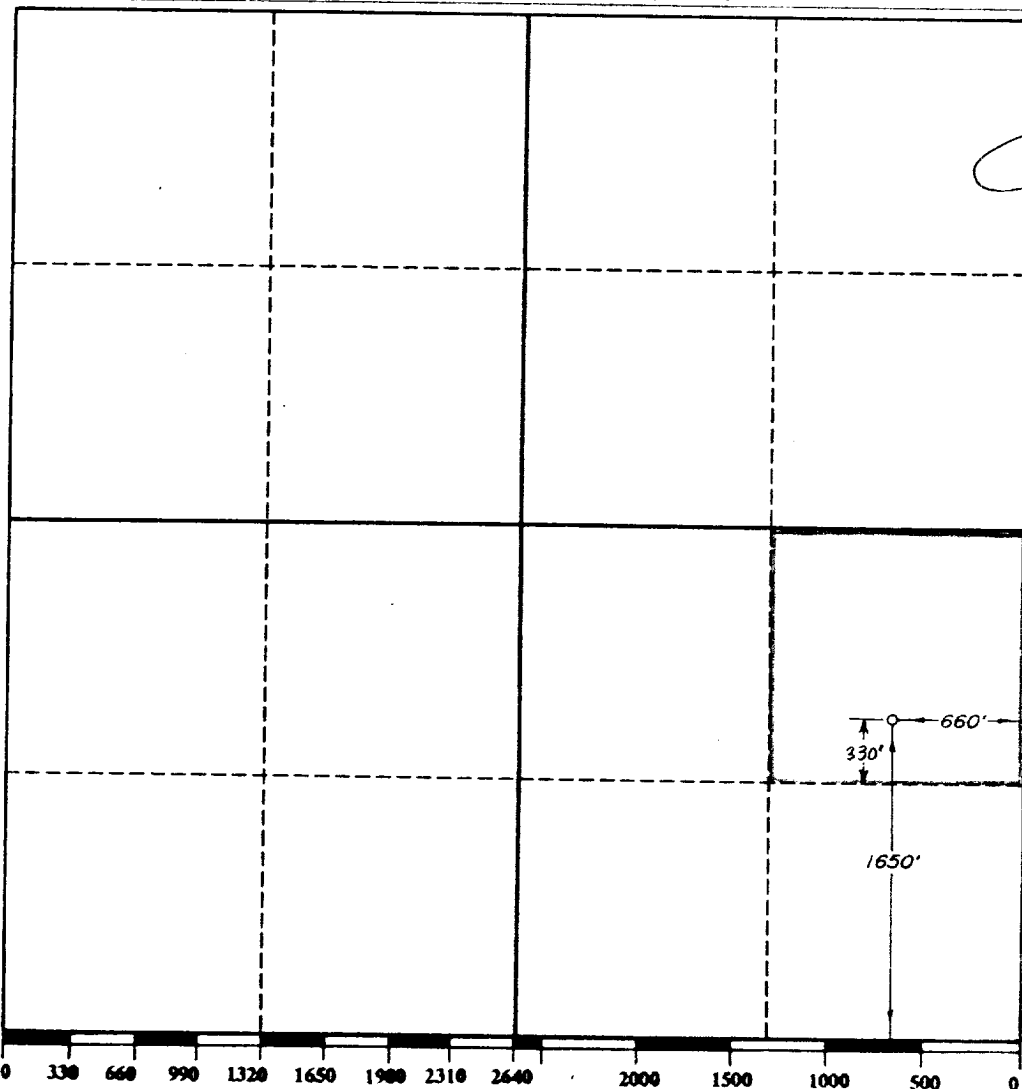

OPERATOR CERTIFICATION

I hereby certify that the information contained herein is true and complete to the best of my knowledge and belief.

Signature

Everett R. Tracy

Printed Name

Production Manager

Position

Horizon Oil & Gas Co.

Company

10/30/89

Date

SURVEYOR CERTIFICATION

I hereby certify that the well location shown on this plat was plotted from field notes of actual surveys made by me or under my supervision, and that the same is true and correct to the best of my knowledge and belief.

Date Surveyed

OCTOBER 17, 1989

Signature & Seal of
Professional Surveyor

V. L. Byrner
Certificate No.

7920

Outline of Dedicated Acreage

11.4

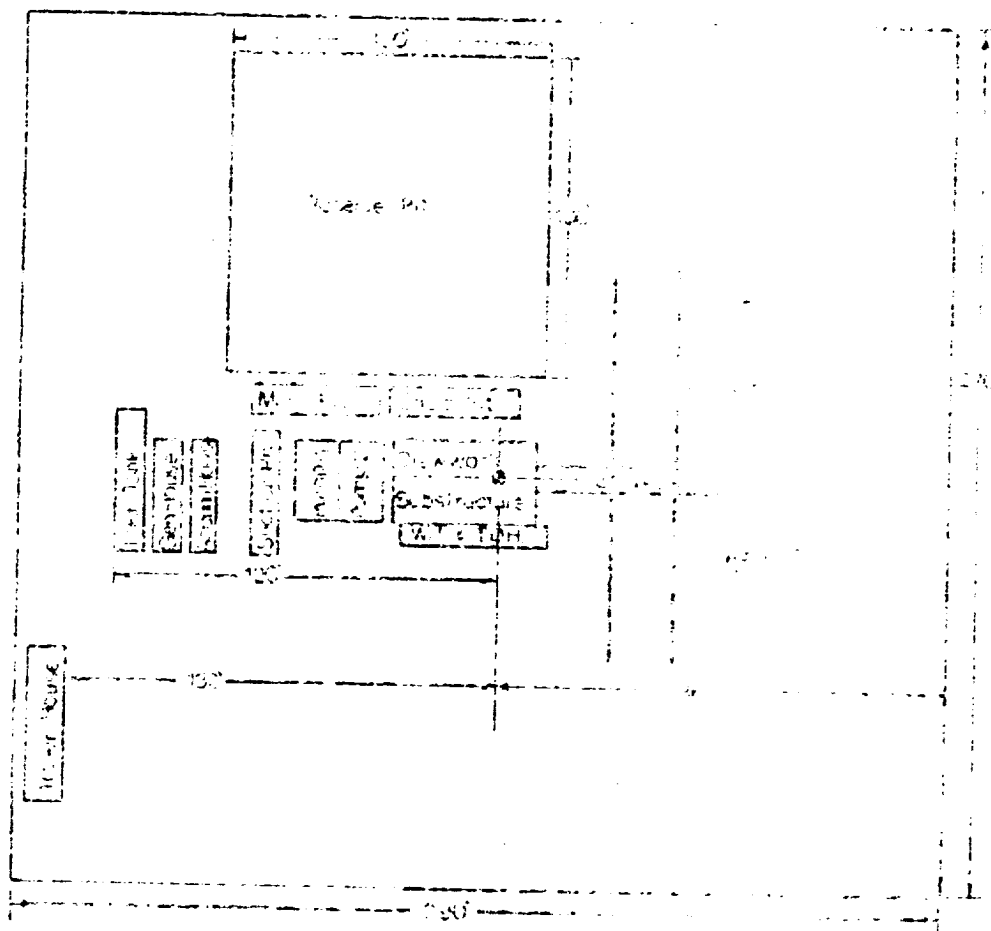
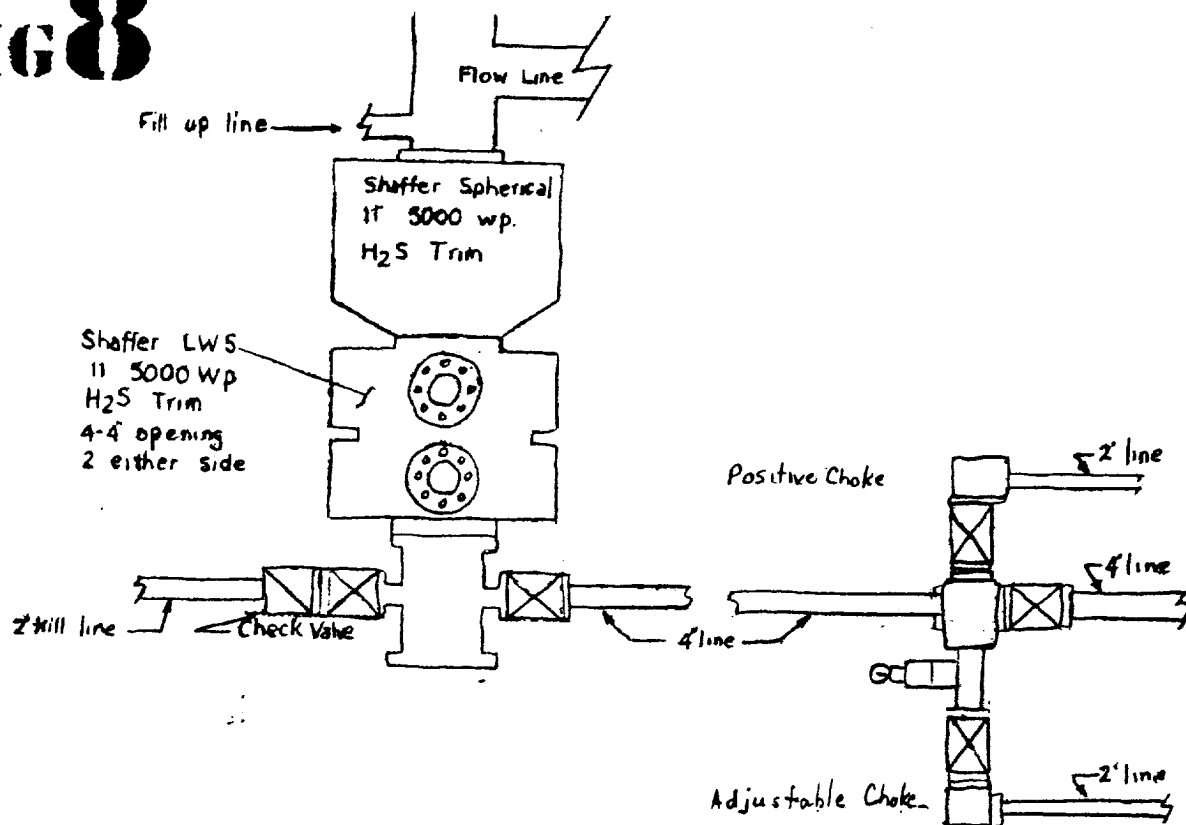

TD 7550

Granit 7340

Montoya 7240

Fuss 7216

Silurian 7196

Miss 6942

Strawn 6678

Penn 6577

Canyon 6472

Cisco 6314

3 Bros 6075

WC 5677

Abo 4471

Tubb 4238

PIC 2012

#1 7200 - 30 SY

will Plug Back

#2 6625 - 30 SY

#3 5725 - 30 SY

#4 5025 30 SY

#5 4285 30 SY

#6 ¹⁰⁰
~~3050~~ 30 SY