

STATE OF NEW MEXICO  
ENERGY AND MINERALS DEPARTMENT

OIL CONSERVATION DIVISION

P. O. BOX 2088

SANTA FE, NEW MEXICO 87501

Form C-101  
Revised 10-1-78

5A. Indicate Type of Lease

STATE ☐ FEE ☒

5. State Oil & Gas Lease No.

OCT - 9 '89

O. C. D.

RESIA, OFFICE

APPLICATION FOR PERMIT TO DRILL, DEEPEN, OR PLUG BACK

1a. Type of Work DRILL <input checked="" type="checkbox"/> DEEPEN <input type="checkbox"/> PLUG BACK <input type="checkbox"/>		7. Unit Agreement Name
b. Type of Well OIL WELL <input checked="" type="checkbox"/> GAS WELL <input type="checkbox"/> OTHER <input type="checkbox"/> SINGLE ZONE <input checked="" type="checkbox"/> MULTIPLE ZONE <input type="checkbox"/>		8. Farm or Lease Name Judith
2. Name of Operator Slash Four Enterprises, Inc.		9. Well No. 1
3. Address of Operator P.O. Box 1433, Roswell, N.M. 88201		10. Field and Pool, or Wildcat Wildcat San Andres
4. Location of Well UNIT LETTER O LOCATED 330 FEET FROM THE South LINE AND 2310 FEET FROM THE East LINE OF SEC. 28 TWP. 11S RGE. 28E NMPM		12. County Chaves
19. Proposed Depth 2350		19A. Formation San Andres
20. Rotary or C.T. Rotary		
21. Elevations (Show whether DF, RT, etc.) 3652 Ground	21A. Kind & Status Plug. Bond One Well	21B. Drilling Contractor United Drilling
22. Approx. Date Work will start November 15, 1989		

23.

PROPOSED CASING AND CEMENT PROGRAM

SIZE OF HOLE	SIZE OF CASING	WEIGHT PER FOOT	SETTING DEPTH	SACKS OF CEMENT	EST. TOP
12 1/4"	8 5/8"	23#	250' 350'	150	Circulate
7 7/8"	4 1/2"	9.5#	TD	123	1600'

We propose to drill a 12 1/4" hole to approximately 400'. We will then run 8 5/8" 23# casing with 2 centralizers, insert float, and Texas pattern guide shoe. The 8 5/8" casing will be cemented with enough class C cement to circulate cement to surface. We then plan to drill a 7 7/8" hole to TD. After drilling to TD we will run porosity and resistivity logs. If the hole is dry we will plug and abandon it according to NMOC rules and regulations. If the hole is completed we plan to run 4 1/2" casing to TD and cement with enough class C to cover the top of the pay with at least 500' of cement. The hole will be drilled with air, attached is a diagram of the control head configuration.

Part ID-1  
11-17-89  
New-Lo + HPI

APPROVAL VALID FOR 180 DAYS  
PERMIT EXPIRES 5/15/90  
UNLESS DRILLING UNDERWAY

IN ABOVE SPACE DESCRIBE PROPOSED PROGRAM; IF PROPOSAL IS TO DEEPEN OR PLUG BACK, GIVE DATA ON PRESENT PRODUCTIVE ZONE AND PROPOSED NEW PRODUCTIVE ZONE. GIVE BLOWOUT PREVENTER PROGRAM, IF ANY.

I hereby certify that the information above is true and complete to the best of my knowledge and belief.

Signed [Signature] Title President, Slash Four Ent. Inc. Date 10/6/89

(This space for State Use)

ORIGINAL FILED BY

MIKE [Signature]

APPROVED BY [Signature] TITLE SUPERVISOR, OIL & GAS DATE NOV 15 1989

CONDITIONS OF APPROVAL, IF ANY:

## OIL CONSERVATION DIVISION

STATE OF NEW MEXICO  
ENERGY AND MINERALS DEPARTMENTP. O. BOX 2088  
SANTA FE, NEW MEXICO 87501Form C-102  
Revised 10-1-78

All distances must be from the outer boundaries of the Section.

Operator Slash Four Enterprises			Lease Judith		Well No. 1
Unit Letter 0	Section 28	Township 11 South	Range 28 East	County Chaves	
Actual Footage Location of Well: 330 feet from the South line and 2310 feet from the East line					
Ground Level Elev. 3652	Producing Formation San Andres		Pool Wildcat	Dedicated Acreage: 40 Acres	

1. Outline the acreage dedicated to the subject well by colored pencil or hachure marks on the plat below.
2. If more than one lease is dedicated to the well, outline each and identify the ownership thereof (both as to working interest and royalty).
3. If more than one lease of different ownership is dedicated to the well, have the interests of all owners been consolidated by communitization, unitization, force-pooling, etc?

☒ Yes ☐ No If answer is "yes," type of consolidation Communitization

If answer is "no," list the owners and tract descriptions which have actually been consolidated. (Use reverse side of this form if necessary.)

No allowable will be assigned to the well until all interests have been consolidated (by communitization, unitization, forced-pooling, or otherwise) or until a non-standard unit, eliminating such interests, has been approved by the Division.

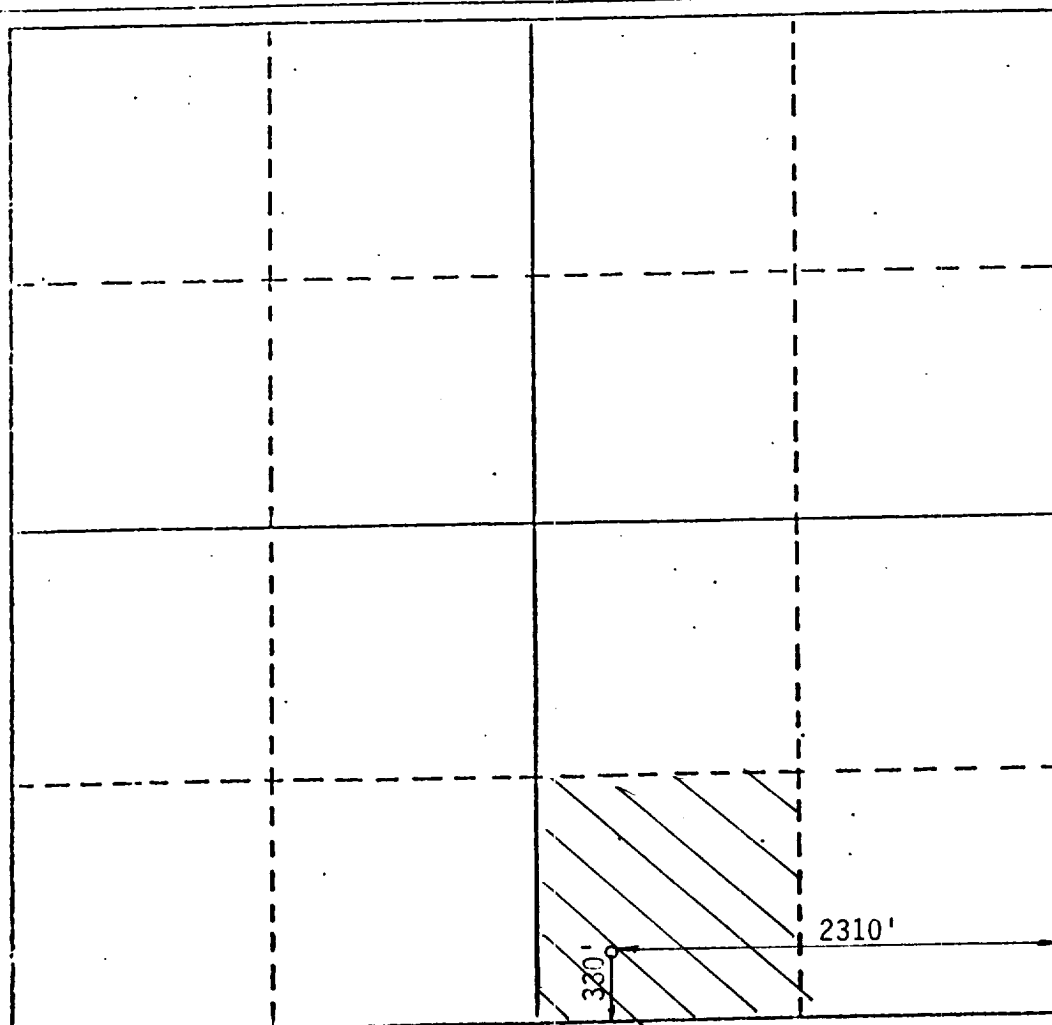

## CERTIFICATION

I hereby certify that the information contained herein is true and complete to the best of my knowledge and belief.

Name  
Phelps White, IV  
Position  
President  
Company  
Slash Four Enterprises, Inc.  
Date  
10/6/89

I hereby certify that the well location shown on this plat was plotted from field notes of actual surveys made by me or under my supervision, and that the same is true and correct to the best of my knowledge and belief.

Date Surveyed  
September 19, 1989  
Registered Professional Engineer  
and/or Land Surveyor  
P. R. Patton  
Certificate No.  
8112

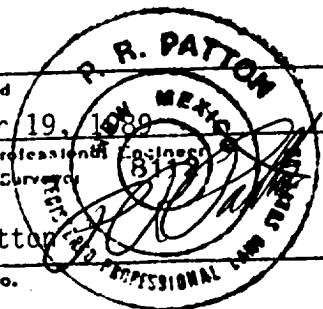

Attachment for C-101

Judith #1  
330' FSL & 2310' FEL  
Sec. 28, T11S, R28E  
Chaves, Co., N.M.

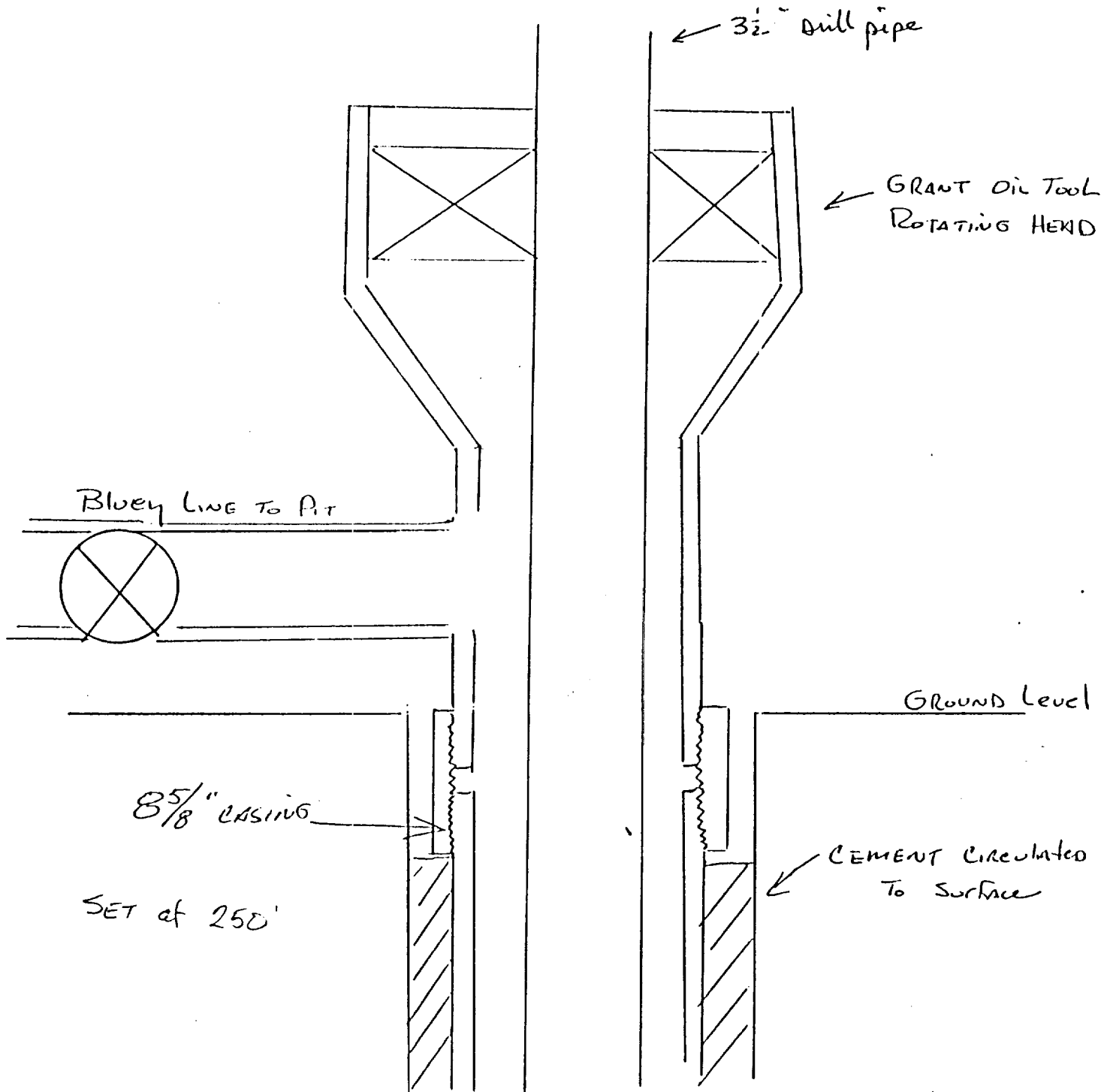

Blowout Prevention Device