

UNITED STATES
DEPARTMENT OF THE INTERIOR
BUREAU OF LAND MANAGEMENT

30-005-62747
file
BLM Roswell District
Modified Form 10-1
NOV 28 1989
RECEIVED
NM060-3160-2

APPLICATION FOR PERMIT TO DRILL, DEEPEN, OR PLUG BACK

1a. TYPE OF WORK

DRILL ☒

DEEPEN ☐

PLUG BACK ☐

b. TYPE OF WELL

OIL WELL ☒

GAS WELL ☐

OTHER ☐

SINGLE ZONE ☐

MULTIPLE ZONE ☐

2. NAME OF OPERATOR

McClellan Oil Corporation

3a. Area Code & Phone No.

505-622-3200

3. ADDRESS OF OPERATOR

P.O. Drawer 730 Roswell, NM 88202

4. LOCATION OF WELL (Report location clearly and in accordance with any State requirements.)*

At surface
405 FNL & 330 FEL
At proposed prod. zone

14. DISTANCE IN MILES AND DIRECTION FROM NEAREST TOWN OR POST OFFICE*

17 miles northeast of Roswell

15. DISTANCE FROM PROPOSED*

LOCATION TO NEAREST
PROPERTY OR LEASE LINE, FT.
(Also to nearest drlg. unit line, if any)

16. NO. OF ACRES IN LEASE

1872.48

17. NO. OF ACRES ASSIGNED
TO THIS WELL

40

18. DISTANCE FROM PROPOSED LOCATION*
TO NEAREST WELL, DRILLING, COMPLETED,
OR APPLIED FOR, ON THIS LEASE, FT.

19. PROPOSED DEPTH

1250'

20. ROTARY OR CABLE TOOLS

Rotary and Cable Tool

21. ELEVATIONS (Show whether DF, RT, GR, etc.)

3594 G.L.

22. APPROX. DATE WORK WILL START*

12-1-89

PROPOSED CASING AND CEMENTING PROGRAM

HOLE SIZE	CASING SIZE	WEIGHT/FOOT	GRADE	THREAD TYPE	SETTING DEPTH	QUANTITY OF CEMENT
12 1/4"	8 5/8"	24 lb.	H-40 J-55	8 rd	900'	450 sx 'C'
7 7/8"	5 1/2"	14 lb.	J-55	8 rd	1250'	150 sx 'C'

MUD PROGRAM

Drill to 900' with fresh water and set 8 5/8" casing and circulate cement. All this is to be done by Rotary Rig. Move Rotary off, rig up Cable Tool Rig and drill to TD (1250'). If production is indicated run 5 1/2" production casing and cement. Move Cable Tool Rig off and attempt completion.

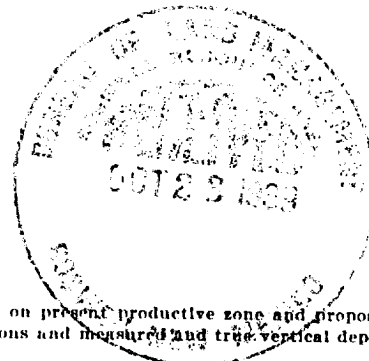

Post ID-1
12-1-89
New Loc +
API

IN ABOVE SPACE DESCRIBE PROPOSED PROGRAM: If proposal is to deepen or plug back, give data on present productive zone and proposed new productive zone. If proposal is to drill or deepen directionally, give pertinent data on subsurface locations and measured and true vertical depths. Give blowout preventer program, if any.

24.

SIGNED

Paul Raydahl

TITLE

Drilling & Production Eng.

DATE

Oct 19, 1989

(This space for Federal or State office use)

PERMIT NO.

APPROVAL DATE

APPROVED BY

S/Phil Kirk

TITLE

Area Manager

DATE

NOV 27 1989

CONDITIONS OF APPROVAL, IF ANY:

APPROVAL OF THIS APPLICATION DOES NOT WARRANT OR CERTIFY THAT THE APPLICANT HOLDS LEGAL OR EQUITABLE TITLE TO THOSE RIGHTS IN THE SUBJECT LEASE WHICH WOULD BE NECESSARY FOR THE APPLICANT TO CONDUCT OPERATIONS THEREON.

PLEASE BE ADVISED THAT THERE WILL BE NO EXCAVATION OF FEDERALLY OWNED MINERAL MATERIAL FOR CONSTRUCTION OF THE ACCESS ROAD OR PAD WITHOUT PAYMENT IN ADVANCE.

U.S.C. Section 1001, makes it a crime for any person knowingly and willfully to make to any department or agency of the

Submit to Appropriate
District Office
State Lease - 4 copies
Fee Lease - 3 copies

State of New Mexico
Energy, Minerals and Natural Resources Department

Form C-102
Revised 1-1-89

OIL CONSERVATION DIVISION

P.O. Box 2088
Santa Fe, New Mexico 87504-2088

DISTRICT I

P.O. Box 1980, Hobbs, NM 88240

DISTRICT II

P.O. Drawer DD, Artesia, NM 88210

DISTRICT III

1000 Rio Brazos Rd., Aztec, NM 87410

WELL LOCATION AND ACREAGE DEDICATION PLAT

All Distances must be from the outer boundaries of the section

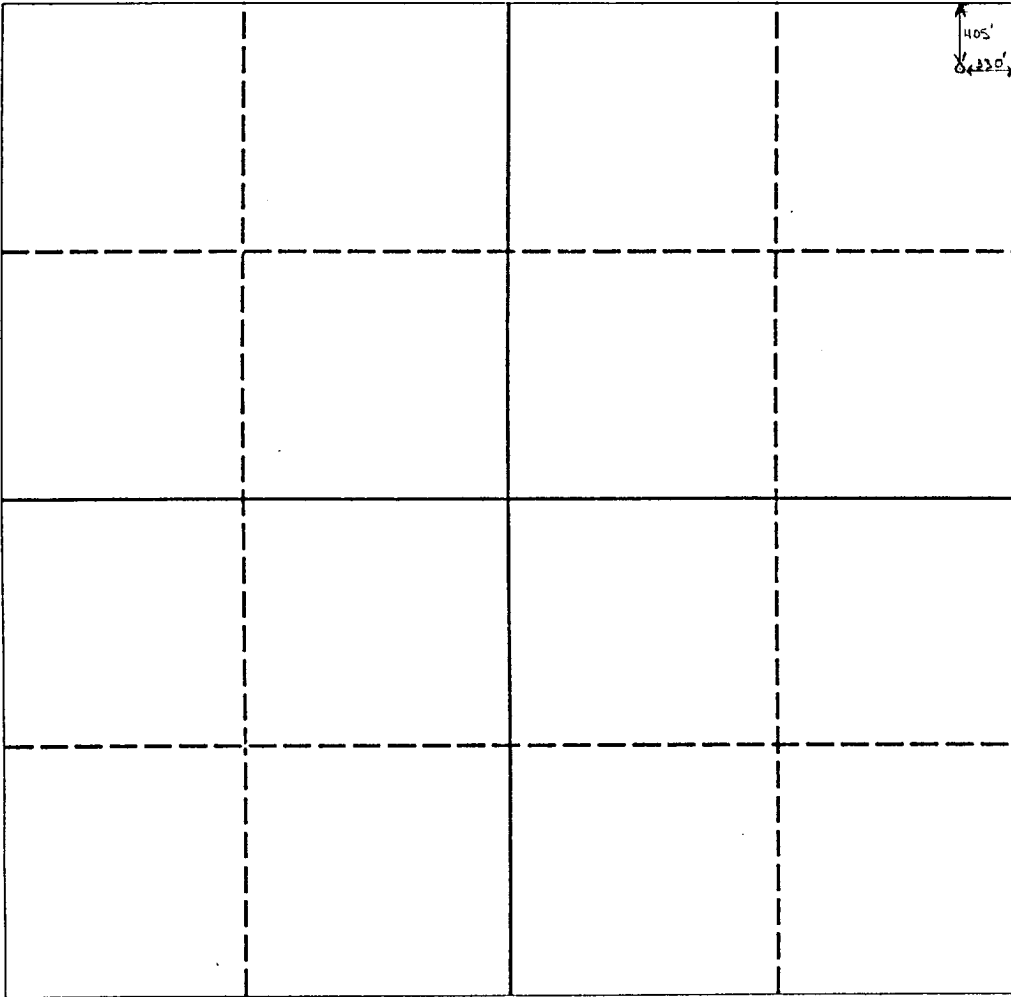
Operator McClellan Oil Corporation			Lease Aciete Federal		Well No. #1
Unit Letter A	Section 35	Township 9 South	Range 25 East	NMPM	County Chaves
Actual Footage Location of Well: 405 feet from the North line and 330 feet from the East line					
Ground level Elev. 3594'	Producing Formation San Andres		Pool Wildcat	San Andres	
			Dedicated Acreage: 40 Acres		
<p>1. Outline the acreage dedicated to the subject well by colored pencil or hatchure marks on the plat below.</p> <p>2. If more than one lease is dedicated to the well, outline each and identify the ownership thereof (both as to working interest and royalty).</p> <p>3. If more than one lease of different ownership is dedicated to the well, have the interest of all owners been consolidated by communitization, unitization, force-pooling, etc.? <input type="checkbox"/> Yes <input type="checkbox"/> No If answer is "yes" type of consolidation _____</p> <p>If answer is "no" list the owners and tract descriptions which have actually been consolidated. (Use reverse side of this form if neccessary. _____)</p> <p>No allowable will be assigned to the well until all interests have been consolidated (by communitization, unitization, forced-pooling, or otherwise) or until a non-standard unit, eliminating such interest, has been approved by the Division.</p>					
				OPERATOR CERTIFICATION I hereby certify that the information contained herein is true and complete to the best of my knowledge and belief.	
				Signature <i>Paul Ragsdale</i> Printed Name Paul Ragsdale Position Operations Manager Company McClellan Oil Corporation Date Oct. 19, 1989	
				SURVEYOR CERTIFICATION I hereby certify that the well location shown on this plat was plotted from field notes of actual surveys made by me or under my supervision, and that the same is true and correct to the best of my knowledge and belief.	
				Date Surveyed Jan. 16, 1989 Signature & Seal of Professional Surveyor P. R. Patton See Attached Plat Certificate No. 8112	

All distances must be from the outer boundaries of the Section.

Operator McClellan Oil Corp.		Lease Aciete Federal		Well No. 1
Unit Letter A	Section 35	Township 9 South	Range 25 East	County Chaves
Actual Footage Location of Well: 405 feet from the North line and 330 feet from the East line				
Ground Level Elev. 3587	Producing Formation		Pool	Dedicated Acreage: Acres

1. Outline the acreage dedicated to the subject well by colored pencil or hatchure marks on the plat below.
2. If more than one lease is dedicated to the well, outline each and identify the ownership thereof (both as to working interest and royalty).
3. If more than one lease of different ownership is dedicated to the well, have the interests of all owners been consolidated by communitization, unitization, force-pooling, etc?

☐ Yes ☐ No If answer is "yes," type of consolidation _____

If answer is "no," list the owners and tract descriptions which have actually been consolidated. (Use reverse side of this form if necessary.) _____

No allowable will be assigned to the well until all interests have been consolidated (by communitization, unitization, forced-pooling, or otherwise) or until a non-standard unit, eliminating such interests, has been approved by the Division.

Section 35, T.9S., R. 25 E.

CERTIFICATION

I hereby certify that the information contained herein is true and complete to the best of my knowledge and belief.

Mark McClellan

Name

Mark McClellan

Position

Exploration Mgr.

Company

McClellan Oil Corporation

Date

November 15, 1989

I hereby certify that the well location shown on this plat was plotted from field notes of actual surveys made by me or under my supervision, and that the same is true and correct to the best of my knowledge and belief.

JOHN D. JAQUES
Date Surveyed **NEW MEXICO**
November 14, 1989
Registered Professional Engineer
and/or Land Surveyor
John D. Jaques, P.E. & L.S.
Certificate No. **6290**

APPLICATION FOR DRILLING

McCLELLAN OIL CORPORATION
Aciete Fed. #1
405 FNL & 330 FEL, Sec. 35-T9S-R25E
Chaves County, New Mexico
Lease No. NM-0559993

In conjunction with Form 3160-3, Application for Permit to Drill subject well, McClellan Oil Corporation submits the following items of pertinent information in accordance with BLM requirements:

1. The geologic surface formation is recent Permian with quaternary alluvium and other surficial deposits.
2. The tops of geologic markers are as follows:

San Andres	510'
T.D.	1250'
3. The estimated depths at which water, oil or gas formations are anticipated to encountered:

Water: Surface water between 100' to 300'.

Oil: 1000' to 1250'.
4. Proposed Casing Program: See Form 3160-3.
5. Pressure Control Equipment: A cable tool control head will be installed after setting surface.
6. Mud Program: None
7. Testing, Logging, and Coring Program:

Drill Stem Tests:

Logging: From surface Casing to T.D.: G/R, CNL-LDT, DLL, MSFL
8. No abnormal pressures or temperatures are anticipated. In the event abnormal pressures are encountered the proposed mud program will be modified.
10. Anticipated starting date: December 1, 1989.
Anticipated completion of drilling operations: Approximately 35 days.

MULTI-POINT SURFACE USE AND OPERATIONS PLAN

McCLELLAN OIL CORPORATION
Aciete Fed. #1
405 FNL & 330 FEL
Chaves County, New Mexico
Lease No. NM-0559993

This plan is submitted with the Application for permit to Drill the above described well. The purpose of the plan is to describe the location of the proposed well, the proposed construction activities and operations plan, to be followed in rehabilitating the surface after completion of the operation so that a complete appraisal can be made of the environmental effects associated with the operations.

1. EXISTING ROADS:

- A. Exhibit "A" is a portion of the BLM color quad map showing the location of proposed well and access road as staked, in relation to existing roads and highway. The well is approximately 17 miles northeast of Roswell, NM. The 15 miles consists of 10 miles of U.S. Highway 380, and 7 miles of ranch-oilfield roads.
- B. Directions: Travel east of Roswell, NM on U.S. Highway 380, 10 miles to the Bottomless Lakes turnoff. Turn north for 5.7 miles, crossing second cattleguard that is 220 feet northeast of the McCrea ranch house. Continue northwest to the road crossing; take left hand road .2 mile southwest crossing cattleguard; then .1 mile to gate. Take road on north side of fence line for 1 miles; turn north .1 mile to Sanders well. Continue north 2300 feet on ripped access road to the MM Fed., Well No. 2 wellsite. The access road starts on the northeast corner of the wellsite pad and will run northeast for approximately 1500' to the southwest corner of the proposed wellsite. The existing location (400' square) and access road is color coded in red on Exhibits "A" and "B".

2. PLANNED ACCESS ROAD-The proposed well will be built on the south side of the existing MM Fed. #10 locatoin. No new construction will be required except to build a small pit off the location edge. See Exhibit D.

3. LOCATION OF EXISTING WELLS:

- A. Existing wells within a two mile radius are shown on Exhibit "C".

4. LOCATION OF EXISTING AND/OR PROPOSED FACILITIES:

- A. There are production facilities on this lease at the present time.
- B. If the well proves to be commercial, a separate tank battery will be constructed on the location.

5. LOCATION & TYPE OF WATER SUPPLY

- A. It is planned to drill the surface of the proposed well with fresh water which will be obtained from commercial sources. The water will be transported over existing access roads.

6. SOURCE OF CONSTRUCTION MATERIALS- No materials are required.

7. METHODS OF HANDLING WASTE DISPOSAL:

- A. Drill cuttings will be disposed of in the reserve pits.
- B. Drilling fluids will be allowed to evaporate in the reserve pits until the pits are dry.
- C. All pits will be fenced with normal fencing materials to prevent livestock from entering the area.
- D. Water produced during operations will be collected in tanks until hauled to an approved disposal system, or a separate disposal application will be submitted to the BLM for approval.
- E. Oil produced during operations will be stored in tanks until sold.
- F. Current laws and regulations pertaining to the disposal of human waste will be complied with.
- G. Trash, waste paper, garbage and junk will be buried in a separate trash pit and covered with a minimum of 24 inches of dirt. All waste material will be contained to prevent scattering by the wind using either a dumpster or netting.
- H. All trash and debris will be buried or removed from the wellsite within 30 days after finishing drilling and/or completion operations.

8. ANCILIARY FACILITIES:

- A. None Required.

10. PLANS FOR RESTORATION OF THE SURFACE:

- A. After completion of drilling and/or completion operations, all equipment and other material not needed for operations will be removed. Pits will be filled and the location cleaned of all trash and junk to leave the wellsite contoured as before construction.
- B. Any unguarded pits containing fluids will be fenced until they are filled.
- C. If the proposed well is non-productive, all rehabilitation and/or vegetation requirements of the Bureau of Land Management will be complied with and will be accomplished as expeditiously as possible. All pits will be filled and leveled within 90 days after abandonment.

11. OTHER INFORMATION:

- A. Topography: From the wellsite elevation of 3594', the land surface in the vicinity of the wellsite is on a 1.3':100' northwest facing slope that drains toward a draw 800' north of the location that drains to the Pecos River, 6500' to the west. The location has 3 to 4 foot coppice sand dunes.
- B. Soil: The topsoil at the wellsite is sandy loam with outcrops of gypsum rock.
- C. Flora and Fauna: The vegetative cover consists of a fair cover of grass, mainly grama, dropseed, three-awn, tabosa and blue stem grass along with mesquite, yucca, cacti and miscellaneous wildflowers. The wildlife consists of rabbits, coyotes, antelope, rattlesnakes, lizards, dove, quail and other wildlife typical of the semi-arid desert land.
- D. Residences and Other Structures: None in the area.
- E. Ponds and streams: There are ponds formed intermittently in the draw north of the location and the Pecos River is 6500 feet to the west.
- F. Land Use: Cattle grazing.
- G. Surface Ownership: The proposed wellsite and access road are on Federal surface leases to David McCrear. The minerals are Federal.
- H. There is no visible evidence of archaeological, historical or cultural sites in the area. An archaeological survey has been conducted by Archaeological Survey Consultants, P.O. Box D, Roswell, NM 88201, and their report has been submitted to the appropriate government agencies.

R. 24 E. 8E-8

R. 25 E.

R. 26 E

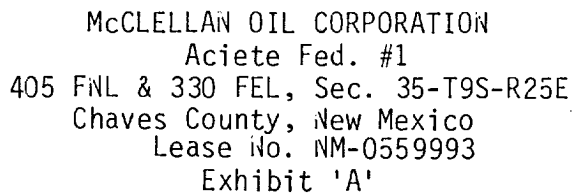

DEPARTMENT OF THE INTERIOR
GEOLOGICAL SURVEY

22°30'

590000E

560

R. 25 E. R. 26 E.

20' 562

ACIETE FED 1

N

BITTER LAKE NATIONAL WILDLIFE FUGE

MM FED No. 2

EXISTING

P/L R/W

36

31

35

3600

3592

3620

3649

3700

3750

3650

3660

3676

3700

3750

3769

3770

3780

3790

3800

3810

3820

3830

3840

3850

3860

3870

3880

3890

3900

3910

3920

3930

3940

3950

3960

3970

3980

3990

4000

4010

4020

4030

4040

4050

4060

4070

4080

4090

4100

4110

4120

4130

4140

4150

4160

4170

4180

4190

4200

4210

4220

4230

4240

4250

4260

4270

4280

4290

4300

4310

4320

4330

4340

4350

4360

4370

4380

4390

4400

4410

4420

4430

4440

4450

4460

4470

4480

4490

4500

4510

4520

4530

4540

4550

4560

4570

4580

4590

4600

4610

4620

4630

4640

4650

4660

4670

4680

4690

4700

4710

4720

4730

4740

4750

4760

4770

4780

4790

4800

4810

4820

4830

4840

4850

4860

4870

4880

4890

4900

4910

4920

4930

4940

4950

4960

4970

4980

4990

5000

5010

5020

5030

5040

5050

5060

5070

5080

5090

5100

5110

5120

5130

5140

5150

5160

5170

5180

5190

5200

5210

5220

5230

5240

5250

5260

5270

5280

5290

5300

5310

5320

5330

5340

5350

5360

5370

5380

5390

5400

5410

5420

5430

5440

5450

5460

5470

5480

5490

5500

5510

5520

5530

5540

5550

5560

5570

5580

5590

5600

5610

5620

5630

5640

5650

5660

5670

5680

5690

5700

5710

5720

5730

5740

5750

5760

5770

5780

5790

5800

5810

5820

5830

5840

5850

5860

5870

5880

5890

5900

5910

5920

5930

5940

5950

5960

5970

5980

5990

6000

6010

6020

6030

6040

6050

6060

6070

6080

6090

6100

6110

6120

6130

6140

6150

6160

6170

6180

6190

6200

6210

6220

6230

6240

6250

6260

6270

6280

6290

6300

6310

6320

6330

6340

6350

6360

6370

6380

6390

6400

6410

6420

6430

6440

6450

6460

6470

6480

6490

6500

6510

</

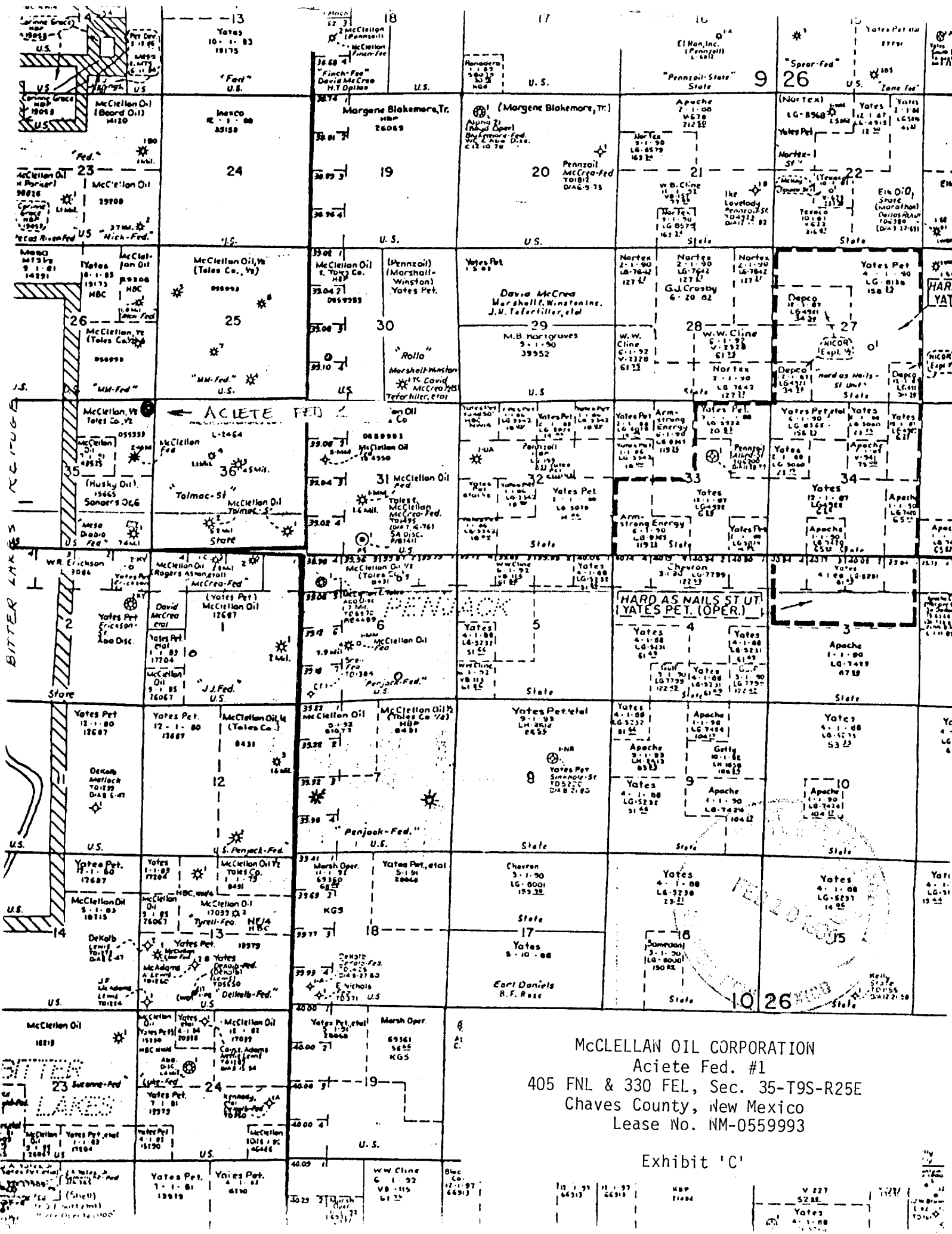

McCLELLAN OIL CORPORATION
Aciete Fed. #1
405 FNL & 330 FEL, Sec. 35-T9S-R25E
Chaves County, New Mexico
Lease No. NM-0559993

Exhibit 'C'

