

Submit to Appropriate  
District Office  
State Lease - 6 copies  
Fee Lease - 5 copies

State of New Mexico  
Energy, Minerals and Natural Resources Department

Form C-101  
Revised 1-1-89

OIL CONSERVATION DIVISION

P.O. Box 2088  
Santa Fe, New Mexico 87504-2088

DISTRICT I  
P.O. Box 1980, Hobbs, NM 88240

DISTRICT II  
P.O. Drawer DD, Artesia, NM 88210

DISTRICT III  
1000 Rio Brazos Rd., Aztec, NM 87410

JAN 26 '90

API NO. (assigned by OCD on New Wells)

31-005-62764

5. Indicate Type of Lease

STATE ☒

FEE ☐

6. State Oil & Gas Lease No.

LG-5246

APPLICATION FOR PERMIT TO DRILL, DEEPEN, OR PLUG BACK

1a. Type of Work:

DRILL ☒

RE-ENTER ☐

DEEPEN ☐

PLUG BACK ☐

b. Type of Well:

OIL  
WELL ☒

GAS  
WELL ☐

OTHER ☐

SINGLE  
ZONE ☒

MULTIPLE  
ZONE ☐

7. Lease Name or Unit Agreement Name

Frank "P" State

2. Name of Operator

Collins Oil & Gas Corporation

8. Well No.

7

3. Address of Operator

P.O. Box 2443, Roswell, NM 88202-2443

9. Pool name or Wildcat

Diablo-San-Andres

4. Well Location

Unit Letter P : 990 Feet From The South Line and 990 Feet From The East Line

Section 21 Township 10S Range 27E NMPM Chaves County

10. Proposed Depth

2150

11. Formation

San-Andres

12. Rotary or C.T.

CT

13. Elevations (Show whether DF, RT, GR, etc.)

3850 GL

14. Kind & Status Plug. Bond

Single

15. Drilling Contractor

Collins O/G

16. Approx. Date Work will start

3-1-90

17.

PROPOSED CASING AND CEMENT PROGRAM

SIZE OF HOLE	SIZE OF CASING	WEIGHT PER FOOT	SETTING DEPTH	SACKS OF CEMENT	EST. TOP
12 1/2"	8-5/8	23	420	circulate	
8"	4 1/2"	9.5	2160	200	

Post #D-1  
2-9-90  
New Line & API

APPROVAL VALID FOR 180 DAYS  
PERMIT EXPIRED 7/6/90  
UNLESS DRILLING UNDERWAY

IN ABOVE SPACE DESCRIBE PROPOSED PROGRAM: IF PROPOSAL IS TO DEEPEN OR PLUG BACK, GIVE DATA ON PRESENT PRODUCTIVE ZONE AND PROPOSED NEW PRODUCTIVE ZONE. GIVE BLOWOUT PREVENTER PROGRAM, IF ANY.

I hereby certify that the information above is true and complete to the best of my knowledge and belief.

SIGNATURE

Roy D. Collins

TITLE Pres. Collins Oil & Gas Company DATE 1/25/90

TYPE OR PRINT NAME

ROY D. COLLINS

TELEPHONE NO. 623-2040

(This space for State Use)

ORIGINAL SIGNED BY

MIKE WILLIAMS

APPROVED BY

SUPERVISOR, DISTRICT II

TITLE

DATE

FEB 6 1990

CONDITIONS OF APPROVAL, IF ANY:

All distances must be from the outer boundaries of the Section.

Operator Collins Oil & Gas Corporation			Lease FRANK P. STATE		Well No. 7
Unit Letter P	Section 21	Township 10 SOUTH	Range 27 EAST	County CHAVES	
Actual Footage Location of Well: 990 feet from the SOUTH line and 990 feet from the EAST line					
Ground Level Elev. 3850	Producing Formation San-Andres		Pool Diablo-San-Andres	Dedicated Acreage 40 Acres	

1. Outline the acreage dedicated to the subject well by colored pencil or hatchure marks on the plat below.
2. If more than one lease is dedicated to the well, outline each and identify the ownership thereof (both as to working interest and royalty).
3. If more than one lease of different ownership is dedicated to the well, have the interests of all owners been consolidated by communitization, unitization, force-pooling, etc?

☐ Yes ☐ No If answer is "yes," type of consolidation \_\_\_\_\_

If answer is "no," list the owners and tract descriptions which have actually been consolidated. (Use reverse side of this form if necessary.) \_\_\_\_\_

No allowable will be assigned to the well until all interests have been consolidated (by communitization, unitization, forced-pooling, or otherwise) or until a non-standard unit, eliminating such interests, has been approved by the Division.

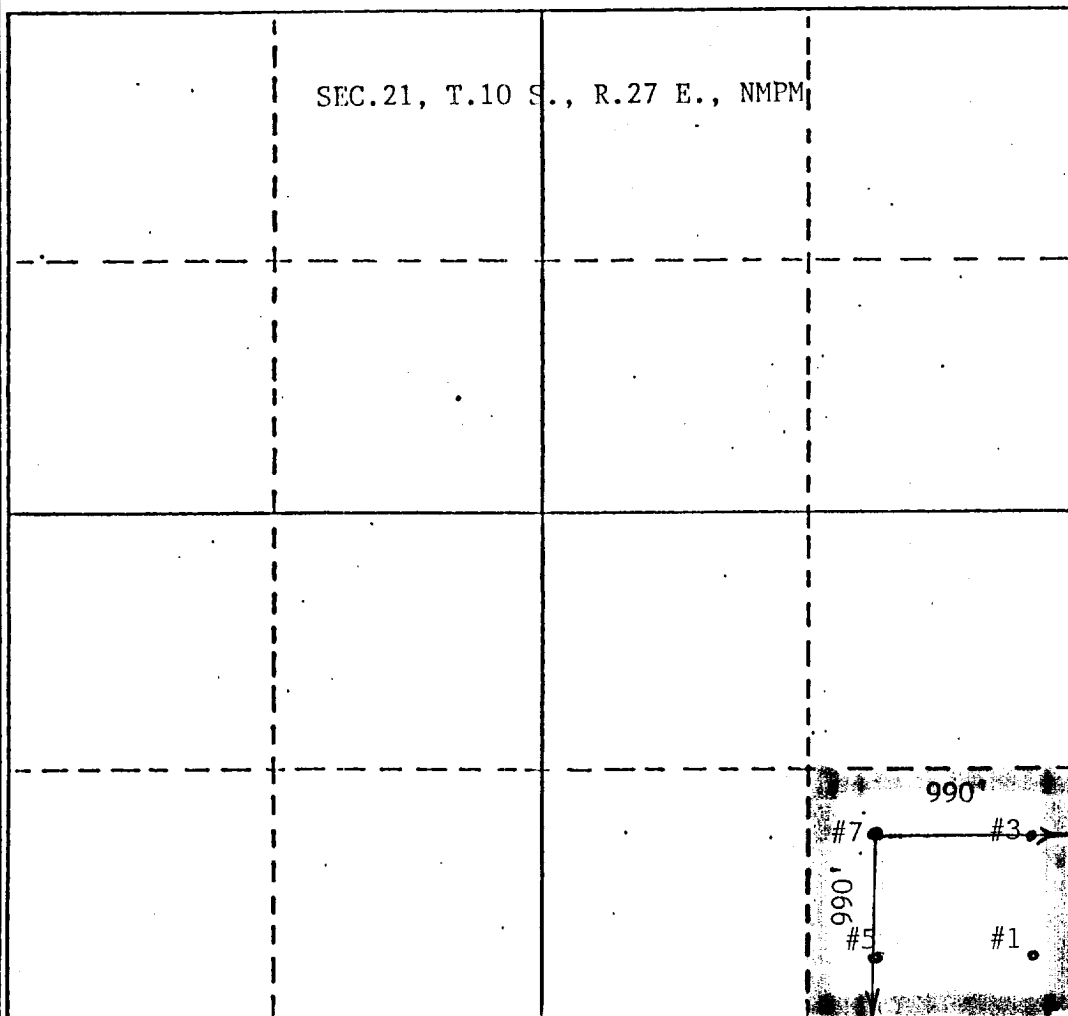

#### CERTIFICATION

I hereby certify that the information contained herein is true and complete to the best of my knowledge and belief.

*Roy H. Collins*  
Name  
Roy Collins, President  
Position  
President  
Company  
Collins OIL & Gas Corporation  
Date  
1/25/90

I hereby certify that the well location shown on this plat was plotted from field notes of actual surveys made by me or under my supervision, and that the same is true and correct to the best of my knowledge and belief.

Date Surveyed  
OCTOBER 14, 1987  
Registered Professional Engineer  
and/or Land Surveyor  
John D. Jaquess  
6290  
Professional Engineer U.S.