

State of New Mexico  
Energy, Minerals and Natural Resources Department

Form C-101  
Revised 1-1-89

Submit to Appropriate  
District Office  
State Lease - 6 copies  
Fee Lease - 5 copies

OIL CONSERVATION DIVISION

P.O. Box 2088  
Santa Fe, New Mexico 87504-2088

DISTRICT I  
P.O. Box 1980, Hobbs, NM 88240

DISTRICT II  
P.O. Drawer DD, Artesia, NM 88210

DISTRICT III  
1000 Rio Brazos Rd., Aztec, NM 87410

API NO. (assigned by OCD on New Wells)

30-005-62776

5. Indicate Type of Lease

STATE  FEE

6. State Oil & Gas Lease No.

LG-5246

MAR 15 '90

APPLICATION FOR PERMIT TO DRILL, DEEPEN, OR PLUG BACK

1a. Type of Work:

DRILL  RE-ENTER  DEEPEN  PLUG BACK

b. Type of Well:

OIL WELL  GAS WELL  OTHER  SINGLE ZONE  MULTIPLE ZONE

7. Lease Name or Unit Agreement Name

Paula "K" State

2. Name of Operator

Collins Oil & Gas Corporation

8. Well No.

3

3. Address of Operator

P.O. Box 2443, Roswell, NM 88202-2443

9. Pool name or Wildcat

Diablo-San-Andres

4. Well Location

Unit Letter J : 1650 Feet From The South Line and 2222 Feet From The East Line

Section 21 Township 10S Range 27E NMPM Chaves County

10. Proposed Depth

2100

11. Formation

San-Andres

12. Rotary or C.T.

CT

13. Elevations (Show whether DF, RT, GR, etc.)

3826 GL

14. Kind & Status Plug. Bond

Blanket

15. Drilling Contractor

Collins O/G

16. Approx. Date Work will start

5/20/90

17. PROPOSED CASING AND CEMENT PROGRAM

SIZE OF HOLE	SIZE OF CASING	WEIGHT PER FOOT	SETTING DEPTH	SACKS OF CEMENT	EST. TOP
12 1/2"	8-5/8"	23	500	sufficient to circulate	
8"	4 1/2"	10.50	2100	200	

Part ID-1  
3-23-90  
New Loc + API

APPROVAL VALID FOR 100 DAYS  
9/21/90

IN ABOVE SPACE DESCRIBE PROPOSED PROGRAM: IF PROPOSAL IS TO DEEPEN OR PLUG BACK, GIVE DATA ON PRESENT PRODUCTIVE ZONE AND PROPOSED NEW PRODUCTIVE ZONE. GIVE BLOWOUT PREVENTER PROGRAM, IF ANY.

I hereby certify that the information above is true and complete to the best of my knowledge and belief.

SIGNATURE ROY D. COLLINS TITLE Pres. Collins Oil & Gas Corp DATE 3/15/90

TYPE OR PRINT NAME ROY D. COLLINS TELEPHONE NO 623-2040

(This space for State Use) ORIGINAL SIGNED BY MIKE WILLIAMS SUPERVISOR, DISTRICT II DATE MAR 21 1990

APPROVED BY \_\_\_\_\_ TITLE \_\_\_\_\_ DATE \_\_\_\_\_

CONDITIONS OF APPROVAL, IF ANY:

All distances must be from the outer boundaries of the Section.

Operator Collins Oil & Gas Corp.		Lease Paula (K) State			Well No. 3
Unit Letter J	Section 21	Township 10 South	Range 27 East	County Chaves	
Actual Footage Location of Well: 2222 feet from the East line and 1650 feet from the South line					
Ground Level Elev. 3826	Producing Formation San-Andres	Pool Diablo-San-Andres		Dedicated Acreage 40 Acres	

1. Outline the acreage dedicated to the subject well by colored pencil or hachure marks on the plat below.
2. If more than one lease is dedicated to the well, outline each and identify the ownership thereof (both as to working interest and royalty).
3. If more than one lease of different ownership is dedicated to the well, have the interests of all owners been consolidated by communitization, unitization, force-pooling, etc?

Yes  No If answer is "yes," type of consolidation \_\_\_\_\_

If answer is "no," list the owners and tract descriptions which have actually been consolidated. (Use reverse side of this form if necessary.) \_\_\_\_\_

No allowable will be assigned to the well until all interests have been consolidated (by communitization, unitization, forced-pooling, or otherwise) or until a non-standard unit, eliminating such interests, has been approved by the Division.

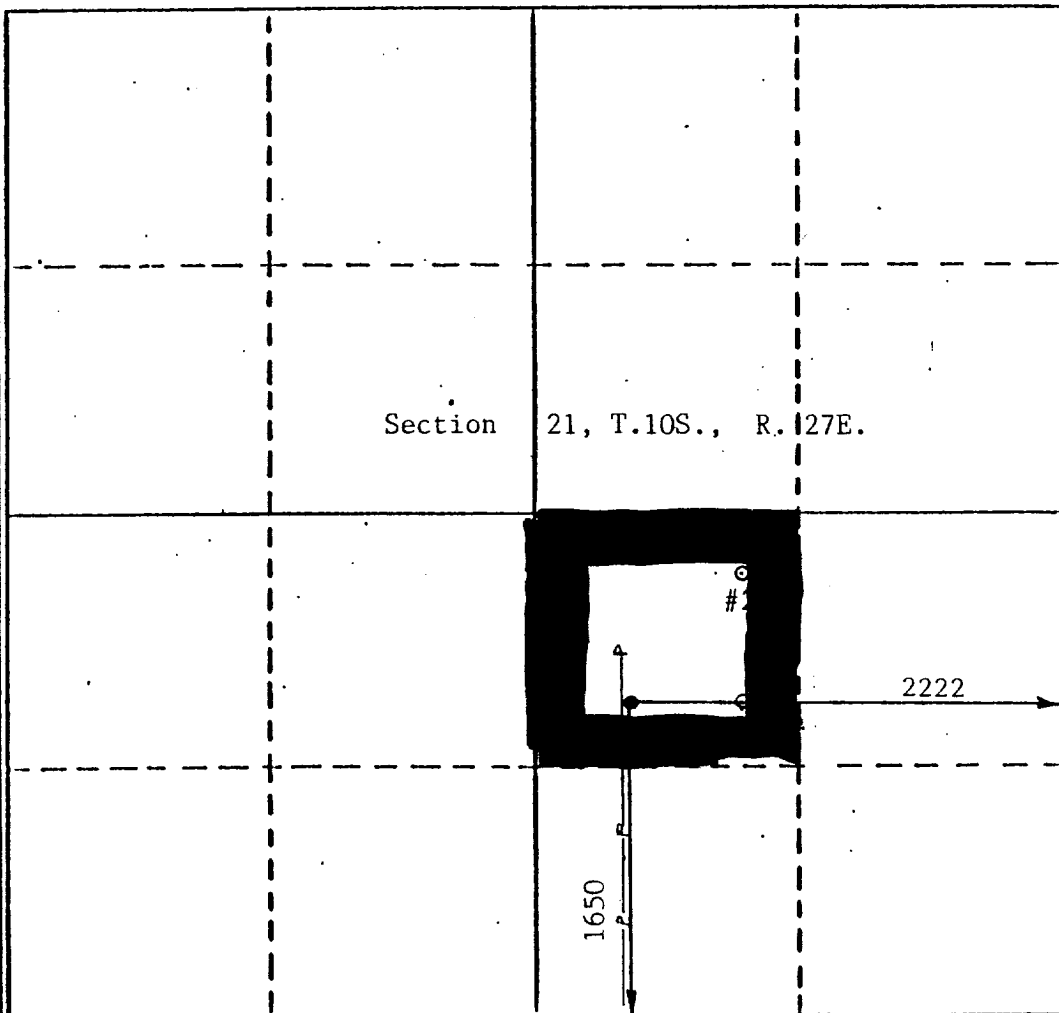

CERTIFICATION

I hereby certify that the information contained herein is true and complete to the best of my knowledge and belief.

Name  
*Ray H. Collins*

Position  
Pres. Collins Oil & Gas Corp.

Company  
Collins Oil & Gas Corp.

Date  
3/15/90

I hereby certify that the well location shown on this plat was plotted from field notes of actual surveys made by me or under my supervision, and that the same is true and correct to the best of my knowledge and belief.

DATE SURVEYED  
February 26, 1990

REGISTERED PROFESSIONAL ENGINEER AND/OR LAND SURVEYOR  
JOHN D. JAQUES, P.E. & L.S.

Certificate No. 6290

*B. B. P. 6970*