

All distances must be from the outer boundaries of the Section.

| | | | | | | | | |
|----------------------------------------------------------------------------------------------------|----------------------------|---------------------|-------------------------|--------------------------------------------------------------|--|--------------------------------|--|--|
| Operator Yates Petroleum Corporation | | | Lease Hewitt Federal | | | Well No. #3 | | |
| Unit Letter L | Section 21 | Township 6 South | Range 25 East | County BUREAU OF LAND MANAGEMENT ROSSELL RESOURCE AREA | | | | |
| Actual Footage Location of Wells: 660 feet from the West line and 1980 feet from the South line | | | | | | | | |
| Ground Level Elev. 3837 | Producing Formation Abo | | Pool Pecos Slope Abo | | | Dedicated Acreage 160 Acres | | |

1. Outline the acreage dedicated to the subject well by colored pencil or hachure marks on the plat below.
2. If more than one lease is dedicated to the well, outline each and identify the ownership thereof (both as to working interest and royalty).
3. If more than one lease of different ownership is dedicated to the well, have the interests of all owners been consolidated by communitization, unitization, force-pooling, etc?

☐ Yes ☐ No If answer is "yes," type of consolidation _____

If answer is "no," list the owners and tract descriptions which have actually been consolidated. (Use reverse side of this form if necessary.) _____

No allowable will be assigned to the well until all interests have been consolidated (by communitization, unitization, forced-pooling, or otherwise) or until a non-standard unit, eliminating such interests, has been approved by the Division.

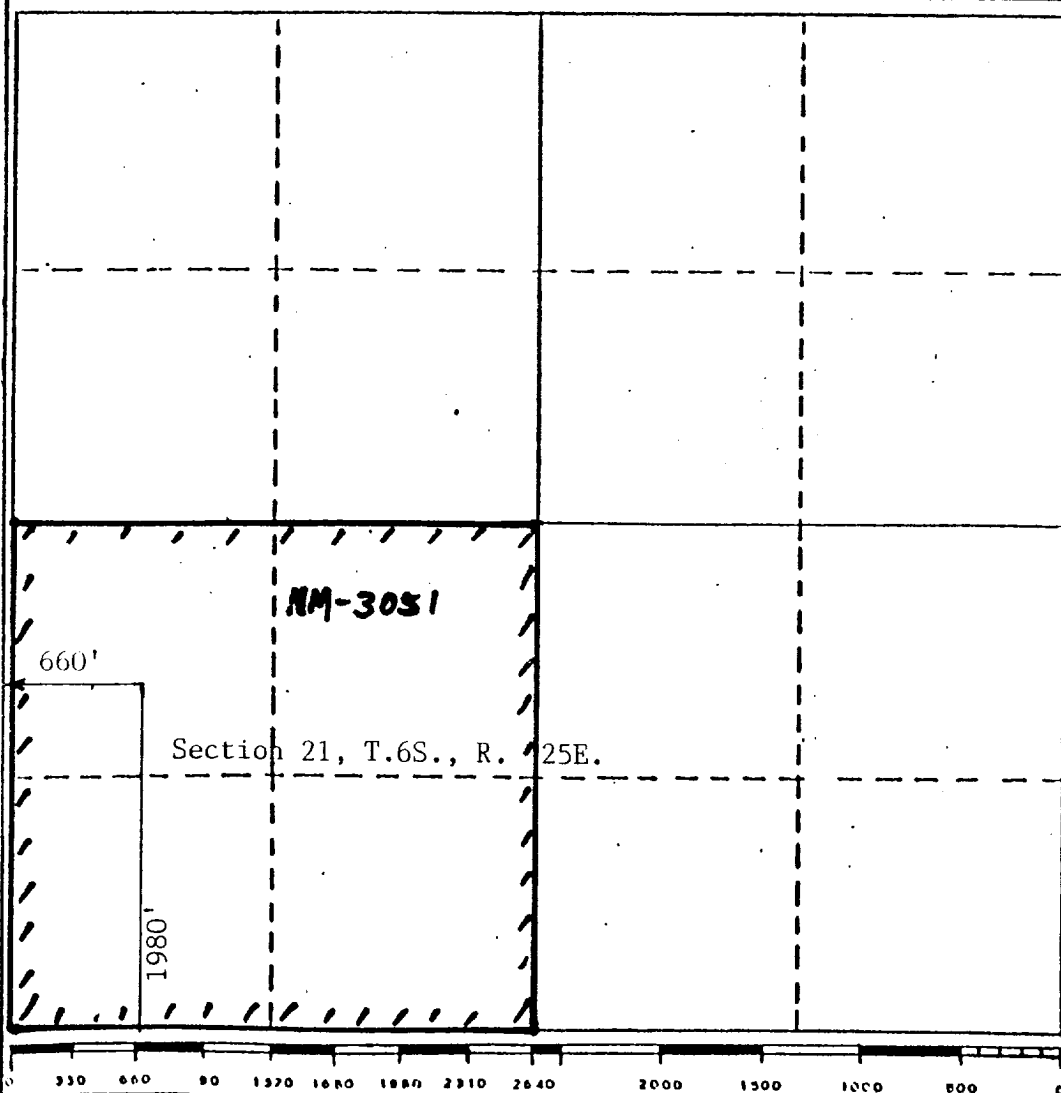

CERTIFICATION

I hereby certify that the information contained herein is true and complete to the best of my knowledge and belief.

Clifton R. May

Name
Clifton R. May
Position
Permit Agent
Company
Yates Petroleum Corporation
Date
3-21-90

I hereby certify that the well location shown on this plat was plotted from field notes of actual surveys made by me or under my supervision, and that the same is true and correct to the best of my knowledge and belief.

John D. Jaquess
March 14, 1990

Date Surveyed
6290
Registered Professional Engineer and/or Land Surveyor
John D. Jaquess, E.S. & L.S.
Certificate No. 6290