

Submit to Appropriate  
District Office  
State Lease - 6 copies  
Fee Lease - 5 copies

State of New Mexico  
Energy, Minerals and Natural Resources Department

Form C-101  
Revised 1-1-89

OIL CONSERVATION DIVISION

DISTRICT I  
P.O. Box 1980, Hobbs, NM 88240

DISTRICT II  
P.O. Drawer DD, Artesia, NM 88210

DISTRICT III  
1000 Rio Brazos Rd., Aztec, NM 87410

P.O. Box 2088  
Santa Fe, New Mexico 87504-2088  
MAY -9 '90

API NO. (assigned by OCD on New Wells)

30-005-62785

5. Indicate Type of Lease

STATE ☒

FEE ☐

6. State Oil & Gas Lease No.

E-3614

APPLICATION FOR PERMIT TO DRILL, DEEPEN, OR PLUG BACK

1a. Type of Work:

DRILL ☒

RE-ENTER ☐

DEEPEN ☐

PLUG BACK ☐

b. Type of Well:

OIL  
WELL ☒

GAS  
WELL ☐

OTHER ☐

SINGLE  
ZONE ☐

MULTIPLE  
ZONE ☐

7. Lease Name or Unit Agreement Name

Standard State

2. Name of Operator

Mountain States Petroleum Corporation

8. Well No.

7

3. Address of Operator

Post Office Box 1936, Roswell, N.M. 88201

9. Pool name or Wildcat

X Acme San Andres

4. Well Location

Unit Letter B : 2310 Feet From The East Line and 990 Feet From The North Line

Section 5 Township 8 South Range 27 East NMPM Chaves County

10. Proposed Depth

2200'

11. Formation

San Andres

12. Rotary or C.T.

Rotary

13. Elevations (Show whether DF, RT, GR, etc.)

4005

14. Kind & Status Plug. Bond

Blanket

15. Drilling Contractor

United Drilling

16. Approx. Date Work will start

5-14-90

17.

PROPOSED CASING AND CEMENT PROGRAM

SIZE OF HOLE	SIZE OF CASING	WEIGHT PER FOOT	SETTING DEPTH	SACKS OF CEMENT	EST. TOP
12-1/4"	8-5/8"	24#	300'	170	
7-7/8"	4-1/2"	9.5#	2200'	240	

Drill 12-1/4" hole to a depth of 300'+. Run 300' of 8-5/8" casing and circulate Class C cement. Drill 7-7/8" hole down to a depth of 2200'+. Run logging tools. Run 2200' of 4-1/2" casing. Pump 240 SXS Class C cement. Perforate casing and test well.

APPROVAL VALID FOR 180 DAYS  
PERMIT EXPIRES 11/9/90  
UNLESS DRILLING UNDERWAY

IN ABOVE SPACE DESCRIBE PROPOSED PROGRAM: IF PROPOSAL IS TO DEEPEN OR PLUG BACK, GIVE DATA ON PRESENT PRODUCTIVE ZONE AND PROPOSED NEW PRODUCTIVE ZONE. GIVE BLOWOUT PREVENTER PROGRAM, IF ANY.

I hereby certify that the information above is true and complete to the best of my knowledge and belief.

SIGNATURE Roger P. Slayton TITLE President DATE 5-8-90

TYPE OR PRINT NAME ROGER P. SLAYTON TELEPHONE NO. 6237184

(This space for State Use)

ORIGINAL SIGNED BY  
MIKE WILLIAMS

APPROVED BY SUPERVISOR, DISTRICT II

TITLE

DATE

MAY 7 1990

CONDITIONS OF APPROVAL, IF ANY:

All distances must be from the outer boundaries of the Section.

Operator		Lease Standard State		Well No. 7
Unit Letter B	Section 5	Township 8 South	Range 27 East	County Chaves
Actual Footage Location of Well:				
2,310 feet from the east		line and 990 feet from the north		line
Ground Level Elev. 4005.00	Producing Formation SH	Pool Acres 20	Dedicated Acreage: 40 Acres	

1. Outline the acreage dedicated to the subject well by colored pencil or hachure marks on the plat below.
2. If more than one lease is dedicated to the well, outline each and identify the ownership thereof (both as to working interest and royalty).
3. If more than one lease of different ownership is dedicated to the well, have the interests of all owners been consolidated by communitization, unitization, force-pooling, etc?

☐ Yes ☐ No If answer is "yes," type of consolidation \_\_\_\_\_

If answer is "no," list the owners and tract descriptions which have actually been consolidated. (Use reverse side of this form if necessary.) \_\_\_\_\_

No allowable will be assigned to the well until all interests have been consolidated (by communitization, unitization, forced-pooling, or otherwise) or until a non-standard unit, eliminating such interests, has been approved by the Division.

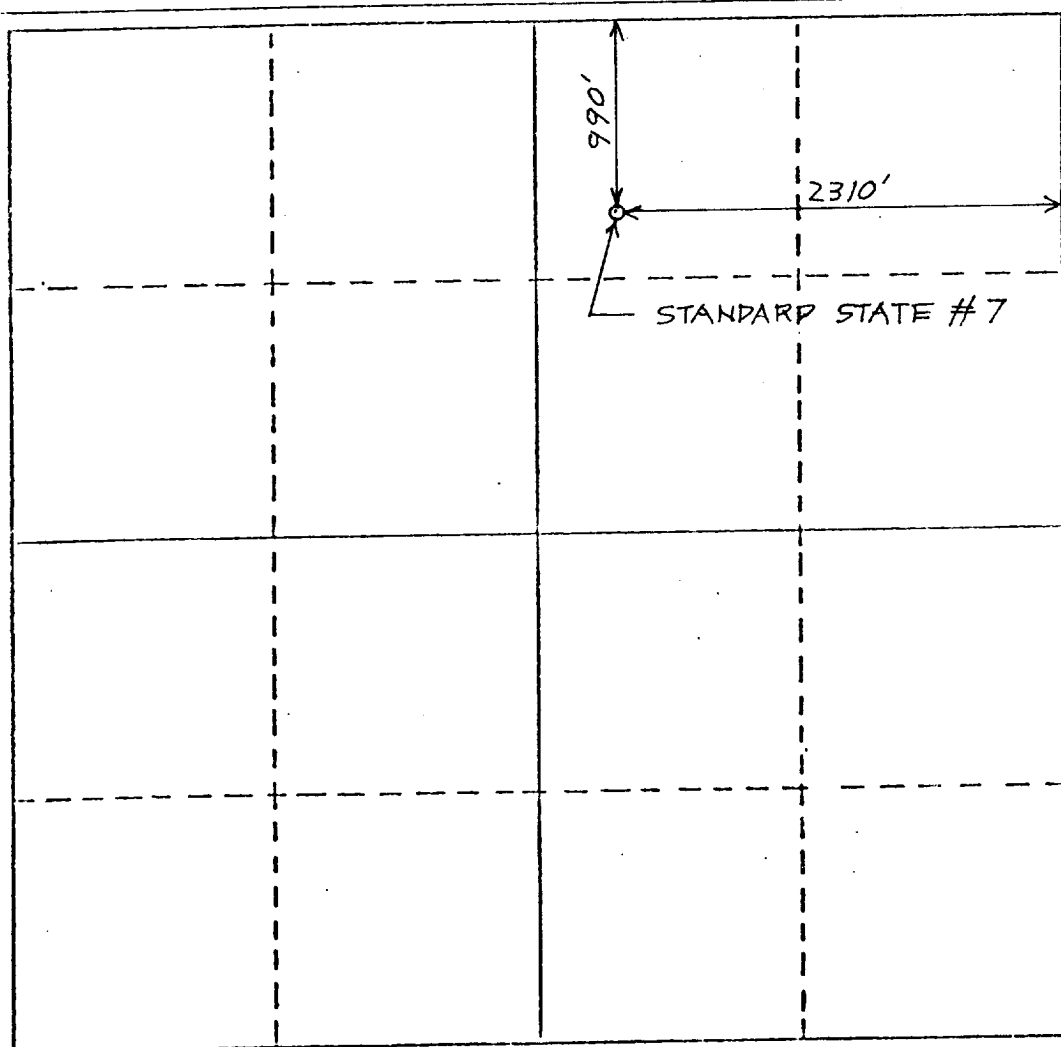

CERTIFICATION

I hereby certify that the information contained herein is true and complete to the best of my knowledge and belief.

Name  
Robert P. Wright  
Position  
President  
Company  
Mountain States Pet.  
Date  
5-8-90

I hereby certify that the well location shown on this plat was plotted from field notes of actual surveys made by me or under my supervision, and that the same is true and correct to the best of my knowledge and belief.

May 4, 1990  
Date Surveyed  
Registered Professional Engineer  
and/or Land Surveyor  
Certificate No. 7929

0 330 660 990 1320 1650 1980 2310 2640 2970 3300 3630 3960 4290 4620 4950 5280 5610 5940 6270 6600

10" Rotating Head

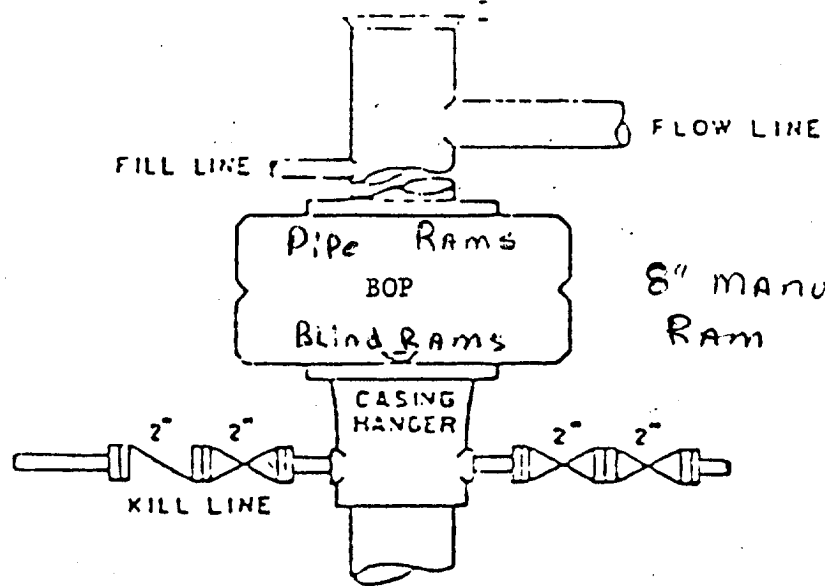

8" Manual Double  
Ram B.O.P. 3000#

BOP STACK

BOP ARRANGEMENT