

# OIL CONSERVATION DIVISION

P.O. Box 2088

Santa Fe, New Mexico 87504-2088

**DISTRICT I**  
P.O. Box 1980, Hobbs, NM 88240

**DISTRICT II**  
P.O. Drawer DD, Artesia, NM 88210

**DISTRICT III**  
1000 Rio Brazos Rd., Aztec, NM 87410

## WELL LOCATION AND ACREAGE DEDICATION PLAT

All Distances must be from the outer boundaries of the section

Operator Stevens Operating Corporation			Lease McBride State		Well No. 3
Unit Letter G	Section 28	Township 10 South	Range 27 East	County Chaves	
Actual Footage Location of Well: 1675 feet from the North line and 2310 feet from the East line					
Ground level Elev. 3810	Producing Formation Fusselman	Pool Diablo Fusselman		Dedicated Acreage: 80 Acres	

- Outline the acreage dedicated to the subject well by colored pencil or hatchure marks on the plat below.
- If more than one lease is dedicated to the well, outline each and identify the ownership thereof (both as to working interest and royalty).
- If more than one lease of different ownership is dedicated to the well, have the interest of all owners been consolidated by communitization, unitization, force-pooling, etc.?  
☐ Yes ☐ No If answer is "yes" type of consolidation \_\_\_\_\_  
If answer is "no" list the owners and tract descriptions which have actually been consolidated. (Use reverse side of this form if necessary.) \_\_\_\_\_  
No allowable will be assigned to the well until all interests have been consolidated (by communitization, unitization, forced-pooling, or otherwise) or until a non-standard unit, eliminating such interest, has been approved by the Division.

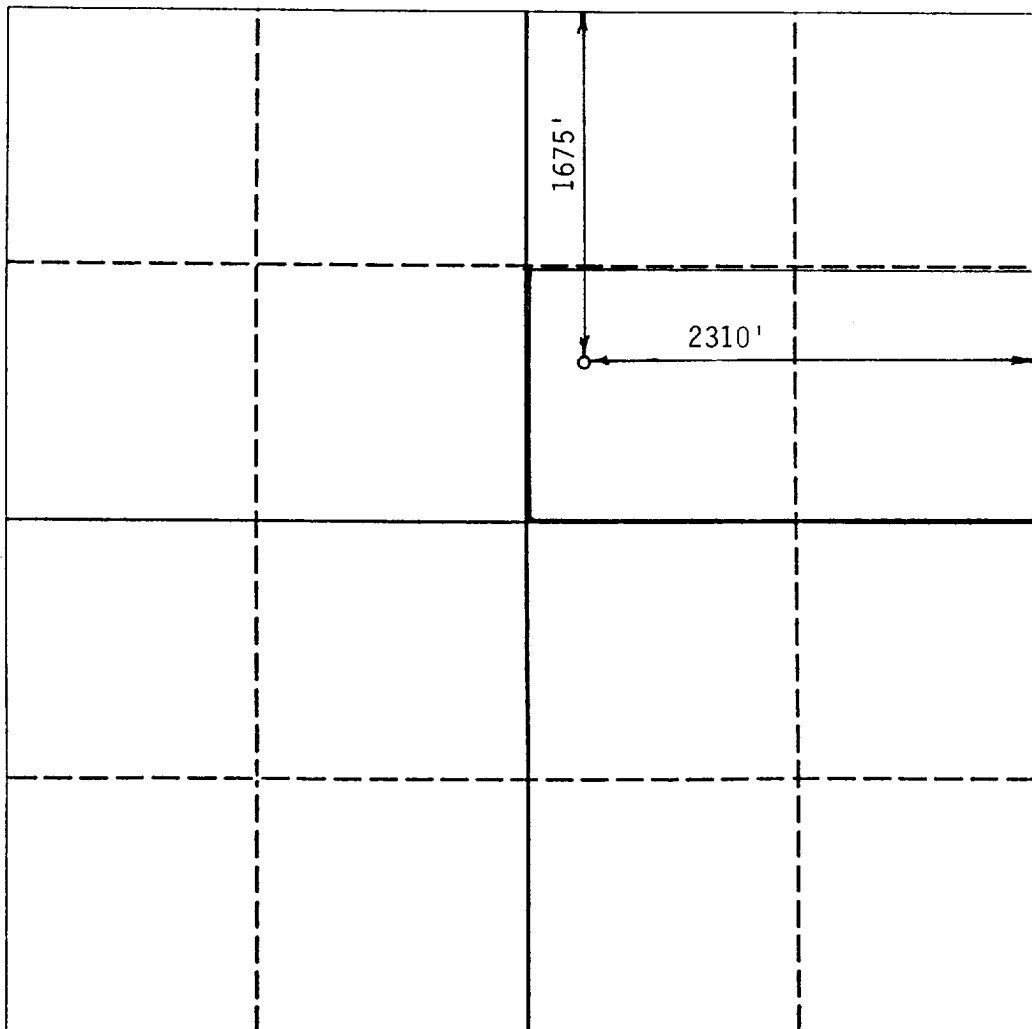

### OPERATOR CERTIFICATION

I hereby certify that the information contained herein is true and complete to the best of my knowledge and belief.

Signature  
*Bob Farmer*  
Printed Name  
Bob Farmer  
Position  
Production Supt.  
Company  
Stevens Oper. Corp.  
Date  
September 21, 1990

### SURVEYOR CERTIFICATION

I hereby certify that the well location shown on this plat was plotted from field notes of actual surveys made by me or under my supervision, and that the same is true and correct to the best of my knowledge and belief.

Date Surveyed  
September 22, 1990

Signature & Seal of  
Professional Surveyor  
P.R. Patton

Certificate No.

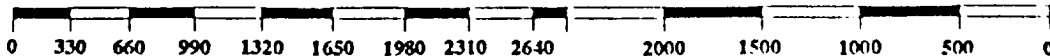
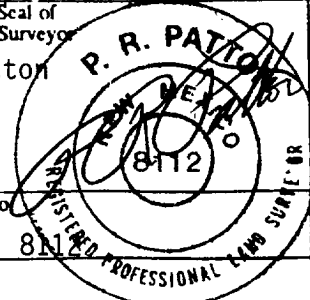

Submit to Appropriate  
District Office  
State Lease - 6 copies  
Fee Lease - 5 copies

State of New Mexico  
Energy, Minerals and Natural Resources Department

Form C-101  
Revised 1-1-89

OIL CONSERVATION DIVISION

P.O. Box 2088  
Santa Fe, New Mexico 87504-2088

DISTRICT I  
P.O. Box 1980, Hobbs, NM 88240

DISTRICT II  
P.O. Drawer DD, Artesia, NM 88210

DISTRICT III  
1000 Rio Brazos Rd., Aztec, NM 87410

SEP 25 '90

API NO. (assigned by OCD on New Wells)

30-005-62798

5. Indicate Type of Lease

STATE ☒ FEE ☐

6. State Oil & Gas Lease No.

LG-7426

APPLICATION FOR PERMIT TO DRILL, DEEPEN, OR PLUG BACK

1a. Type of Work:

DRILL ☒

RE-ENTER ☐

DEEPEN ☐

PLUG BACK ☐

b. Type of Well:

OIL WELL ☒

GAS WELL ☐

OTHER ☐

SINGLE ZONE ☒

MULTIPLE ZONE ☐

7. Lease Name or Unit Agreement Name

McBride State

2. Name of Operator

Stevens Operating Corporation

8. Well No.

#3

3. Address of Operator

P. O. Box 2408, Roswell, NM 88201

9. Pool name or Wildcat

Diablo Fusselman

4. Well Location

Unit Letter G : 1675 Feet From The North Line and 2310 Feet From The East Line

Section 28 Township 10S Range 27E NMPM Chaves County

10. Proposed Depth

6370'

11. Formation

Fusselman

12. Rotary or C.T.

Rotary

13. Elevations (Show whether DF, RT, GR, etc.)

3810 GR

14. Kind & Status Plug. Bond

Statewide

15. Drilling Contractor

L&M Drilling

16. Approx. Date Work will start

September 28, 1990

17.

PROPOSED CASING AND CEMENT PROGRAM

SIZE OF HOLE	SIZE OF CASING	WEIGHT PER FOOT	SETTING DEPTH	SACKS OF CEMENT	EST. TOP
20"	16"		30'	Redimix	
14 3/4"	10 3/4"	40.5#	2100' 1000	Circ to Surface	
9 5/8"	7"	23#-26#	6370'	400 sxs	5300'

1. Propose to drill to a depth of 6370' with Intermediate 10 3/4" casing through producing San Andres offset well TD of 2076'. If commercial production is indicated, well will be cased, cemented and tested open hole and/or perforated.

2. If severe lost circulation occurs in formations above 600' well may be cased with 10 3/4", circulating cement to surface, and the 7" casing cemented two stage DV tool, circulating back to 100' above 10 3/4" casing depth.

Part ID-1  
9-28-90  
New Log &  
API

APPROVAL VALID FOR 180 DAYS  
PERMIT EXPIRES 3/25/91  
UNLESS DRILLING UNDERWAY

IN ABOVE SPACE DESCRIBE PROPOSED PROGRAM: IF PROPOSAL IS TO DEEPEN OR PLUG BACK, GIVE DATA ON PRESENT PRODUCTIVE ZONE AND PROPOSED NEW PRODUCTIVE ZONE. GIVE BLOWOUT PREVENTER PROGRAM, IF ANY.

I hereby certify that the information above is true and complete to the best of my knowledge and belief.

SIGNATURE Bob Farmer TITLE Production Supt. DATE 9/24/90

TYPE OR PRINT NAME Bob Farmer 505-622-7273 TELEPHONE NO.

(This space for State Use)

ORIGINAL SIGNED BY  
MIKE WILLIAMS  
SUPERVISOR, DISTRICT II

APPROVED BY \_\_\_\_\_ TITLE \_\_\_\_\_ DATE \_\_\_\_\_

CONDITIONS OF APPROVAL, IF ANY:

SEP 25 1990

# B O P & CHOKE MANIFOLD

SERIES 900

