

Submit to Appropriate
District Office
State Lease - 6 copies
Fee Lease - 5 copies

State of New Mexico
Energy, Minerals and Natural Resources Department

Form C-101
Revised 1-1-89

OIL CONSERVATION DIVISION

P.O. Box 2088
Santa Fe, New Mexico 87504-2088

DISTRICT I
P.O. Box 1980, Hobbs, NM 88240

DISTRICT II
P.O. Drawer DD, Artesia, NM 88210

DISTRICT III
1000 Rio Brazos Rd., Aztec, NM 87410

OCT 19 '90

API NO. (assigned by OCD on New Wells) 30-005-62804
5. Indicate Type of Lease STATE <input checked="" type="checkbox"/> FEE <input type="checkbox"/>
6. State Oil & Gas Lease No. L-6278

APPLICATION FOR PERMIT TO DRILL, DEEPEN, OR PLUG BACK

1a. Type of Work: DRILL <input checked="" type="checkbox"/> RE-ENTER <input type="checkbox"/> DEEPEN <input type="checkbox"/> PLUG BACK <input type="checkbox"/>		7. Lease Name or Unit Agreement Name Hanlad "B" State	
b. Type of Well: OIL WELL <input checked="" type="checkbox"/> GAS WELL <input type="checkbox"/> OTHER <input type="checkbox"/>		8. Well No. 6	
2. Name of Operator Hanson Operating Company, Inc.		9. Pool name or Wildcat Diablo San Andres	
3. Address of Operator P. O. Box 1515, Roswell, New Mexico 88202-1515			
4. Well Location Unit Letter <u>K</u> : <u>1650</u> Feet From The <u>South</u> Line and <u>1650</u> Feet From The <u>West</u> Line Section <u>22</u> Township <u>10S</u> Range <u>27E</u> NMFM Chaves County			

10. Proposed Depth 2150'		11. Formation San Andres		12. Rotary or C.T. C.T.	
13. Elevations (Show whether DF, RT, GR, etc.) 3852' GR		14. Kind & Status Plug. Bond Statewide		15. Drilling Contractor N/A	
16. Approx. Date Work will start 10/29/90					

17. PROPOSED CASING AND CEMENT PROGRAM					
SIZE OF HOLE	SIZE OF CASING	WEIGHT PER FOOT	SETTING DEPTH	SACKS OF CEMENT	EST. TOP
12-1/4"	8-5/8"	24#	500'	150	Circulate
8"	5-1/2"	15#	2150'	450	Circulate

It is proposed to drill the above-mentioned well with cable tools to a depth sufficient to test the San Andres formation. If commercial production is indicated, pipe would be set. The well will be perforated and stimulated as needed.

Part ID-1
9-26-90
Newkirk & APF

APPROVAL VALID FOR 180 DAYS
PERMIT EXPIRES 4/23/91
UNLESS DRILLING UNDERWAY

IN ABOVE SPACE DESCRIBE PROPOSED PROGRAM: IF PROPOSAL IS TO DEEPEN OR PLUG BACK, GIVE DATA ON PRESENT PRODUCTIVE ZONE AND PROPOSED NEW PRODUCTIVE ZONE. GIVE BLOWOUT PREVENTER PROGRAM, IF ANY.

I hereby certify that the information above is true and complete to the best of my knowledge and belief.

SIGNATURE Brenda R. Godfrey TITLE Production Analyst DATE 10/18/90

TYPE OR PRINT NAME

TELEPHONE NO.

(This space for State Use)

ORIGINAL SIGNED BY
MIKE WILLIAMS
SUPERVISOR, DISTRICT II

APPROVED BY _____ TITLE _____ DATE OCT 23 1990

CONDITIONS OF APPROVAL, IF ANY:

44-38861-200-10

100-10

100-10

100-10

100-10

100-10
100-10
100-10

100-10

100-10

State Lease - 4 copies
Fee Lease - 3 copies

SECTION 2-2-88

LAND CONSERVATION DIVISION
P.O. Box 2088
Santa Fe, New Mexico 87504-2088

DISTRICT I
P.O. Box 1980, Hobbs, NM 88240

DISTRICT II
P.O. Drawer DD, Artesia, NM 88210

DISTRICT III
1000 Rio Brazos Rd., Aztec, NM 87410

WELL LOCATION AND ACREAGE DEDICATION PLAT
All Distances must be from the outer boundaries of the section

Operator Hanson Operating Company			Lease Hanlad "B"		Well No. 6
Unit Letter K	Section 22	Township 10 South	Range 27 East	County Chaves	
Actual Footage Location of Well: 1650 feet from the South line and 1650 feet from the West line					
Ground level Elev. 3852'		Producing Formation San Andres		Pool Diablo	
				Dedicated Acreage: 40 Acres	

- 1. Outline the acreage dedicated to the subject well by colored pencil or hatchure marks on the plat below.
- 2. If more than one lease is dedicated to the well, outline each and identify the ownership thereof (both as to working interest and royalty).
- 3. If more than one lease of different ownership is dedicated to the well, have the interest of all owners been consolidated by communization, unitization, force-pooling, etc?
☐ Yes ☐ No If answer is "yes" type of consolidation _____
If answer is "no" list the owners and tract descriptions which have actually been consolidated. (Use reverse side of this form if necessary.) _____
No allowable will be assigned to the well until all interests have been consolidated (by communization, unitization, forced-pooling, or otherwise) or until a non-standard unit, eliminating such interest, has been approved by the Division.

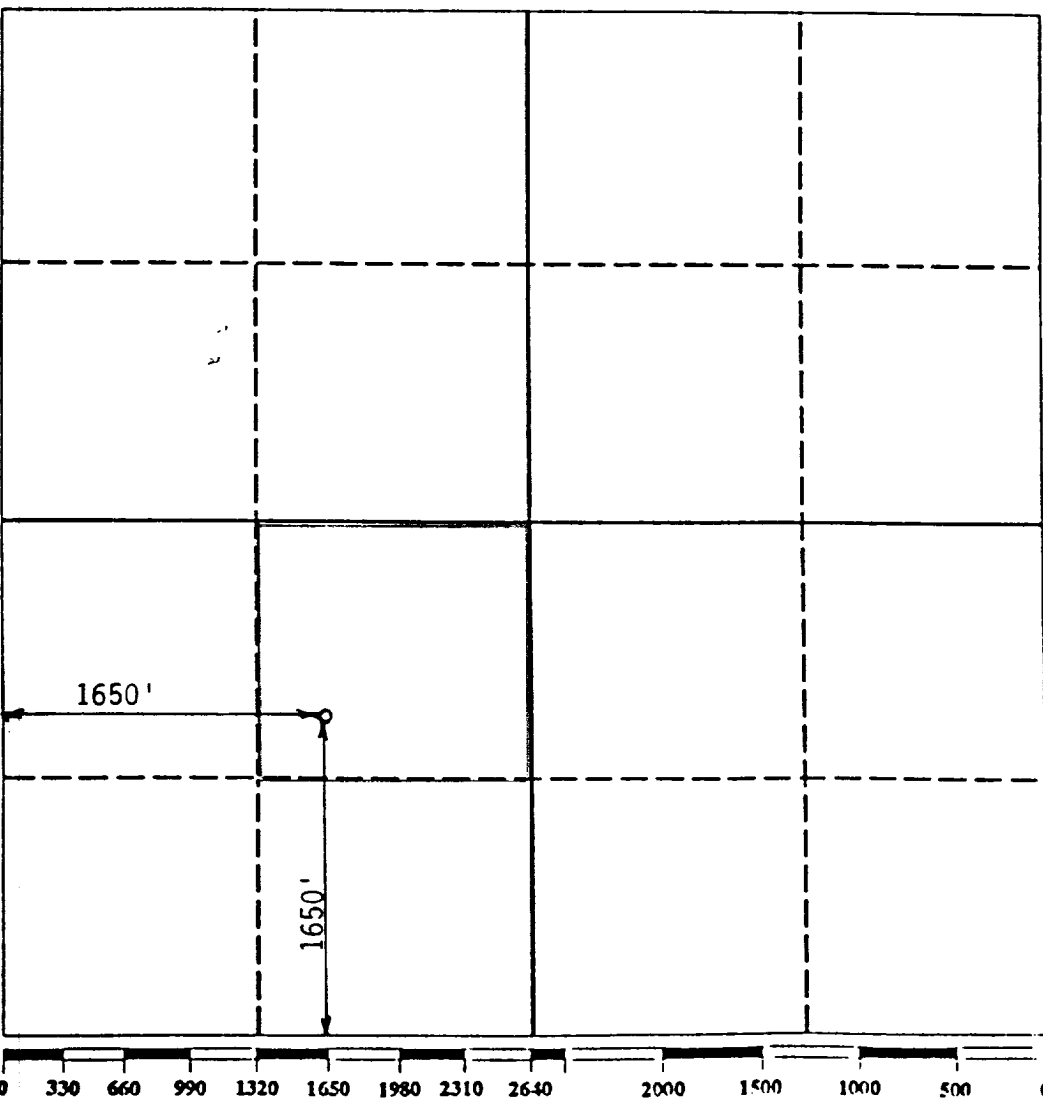

OPERATOR CERTIFICATION
I hereby certify that the information contained herein is true and complete to the best of my knowledge and belief.

Signature: *Brenda R. Godfrey*
Printed Name: **Brenda R. Godfrey**
Position: **Production Analyst**
Company: **Hanson Operating Co., Inc.**
Date: **10/17/90**

SURVEYOR CERTIFICATION
I hereby certify that the well location shown on this plat was plotted from field notes of actual surveys made by me or under my supervision, and that the same is true and correct to the best of my knowledge and belief.

Date Surveyed: **October 2, 1990**
Signature & Seal of Professional Surveyor: *R. Patton*
Certificate No. **8112**