

Submit to Appropriate
District Office
State Lease - 6 copies
Fee Lease - 5 copies

State of New Mexico
Energy, Minerals and Natural Resources Department

Form C-101
Revised 1-1-89

OIL CONSERVATION DIVISION

DISTRICT I
P.O. Box 1980, Hobbs, NM 88240

DISTRICT II
P.O. Drawer DD, Artesia, NM 88210

DISTRICT III
1000 Rio Brazos Rd., Aztec, NM 87410

P.O. Box 2088
Santa Fe, New Mexico 87504-2088

JAN 4 1990

API NO. (assigned by OCD on New Wells) <u>30-105-63822</u>	
5. Indicate Type of Lease STATE <input type="checkbox"/> FEE <input checked="" type="checkbox"/>	
6. State Oil & Gas Lease No.	
7. Lease Name or Unit Agreement Name <u>McQuiddy "AIP"</u> <u>Rolba TC</u>	
8. Well No. <u>2</u>	
9. Pool name or Wildcat <u>Wildcat Ordovician</u>	

10. Proposed Depth <u>6200'</u>	11. Formation <u>Ordovician</u>	12. Rotary or C.T. <u>Rotary</u>
13. Elevations (Show whether DF, RT, GR, etc.) <u>3761' GR</u>	14. Kind & Status Plug Bond <u>Blanket</u>	15. Drilling Contractor <u>Undesignated</u>
16. Approx. Date Work will start <u>ASAP</u>		

PROPOSED CASING AND CEMENT PROGRAM					
SIZE OF HOLE	SIZE OF CASING	WEIGHT PER FOOT	SETTING DEPTH	SACKS OF CEMENT	EST. TOP
<u>12 1/4"</u>	<u>8 5/8"</u>	<u>24# K-55</u>	<u>Approx. 1000'</u>	<u>600 sacks</u>	<u>Circulate</u>
<u>7 7/8"</u>	<u>5 1/2"</u>	<u>15.5# J-55</u>	<u>TD</u>	<u>450 sacks</u>	

We propose to drill and test the Ordovician and intermediate formations. Approximately 1000' of surface casing will be set and cement circulated to shut off gravel and cavings. If commercial, production casing will be run and cemented with adequate cover, perforated and stimulated as needed for production.

MUD PROGRAM: FW gel & LCM to 1000'; cut brine to 4500'; salt water gel & starch to TD.

BOP PROGRAM: BOP's will be tested daily and installed at the offset.

GAS NOT DEDICATED.

APPROVAL VALID FOR 180 DAYS
PERMIT EXPIRES 7/11/91
UNLESS DRILLING UNDERWAY

Post ID-1
1-18-91
New line &
APF

IN ABOVE SPACE DESCRIBE PROPOSED PROGRAM: IF PROPOSAL IS TO DEEPEN OR PLUG BACK, GIVE DATA ON PRESENT PRODUCTIVE ZONE AND PROPOSED NEW PRODUCTIVE ZONE. GIVE BLOWOUT PREVENTER PROGRAM, IF ANY.

I hereby certify that the information above is true and complete to the best of my knowledge and belief.

SIGNATURE Clifton R. May TITLE Permit Agent DATE 1-4-91
TYPE OR PRINT NAME Clifton R. May TELEPHONE NO. 748-1471

(This space for State Use)

ORIGINAL SIGNED BY
MIKE WILLIAMS
SUPERVISOR, DISTRICT I?

APPROVED BY _____ TITLE _____ DATE JAN 11 1991

CONDITIONS OF APPROVAL, IF ANY:

Submit to Appropriate
District Office
State Lease - 4 copies
Fee Lease - 3 copies

State of New Mexico
Energy, Minerals and Natural Resources Department

Form C-102
Revised 1-1-89

OIL CONSERVATION DIVISION

P.O. Box 2088
Santa Fe, New Mexico 87504-2088

DISTRICT I
P.O. Box 1980, Hobbs, NM 88240

DISTRICT II
P.O. Drawer DD, Artesia, NM 88210

DISTRICT III
1000 Rio Brazos Rd., Aztec, NM 87410

WELL LOCATION AND ACREAGE DEDICATION PLAT

All Distances must be from the outer boundaries of the section

Operator YATES PETROLEUM CORPORATION		Lease Rolla TC McQUIDDY "A1H"		Well No. 2	
Unit Letter G	Section 29	Township 9 SOUTH	Range 26 EAST	County NMNM CHAVES	
Actual Footage Location of Well: 2310 feet from the EAST line and 1980 feet from the NORTH line					
Ground level Elev. 3761.0	Producing Formation ORDOVICIAN		Pool WILDCAT ORDOVICIAN	Dedicated Acreage: 320 Acres	

1. Outline the acreage dedicated to the subject well by colored pencil or hatchure marks on the plat below.
2. If more than one lease is dedicated to the well, outline each and identify the ownership thereof (both as to working interest and royalty).
3. If more than one lease of different ownership is dedicated to the well, have the interest of all owners been consolidated by communitization, unitization, force-pooling, etc.?
☐ Yes ☐ No If answer is "yes" type of consolidation _____
If answer is "no" list the owners and tract descriptions which have actually been consolidated. (Use reverse side of this form if necessary.)
No allowable will be assigned to the well until all interests have been consolidated (by communitization, unitization, forced-pooling, or otherwise) or until a non-standard unit, eliminating such interest, has been approved by the Division.

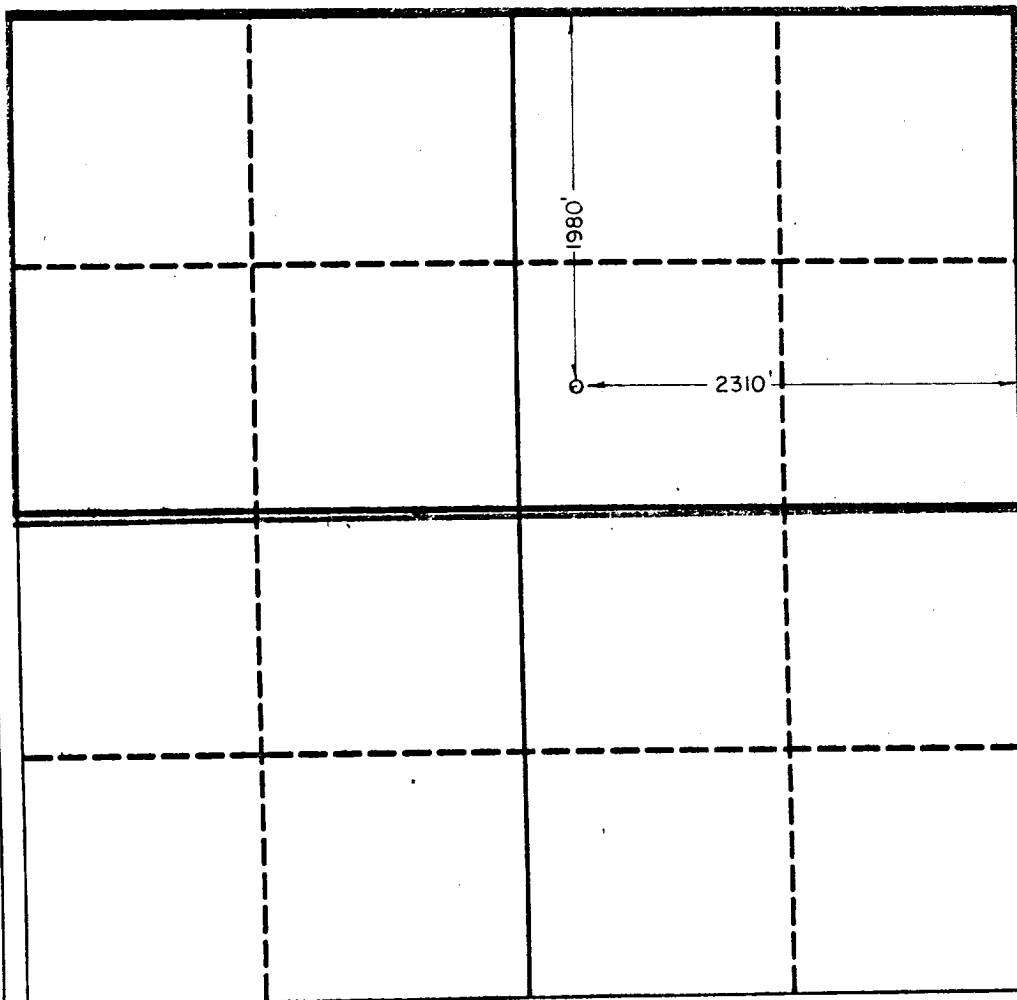

OPERATOR CERTIFICATION

I hereby certify that the information contained herein is true and complete to the best of my knowledge and belief.

Signature <i>Clifton R. May</i>
Printed Name Clifton R. May
Position Permit Agent
Company Yates Petroleum Corp.
Date 1-4-91

SURVEYOR CERTIFICATION

I hereby certify that the well location shown on this plat was plotted from field notes of actual surveys made by me or under my supervision, and that the same is true and correct to the best of my knowledge and belief.

Date Surveyed 12/22/90
Signature & Seal of Professional Surveyor <i>[Signature]</i> HERSCHEL Certificate No. 3640

YATES PETROLEUM CORPORATION

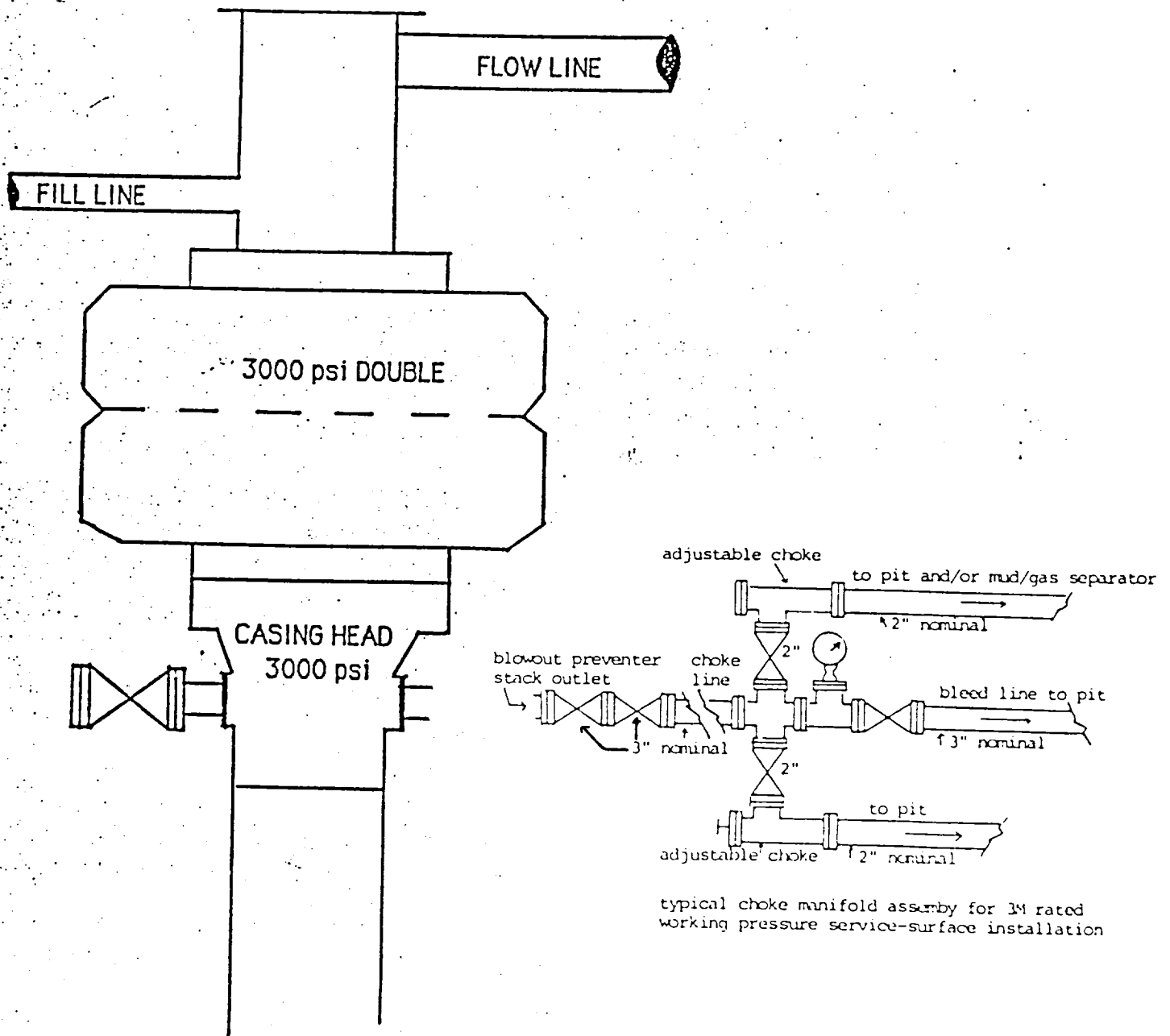

**BLOWOUT PREVENTER
3M SYSTEM**

Foor Ranch;
Wokeamp, N.
(Gas)
76755