

Submit 3 Copies  
to Appropriate  
District Office

State of New Mexico  
Energy, Minerals and Natural Resources Department

Form C-103  
Revised 1-1-89

clsr  
Op

DISTRICT I  
P.O. Box 1980, Hobbs, NM 88240

DISTRICT II  
P.O. Drawer DD, Artesia, NM 88210

DISTRICT III  
1000 Rio Brazos Rd., Aztec, NM 87410

OIL CONSERVATION DIVISION

P.O. Box 2088  
Santa Fe, New Mexico 87504-2088  
JUL 12 1992

WELL API NO. 30-005-62898
5. Indicate Type of Lease STATE <input checked="" type="checkbox"/> FEE <input type="checkbox"/>
6. State Oil & Gas Lease No. VB-0110
7. Lease Name or Unit Agreement Name Celtic State
8. Well No. 1
9. Pool name or Wildcat Undesignated

SUNDRY NOTICES AND REPORTS ON WELLS (DO NOT USE THIS FORM FOR PROPOSALS TO DRILL OR TO DEEPEN OR PLUG BACK TO A DIFFERENT RESERVOIR. USE "APPLICATION FOR PERMIT" (FORM C-101) FOR SUCH PROPOSALS.)	
1. Type of Well: OIL WELL <input checked="" type="checkbox"/> GAS WELL <input type="checkbox"/> OTHER <input type="checkbox"/>	
2. Name of Operator ELK OIL COMPANY	
3. Address of Operator Post Office Box 310, Roswell, New Mexico 88202-0310	
4. Well Location Unit Letter <u>E</u> : <u>1350</u> Feet From The <u>North</u> Line and <u>990</u> Feet From The <u>West</u> Line Section <u>13</u> Township <u>8 South</u> Range <u>27 East</u> NMPM <u>Chaves</u> County	
10. Elevation (Show whether DF, RKB, RT, GR, etc.) 3948' GR	

11. Check Appropriate Box to Indicate Nature of Notice, Report, or Other Data	
NOTICE OF INTENTION TO:	SUBSEQUENT REPORT OF:
PERFORM REMEDIAL WORK <input type="checkbox"/>	REMEDIAL WORK <input type="checkbox"/>
TEMPORARILY ABANDON <input type="checkbox"/>	ALTERING CASING <input type="checkbox"/>
PULL OR ALTER CASING <input type="checkbox"/>	COMMENCE DRILLING OPNS. <input type="checkbox"/>
OTHER: <input type="checkbox"/>	PLUG AND ABANDONMENT <input type="checkbox"/>
	CASING TEST AND CEMENT JOB <input type="checkbox"/>
	OTHER: <u>Change Location</u> <input type="checkbox"/>

12. Describe Proposed or Completed Operations (Clearly state all pertinent details, and give pertinent dates, including estimated date of starting any proposed work) SEE RULE 1103.

Change location from 1650' FNL and 990' FWL to  
1350' FNL and 990' FWL

Post ID-1  
9-25-92  
Amend Loc

I hereby certify that the information above is true and complete to the best of my knowledge and belief.

SIGNATURE Joseph J. Kelly TITLE President DATE 07/30/92  
TYPE OR PRINT NAME Joseph J. Kelly TELEPHONE NO. 505/623-3190

(This space for State Use)

ORIGINAL SIGNED BY  
MIKE WILLIAMS  
SUPERVISOR, DISTRICT II

APPROVED BY \_\_\_\_\_ TITLE \_\_\_\_\_ DATE SEP 28 1992

CONDITIONS OF APPROVAL, IF ANY:

Submit to Appropriate  
District Office  
State Lease - 4 copies  
Fee Lease - 3 copies

State of New Mexico  
Energy, Minerals and Natural Resources Department

Form C-102  
Revised 1-1-89

OIL CONSERVATION DIVISION

P.O. Box 2088  
Santa Fe, New Mexico 87504-2088

DISTRICT I  
P.O. Box 1980, Hobbs, NM 88240

DISTRICT II  
P.O. Drawer DD, Artesia, NM 88210

DISTRICT III  
1000 Rio Brazos Rd., Aztec, NM 87410

WELL LOCATION AND ACREAGE DEDICATION PLAT

All Distances must be from the outer boundaries of the section

Operator ELK OIL			Lease Celtic State (ALTERNATE)		Well No. 1
Unit Letter E	Section 13	Township 8S	Range 27E	County CHAVES	NMPM
Actual Footage Location of Well: 1350 feet from the NORTH line and 990 feet from the WEST line					
Ground level Elev. 3948		Producing Formation San Andres		Pool Undesignated	
					Dedicated Acreage: 40 Acres

1. Outline the acreage dedicated to the subject well by colored pencil or hatchure marks on the plat below.

2. If more than one lease is dedicated to the well, outline each and identify the ownership thereof (both as to working interest and royalty).

3. If more than one lease of different ownership is dedicated to the well, have the interest of all owners been consolidated by communitization, unitization, force-pooling, etc.?

☐ Yes ☐ No If answer is "yes" type of consolidation

If answer is "no" list the owners and tract descriptions which have actually been consolidated. (Use reverse side of this form if necessary.)

No allowable will be assigned to the well until all interests have been consolidated (by communitization, unitization, forced-pooling, or otherwise) or until a non-standard unit, eliminating such interest, has been approved by the Division.

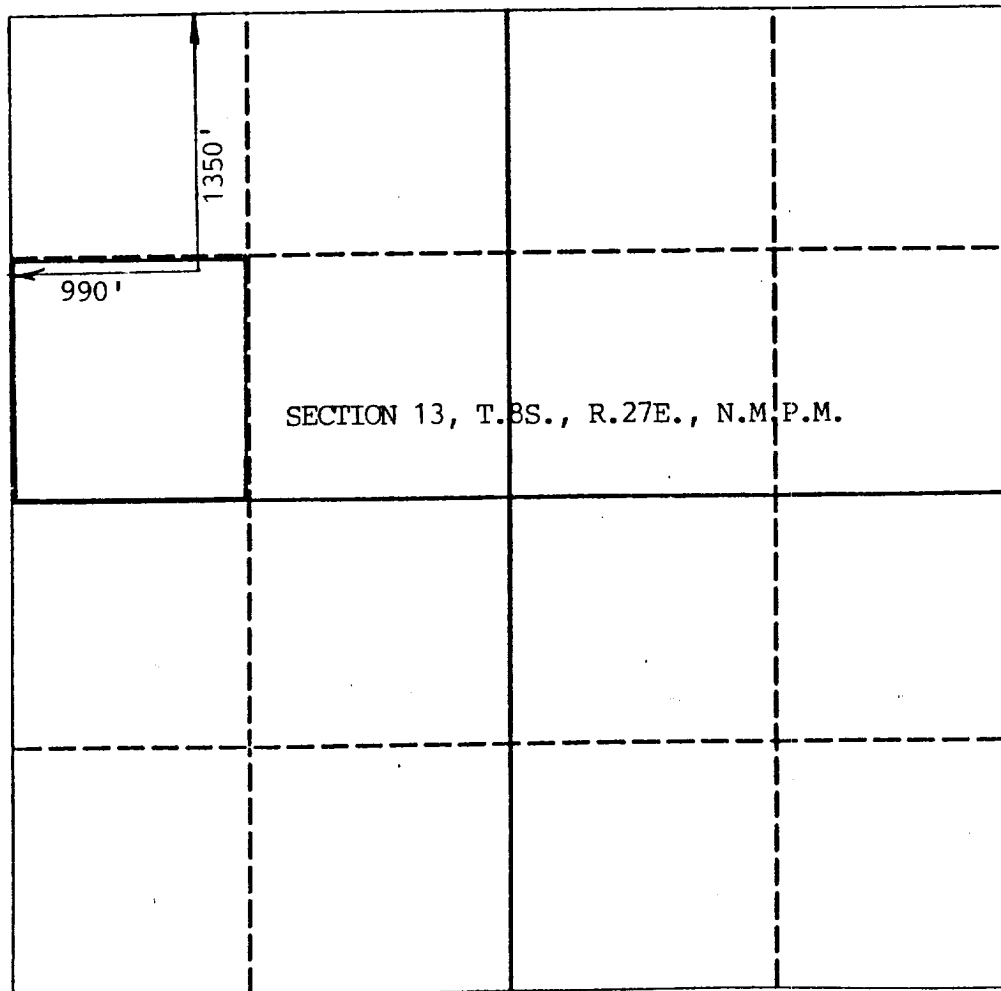

OPERATOR CERTIFICATION

I hereby certify that the information contained herein is true and complete to the best of my knowledge and belief.

Signature

Printed Name

Joseph J. Kelly

Position

President

Company

ELK OIL COMPANY

Date

July 30, 1992

SURVEYOR CERTIFICATION

I hereby certify that the well location shown on this plat was plotted from field notes of actual surveys made by me or under my supervision, and that the same is true and correct to the best of my knowledge and belief.

Date Surveyed

4/13/92

Signature & Seal of  
Professional Surveyor

JOHN J. JACQUES  
NEW MEXICO  
6290 STRE  
BK. 65  
10256718 & 68