

UNITED STATES
DEPARTMENT OF THE INTERIOR

BUREAU OF LAND MANAGEMENT

NM 011 Cont. OFFICE FOR NUMBER
Drawer DD OF CO. 886491
Artesia, NM 88210 (Other instructions on reverse side)

30-005-62956
BLM Roswell District
Modified Form No.
NM060-3160-2

APPLICATION FOR PERMIT TO DRILL, DEEPEN, OR PLUG BACK

1A. TYPE OF WORK DRILL <input checked="" type="checkbox"/> DEEPEN <input type="checkbox"/> PLUG BACK <input type="checkbox"/>		5. LEASE DESIGNATION AND SERIAL NO. NM 71754	
B. TYPE OF WELL OIL WELL <input checked="" type="checkbox"/> GAS WELL <input type="checkbox"/> OTHER <input type="checkbox"/>		6. IF INDIAN, ALLOTTEE OR TRIBE NAME	
2. NAME OF OPERATOR TOPAT OIL CORPORATION		7. UNIT AGREEMENT NAME	
3. ADDRESS OF OPERATOR 505 N. Big Spring - Ste. 204 - Midland, TX 79701		8. FARM OR LEASE NAME Marilyn Federal	
4. LOCATION OF WELL (Report location clearly and in accordance with any State requirements) At surface: 330' FEL and 2310' FSL At proposed prod. zone: Same		9. WELL NO. # 1	
14. DISTANCE IN MILES AND DIRECTION FROM NEAREST TOWN OR POST OFFICE 15 Miles East of Roswell, New Mexico		10. FIELD AND POOL, OR WILDCAT COYOTE QUEEN	
15. DISTANCE FROM PROPOSED LOCATION TO NEAREST PROPERTY OR LEASE LINE, FT. (Also to nearest drlg. unit line, if any) 330' LSE LINE		11. SEC., T., R., M., OR BLE. AND SURVEY OR AREA UNIT 19, T-11-S, R-27-E	
16. NO. OF ACRES IN LEASE 240		12. COUNTY OR PARISH Chaves	
17. NO. OF ACRES ASSIGNED TO THIS WELL 40		13. STATE New Mexico	
18. DISTANCE FROM PROPOSED LOCATION TO NEAREST WELL, DRILLING, COMPLETED, None of this OR APPLIED FOR, ON THIS LEASE, FT. lease @ present		20. ROTARY OR CABLE TOOLS ROTARY (Air)	
21. ELEVATIONS (Show whether DF, RT, GR, etc.) 3668 GL		22. APPROX. DATE WORK WILL START 3-1 to 3/15/93	

PROPOSED CASING AND CEMENTING PROGRAM

HOLE SIZE	CASING SIZE	WEIGHT/FOOT	GRADE	THREAD TYPE	SETTING DEPTH	QUANTITY OF CEMENT
6-1/4"	4-1/2"	10.5#	J-55	ST&C	950'	250 sx C1 "C"
11"	7"	17#	"	"	200'	Cmt to surface

1. Stake location, perform archeological survey and BLM approval on location and access to same, dig pits as outlined in attached drilling plan.
2. Move in rotary rig - according to attached drilling plan.
3. Drill 11" hole to 200', cmt 200' of 7" csg., cmt will be circulated, drill 6-1/4" hole to 950', 4-1/2" 10.5# casing and cement using 200 sx C1 "C".
4. Log well with GRN and perforate Queen formation as determined by geologists.
5. Frac with 45,000# sand and 24,000 gls gelled KCL.
6. Put well on production.

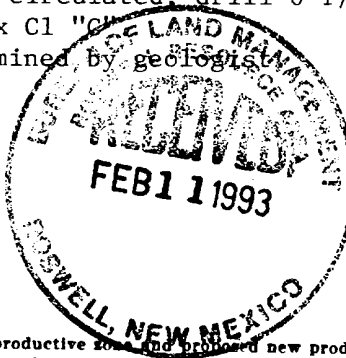

IN ABOVE SPACE DESCRIBE PROPOSED PROGRAM: If proposal is to deepen or plug back, give data on present productive zone and proposed new productive zone. If proposal is to drill or deepen directionally, give pertinent data on subsurface locations and measured and true vertical depths. Give blowout preventer program, if any.

24. Tom Schneider
SIGNED: Tom Schneider TITLE: President DATE: 2-9-93
(This space for Federal or State office use)

PERMIT NO. _____ APPROVAL DATE: _____
APPROVED BY: Sanasha L. Allen TITLE: Area Manager DATE: 4/12/93
CONDITIONS OF APPROVAL, IF ANY:

PLEASE BE ADVISED THAT THERE WILL BE NO EXCAVATION OF FEDERALLY OWNED MINERAL MATERIAL FOR CONSTRUCTION OF THE ACCESS ROAD OR PAD WITHOUT PAYMENT IN ADVANCE.

APPROVAL OF THIS APPLICATION DOES NOT WARRANT OR CERTIFY THAT THE APPLICANT'S PROPOSED OPERATION IS LEGAL OR EQUITABLE. TITLE TO THESE MINERALS IS NOT GUARANTEED BY THIS LEASE WHICH WOULD ENTITLE THE APPLICANT TO CONDUCT OPERATIONS THEREON.

Section 1001, makes it a crime for any person knowingly and willfully to make to any department or agency of the United States any false statement.

Submit to Appropriate
District Office
State Lease - 4 copies
Fee Lease - 3 copies

State of New Mexico
Energy, Minerals and Natural Resources Department

Form C-102
Revised 1-1-89

OIL CONSERVATION DIVISION

P.O. Box 2088
Santa Fe, New Mexico 87504-2088

DISTRICT I

P.O. Box 1980, Hobbs, NM 88240

DISTRICT II

P.O. Drawer DD, Artesia, NM 88210

DISTRICT III

1000 Rio Brazos Rd., Aztec, NM 87410

WELL LOCATION AND ACREAGE DEDICATION PLAT

All Distances must be from the outer boundaries of the section

Operator TOPAT OIL COMPANY		Lease MARKED FEDERAL		Well No. 1
Unit Letter P	Section 19	Township 11-South	Range 27 - East NMPM	County Chaves
Actual Footage Location of Well: 330 feet from the East line and 990 feet from the South line				
Ground level Elev. 3668	Producing Formation GREEN	Pool SOMOTE OIL	Dedicated Acreage: 40 Acres	

1. Outline the acreage dedicated to the subject well by colored pencil or hachure marks on the plat below.
2. If more than one lease is dedicated to the well, outline each and identify the ownership thereof (both as to working interest and royalty).
3. If more than one lease of different ownership is dedicated to the well, have the interest of all owners been consolidated by communitization, unitization, force-pooling, etc?
☐ Yes ☐ No If answer is "yes" type of consolidation _____
If answer is "no" list the owners and tract descriptions which have actually been consolidated. (Use reverse side of this form if necessary).
No allowable will be assigned to the well until all interests have been consolidated (by communitization, unitization, forced-pooling, or otherwise) or until a non-standard unit, eliminating such interest, has been approved by the Division.

OPERATOR CERTIFICATION

I hereby certify that the information contained herein is true and complete to the best of my knowledge and belief.

Signature

TOM SCHNEIDER

Printed Name

PRESIDENT

Position

TOPAT OIL CORPORATION

Company

MARCH 05 1993

Date

SURVEYOR CERTIFICATION

I hereby certify that the well location shown on this plat was plotted from field notes of actual surveys made by me or under my supervision, and that the same is true and correct to the best of my knowledge and belief.

Date Surveyed

March 2 1993

Signature & Seal of Professional Surveyor

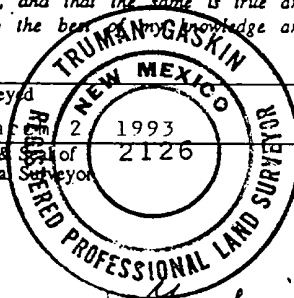

Certificate No.

2126

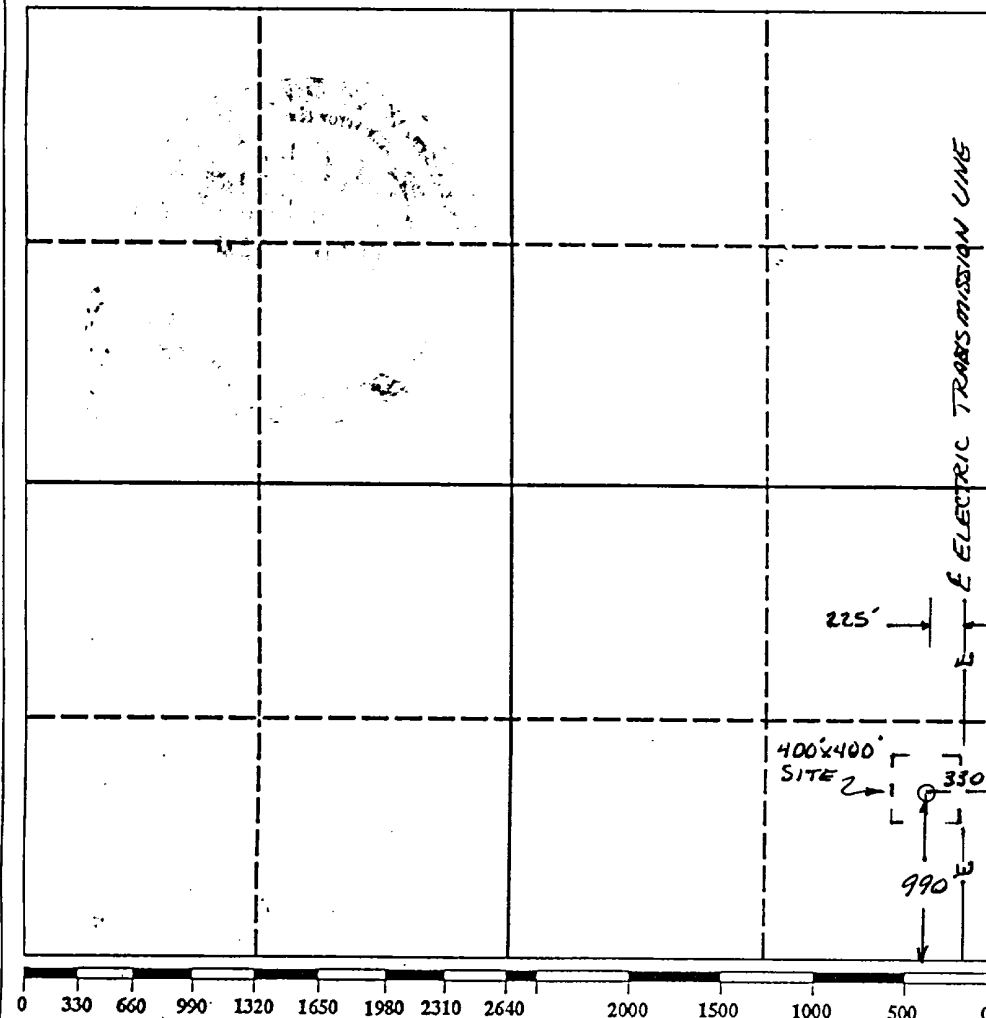

PERTINENT INFORMATION

FOR

TOPAT OIL CORPORATION

#1 Marilyn Federal
330' FEL & ~~2310~~ FSL Section 19, T11S, R27E,
Chaves County, New Mexico

NM-71754

<u>LOCATED:</u>	15 miles east of Roswell, New Mexico
<u>FEDERAL LEASE NUMBER:</u>	NM-71754
<u>ACRES IN LEASE:</u>	240 acres
<u>RECORD LESSEE:</u>	Elk Oil Co.
<u>BOND COVERAGE:</u>	Federal Bond # B03535
<u>AUTHORITY TO OPERATE:</u>	Operating Agreement
<u>MINERAL OWNERSHIP:</u>	Public
<u>GRAVING PERMITTEE:</u>	Slash G Cattle Co. P.O. Box 2067 Roswell, New Mexico 88202
<u>POOL RULES:</u>	Coyote (Queen) 20 acres
<u>EXHIBITS:</u>	A. Road and Contour Map B. Lease and Well Maps C. Pit diagram D. BOP diagram

0209933.DOC



MULTI-POINT SURFACE USE AND OPERATIONS PLAN

TOPAT OIL CORPORATION

#1 Marilyn Federal
330' FEL & ~~2310~~^{2310.70} FSL Section 19, T11S, R27E,
Chaves County, New Mexico

NM-71754

This plan is submitted following the Application for Permit to Drill the above described well. The purpose of the plan is to describe the location of the proposed well, the proposed construction activities and operations plan, the magnitude of necessary surface disturbance involved, and the procedures to be followed in rehabilitating the surface after completion of the operation so that a complete appraisal can be made of the environmental effects associated with the operation.

1. EXISTING ROADS:

- A. Exhibit "A" is a portion of a road map showing the location of the well. The well is approximately 15 miles east of Roswell, New Mexico.
- B. Directions: See Exhibit "B".
- C. Surface Use Plan: All existing areas roads will be maintained in as good as condition as found presently.

2. PLANNED ACCESS ROAD:

- A. Length and Width: Approximately 1200' of existing road will be built.
- B. Surfacing Material: No surface material will be needed.
- C. Maximum Grade: N/A
- D. Turnouts: Since the road is essentially flat, no traffic turnouts are necessary.

0209934.DOC

FEB 1 1996

E. Drainage Design: As needed.

F. Culverts: None necessary.

3. LOCATION OF EXISTING WELLS:

A. There are no wells at present on this lease.

4. LOCATION OF EXISTING AND/OR PROPOSED FACILITIES:

A. If the well is productive, production, storage and measurement facilities will be located on the well pad of the Marilyn # 1.

5. LOCATION AND TYPE OF WATER SUPPLY:

A. Water for drilling operations will be purchased from a commercial water hauler.

B. If fresh water is required it will be purchased from Jim's Water Service, Roswell, New Mexico and obtained from the L L & E water station, Permit W-642, Sec 28, T-9-S, R-27-E.

6. SOURCE OF CONSTRUCTION MATERIALS:

A. It is planned to use material-in-place for construction. If necessary, caliche for surfacing the road and pad will be obtained locally. No caliche will be taken from Public land without prior approval.

7. METHODS OF HANDLING WASTE DISPOSAL:

A. Drilling and workover fluids will be allowed to evaporate in the drilling pits until the pit is dry.

B. Water produced during test will be disposed of in the workover pit. Oil produced during test will be stored in test tanks until sold.

C. Current laws and regulations pertaining to the disposal of human waste will be complied with.

D. All trash and debris will be removed from the wellsite within 30 days after finishing drilling and/or completion operations.

8. ANCILLARY FACILITIES:

- A. None necessary

9. WELL SITE LAYOUT:

- A. The wellsite has been surveyed as per attached plat.
- B. Dimensions and relative location of the drill pad, pit and equipment are shown on the attached diagram.

10. PLANS FOR RESTORATION OF THE SURFACE:

- A. After completion of drilling and/or completion operations, all equipment and other material not needed for operations will be removed. Pits will be filled when dry and the location cleaned of all trash and junk to leave the wellsite in an aesthetically pleasing condition as possible.
- B. Any unguarded pits containing fluids will be fenced until they are dry.
- C. If the well is non-productive, the disturbed area will be rehabilitated to Federal Agency requirements and will be accomplished as expeditiously as possible.

11. OTHER INFORMATION:

- A. Topography: The regional terrain is a rolling alluvial plain sloping to the west toward the Pecos River. The access road is essentially level. The location slopes northwest.
- B. Soil: The soil at the wellsite is sandy clay loam with associated gravels.
- C. Flora and Fauna: Flora consists of range grasses with some yucca and mesquite. No wildlife was observed. Fauna probably includes reptiles, rodents and various birds.
- D. Ponds or Streams: There are no ponds near the wellsite. The Pecos River is six miles west.
- E. Residences and Other Structures: There are no occupied dwellings within two miles.
- F. Archaeological, Historical and other Cultural Sites:

The archaeological study of the Marilyn Federal # 1 has been done by James ViSciscenti, Archeological Survey Consultants, Roswell, New Mexico.

G. Land Use: The vicinity surrounding the wellsite is semiarid rangeland, used primarily for grazing.

H. Surface Ownership: The new access road and wellsite are privately owned. The surface is Mr. David J. Sorenson, P.O. Box 1453 Roswell, New Mexico 88201-1453.

12. OPERATOR'S REPRESENTATIVE:

Representative responsible for assuring compliance with the approved Surface Use Plan:

Thomas Schneider
Topat Oil Corporation
505 N. Big Spring St. - Ste. 204
Midland, Texas 79701-4367
915/682-6340

13. CERTIFICATION:

I hereby certifiy that I, or person under my direct supervision, have inspected the proposed drillsite and access route; that I am familiar with the conditions which presently exist; that the statements made in this plan are, to the best of my knowledge true and correct; that the work associated with the operations proposed herein will be performed by TOPAT OIL CORPORATION and its sub-contractors in conformity with this plan and the terms and conditions under which it is approved. This statement is subject to the provisions of 18 U.S.C. 1001 for the filing of a false statement.

Date: 2/09/93

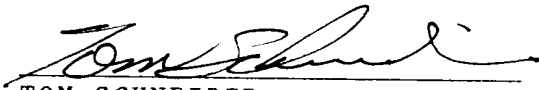
TOM SCHNEIDER
President



SUPPLEMENT DATA
APPLICATION FOR PERMIT TO DRILL, DEEPEN, OR PLUG BACK

Marilyn Federal # 1
Coyote Queen
Sec 19, T 11 S, R 27 E
Chaves County, New Mexico

Estimated depths on water, oil and gas.

Fresh Water - 100'
Oil & Gas - 700 - 900'

Geological Tops:

Yates 100' (+ -)
Queen 600' (+ -)
San Andres 1150' (+ -)

Surface Casing: 200' of 7" surface casing will be set
and cement circulated.

Thomas Schneider
Operator Representative

0209936.DOC



SUPPLEMENTAL DRILLING DATA

TOPAT OIL CORPORATION

#1 Marilyn Federal
330' FEL & 2310' FSL Section 19, T11S, R27E,
Chaves County, New Mexico

NM-71754

The following items supplement Form 3160-3 in accordance with instructions contained in Onshore Oil and Gas Order No. 1:

1. PROPOSED CASING PROGRAM: 200' 7" surface pipe and 950' of 4-1/2" production casing.
2. CIRCULATING MEDIUM: Well will be drilled with air.
3. AUXILIARY EQUIPMENT: A full-opening safety valve, to fit the drill string in use, will be kept on the rig floor at all times.
4. TESTING, LOGGING AND CORING PROGRAM: Gamma Ray Neutron log and perforate. Possibly log well open hole if it is deemed necessary by geologist.
5. ANTICIPATED STARTING DATE: Plan to begin operations between March 1 and March 15, 1993. Drilling and completion operations are estimated to last about 6-8 days.
6. PRESSURE CONTROL: Manually operated ram type work over rig blow out preventer, rated 3000# working pressure.
7. HAZARDS: We do not expect to encounter any abnormal pressures or hazards.

The undersigned accepts all applicable terms, conditions, stipulations and restrictions concerning operations conducted on the leased land or portion thereof, as described below:

Lease No. NM-71754

Legal Description of Land: SE/4 Sec. 19, T-11-S, R-27-E.

Formations: Queen

Bond Coverage: New Mexico

BLM Bond File No: B03535

Authorized Signature: Tom Schneider
President



Thomas Schneider
Field Representative

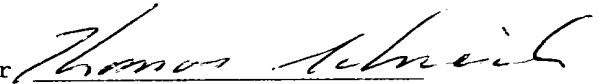

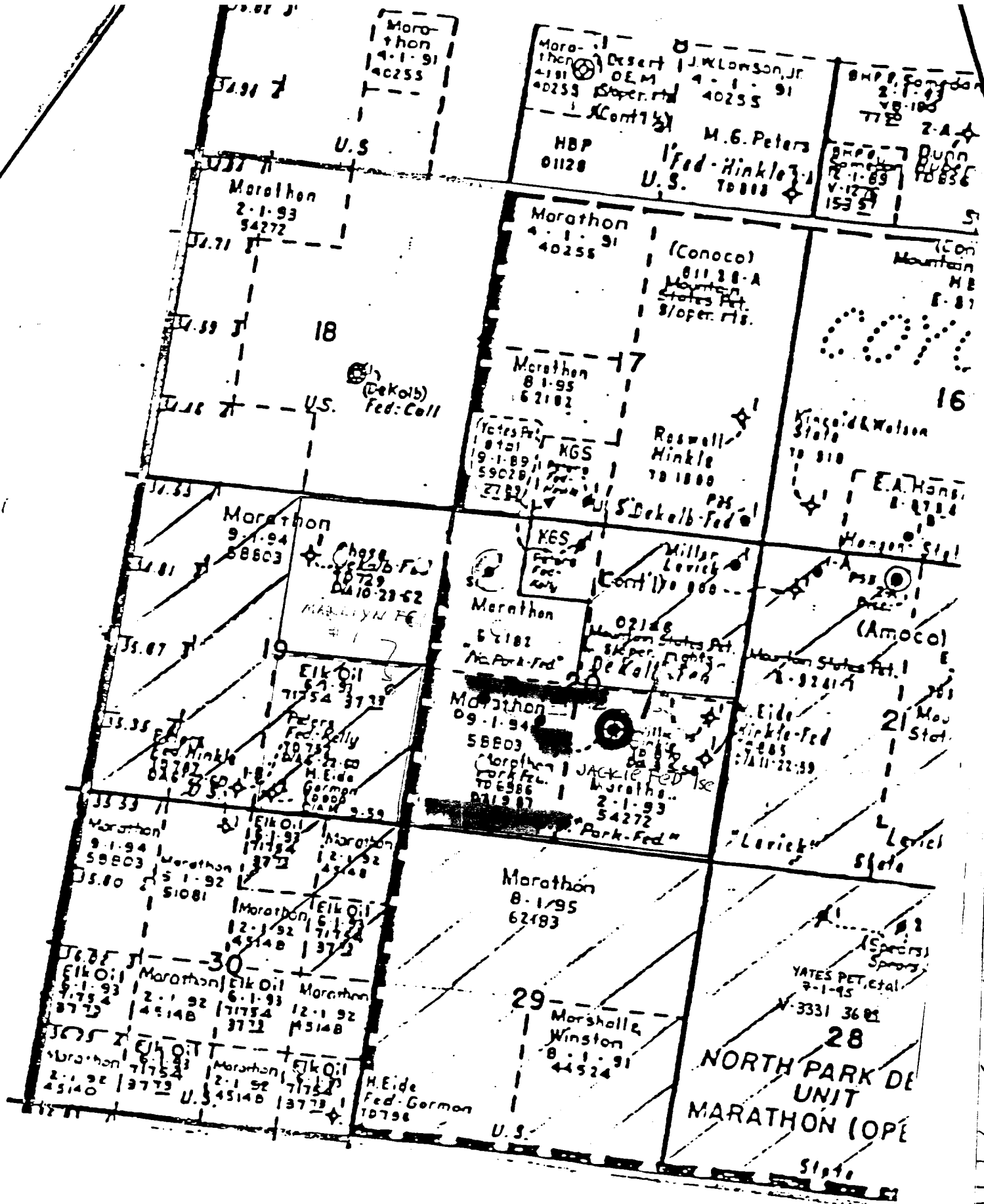



- Road to be built
- Existing windmills
- Existing oil wells
- Stackd Location-Patricia Federal #2
- Cattleguard-Marilyn 10 S. 1. 11 S.
- Location for Marilyn
- Lease Boundary - Marilyn 870000 FEET



0

EXHIBIT C

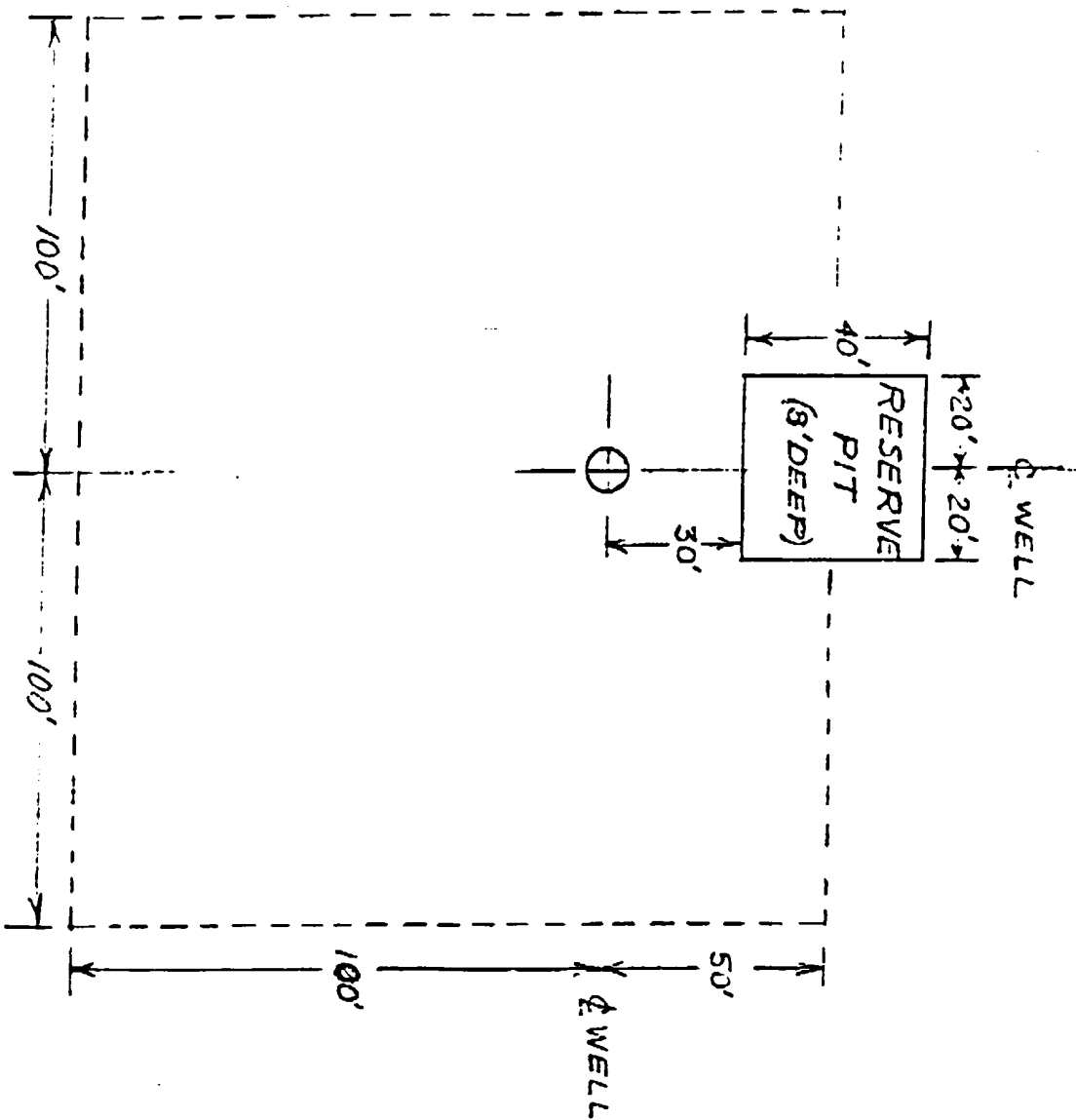

UNITED DRILLING, INC.
LOCATION PLAT
RIGS 1 & 4
AIR DRILLING.

5-11-19-40' 10/1/19



EXHIBIT D

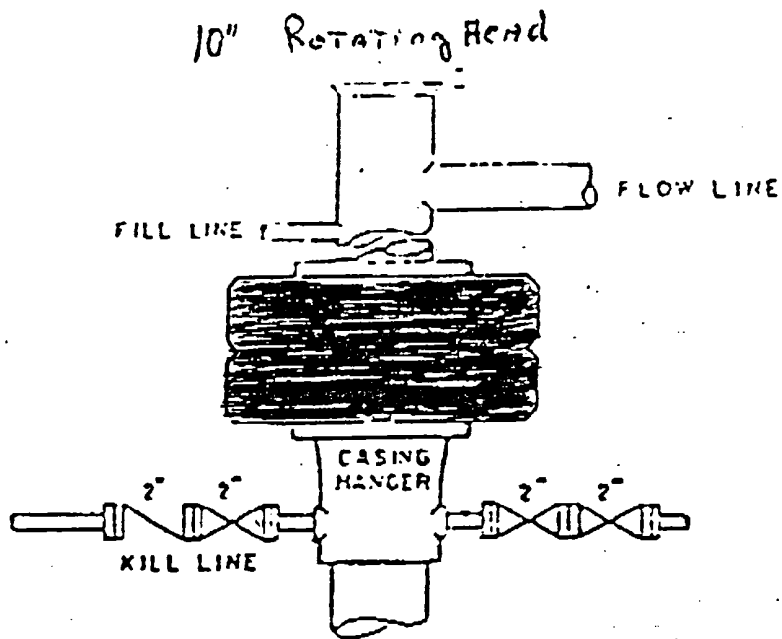

10" ROTATING HEAD