

UNITED STATES  
DEPARTMENT OF THE INTERIOR  
BUREAU OF LAND MANAGEMENT

Artesia, NM 88210

SUNDRY NOTICES AND REPORTS ON WELLS

Do not use this form for proposals to drill or to deepen or reentry to a different reservoir.  
Use "APPLICATION FOR PERMIT" for such proposals.

SUBMIT IN TRIPLICATE

FORM APPROVED  
Budget Bureau No. 1004-0135  
Expires: March 31, 1993

5. Lease Designation and Serial No.  
NM-18484

6. If Indian, Allottee or Tribe Name

7. If Unit or CA, Agreement Designation

8. Well Name and No. *Com*  
Unruh AFF Federal #1

9. API Well No.  
30-005-62957

10. Field and Pool, or Exploratory Area  
Pecos Slope Abo

11. County or Parish, State  
Chaves Co., NM

JUL 15 '94

O. C. D.  
Artesia Office

YATES PETROLEUM CORPORATION

105 South 4th St., Artesia, NM 88210

660' FNL & 1530' FEL of Section 20-T10S-R25E (Unit B, NWNE)

CHECK APPROPRIATE BOX(S) TO INDICATE NATURE OF NOTICE, REPORT, OR OTHER DATA

TYPE OF SUBMISSION

- ☒ Notice of Intent
- ☐ Subsequent Report
- ☐ Final Abandonment Notice

TYPE OF ACTION

- ☐ Abandonment
- ☐ Recompletion
- ☐ Plugging Back
- ☐ Casing Repair
- ☐ Altering Casing
- ☒ Off-lease sales & measurement; central delivery point for wells
- ☐ Change of Plans
- ☐ New Construction
- ☐ Non-Routine Fracturing
- ☐ Water Shut-Off
- ☐ Conversion to Injection
- ☐ Dispose Water

(Note: Report results of multiple completion on Well Completion or Recompletion Report and Log form.)

13. Describe Proposed or Completed Operations (Clearly state all pertinent details, and give pertinent dates, including estimated date of starting any proposed work. If well is directionally drilled, give subsurface locations and measured and true vertical depths for all markers and zones pertinent to this work.)\*

Due to economic conditions with the gas purchaser, Yates Petroleum Corporation has been required to lay gathering lines and set allocation meters at each well that produces into a common line. We hereby request approval for off-lease sales & measurement and for commingling of the captioned well with:

Cannon XF #1 (fee lease) (Yates Petroleum) SENE of Section 17-T10S-R25E  
G.P. Federal Com #1-21 (NM-17038) (Abo Petroleum) NW/SW of Section 21-T9S-R25E  
Adell UJ Fed Com #1 (NM-16074) (Yates Petroleum) NENE of Section 7-T10S-R25E (CA RNM107)  
Bitter Lake PX State #1 (LG-855) (Yates Petroleum) SWSW of Section 16-T10S-R25E  
Bitter Lake PX State #2 (LG-855) (Yates Petroleum) SWNW of Section 16-T10S-R25E  
Eakin AFB Com #1 (fee lease) (Yates Petroleum) NENW of Section 17-T10S-R25E (CA NMNM72614)  
Eargrove AFH #1 (fee lease) (Yates Petroleum) SENE of Section 8-T10S-R25E  
Mountain VR Federal #1 (NM-18819) (Yates Petroleum) SWSE of Section 8-T10S-R25E (CA SCR440)  
Mountain VR Federal #2 (NM-18819) (Yates Petroleum) SENW of Section 8-T10S-R25E (CA NMO61P3586C353)  
Mountain VR Federal #3 (NM-18819) (Yates Petroleum) NESW of Section 8-T10S-R25E (CA RNM107)

The gas is measured at each location with a check meter prior to measurement for sales for marketing gas to the pipeline company. The sales point is located at the Marie VU Federal #1, NESE of Section 20-T9S-R25E.

Periodic calibration tests on all meters are done. Test results will be furnished to the BLM

14. I hereby certify that the foregoing is true and correct

Signed *Rusty Klein*

Title Production Clerk

(This space for Federal or State office use)

Approved by  
Conditions of approval, if any:

Title

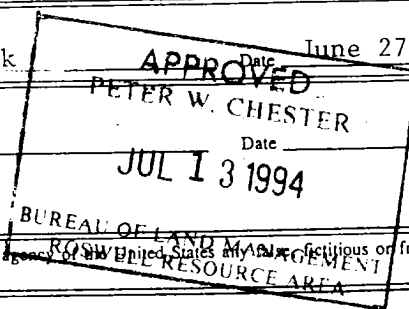

Title 18 U.S.C. Section 1001, makes it a crime for any person knowingly and willfully to make to any department or agency of the United States any false, fictitious or fraudulent statements or representations as to any matter within its jurisdiction.

\*See Instruction on Reverse Side

RECEIVED

CRA BLM FORMAT

Jul 1 8 25 AM '94

APPLICATION FOR SURFACE COMMINGLING,  
OFF LEASE ~~SALES~~ AND MEASUREMENT APPROVAL

This Format Should Be Attached To A Sundry Notice

To: Bureau of Land Management  
P. O. Box 1778  
Carlsbad, New Mexico 88221-1778

Yates Petroleum Corp. (Operator's Name) is requesting approval for surface commingling and off-lease ~~SALES~~ and measurement of hydrocarbon production from the following formation(s) and well(s) on Federal Lease No. NM-18484 ; Lease Name: Unruh AFF Federal Com  
CA No. NMNM90995

<u>Well No.</u>	<u>Loc.</u>	<u>Sec.</u>	<u>Twp.</u>	<u>Rng.</u>	<u>Formation</u>
<u>1</u>	<u>B</u>	<u>20</u>	<u>10S</u>	<u>25E</u>	<u>Abo</u>
<u> </u>	<u> </u>	<u> </u>	<u> </u>	<u> </u>	<u> </u>
<u> </u>	<u> </u>	<u> </u>	<u> </u>	<u> </u>	<u> </u>
<u> </u>	<u> </u>	<u> </u>	<u> </u>	<u> </u>	<u> </u>

with hydrocarbon production from the following formation(s) and well(s) on Federal lease No.   ; Lease Name:  

<u>Well No.</u>	<u>Loc.</u>	<u>Sec.</u>	<u>Twp.</u>	<u>Rng.</u>	<u>Formation</u>
<u>SEE ATTACHED SHEET</u>	<u> </u>	<u> </u>	<u> </u>	<u> </u>	<u> </u>
<u> </u>	<u> </u>	<u> </u>	<u> </u>	<u> </u>	<u> </u>
<u> </u>	<u> </u>	<u> </u>	<u> </u>	<u> </u>	<u> </u>

Production from the wells involved is as follows:

<u>Well Name and No.</u>	<u>BOPD</u>	<u>Oil Gravity</u>	<u>MCFPD</u>
<u>Mountain VR Fed #1</u>	<u>0</u>	<u>N/A</u>	<u>254</u>
<u>Mountain VR Fed #2</u>	<u>0</u>	<u>N/A</u>	<u>36</u>
<u>Mountain VR Fed #3</u>	<u>0</u>	<u>N/A</u>	<u>57</u>
<u>Hargrove AFH #1</u>	<u>0</u>	<u>N/A</u>	<u>176</u>
<u>Eakin AFB Com #1</u>	<u>0</u>	<u>N/A</u>	<u>20</u>
<u>Adell UJ Com #1</u>	<u>0</u>	<u>N/A</u>	<u>86</u>
<u>Bitter Lakes PX St. #1</u>	<u>0</u>	<u>N/A</u>	<u>40</u>
<u>Bitter Lakes PX St. #2</u>	<u>0</u>	<u>N/A</u>	<u>179</u>
<u>Cannon XF #1</u>	<u>0</u>	<u>N/A</u>	<u>271</u>
<u>GP Federal #1-21 (APC)</u>	<u>0</u>	<u>N/A</u>	<u>25</u>

RECEIVED

APPLICATION FOR SURFACE COMMINGLING, OFF-LEASE STORAGE AND MEASUREMENT APPROVAL:

~~JUL 1 6 25 AM '94~~

with hydrocarbon production from the following formation(s) and well(s) on  
Federal Lease No SEE BELOW ; Lease Name SEE BELOW

<u>WELL NAME &amp; NO.</u>	<u>LEASE NO./CA NO.</u>	<u>UL-S-T-R</u>	<u>FORMATION</u>
GP Federal #1-21 (Abo)	NM-17038	L-21-T9S-25E	Abo
Adell UJ Federal Com #1 (YPC)	NM-16074/RNM107	A-7-T10S-R25E	Abo
Bitter Lake PX State #1 (YPC)	LG-855	M-16-T10S-R25E	Abo
Bitter Lake PX State #2 (YPC)	LG-855	E-16-T10S-R25E	Abo
Eakin AFB Com #1 (YPC)	fee/NMNM72614)	C-17-T10S-R25E	Abo
Hargrove AFH #1 (YPC)	fee	H-8-T10S-R25E	Abo
Mountain VR Federal #1 (YPC)	NM-18819/SCR440	O-8-T10S-R25E	Abo
Mountain VR Federal #2 (YPC)	"/NM061P3586C353	F-8-T10S-R25E	Abo
Mountain VR Federal #3 (YPC)	NM-18819/RNM107	K-8-T10S-R25E	Abo
Cannon XF #1 (YPC)	fee	H-17-T10S-R25E	Abo

RECEIVED

JUL 1 8 23 AM '94

Continued:

The proposed operation is described in detail on the attached diagrams.

A map is enclosed showing the lease numbers and location of all leases and wells that will contribute production to the proposed commingling/common storage facility. All unitized/communitized areas, producing zones/pools are also clearly illustrated.

A schematic diagram is also attached which clearly identifies all equipment that will be utilized.

The storage and measuring facility is located at NESE Sec. 20, T 9 S, R 25 E, on lease No. NM-18602, Chaves County, New Mexico. BLM will be notified if there is any future change in the facility location.

Details of the proposed method for allocating production to contributing sources is as follows:

Gas will be metered separately prior to measurement for sales for marketing gas to the pipeline company by their own check meter at each individual location.

---

---

---

~~\_\_\_\_\_~~  
The proposed commingling of production is in the interest of conservation and will not result in reduced royalty or improper measurement of production.

The proposed commingling is necessary for continued operation of the above referenced Federal leases.

We understand that the requested approval will not constitute the granting of any right-of-way or construction rights not granted by the lease instrument. And, we will submit within 30 days an application for right-of-way approval to the BLM's Realty Section in your office if we have not already done so.

Signature: Rusty Klein

Name: Rusty Klein

Title: Production Clerk

Date: June 27, 1994



RECEIVED

JUL 1 8 25 AM '94

BUREAU OF POST  
ROADS  
AREA

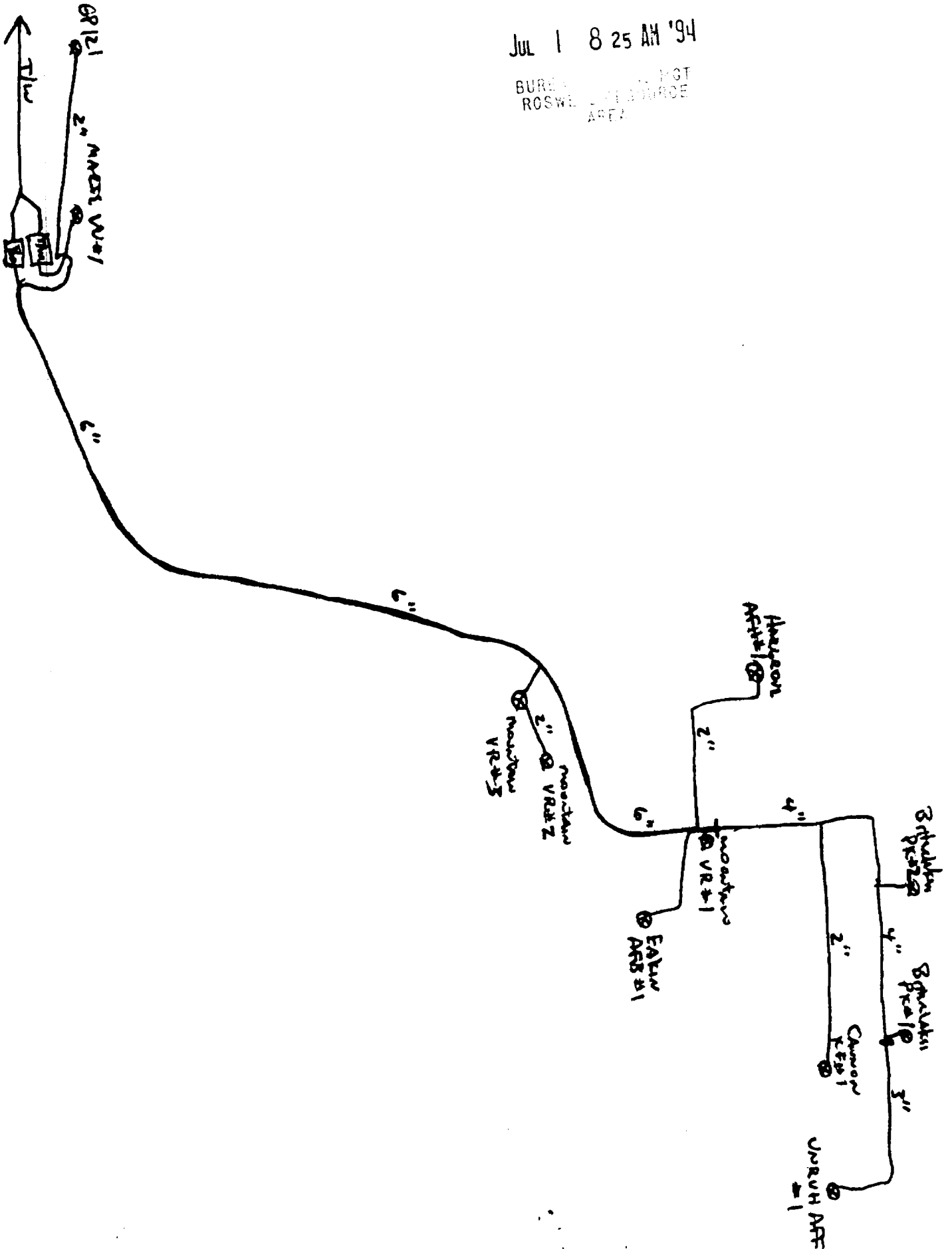

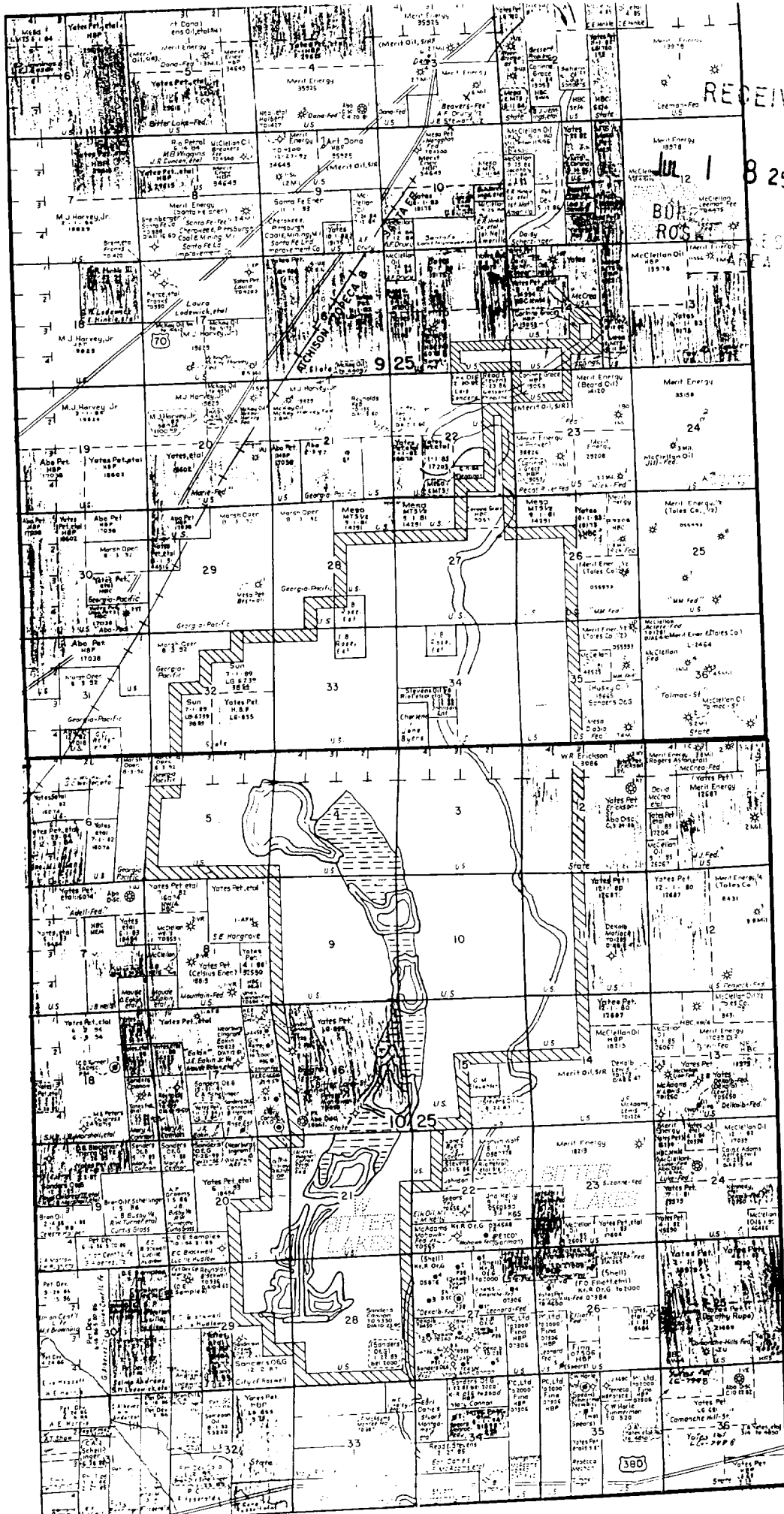

RECEIVED

Jun 1 8 25 AM '94

BOB ROSS  
POST  
RESOURCE

380