

Submit to Appropriate
District Office
State Lease - 6 copies
Fee Lease - 5 copies

State of New Mexico
Energy, Minerals and Natural Resources Department

Form C-101
Revised 1-1-89

OIL CONSERVATION DIVISION

DISTRICT I
P.O. Box 1980, Hobbs, NM 88240

DISTRICT II
P.O. Drawer DD, Artesia, NM 88210

DISTRICT III
1000 Rio Brazos Rd., Aztec, NM 87410

P.O. Box 2088
Santa Fe, New Mexico 87504-2088

JUN 11 1993

API NO. (assigned by OCD on New Wells)

30-005-62963

5. Indicate Type of Lease

STATE ☒

FEE ☐

6. State Oil & Gas Lease No.

V-2982

APPLICATION FOR PERMIT TO DRILL, DEEPEN OR PLUG BACK

1a. Type of Work:

DRILL ☒

RE-ENTER ☐

DEEPEN ☐

PLUG BACK ☐

b. Type of Well:

OIL
WELL ☒

GAS
WELL ☐

OTHER ☐

SINGLE
ZONE ☒

MULTIPLE
ZONE ☐

7. Lease Name or Unit Agreement Name

Bill Thorp State

2. Name of Operator

Collins Oil & Gas Corporation

8. Well No.

3

3. Address of Operator

P.O. Box 2443, Roswell, NM 88202-2443

9. Pool name or Wildcat

Southeast Acme San Andres Pool

4. Well Location

Unit Letter L : 1650 Feet From The South Line and 330 Feet From The West Line

Section 12

Township 8-S

Range 27E

NMPM Chaves

County

10. Proposed Depth

2200

11. Formation

San-Andres

12. Rotary or C.T.

C.T.

13. Elevations (Show whether DF, RT, GR, etc.)

3930 GL

14. Kind & Status Plug. Bond

Blanket

15. Drilling Contractor

C & J Drilling

16. Approx. Date Work will start

7-1-93

17.

PROPOSED CASING AND CEMENT PROGRAM

SIZE OF HOLE	SIZE OF CASING	WEIGHT PER FOOT	SETTING DEPTH	SACKS OF CEMENT	EST. TOP
12 1/2"	8-5/8"	24	470	sufficient to circulate	
7-7/8"	4 1/2"	10.50	2200	220	1100'

IN ABOVE SPACE DESCRIBE PROPOSED PROGRAM: IF PROPOSAL IS TO DEEPEN OR PLUG BACK, GIVE DATA ON PRESENT PRODUCTIVE ZONE AND PROPOSED NEW PRODUCTIVE ZONE. GIVE BLOWOUT PREVENTER PROGRAM, IF ANY.

I hereby certify that the information above is true and complete to the best of my knowledge and belief.

SIGNATURE Pres. Collins O/G TITLE Pres. Collins O/G DATE 6-10-93

TYPE OR PRINT NAME ROY D. COLLINS TELEPHONE NO. 623-2040

(This space for State Use)
ORIGINAL SIGNED BY
MIKE WILLIAMS
SUPERVISOR, DISTRICT II

APPROVED BY _____ TITLE _____ DATE JUN 11 1993

CONDITIONS OF APPROVAL, IF ANY:

Post ID-1
6-18-93
New Loc + APE

Submit to Appropriate
District Office
State Lease - 4 copies
Fee Lease - 3 copies

State of New Mexico
Energy, Minerals and Natural Resources Department

Form C-102
Revised 1-1-89

OIL CONSERVATION DIVISION

P.O. Box 2088
Santa Fe, New Mexico 87504-2088

DISTRICT I
P.O. Box 1980, Hobbs, NM 88240

DISTRICT II
P.O. Drawer DD, Artesia, NM 88210

DISTRICT III
1000 Rio Brazos Rd., Aztec, NM 87410

WELL LOCATION AND ACREAGE DEDICATION PLAT

All Distances must be from the outer boundaries of the section

Operator COLLINS OIL & GAS Corp.			Lease BILL THORP STATE		Well No. #3
Unit Letter L	Section 12	Township 8S.	Range 27E.	County NMPM CHAVES	
Actual Footage Location of Well: 1650 feet from the SOUTH line and 330 feet from the WEST line					
Ground level Elev. 3930		Producing Formation San-Andres		Pool Southeast Acme San Andres Pool	
				Dedicated Acreage: 40 Acres	

1. Outline the acreage dedicated to the subject well by colored pencil or hatchure marks on the plat below.
2. If more than one lease is dedicated to the well, outline each and identify the ownership thereof (both as to working interest and royalty).
3. If more than one lease of different ownership is dedicated to the well, have the interest of all owners been consolidated by communitization, unitization, force-pooling, etc.?
☐ Yes ☐ No If answer is "yes" type of consolidation _____
If answer is "no" list the owners and tract descriptions which have actually been consolidated. (Use reverse side of this form if necessary.)
No allowable will be assigned to the well until all interests have been consolidated (by communitization, unitization, forced-pooling, or otherwise) or until a non-standard unit, eliminating such interest, has been approved by the Division.

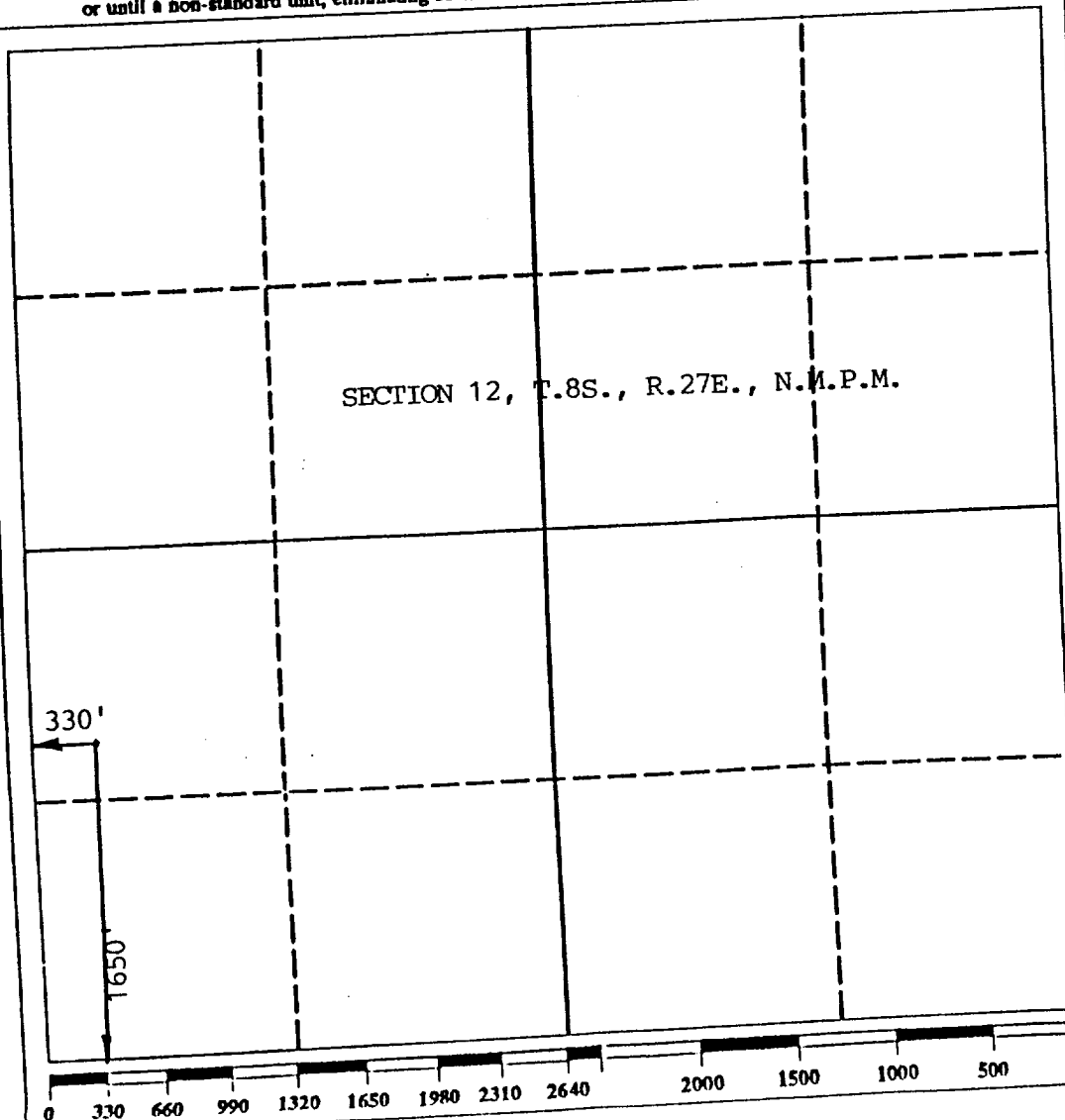

OPERATOR CERTIFICATION

I hereby certify that the information contained herein is true and complete to the best of my knowledge and belief.

Signature
Roy D. Collins
Printed Name
ROY D. COLLINS
Position
Pres.
Company
Collins O/G
Date
6-9-93

SURVEYOR CERTIFICATION

I hereby certify that the well location shown on this plat was plotted from field notes of actual surveys made by me or under my supervision, and that the same is true and correct to the best of my knowledge and belief.

Date Surveyed
5/21/93
Signature & Seal of Professional Surveyor
Jaques
Professional Engineer
Certificate No. 6292
THORP 34