

Submit to Appropriate
District Office
State Lease - 6 copies
Fee Lease - 5 copies

State of New Mexico
Energy, Minerals and Natural Resources Department

Form C-101
Revised 1-1-89

OIL CONSERVATION DIVISION

P.O. Box 2088
Santa Fe, New Mexico 87504-2088

DISTRICT I
P.O. Box 1980, Hobbs, NM 88240

DISTRICT II
P.O. Drawer DD, Artesia, NM 88210

DISTRICT III
1000 Rio Brazos Rd., Aztec, NM 87410

API NO. (assigned by OCD on New Wells)

30-005-62971

5. Indicate Type of Lease

STATE ☐

FEE ☒

6. State Oil & Gas Lease No.

APPLICATION FOR PERMIT TO DRILL, DEEPEN, OR PLUG BACK

1a. Type of Work:

DRILL ☒

RE-ENTER ☐

DEEPEN ☐

PLUG BACK ☐

b. Type of Well:

OIL
WELL ☒

GAS
WELL ☐

OTHER ☐

SINGLE
ZONE ☒

MULTIPLE
ZONE ☐

7. Lease Name or Unit Agreement Name

Ross Fee

2. Name of Operator

McClellan Oil Corporation

8. Well No.

1

3. Address of Operator

P O Drawer 730, Roswell, NM 88202-0730

9. Pool name or Wildcat

Wildcat

4. Well Location

Unit Letter D : 660' Feet From The North Line and 660' Feet From The West Line

Section 18

Township

8 South

Range

28 East

NMPM

Chaves

County

10. Proposed Depth

2350'

11. Formation

San Andres

12. Rotary or C.T.

Rotary & C.T.

13. Elevations (Show whether DF, RT, GR, etc.)

GR 3974'

14. Kind & Status Plug. Bond

Statewide

15. Drilling Contractor

United Dril. & Collins

16. Approx. Date Work will start

8/15/93

17. PROPOSED CASING AND CEMENT PROGRAM

SIZE OF HOLE	SIZE OF CASING	WEIGHT PER FOOT	SETTING DEPTH	SACKS OF CEMENT	EST. TOP
12 1/4"	8 5/8"	24 lb.	450'	450 sx	Cir. to surface
7 7/8"	5 1/2"	17 lb.	2350'	300 sx	

Propose to drill to 2225' with rotary rig using air and soap. At 2225' will move rotary rig off hole and drill with cable tool rig from 2225' to an approximate total depth of 2350'. If oil and gas are found in commercial quantities, 5 1/2" production casing will be run and a completion attempt will be made in the San Andres.

IN ABOVE SPACE DESCRIBE PROPOSED PROGRAM: IF PROPOSAL IS TO DEEPEN OR PLUG BACK, GIVE DATA ON PRESENT PRODUCTIVE ZONE AND PROPOSED NEW PRODUCTIVE ZONE. GIVE BLOWOUT PREVENTER PROGRAM, IF ANY.

I hereby certify that the information above is true and complete to the best of my knowledge and belief.

SIGNATURE Mark McClellan TITLE President DATE 7/23/93

TYPE OR PRINT NAME

TELEPHONE NO. (505) 622-3200

(This space for State Use)

APPROVED BY Mark Bahling TITLE GEOLOGIST DATE 7-26-93

CONDITIONS OF APPROVAL, IF ANY:

APPROVAL VALID FOR 180 DAYS
PERMIT EXPIRES 1-26-94
UNLESS DRILLING UNDERWAY

State of New Mexico
Energy, Minerals and Natural Resources Department

Form C-102
Revised 1-1-89

OIL CONSERVATION DIVISION

P.O. Box 2088
Santa Fe, New Mexico 87504-2088

Submit to Appropriate
District Office
State Lease - 4 copies
Fee Lease - 3 copies

DISTRICT I
P.O. Box 1980, Hobbs, NM 88240

DISTRICT II
P.O. Drawer DD, Artesia, NM 88210

DISTRICT III
1000 Rio Brazos Rd., Aztec, NM 87410

WELL LOCATION AND ACREAGE DEDICATION PLAT

All Distances must be from the outer boundaries of the section

Operator MCCLELLAN OIL		Lease ROSS FEE		Well No. #1
Unit Letter D	Section 18	Township 8S.	Range 28E.	County CHAVES
Actual Footage Location of Well: 660 feet from the NORTH line and 660 feet from the WEST line				
Ground level Elev. 3974	Producing Formation San Andres	Pool Wildcat	Dedicated Acreage: 40 Acres	

1. Outline the acreage dedicated to the subject well by colored pencil or hatchure marks on the plat below.

2. If more than one lease is dedicated to the well, outline each and identify the ownership thereof (both as to working interest and royalty).

3. If more than one lease of different ownership is dedicated to the well, have the interest of all owners been consolidated by communitization, unitization, force-pooling, etc.?

☐ Yes ☐ No

If answer is "yes" type of consolidation

If answer is "no" list the owners and tract descriptions which have actually been consolidated. (Use reverse side of this form if necessary.)

No allowable will be assigned to the well until all interests have been consolidated (by communitization, unitization, forced-pooling, or otherwise) or until a non-standard unit, eliminating such interest, has been approved by the Division.

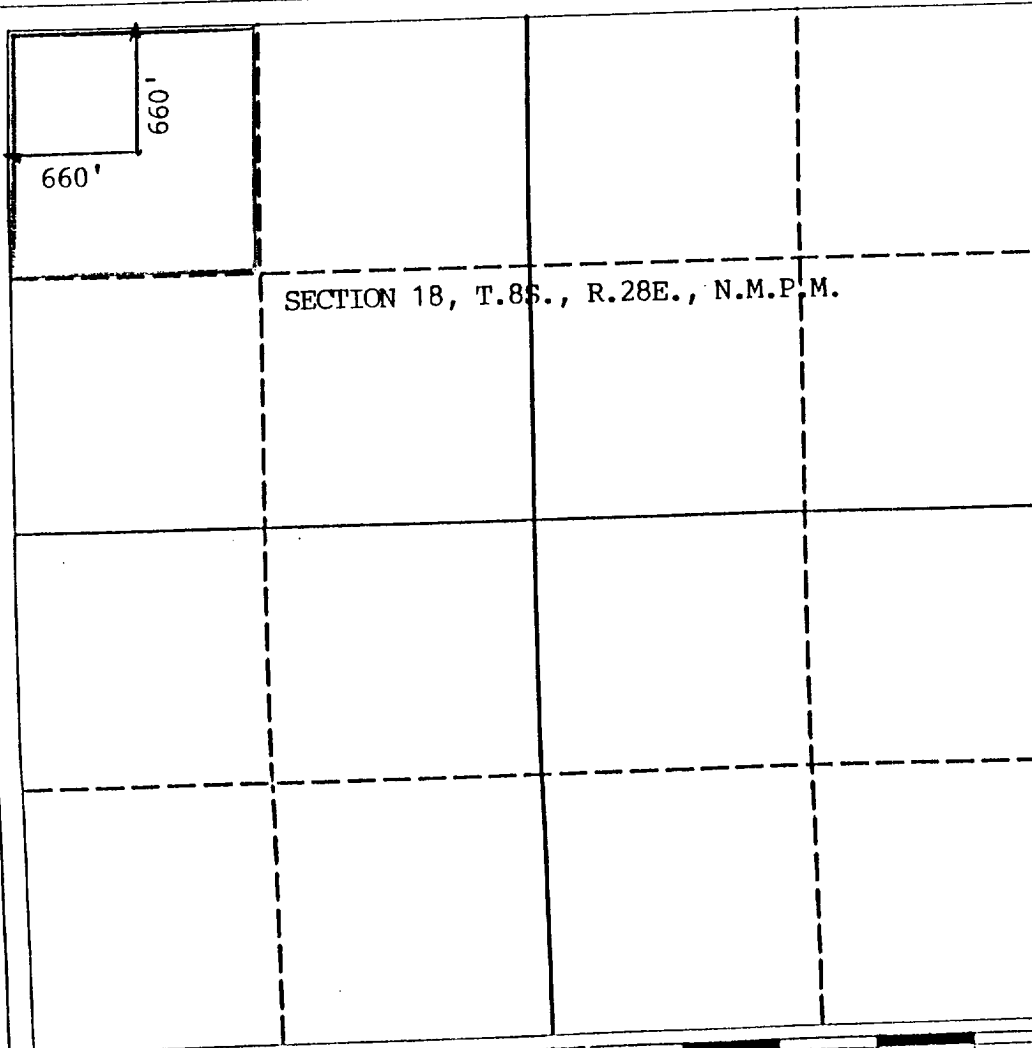

OPERATOR CERTIFICATION

I hereby certify that the information contained herein is true and complete to the best of my knowledge and belief.

Signature

Mark McClellan

Printed Name

Mark McClellan

Position

President

Company

McClellan Oil Corporation

Date

7-21-93

SURVEYOR CERTIFICATION

I hereby certify that the well location shown on this plat was plotted from field notes of actual surveys made by me or under my supervision, and that the same is true and correct to the best of my knowledge and belief.

Date Surveyed

7/15/93

Signature & Seal of
Professional Surveyor

Certificate No.

6290

HANMAC1