

# N. M. Oil Cons. Division

811 S. 1ST ST.

ARTESIA NM 88210-2834

SUBMIT IN TR DATE\*

(Other instructions on reverse side)

FORM APPROVED

OMB NO. 1004-0136

Expires: February 28, 1995

Form 3160-3  
(July 1992)

## UNITED STATES DEPARTMENT OF THE INTERIOR BUREAU OF LAND MANAGEMENT

### APPLICATION FOR PERMIT TO DRILL OR DEEPEN

1a. TYPE OF WORK

DRILL ☒

DEEPEN ☐

b. TYPE OF WELL

OIL WELL ☐

GAS WELL ☒

OTHER

SINGLE ZONE ☐

MULTIPLE ZONE ☐

2. NAME OF OPERATOR

YATES PETROLEUM CORPORATION

3. ADDRESS AND TELEPHONE NO.

105 South Fourth Street, Artesia, NM 88210 (505) 748-1471

4. LOCATION OF WELL (Report location clearly and in accordance with any State requirements.)

At surface

660' FNL and 1980' FWL, Unit C

At proposed prod. zone

Same

14. DISTANCE IN MILES AND DIRECTION FROM NEAREST TOWN OR POST OFFICE\*

25 miles Northeast of Roswell, New Mexico

15. DISTANCE FROM PROPOSED\*

LOCATION TO NEAREST

PROPERTY OR LEASE LINE, FT.

(Also to nearest drilg. unit line, if any)

16. NO. OF ACRES IN LEASE

320

17. NO. OF ACRES ASSIGNED TO THIS WELL

160

18. DISTANCE FROM PROPOSED LOCATION\*

TO NEAREST WELL, DRILLING, COMPLETED, OR APPLIED FOR, ON THIS LEASE, FT.

19. PROPOSED DEPTH

4400'

20. ROTARY OR CABLE TOOLS

Rotary

21. ELEVATIONS (Show whether DF, RT, GR, etc.)

3838' GR

22. APPROX. DATE WORK WILL START\*

ASAP

23.

#### PROPOSED CASING AND CEMENTING PROGRAM

SIZE OF HOLE	GRADE, SIZE OF CASING	WEIGHT PER FOOT	SETTING DEPTH	QUANTITY OF CEMENT
14.75"	9.625"	36# J-55	850'	700 sx Circulate
*12.25"	8.625"	24# J-55	1600'	300 sx Tie-back to 9 5/8" casing
7.875"	4.5"	10.5# J-55	TD	350 sx

Yates Petroleum Corporation proposes to drill and test the Abo and intermediate formations. Approx. 800' of surface casing will be set and cement circulated to the surface. (\*If lost circulation is encountered, 8 5/8" casing will be set to approx. 1600'. Hole size will be reduced to 6.125".) If commercial, production casing will be run and cemented with adequate cover, perforated and stimulated as needed for production.

MUD PROGRAM: Spud to 850' with FW Gel/LCM; 850' to 3700' with cut brine; 3700' to TD with SW Gel/Starch/Oil.

BOPE PROGRAM: BOPE will be installed on the 9.625" casing and tested daily for operational.

GAS NOT DEDICATED.

MAY - 2 1996

OIL CON. DIV.

DIST 2

IN ABOVE SPACE DESCRIBE PROPOSED PROGRAM: If proposal is to deepen, give data on present productive zone and proposed new productive zone. If proposal is to drill or deepen directionally, give pertinent data on subsurface locations and measured and true vertical depths. Give blowout preventer program, if any.

24.

SIGNED

*Clifton R. May*

TITLE Regulatory Agent

DATE 4-23-96

(This space for Federal or State office use)

PERMIT NO.

APPROVAL DATE

Application approval does not warrant or certify that the applicant holds legal or equitable title to those rights in the subject lease which would entitle the applicant to conduct operations thereon.

CONDITIONS OF APPROVAL, IF ANY:

APPROVED BY

TITLE

DATE

\*See Instructions On Reverse Side

Title 18 U.S.C. Section 1001. makes it a crime for any person knowingly and willfully to make to any department or agency of the

## INSTRUCTIONS

GENERAL: This form is designed for submitting proposals to perform certain well operations, as indicated, on all types of lands and leases for appropriate action by either a Federal or a State agency, or both, pursuant to applicable Federal and/or State laws and regulations. Any necessary special instructions concerning the use of this form and the number of copies to be submitted, particularly with regard to local, area, or regional procedures and practices, either are shown below or will be issued by, or may be obtained from, the local Federal and/or State office.

ITEM 1: If the proposal is to redrill to the same reservoir at a different subsurface location or to a new reservoir, use this form with appropriate notations. Consult applicable State or Federal regulations concerning subsequent work proposals or reports on the well.

ITEM 4: If there are no applicable State requirements, locations on Federal or Indian land should be described in accordance with Federal requirements. Consult local State or Federal office for specific instructions.

ITEM 14: Needed only when location of well cannot readily be found by road from the land or lease description. A plat, or plats, separate or on this reverse side, showing the roads to, and the surveyed location of, the well, and any other required information, should be furnished when required by Federal or State agency offices.

ITEMS 15 AND 18: If well is to be, or has been directionally drilled, give distances for subsurface location of hole in any present or objective production zone.

ITEM 22: Consult applicable Federal or State regulations, or appropriate officials, concerning approval of the proposal before operations are started.

## NOTICE

The Privacy Act of 1974 and the regulation in 43 CFR 2.48(d) provide that you be furnished the following information in connection with information required by this application.

AUTHORITY: 30 U.S.C. 181 et seq., 25 U.S.C. 396; 43 CFR Part 3160.

PRINCIPAL PURPOSE: The information is to be used to process and evaluate your application for permit to drill or deepen an oil or gas well.

ROUTINE USES: (1) The analysis of the applicant's proposal to discover and extract the Federal or Indian resources encountered. (2) The review of procedures and equipment and the projected impact on the land involved. (3) The evaluation of the effects of proposed operation on surface and subsurface water and other environmental impacts. (4)(5) Information from the record and/or the record will be transferred to appropriate Federal, State, local or foreign agencies, when relevant to civil, criminal or regulatory investigations or prosecutions, as well as routine regulatory responsibility.

EFFECT OF NOT PROVIDING INFORMATION: Filing of this application and disclosure of the information is mandatory only if the operator elects to initiate drilling operation on an oil and gas lease.

## BURDEN HOURS STATEMENT

Public reporting burden for this form is estimated to average 30 minutes per response, including the time for reviewing instructions, gathering and maintaining data, and completing and reviewing the form. Direct comments regarding the burden estimate or any other aspect of this form to U.S. Department of the Interior, Bureau of Land Management, (Alternate) Bureau Clearance Officer, (WO-771), 1849 C Street, N.W., Washington, D.C. 20240, and the Office of Management and Budget, Paperwork Reduction Project (1004-0136), Washington, D.C. 20503.

The Paperwork Reduction Act of 1980 (44 U.S.C. 3501 et seq) requires us to inform you that:

This information is being collected to allow evaluation of the technical, safety, and environmental factors involved with drilling for oil and/or gas on Federal and Indian oil and gas leases.

This information will be used to analyze and approve applications.

Response to this request is mandatory only if the operator elects to initiate drilling operations on an oil and gas lease.

District I  
PO Box 1980, Hobbs, NM 88241-1980  
District II  
PO Drawer DD, Artesia, NM 88211-0719  
District III  
1000 Rio Brazos Rd., Aztec, NM 87410  
District IV  
PO Box 2088, Santa Fe, NM 87504-2088

State of New Mexico  
Energy, Minerals & Natural Resources Department

OIL CONSERVATION DIVISION  
PO Box 2088  
Santa Fe, NM 87504-2088

Form C-102  
Revised February 10, 1994  
Instructions on back  
Submit to Appropriate District Office  
State Lease - 4 Copies  
Fee Lease - 3 Copies

☐ AMENDED REPORT

WELL LOCATION AND ACREAGE DEDICATION PLAT

1 API Number 30-015-63086		2 Pool Code		3 Pool Name PECOS SLOPE ABO			
4 Property Code		5 Property Name COFFMAN "NY" FEDERAL				6 Well Number 3	
7 GRID No. 025575		8 Operator Name YATES PETROLEUM CORPORATION				9 Elevation 3638	

10 Surface Location

UL or lot no. C	Section 25	Township 7S	Range 25E	Lot Ida	Feet from the 660	North/South line North	Feet from the 1980	East/West line West	County Chaves
--------------------	---------------	----------------	--------------	---------	----------------------	---------------------------	-----------------------	------------------------	------------------

11 Bottom Hole Location If Different From Surface

UL or lot no.	Section	Township	Range	Lot Ida	Feet from the	North/South line	Feet from the	East/West line	County
---------------	---------	----------	-------	---------	---------------	------------------	---------------	----------------	--------

12 Dedicated Acres 160	13 Joint or Infill	14 Consolidation Code	15 Order No.
---------------------------	--------------------	-----------------------	--------------

NO ALLOWABLE WILL BE ASSIGNED TO THIS COMPLETION UNTIL ALL INTERESTS HAVE BEEN CONSOLIDATED  
OR A NON-STANDARD UNIT HAS BEEN APPROVED BY THE DIVISION

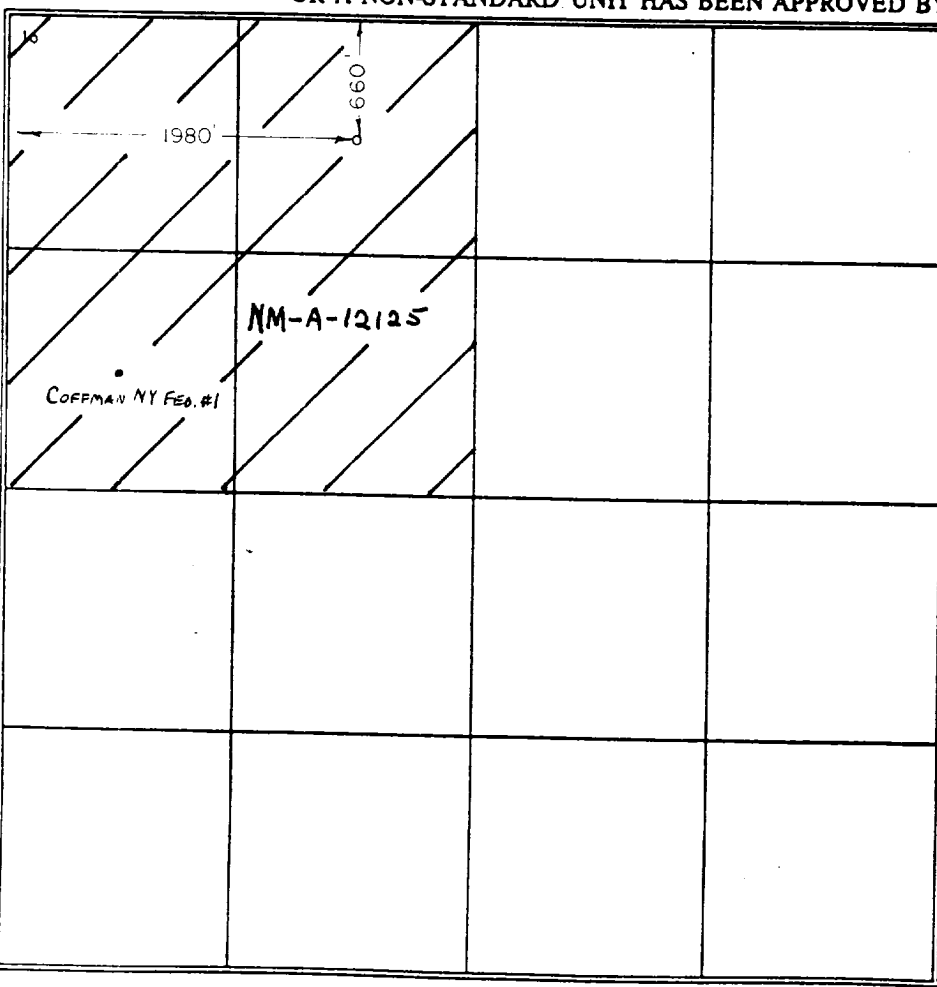
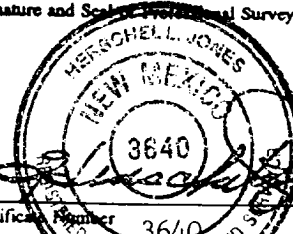
				<p>17 OPERATOR CERTIFICATION</p> <p>I hereby certify that the information contained herein is true and complete to the best of my knowledge and belief</p> <p><i>Clifton R. May</i> Signature Clifton R. May Printed Name Regulatory Agent Title 4-23-96 Date</p>	
<p>18 SURVEYOR CERTIFICATION</p> <p>I hereby certify that the well location shown on this plat was plotted from field notes of actual surveys made by me or under my supervision, and that the same is true and correct to the best of my belief.</p> <p>4/10/96 Date of Survey Signature and Seal of Professional Surveyer:  Certificate Number 3640</p>					

**YATES PETROLEUM CORPORATION  
COFFMAN NY FED. #3  
660' FNL AND 1980' FWL  
Sec. 25-T7S-R25E  
Chaves County, New Mexico**

1. The estimated tops of geologic markers are as follows:

San Andres	406'
Glorieta	1581'
Abo	3671'
TD	4400'

2. The estimated depths at which anticipated water, oil or gas formations are expected to be encountered:

Water:	70'-150'
Oil or Gas:	3671'

3. Pressure Control Equipment: BOPE will be installed on the 9 5/8" casing and rated for 2000# BOP systems will be consistent with API RP 53. Pressure tests will be conducted before drilling out from under all casing strings which are set and cemented in place. Blowout preventor controls will be installed prior to drilling the surface plug and will remain in use until the well is completed or abandoned. Preventors will be inspected and operated at least daily to ensure good mechanical working order, and this inspection recorded on the daily drilling report. See Exhibit B.

**Auxiliary Equipment:**

- A. Auxiliary Equipment: Kelly cock, pit level indicators, flow sensor equipment, and a sub with full opening valve to fit the drill pipe and collars will be available on the rig floor in the open position at all times for use when kelly is not in use.

4. THE PROPOSED CASING AND CEMENTING PROGRAM:

- A. Casing Program: (All New)

<u>Hole Size</u>	<u>Casing Size</u>	<u>Wt./Ft</u>	<u>Grade</u>	<u>Thread</u>	<u>Coupling</u>	<u>Interval</u>	<u>Length</u>
14.75"	9.625"	36#	J55	8RD	ST&C	0-850'	850'
*12.25"	8.625"	24#	J55	8RD	ST&C	0-1600'	1600'
7.875"	4.5"	10.5#	J55	8RD	ST&C	0-TD	4400'

1. Minimum Casing Design Factors: Collapse 1.125, Burst 1.0, Tensile Strength 1.80
2. 8 5/8" casing to be set if lost circulation is encountered. If lost circulation is not encountered, the hole will be reduced to 7 7/8" at 1600'.
3. Yates Petroleum Corporation requests that a variance be granted in requiring the casing and BOPE to be tested to 2000 PSI to testing the casing and BOPE to 1000 PSI. The rig pumps will be used to test the casing and BOPE. Rig pumps used in this area cannot safely test above 1000 PSI. We would have to go to the greater expense of hiring an independent service to do the testing. Also, the maximum shut-in bottom hole pressure is 1100 PSI. Pressure at the surface is much less. Most of the time the Abo formation requires treatment before it flows.

**B. CEMENTING PROGRAM:**

Surface casing: Cement with 450 sx. pacesetter Lite "C" + 10#/sx Gilsonite x 1/4#/sx Celloseal + 3% CaCL2 (yield 1.98, wt. 12.46). Tail in with 250 sx Class "C" + 2% CACL2 (yield 1.33, wt. 13.0).

Intermediate Casing: If ran will cement with 300 sx class "C" + 2% CACL2 (yield 1.33, wt. 13). Tie back to 9 5/8" casing.

Production Casing: Cement with 350 sx. "C" with 8# Silica Lite (yield 1.6 wt 14).

**5. Mud Program and Auxiliary Equipment:**

<u>Interval</u>	<u>Type</u>	<u>Weight</u>	<u>Viscosity</u>	<u>Fluid Loss</u>
Spud to 850'	FwGel/LCM	8.4-9.6	32-38	N/C
800' to 3200'	Cut Brine	9.3 - 10.0	28	N/C
3500' to TD	SW Gel/Starch/Oil	9.3	34-45	<10cc

Sufficient mud material(s) to maintain mud properties, control lost circulation and contain a blow out will be available at the well site during drilling operations. Mud will be checked hourly by rig personnel.

**6. EVALUATION PROGRAM:**

Samples: 10' samples out from surface casing.

Logging: CNL/LDT TD to csg.; w/CNL/GR to surface.; DLL w/rxo - TD to casing.

Coring: None

DST's: Any tests will be based on the recommendation of the well site geologist as warranted by breaks and shows.

**7. Abnormal Conditions, Bottom hole pressure and potential hazards:**

Anticipated BHP:

From: 0	To: 850	Anticipated Max. BHP: 400 PSI
From: 850	To: TD	Anticipated Max. BHP: 1100 PSI

Abnormal Pressures Anticipated: None

Lost Circulation zones anticipated: None

H2S Zones Anticipated: None

Maximum Bottom Hole Temperature: 110 F

**8. ANTICIPATED STARTING DATE:**

Plans are to drill this well as soon as possible after receiving approval. It should take approximately 15 days to drill the well with completion taking another 15 days.

## **MULTI-POINT SURFACE USE AND OPERATIONS PLAN**

**Yates Petroleum Corporation  
Coffman Federal Com #3  
660' FNL and 1980' FWL  
Sec. 25-T7S-R25E  
Chaves County, New Mexico**

This plan is submitted with Form 3160-3, Application for Permit to Drill, covering the above described well. The purpose of this plan is to describe the location of the proposed well, the proposed construction activities and operations plan, the magnitude of the surface disturbance involved and the procedures to be followed in rehabilitating the surface after completion of the operations, so that a complete appraisal can be made of the environmental effect associated with the operations.

### **1. EXISTING ROADS:**

Exhibit A is a portion of the BLM map showing the well and roads in the vicinity of the proposed location. The proposed wellsite is located approximately 25 miles northeast of Roswell New Mexico and the access route to the location is indicated in red and green on Exhibit A.

### **DIRECTIONS:**

Go north of Roswell on Highway 285 for approximately 13 miles to One Horse Road. Turn right and follow road 2.6 miles to Cottonwood road. Go left on Cottonwood for 9.2 miles to Chaves Road. Go right for 2.6 miles and new access will start here and go north to the southeast corner of the pad.

### **2. PLANNED ACCESS ROAD:**

- A. The proposed new access will be approximately 600' in length from the point of origin to the southeast corner of the drilling pad. The road will lie in a(n) northwesterly direction.
- B. The new road will be 14 feet in width (driving surface) and will be adequately drained to control runoff and soil erosion.
- C. The new road will be bladed with drainage on both sides. No traffic turnout will be built.
- D. The route of the road is visible.
- E. Existing roads will be maintained in the same or better condition.

### **3. LOCATION OF EXISTING WELL**

- A. There is drilling activity within a one-mile radius of the wellsite.
- B. Exhibit D shows existing wells within a one-mile radius of the proposed wellsite.

**4. LOCATION OF EXISTING AND/OR PROPOSED FACILITIES**

- A. There are production facilities on this lease at the present time.
- B. In the event that the well is productive, the necessary production facilities will be installed on the drilling pad. If the well is productive oil, a gas or diesel self-contained unit will be used to provide the necessary power. No power will be required if the well is productive of gas.

**5. LOCATION AND TYPE OF WATER SUPPLY:**

- A. It is planned to drill the proposed well with a fresh water system. Jim's Water Service of Artesia, New Mexico will be contracted to furnish the water. The water will be obtained from commercial sources, probably in Roswell, and will be hauled to the location by truck over the existing and proposed roads shown in Exhibit A. Probable source is Abo #3 water station in the SE/4NE/4 of Section 19, Township 7 South, Range 26 East.

**6. SOURCE OF CONSTRUCTION MATERIALS:**

The dirt contractor is responsible for finding a pit to use for construction of road and pad. A possible pit is located in SE/4NE/4 of Section 19-T7S-R26E.

**7. METHODS OF HANDLING WASTE DISPOSAL:**

- A. Drill cuttings will be disposed of in the reserve pits.
- B. Drilling fluids will be allowed to evaporate in the reserve pits until the pits are dry.
- C. Water produced during operations will be collected in tanks until hauled to an approved disposal system, or separate disposal application will be submitted.
- D. Oil produced during operations will be stored in tanks until sold.
- E. Current laws and regulations pertaining to the disposal of human waste will be complied with.
- F. All trash, junk, and other waste materials will be contained in trash cages or bins to prevent scattering and will be removed and deposited in an approved sanitary land fill. Burial on site is not approved.

**8. ANCILLARY FACILITIES: NONE**

**9. WELLSITE LAYOUT:**

- A. Exhibit C shows the relative location and dimensions of the well pad, the reserve pits, the location of the drilling equipment, rig orientation and access road approach.
- B. The reserve pits will be plastic lined.
- C. A 400' x 400' area has been staked and flagged.

10. PLANS FOR RESTORATION

- A. After finishing drilling and/or completion operations, all equipment and other material not needed for further operations will be removed. The location will be cleaned of all trash and junk to leave the wellsite in as aesthetically pleasing a condition as possible.
- B. Unguarded pits, if any, containing fluids will be fenced until they have dried and been leveled.
- C. If the proposed well is non-productive, all rehabilitation and/or vegetation requirements of the Bureau of Land Management will be complied with and will be accomplished as expeditiously as possible. All pits will be filled level after they have evaporated and dried.

11. SURFACE OWNERSHIP: Federal surface administered by BLM.

12. OTHER INFORMATION:

- A. Topography: Refer to the existing archaeological report for a description of the topography, flora, fauna, soil characteristics, dwellings, historical and cultural sites.
- B. The primary surface use is for grazing.

13. OPERATOR'S REPRESENTATIVE

A. Through A.P.D. Approval:

Clifton R. May, Permit Agent  
Yates Petroleum Corporation  
105 South Fourth Street  
Artesia, New Mexico 88210  
Phone (505) 748-1471

B. Through Drilling Operations,  
Completions and Production:

Brian Collins, Operations Manager  
Yates Petroleum Corporation  
105 South Fourth Street  
Artesia, New Mexico 88210  
Phone (505) 748-1471

14. CERTIFICATION:

I hereby certify that I, or persons under my direct supervision, have inspected the proposed drill site and access route, that I am familiar with the conditions which presently exist; that the statements made in this plan are to the best of my knowledge, true and correct; and , that the work associated with the operations proposed herein will be performed by Yates Petroleum Corporation and its contractors and subcontractors in conformity with this plan and the terms and conditions under which it is approved. This statement is subject to the provisions of 18 U.S.C. 1001 for the filing of a false statement.

4/23/96

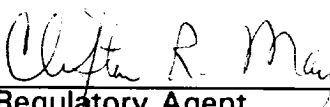
  
Regulatory Agent



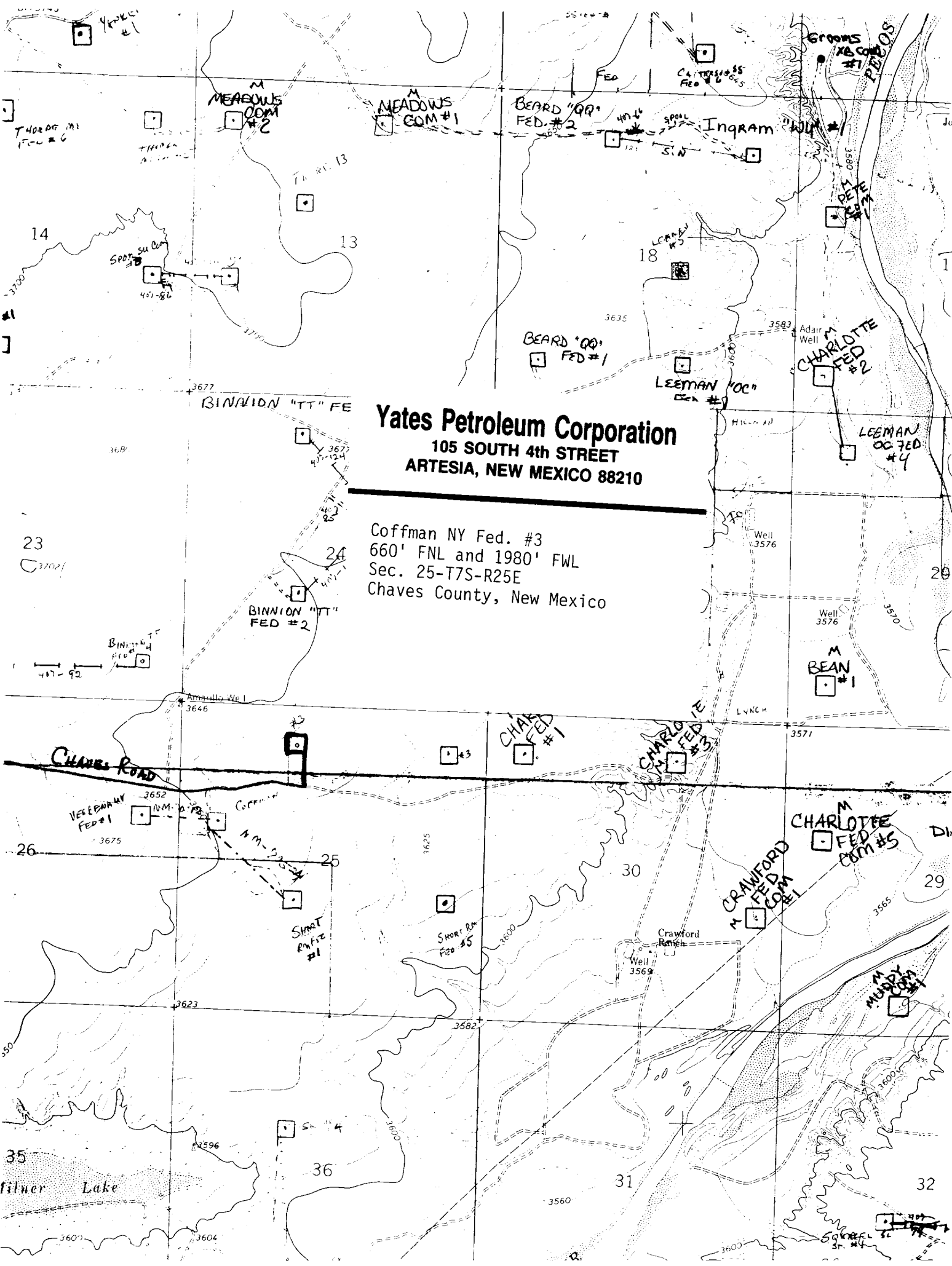

**Yates Petroleum Corporation**  
105 SOUTH 4th STREET  
ARTESIA, NEW MEXICO 88210

Coffman NY Fed. #3  
660' FNL and 1980' FWL  
Sec. 25-T7S-R25E  
Chaves County, New Mexico

# YATES PETROLEUM CORPORATION

## Yates Petroleum Corporation

105 SOUTH 4th STREET  
ARTESIA, NEW MEXICO 88210

Coffman NY Fed. #3  
660' FNL and 1980' FWL  
Sec. 25-T7S-R25E  
Chaves County, New Mexico

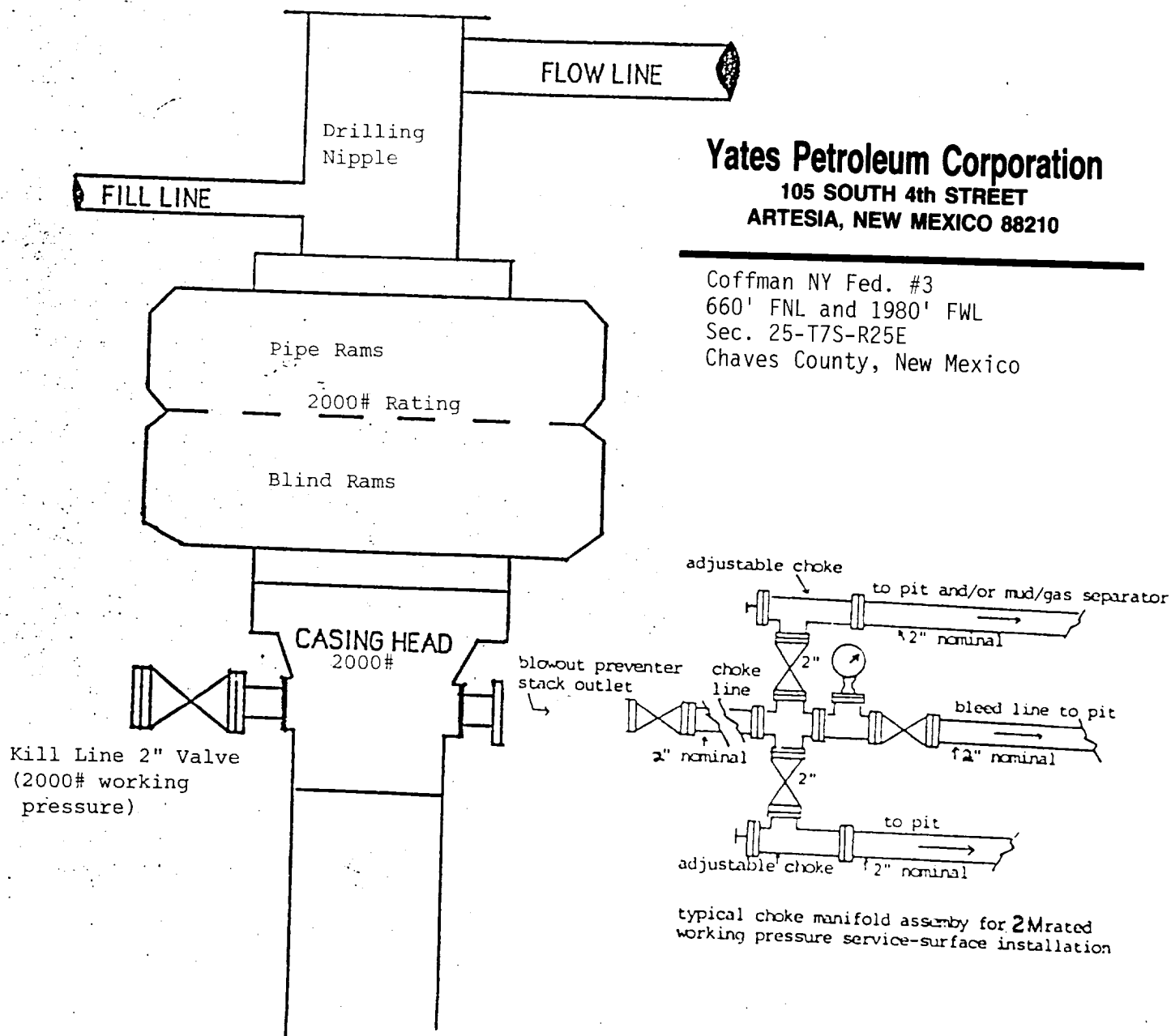

**BLOWOUT PREVENTER  
2M SYSTEM**



## Yates Petroleum Corporation

105 SOUTH 4th STREET  
ARTESIA, NEW MEXICO 88210

Coffman NY Fed. #3  
660' FNL and 1980' FWL  
Sec. 25-T7S-R25E  
Chaves County, New Mexico

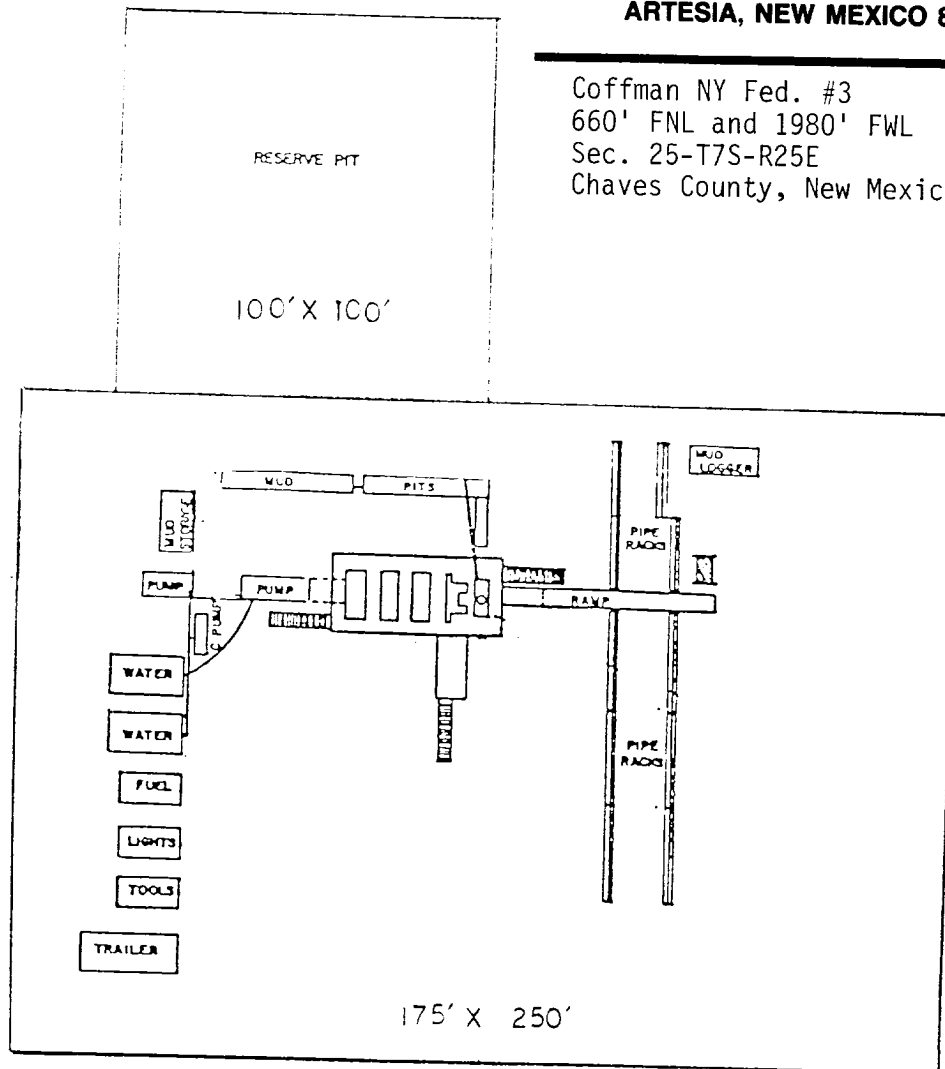

**Yates Petroleum Corporation**  
105 SOUTH 4th STREET  
ARTESIA, NEW MEXICO 88210

Coffman NY Fed. #3  
660' FNL and 1980' FWL  
Sec. 25-T7S-R25E  
Chaves County, New Mexico

