

UNITED STATES  
DEPARTMENT OF THE INTERIOR  
BUREAU OF LAND MANAGEMENT

N.M. Oil Cons.

P.O. Box 1980

Hobbs, NM 88241

FORM APPROVED  
OMB No. 1004-0135  
Expires July 31, 1996

**SUNDRY NOTICES AND REPORTS ON WELLS**

*Do not use this form for proposals to drill or to re-enter an abandoned well. Use Form 3160-3 (APD) for such proposals.*

**SUBMIT IN TRIPLICATE - Other Instructions on reverse side**

1. Type of Well  
☐ Oil Well ☒ Gas Well ☐ Other

2. Name of Operator  
Gothic Production Corp.

3a. Address C/O J.O. Easley, Inc.  
P.O. Box 2691, Roswell, NM 88202-2691

3b. Phone (include area code)  
(505) 682-6879

4. Location of Well (Footage, Sec., T., R., M., or Survey Description)  
660' FNL & 2200'  
21, T7S-26E

5. Lease Serial No.  
NM-022584

6. If Indian, Allottee or Tribe Name

7. If Unit or CA/Agreement, Name and/or No.

8. Well Name and No.  
Chaves A Federal

9. API Well No.  
30-005-63177

10. Field and Pool, or Exploratory Area  
Pecos Slope Abo (82730)

11. County or Parish, State

Chaves

**12. CHECK APPROPRIATE BOX(ES) TO INDICATE NATURE OF NOTICE, REPORT, OR OTHER DATA**

TYPE OF SUBMISSION	TYPE OF ACTION			
<input checked="" type="checkbox"/> Notice of Intent	<input type="checkbox"/> Acidize	<input type="checkbox"/> Deepen	<input type="checkbox"/> Production (Start/Resume)	<input type="checkbox"/> Water Shut-Off
<input type="checkbox"/> Subsequent Report	<input type="checkbox"/> Alter Casing	<input type="checkbox"/> Fracture Treat	<input type="checkbox"/> Reclamation	<input type="checkbox"/> Well Integrity
<input type="checkbox"/> Final Abandonment Notice	<input type="checkbox"/> Casing Repair	<input type="checkbox"/> New Construction	<input type="checkbox"/> Recomplete	<input checked="" type="checkbox"/> Other <u>Gas pipeline connection</u>
	<input type="checkbox"/> Change Plans	<input type="checkbox"/> Plug and Abandon	<input type="checkbox"/> Temporarily Abandon	
	<input type="checkbox"/> Convert to Injection	<input type="checkbox"/> Plug Back	<input type="checkbox"/> Water Disposal	

13. Describe Proposed or Completed Operation (clearly state all pertinent details, including estimated starting date of any proposed work and approximate duration thereof. If the proposal is to deepen directionally or recompleat horizontally, give subsurface locations and measured and true vertical depths of all pertinent markers and zones. Attach the Bond under which the work will be performed or provide the Bond No. on file with BLM/BIA. Required subsequent reports shall be filed within 30 days following completion of the involved operations. If the operation results in a multiple completion or recompleat in a new interval, a Form 3160-4 shall be filed once testing has been completed. Final Abandonment Notices shall be filed only after all requirements, including reclamation, have been completed, and the operator has determined that the site is ready for final inspection.)

The operator intends install a 2" natural gas steel pipeline from this well west 1540' to the Chaves Federal A-3 (See attached map). The pipeline will be buried approximately 2'. A right of way of approximately 20' will be utilized for the installation and maintenance of the pipeline. The NENW of Section 21 is federal surface and the NWNW of Section 21 is fee surface. A pipeline right of way will be obtained from the fee surface owner prior to commencement of the construction. Also, an archeological survey has been conducted long the entire route and will be filed under separate cover.

14. I hereby certify that the foregoing is true and correct

Name (Printed/Typed)

James L. Schultz

Title

Agent/J.O. Easley, Inc.

Signature

Date

11-20-98

**THIS SPACE FOR FEDERAL OR STATE OFFICE USE**

Approved by

(ORIG. FILED) ALVARADO A. LOPEZ

Acting

Title Assistant Field Office Manager,  
Lands and Minerals  
Office

Date

1-5-99

Conditions of approval, if any, are attached. Approval of this notice does not warrant or certify that the applicant holds legal or equitable title to those rights in the subject lease which would entitle the applicant to conduct operations thereon.

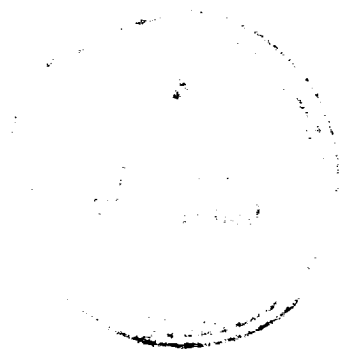

RECEIVED  
DEC 04 '98  
ROSWELL, NM

# EXHIBIT A

Chaves A Federal #4

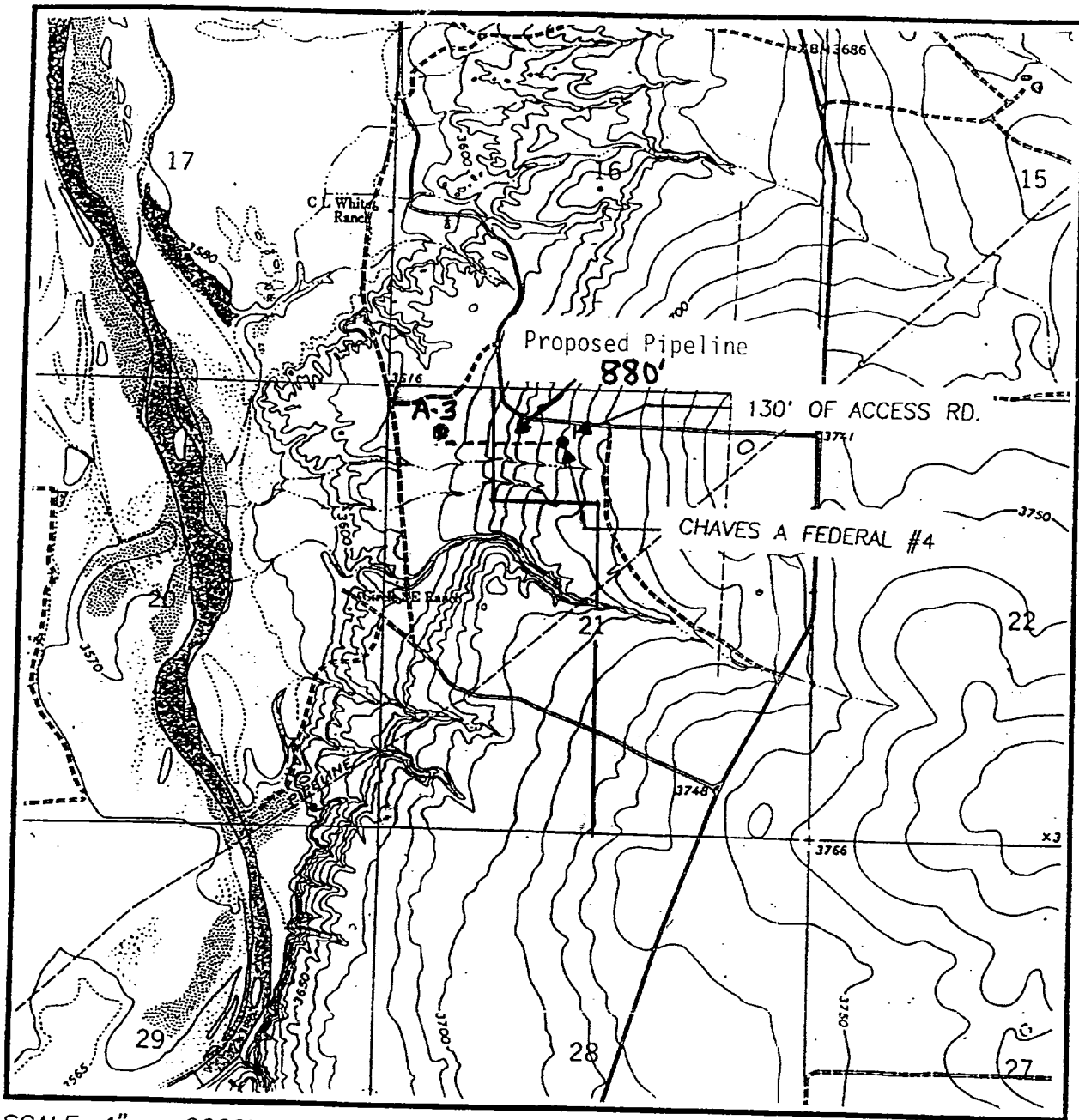

SCALE: 1" = 2000'

**NM 022584**

CONTOUR INTERVAL:  
EIGHTMILE DRAW - 10'

SEC. 21 TWP. 7-S RGE. 26-E

SURVEY N.M.P.M.

COUNTY CHAVES

DESCRIPTION 660' FNL & 2200' FWL

ELEVATION 3683

OPERATOR GOthic ENERGY CORP.

LEASE CHAVES A FEDERAL

U.S.G.S. TOPOGRAPHIC MAP

EIGHTMILE DRAW, N.M.

**JOHN WEST ENGINEERING  
HOBBS, NEW MEXICO**

**(505) 393-3117**

A

HW 035284

RECEIVED  
DEC 04 98  
SLM  
ROSWELL, NM