

District I  
1625 N. French Dr., Hobbs, NM 88240  
District II  
811 South First, Artesia, NM 88210  
District III  
1000 Rio Brazos Road, Aztec, NM 87410  
District IV  
2040 South Pacheco, Santa Fe, NM 87505

State of New Mexico  
Energy Minerals and Natural Resources

Oil Conservation Division  
2040 South Pacheco  
Santa Fe, NM 87505

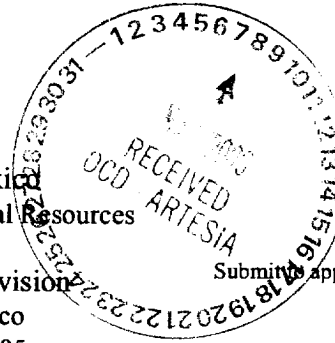

Form C-101  
Revised March 17, 1999  
Submit to appropriate District Office  
State Lease - 6 Copies  
Fee Lease - 5 Copies

☐ AMENDED REPORT

**APPLICATION FOR PERMIT TO DRILL, RE-ENTER, DEEPEN, PLUGBACK, OR ADD A ZONE**

<sup>1</sup> Operator Name and Address Reliance Energy, Inc. P.O. Box 10946, Midland, Texas 79702		<sup>2</sup> OGRID Number 149441
		<sup>3</sup> API Number 30-005-63246
<sup>4</sup> Property Code 25855	<sup>5</sup> Property Name Willow Spring "32" State	<sup>6</sup> Well No. 2

<sup>7</sup> Surface Location									
UL or lot no.	Section	Township	Range	Lot Idn	Feet from the	North/South line	Feet from the	East/West line	County
J	32	4S	25E		1980	South	1980	East	Chaves

<sup>8</sup> Proposed Bottom Hole Location If Different From Surface									
UL or lot no.	Section	Township	Range	Lot Idn	Feet from the	North/South line	Feet from the	East/West line	County
<sup>9</sup> Proposed Pool 1 Undes. Pecos Slope; Abo					<sup>10</sup> Proposed Pool 2				

<sup>11</sup> Work Type Code N	<sup>12</sup> Well Type Code G	<sup>13</sup> Cable Rotary R	<sup>14</sup> Lease Type Code S	<sup>15</sup> Ground Level Elevation 3855
<sup>16</sup> Muffin N	<sup>17</sup> Proposed Depth 4250'	<sup>18</sup> Formation Abo	<sup>19</sup> Contractor unknown	<sup>20</sup> Spud Date May 15, 2000

Minimum WOC time 8 hrs. <sup>21</sup> Proposed Casing and Cement Program

Hole Size	Casing Size	Casing weight/foot	Setting Depth	Sacks of Cement	Estimated TOC
17-1/2"	13-3/8"	48#	800'	450 sx	surface
11"	8-5/8"	24#	1800'	450 sx	1200'
7-7/8"	5-1/2"	15.5#	4250'	500 sx	3000'

<sup>22</sup> Describe the proposed program. If this application is to DEEPEN or PLUG BACK, give the data on the present productive zone and proposed new productive zone.

Describe the blowout prevention program, if any. Use additional sheets if necessary.

Approximately 600' surface casing will be set and cemented to shut off gravel and cavings. 11" hole will be air drilled with intermediate casing at approximately 1800'. 7-7/8" hole will be drilled to TD w/air; production casing will be set and cemented at TD. The Abo will be stimulated as needed.

BOP Program: 3000# BOP installed on 8-5/8" and tested daily; rotating head while air drilling.

<sup>23</sup> I hereby certify that the information given above is true and complete to the best of my knowledge and belief.		OIL CONSERVATION DIVISION	
Signature: Clyde C. Wheeler		Approved by: Jim W. Burns B6A	
Printed name: CLYDE C. WHEELER		Title: SUPERVISOR DISTRICT II	
Title: Petroleum Engineer		Approval Date: 5-9-00 Expiration Date: 5-9-01	
Date: May 5, 2000	Phone: (915) 683-4816	Conditions of Approval: Notify OCD at SPUD & TIME to witness cementing the 12 3/4"	
		Attached <input type="checkbox"/>	

DISTRICT I  
P. O. Box 1980  
Hobbs, NM 88241-1980

DISTRICT II  
P. O. Drawer DD  
Artesia, NM 88211-0719

DISTRICT III  
1000 Rio Brazos Rd.  
Aztec, NM 87410

DISTRICT IV  
P. O. Box 2088  
Santa Fe, NM 87507-2088

State of New Mexico  
Energy, Minerals, and Natural Resources Department

Form C-102  
Revised 02-10-94

Instructions on back

OIL CONSERVATION DIVISION

P. O. Box 2088  
Santa Fe, New Mexico 87504-2088

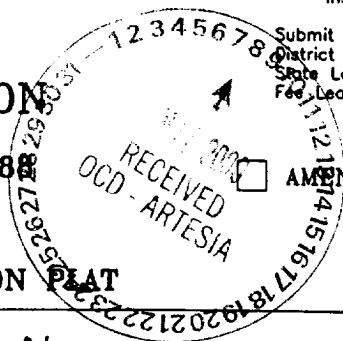

Submit to the Appropriate  
District Office  
State Lease - 4 copies  
Fee Lease - 3 copies

AMENDED REPORT

WELL LOCATION AND ACREAGE DEDICATION PLAT

1 API Number		2 Pool Code		3 Pool Name Pecos Slope Abo					
4 Property Code		5 Property Name WILLOW SPRING '32' STATE						6 Well Number 2	
7 OGRID No. 14944-1		8 Operator Name RELIANCE ENERGY INCORPORATED						9 Elevation 3855'	
10 SURFACE LOCATION									
UL or lot no. J	Section 32	Township 4 SOUTH	Range 25 EAST, N.M.P.M.	Lot Ida	Feet from the 1980'	North/South line SOUTH	Feet from the 1980'	East/West line EAST	County CHAVES
11 BOTTOM HOLE LOCATION IF DIFFERENT FROM SURFACE									
UL or lot no.	Section	Township	Range	Lot Ida	Feet from the	North/South line	Feet from the	East/West line	County
12 Dedicated Acres 160.0		13 Joint or Infill N		14 Consolidation Code		15 Order No.			
NO ALLOWABLE WELL BE ASSIGNED TO THIS COMPLETION UNTIL ALL INTERESTS HAVE BEEN CONSOLIDATED OR A NON-STANDARD UNIT HAS BEEN APPROVED BY THE DIVISION									

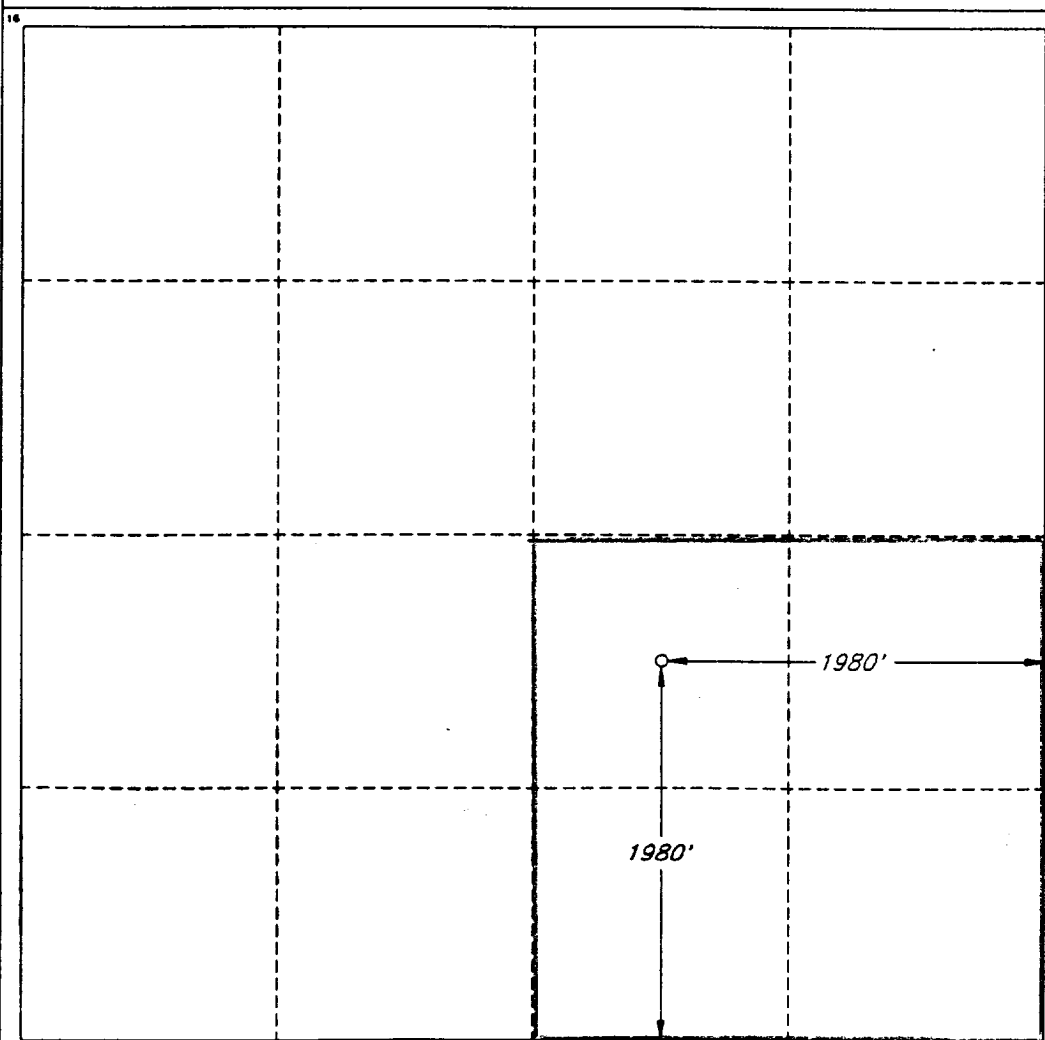

<b>OPERATOR CERTIFICATION</b> I hereby certify that the information contained herein is true and complete to the best of my knowledge and belief.	
Signature Clyde C. Wheeler	
Printed Name CLYDE C. WHEELER	
Title Petroleum Engineer	
Date May 5, 2000	
<b>SURVEYOR CERTIFICATION</b> I hereby certify that the well location shown on this plat was plotted from field notes of actual surveys made by me or under my supervision, and that the same is true and correct to the best of my belief.	
Date of Survey MAY 3, 2000	
Signature and Seal of Professional Surveyor V. L. BEZNER	
Certificate No. V. L. BEZNER R.P.S. #7920	
JOB #68941 / 200 NE / V.H.B.	

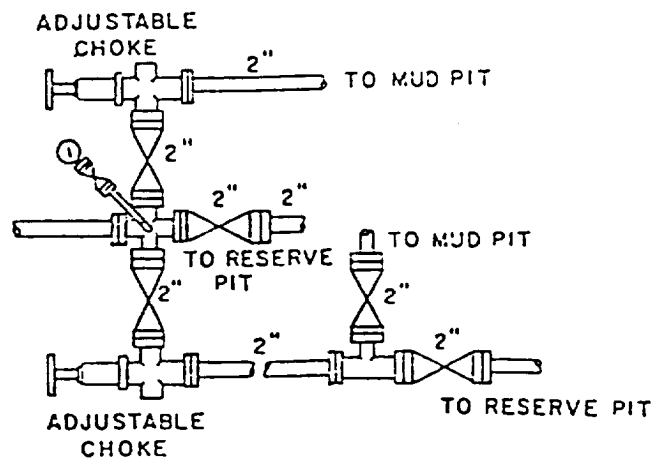
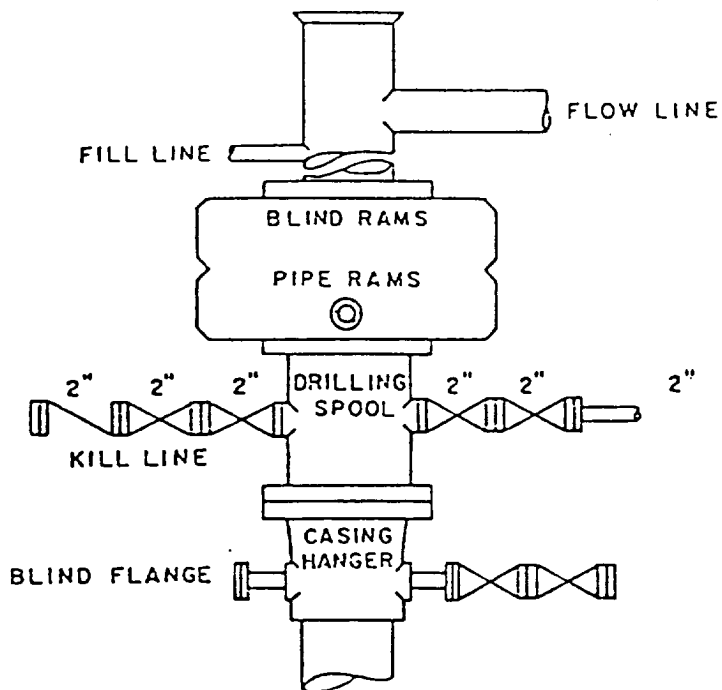

### BOP DIAGRAM

3000# WP Double-Ram  
Operated Daily

Reliance Energy, Inc.  
Willow Spring 32 State #2  
Chaves County, NM