

N.M. Oil Cons. DIV-C 2
1301 W. Grand Avenue
Artesia, NM 88210

UNITED STATES
DEPARTMENT OF THE INTERIOR
BUREAU OF LAND MANAGEMENT

FORM APPROVED
OMB No. 1004-0136
Expires November 30, 2000

APPLICATION FOR PERMIT TO DRILL OR REENTER

1a. Type of Work: <input checked="" type="checkbox"/> DRILL <input type="checkbox"/> REENTER		5. Lease Serial No. NMNM16324
1b. Type of Well: <input type="checkbox"/> Oil Well <input checked="" type="checkbox"/> Gas Well <input type="checkbox"/> Other <input checked="" type="checkbox"/> Single Zone <input type="checkbox"/> Multiple Zone		6. If Indian, Allottee or Tribe Name
2. Name of Operator YATES PETROLEUM CORPORATION Contact: ROBERT ASHER E-Mail: basher@ypcnm.com		7. If Unit or CA Agreement, Name and No.
3a. Address 105 S. 4TH ARTESIA, NM 88210	3b. Phone No. (include area code) Ph: 505.748.4364 Fx: 505.748.4572	8. Lease Name and Well No. CHARLOTTE FED. 7
4. Location of Well (Report location clearly and in accordance with any State requirements.)* At surface SENE 1500FNL 660FEL At proposed prod. zone SENE 1500FNL 660FEL		9. API Well No. 30-005-63328-00-X1
14. Distance in miles and direction from nearest town or post office* APPROX. 25 MILES NE OF ROSWELL, NM		10. Field and Pool, or Exploratory WILDCAT PRECAMBRIAN
15. Distance from proposed location to nearest property or lease line, ft. (Also to nearest drig. unit line, if any)	16. No. of Acres in Lease	11. Sec., T., R., M., or Blk. and Survey or Area Sec 30 T7S R26E Mer NMP
18. Distance from proposed location to nearest well, drilling, completed, applied for, on this lease, ft.	19. Proposed Depth 4990 MD	12. County or Parish CHAVES
21. Elevations (Show whether DF, KB, RT, GL, etc.) 3572 GL	22. Approximate date work will start	13. State NM
		17. Spacing Unit dedicated to this well 320.00
		20. BLM/BIA Bond No. on file
		23. Estimated duration 30 DAYS

24. Attachments

The following, completed in accordance with the requirements of Onshore Oil and Gas Order No. 1, shall be attached to this form:

- | | |
|---|--|
| 1. Well plat certified by a registered surveyor. | 4. Bond to cover the operations unless covered by an existing bond on file (see Item 20 above). |
| 2. A Drilling Plan. | 5. Operator certification |
| 3. A Surface Use Plan (if the location is on National Forest System Lands, the SUPO shall be filed with the appropriate Forest Service Office). | 6. Such other site specific information and/or plans as may be required by the authorized officer. |

25. Signature (Electronic Submission)	Name (Printed/Typed) PATRICIA PEREZ Ph: 505.748.4376	Date 12/11/2002
Title REGULATORY AGENT		
Approved by (Signature) (Electronic Submission)	Name (Printed/Typed) LARRY D BRAY	Date 02/10/2003
Title ASST FIELD MANAGER		

Application approval does not warrant or certify the applicant holds legal or equitable title to those rights in the subject lease which would entitle the applicant to conduct operations thereon.
Conditions of approval, if any, are attached.

Title 18 U.S.C. Section 1001 and Title 43 U.S.C. Section 1212, make it a crime for any person knowingly and willfully to make to any department or agency of the United States any false, fictitious or fraudulent statements or representations as to any matter within its jurisdiction.

Additional Operator Remarks (see next page)

**Electronic Submission #16840 verified by the BLM Well Information System
For YATES PETROLEUM CORPORATION, sent to the Roswell
Committed to AFMSS for processing by Armando Lopez on 12/12/2002 (03AL0090AE)**

**** REVISED ** REVISED ** REVISED ** REVISED ** REVISED ** REVISED ** REVISED ** REVISED ****

1 - 1000 1000 10 MM
1000 1000 1000
1000 1000 1000 A

Additional Operator Remarks:

Charlotte Federal Com. #7 has a current APD expiration date of January 16, 2003, which was extended by means of a Sundry Notice submitted January 7, 2002.

Thank you.

District I
1625 N. French Dr., Hobbs, NM 88240

District II
811 South First, Artesia, NM 88210

District III
1000 Rio Brazos Rd., Aztec, NM 87410

District IV
1220 S. St. Francis Dr., Santa Fe, NM 87505

State of New Mexico
Energy, Minerals & Natural Resources Department

OIL CONSERVATION DIVISION
1220 South St. Francis Dr.
Santa Fe, NM 87505

Form C-102
Revised August 15, 2000

Submit to Appropriate District Office
State Lease - 4 Copies
Fee Lease - 3 Copies

☐ AMENDED REPORT

WELL LOCATION AND ACREAGE DEDICATION PLAT

¹ API Number 30-	² Pool Code	³ Pool Name Wildcat Precambrian
⁴ Property Code	⁵ Property Name CHARLOTTE FEDERAL	⁶ Well Number 7
⁷ OGRID No. 025575	⁸ Operator Name Yates Petroleum Corporation	⁹ Elevation 3572'

¹⁰ Surface Location

UL or lot no. H	Section 30	Township 7S	Range 26E	Lot Idn	Feet from the 1500	North/South line North	Feet from the 660	East/West line East	County Chaves
---------------------------	----------------------	-----------------------	---------------------	---------	------------------------------	----------------------------------	-----------------------------	-------------------------------	-------------------------

¹¹ Bottom Hole Location If Different From Surface

UL or lot no.	Section	Township	Range	Lot Idn	Feet from the	North/South line	Feet from the	East/West line	County
¹² Dedicated Acres 320	¹³ Joint or Infill	¹⁴ Consolidation Code	¹⁵ Order No.						

NO ALLOWABLE WILL BE ASSIGNED TO THIS COMPLETION UNTIL ALL INTERESTS HAVE BEEN CONSOLIDATED OR A NON-STANDARD UNIT HAS BEEN APPROVED BY THE DIVISION

¹⁶										¹⁷ OPERATOR CERTIFICATION I hereby certify that the information contained herein is true and complete to the best of my knowledge and belief. <i>Pat Perez</i> Signature Pat Perez Printed Name Regulatory Agent Title 12/11/2002 Date
										¹⁸ SURVEYOR CERTIFICATION I hereby certify that the well location shown on this plat was plotted from field notes of actual surveys made by me or under my supervision, and that the same is true and correct to the best of my belief. REFER TO ORIGINAL PLAT Date of Survey Signature and Seal of Professional Surveyor: Certificate Number

DISTRICT I
1805 E. French Dr., Hobbs, NM 88240

DISTRICT II
811 South First, Artesia, NM 88210

DISTRICT III
1800 E. Brazos Rd., Artesia, NM 87410

DISTRICT IV
3040 South Pacheco, Santa Fe, NM 87506

State of New Mexico
Energy, Minerals and Natural Resources Department.

Form C-102
Revised March 17, 1999
Instruction on back
Submit to Appropriate District Office
State Lease - 4 Copies
Fee Lease - 3 Copies

OIL CONSERVATION DIVISION

P.O. Box 2088
Santa Fe, New Mexico 87504-2088

☐ AMENDED REPORT

WELL LOCATION AND ACREAGE DEDICATION PLAT

API Number	Pool Code	Pool Name
		Wildcat Precambrian
Property Code	Property Name	Well Number
	CHARLOTTE FEDERAL	7
OGED No.	Operator Name	Elevation
025575	YATES PETROLEUM CORPORATION	3572

Surface Location

UL or Lot No.	Section	Township	Range	Lot Idn	Feet from the	North/South Line	Feet from the	East/West line	County
H	30	7S	26E		1500	NORTH	660	EAST	CHAVES

Bottom Hole Location If Different From Surface

UL or Lot No.	Section	Township	Range	Lot Idn	Feet from the	North/South Line	Feet from the	East/West line	County
Dedicated Acres	Joint or Infill	Consolidation Code	Order No.						

NO ALLOWABLE WILL BE ASSIGNED TO THIS COMPLETION UNTIL ALL INTERESTS HAVE BEEN CONSOLIDATED
OR A NON-STANDARD UNIT HAS BEEN APPROVED BY THE DIVISION

	OPERATOR CERTIFICATION I hereby certify the the information contained herein is true and complete to the best of my knowledge and belief. Signature Pat Perez Printed Name Regulatory Agent Title 11/9/2000 Date	
	SURVEYOR CERTIFICATION I hereby certify that the well location shown on this plat was plotted from field notes of actual surveys made by me or under my supervision, and that the same is true and correct to the best of my belief. 8/25/2000 Date Surveyed Signature & Seal of Professional Surveyor Certification No. L. Jones RLS 3640 CHARLOTTE GENERAL SURVEYING COMPANY DISK 32	

YATES PETROLEUM CORPORATION
Charlotte Federal Com. #7
1500' FNL AND 660' FEL
Section 30, T7S-R26E
Chaves County, New Mexico

- 1 The estimated tops of geologic markers are as follows:

San Andres	445'
Glorieta	1445'
Yeso	1545'
Tubb	2970'
Abo	3670'
Wolfcamp	4320'
Cisco	4670'
Basement	4890'
TD	4990'

2. The estimated depths at which anticipated water, oil or gas formations are expected to be encountered:

Water: 150'-200'
Oil or Gas: All potential zones

3. Pressure Control Equipment: BOPE will be installed on the 8 5/8" casing and rated for 2000# BOP systems will be consistent with API RP 53. Pressure tests will be conducted before drilling out from under all casing strings which are set and cemented in place. Blowout preventor controls will be installed prior to drilling the surface plug and will remain in use until the well is completed or abandoned. Preventors will be inspected and operated at least daily to ensure good mechanical working order, and this inspection recorded on the daily drilling report. See Exhibit B.

Auxiliary Equipment:

- A. Auxiliary Equipment: Kelly cock, pit level indicators, flow sensor equipment, and a sub with full opening valve to fit the drill pipe and collars will be available on the rig floor in the open position at all times for use when kelly is not in use.

4. THE PROPOSED CASING AND CEMENTING PROGRAM:

- A. Casing Program: (All New)

<u>Hole Size</u>	<u>Casing Size</u>	<u>Wt./Ft</u>	<u>Grade</u>	<u>Coupling</u>	<u>Interval</u>	<u>Length</u>
12 1/4"	8 5/8"	24#	J55	ST&C	0-950'	950'
7 7/8"	5 1/2"	15.5#	J55	ST&C	0-4990'	4990'

- 1 Minimum Casing Design Factors: Collapse 1.125, Burst 1.0, Tensile Strength 1.80

B. CEMENTING PROGRAM:

Surface casing: Cement with 325 sx. Lite "C" (Yld 2.0 Wt. 12.5). Tail in with 200 sx "C" + 2% CaCl₂ (Yld 1.33 Wt. 15.6).

Production Casing: Cement with 300 sx ultralite "C" (Yld 1.34 Wt 13). TOC 3200'

5. Mud Program and Auxiliary Equipment:

<u>Interval</u>	<u>Type</u>	<u>Weight</u>	<u>Viscosity</u>	<u>Fluid Loss</u>
0-950'	FW Gel/Paper/LCM	8.6-9.6	32-36	N/C
950'-3650'	Brine	10-10.2	28	N/C
3650'-4990'	Starch/Salt Gel	9.3-10.2	32-40	<10cc

Sufficient mud material(s) to maintain mud properties, control lost circulation and contain a blow out will be available at the well site during drilling operations. Mud will be checked hourly by rig personnel.

6. EVALUATION PROGRAM:

Samples: 20' samples out from surface casing.
Logging: Platform Express, CNL/LDT W/NGT to surf. with GR/CNL up to surface, DLL/MS
Coring: Possible Sidewall Cores
DST's: Possible

7. Abnormal Conditions, Bottom hole pressure and potential hazards:

Anticipated BHP:

From: 0	To: 950'	Anticipated Max. BHP:	400 PSI
From: 950'	To: 4995'	Anticipated Max. BHP:	2200 PSI

Abnormal Pressures Anticipated: None

Lost Circulation zones anticipated: None

H₂S Zones Anticipated: None

Maximum Bottom Hole Temperature: 145 F

8. ANTICIPATED STARTING DATE:

Plans are to drill this well as soon as possible after receiving approval. It should take approximately 30 days to drill the well with completion taking another 15 days.

MULTI-POINT SURFACE USE AND OPERATIONS PLAN

Yates Petroleum Corporation

Charlotte Federal Com. #7

1500' FNL and 660' FEL

Section 30, T7S-R26E

Chaves County, New Mexico

This plan is submitted with Form 3160-3, Application for Permit to Drill, covering the above described well. The purpose of this plan is to describe the location of the proposed well, the proposed construction activities and operations plan, the magnitude of the surface disturbance involved and the procedures to be followed in rehabilitating the surface after completion of the operations, so that a complete appraisal can be made of the environmental effect associated with the operations.

1 EXISTING ROADS:

Exhibit A is a portion of the BLM map showing the well and roads in the vicinity of the proposed location. The proposed wellsite is located approximately 25 miles northeast of Roswell New Mexico and the access route to the location is indicated in red and green on Exhibit A.

DIRECTIONS:

Proceed north of Roswell on Highway 285 to One Horse Road. Turn right (East) and go approximately 2.5 miles to Cottonwood Road. Turn left (North) on Cottonwood and go approximately 8 miles to Chaves Road: turn right (east) on Chaves and go 3.1 miles to San Juan Road. Turn Right (South) and drive .2 of a mile to a white gate on the left (east) side. Go through the gate and drive .2 of a mile where the road is staked on the left (north) going towards the southwest corner of the well pad.

2. PLANNED ACCESS ROAD

The proposed new access road will be approximately 14' in width and 350' in length from the point of origin to the southwest corner of the drilling pad. The road will lie in a south to north direction.

3. LOCATION OF EXISTING WELL

- A. There is drilling activity within a one-mile radius of the wellsite.
- B. Exhibit D shows existing wells within a one-mile radius of the proposed wellsite.

4. LOCATION OF EXISTING AND/OR PROPOSED FACILITIES

- A. There are production facilities on this lease at the present time.
- B. In the event that the well is productive, the necessary production facilities will be installed on the drilling pad. If the well is productive oil, a gas or diesel self-contained unit will be used to provide the necessary power. No power will be required if the well is productive of gas.

5. LOCATION AND TYPE OF WATER SUPPLY:

- A. It is planned to drill the proposed well with a fresh water system. The water will be obtained from commercial sources, possibly in Roswell, and will be hauled to the location by truck over the existing and proposed roads shown in Exhibit A.

6. SOURCE OF CONSTRUCTION MATERIALS:

The dirt contractor will be responsible for finding a source of material for construction of road and pad and will obtain any permits which may be required.

7. METHODS OF HANDLING WASTE DISPOSAL:

- A. Drill cuttings will be disposed of in the reserve pits.
- B. Drilling fluids will be allowed to evaporate in the reserve pits until the pits are dry.
- C. Water produced during operations will be collected in tanks until hauled to an approved disposal system, or separate disposal application will be submitted.
- D. Oil produced during operations will be stored in tanks until sold.
- E. Current laws and regulations pertaining to the disposal of human waste will be complied with.
- F. All trash, junk, and other waste materials will be contained in trash cages or bins to prevent scattering and will be removed and deposited in an approved sanitary land fill. Burial on site is not approved.

8. ANCILLARY FACILITIES: NONE

9. WELLSITE LAYOUT:

- A. Exhibit C shows the relative location and dimensions of the well pad, the reserve pits, the location of the drilling equipment, rig orientation and access road approach.
- B. The reserve pits will be plastic lined.
- C. A 400' x 400' area has been staked and flagged.
- D. The pits will be put to the northeast.

10. PLANS FOR RESTORATION

- A. After finishing drilling and/or completion operations, all equipment and other material not needed for further operations will be removed. The location will be cleaned of all trash and junk to leave the wellsite in as aesthetically pleasing a condition as possible.
- B. Unguarded pits, if any, containing fluids will be fenced until they have dried and been leveled.
- C. If the proposed well is non-productive, all rehabilitation and/or vegetation requirements of the Bureau of Land Management will be complied with and will be accomplished as expeditiously as possible. All pits will be filled level after they have evaporated and dried.

SURFACE OWNERSHIP: Bureau of Management
Roswell, New Mexico

12. OTHER INFORMATION:

- A. Topography: Refer to the existing archaeological report for a description of the topography, flora, fauna, soil characteristics, dwellings, historical and cultural sites.
- B. The primary surface use is for grazing.

13. OPERATOR'S REPRESENTATIVE:

- | | |
|--|---|
| A. Through A.P.D. Approval:
Patricia Perez, Regulatory Agent
Yates Petroleum Corporation
105 South Fourth Street
Artesia, New Mexico 88210
Phone (505) 748-1471 | B. Through Drilling, Completions & Prod.
Pinson McWhorter, Operations Manager
Yates Petroleum Corporation
105 South Fourth Street
Artesia, New Mexico 88210
Phone (505) 748-1471 |
|--|---|

14. CERTIFICATION:

I hereby certify that I, or persons under my direct supervision, have inspected the proposed drill site and access route, that I am familiar with the conditions which presently exist; that the statements made in this plan are to the best of my knowledge, true and correct; and, that the work associated with the operations proposed herein will be performed by Yates Petroleum Corporation and its contractors and subcontractors in conformity with this plan and the terms and conditions under which it is approved. This statement is subject to the provisions of 18 U.S.C. 1001 for the filing of a false statement.

12/11/02

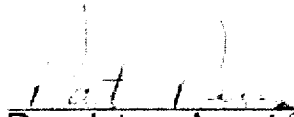

Regulatory Agent

SECTION 30, TOWNSHIP 7 SOUTH, RANGE 26 EAST, NMPM, CHAVES COUNTY, NEW MEXICO.

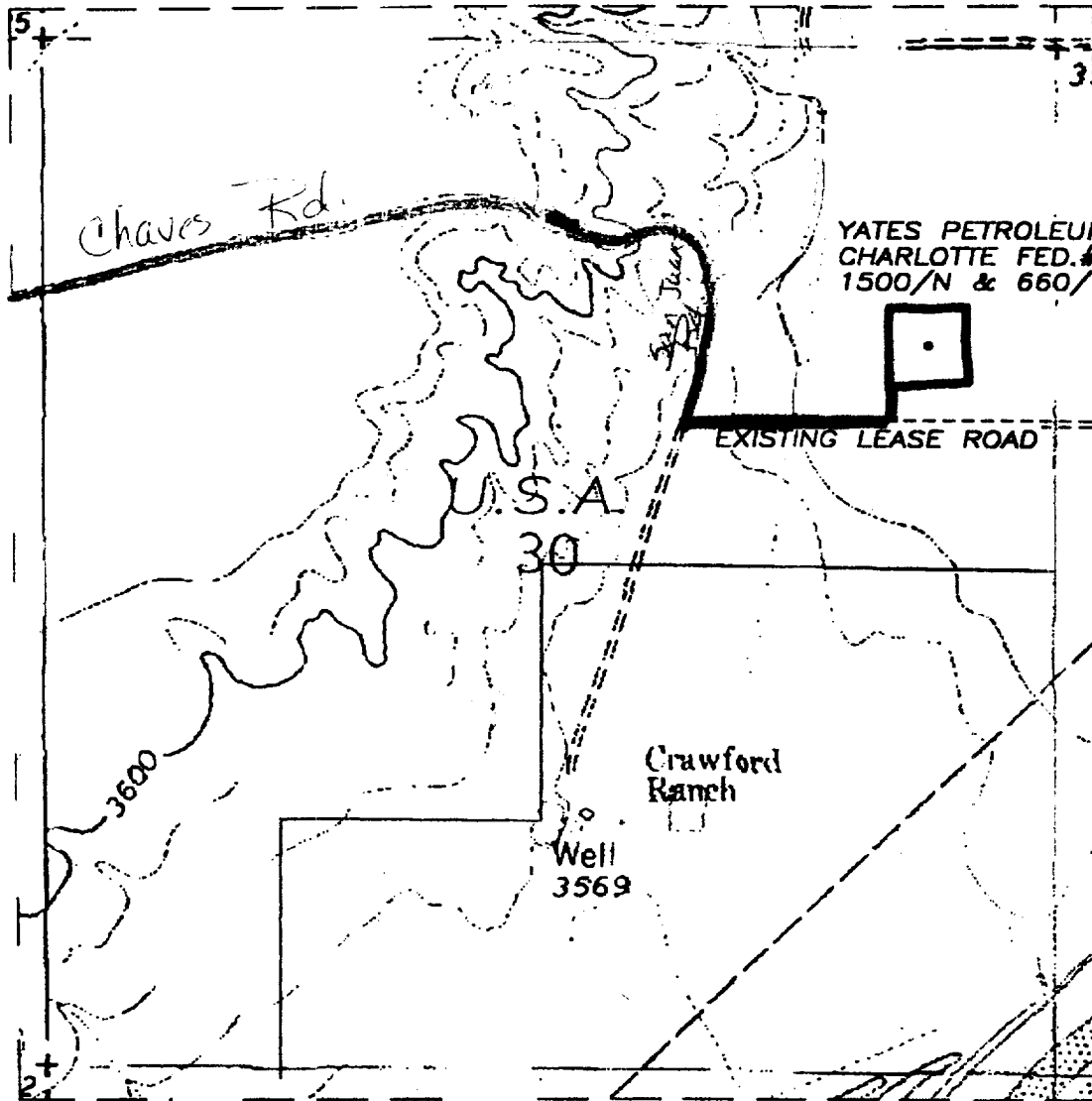

YATES PETROLEUM CORPORATION
CHARLOTTE FEDERAL COM. #7
1500' FNL and 660' FEL
Sec. 30, T7S-R26E
Chaves County, New Mexico

EXHIBIT A-1

1000' 0 1000' 2000'
Scale 1" = 1000'

THE PREPARATION OF THIS PLAT AND THE PERFORMANCE OF THE SURVEY UPON WHICH IT IS BASED WERE DONE UNDER MY DIRECTION AND THE PLAT ACCURATELY DEPICTS THE RESULTS OF SAID SURVEY AND MEET THE REQUIREMENTS OF THE STANDARDS FOR LAND SURVEYING IN NEW MEXICO AS ADOPTED BY THE NEW MEXICO STATE BOARD OF REGISTRATION FOR PROFESSIONAL ENGINEERS AND LAND SURVEYORS.

3640
HERSCHEL JAMES R.L.S. 142546

GENERAL SURVEYING COMPANY P.O. BOX 1928
LOVINGTON, NEW MEXICO 88260

YATES PETROLEUM CORPORATION

LEASE ROAD TO ACCESS THE YATES CHARLOTTE FED. #7 WELL LOCATED IN SECTION 30, TOWNSHIP 7 SOUTH, RANGE 26 EAST, NMPM, CHAVES COUNTY, NEW MEXICO.

Survey Date: 8/26/2006

Drawn By: Ed Blowing

Date: 8/26/06

Sheet of Sheets

W.D. Number

Scale 1" = 1000' CHARLOTTE 7

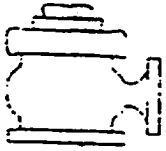

Yates Petroleum Corporation

BOP-2

Typical 2,000 psi Pressure System Schematic

Double Ram Preventer Stack

YATES PETROLEUM CORPORATION
CHARLOTTE FEDERAL COM. #7
1500' FNL and 660' FEL
Sec. 30, T7S-R26E
Chaves County, New Mexico

EXHIBIT B

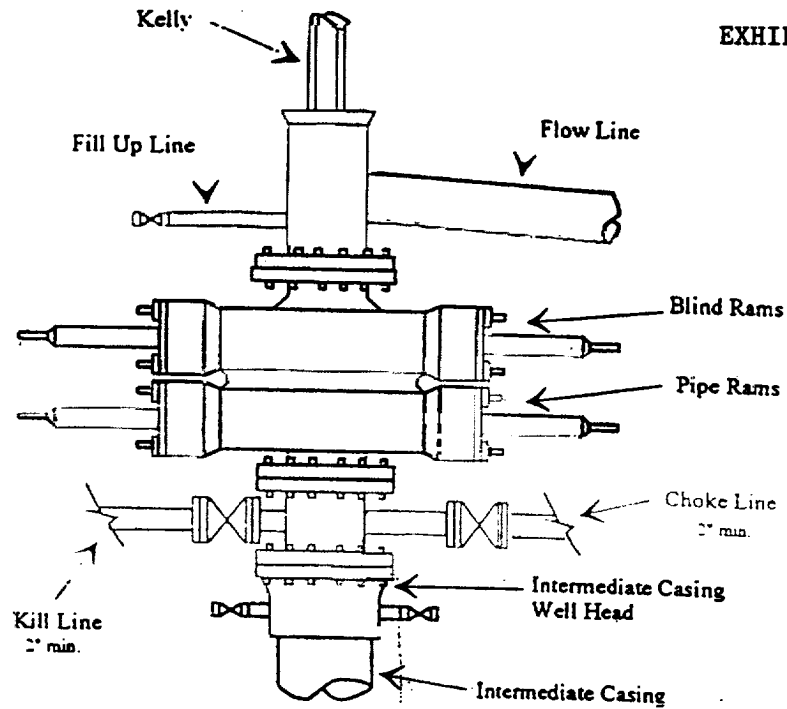

Typical 2,000 psi choke manifold assembly with at least these minimum features

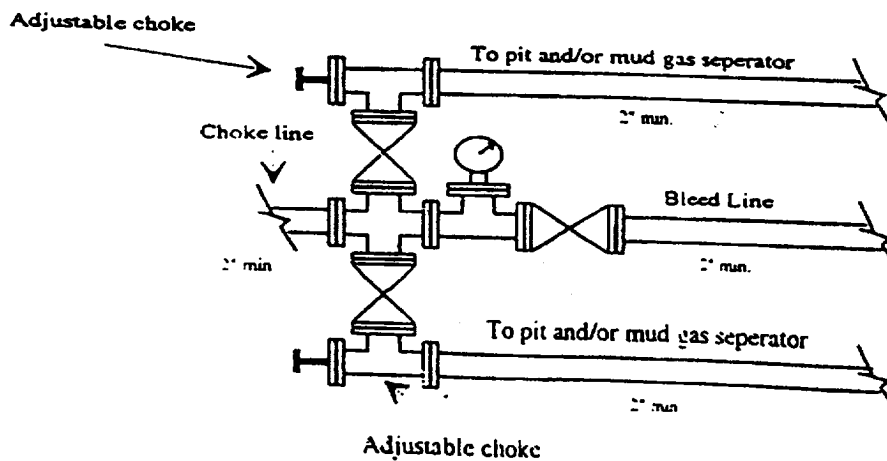

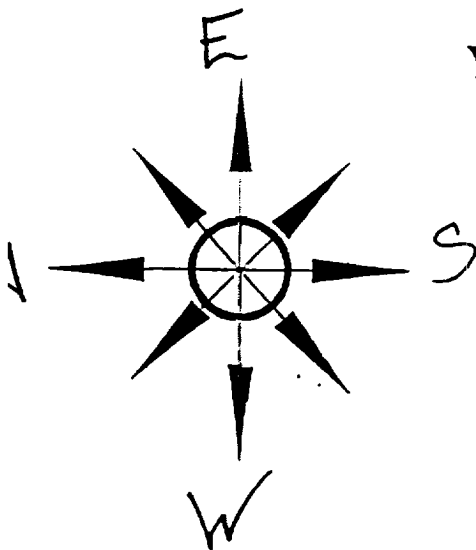

Yates Petroleum Corporation

Location Layout for Permian Basin

Up to 12,000'

PB - L1

YATES PETROLEUM CORPORATION
CHARLOTTE FEDERAL COM. #7
1500' FNL and 660' FEL
Sec. 30, T7S-R26E
Chaves County, New Mexico

EXHIBIT C

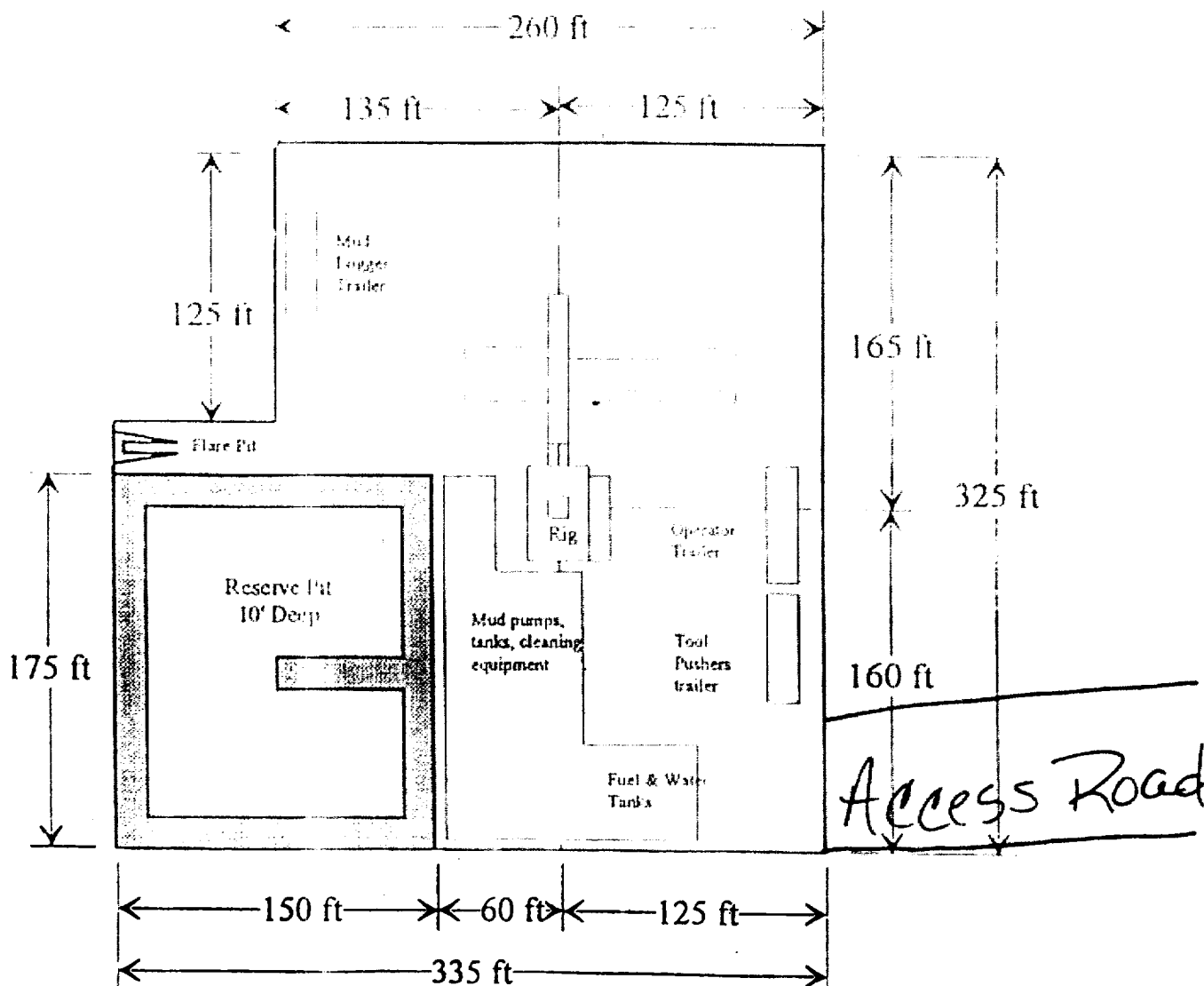

Distance from Well
Head to Reserve Pit
will vary between rigs

The above dimension

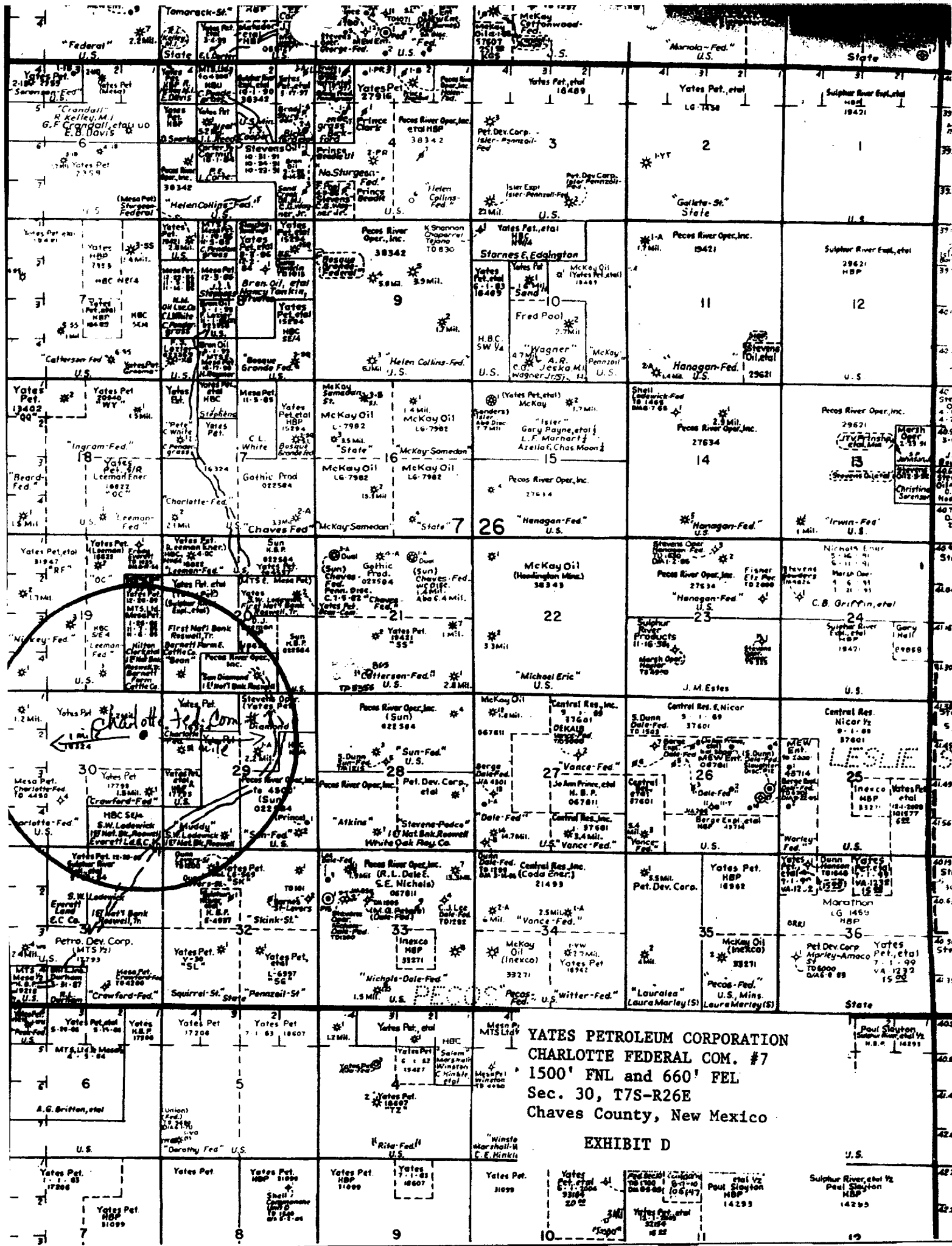

YATES PETROLEUM CORPORATION
CHARLOTTE FEDERAL COM. #7
1500' FNL and 660' FEL
Sec. 30, T7S-R26E
Chaves County, New Mexico

EXHIBIT D

U.S.

Paul Slayton
H.B.P. 14293

Sulphur River, et al
Paul Slayton
H.B.P. 14293