

DISTRICT I
1625 N. French Dr., Hobbs, NM 88240

DISTRICT II
811 South First, Artesia, NM 88210

DISTRICT III
1000 Rio Brazos Rd., Aztec, NM 87410

DISTRICT IV
2040 South Pacheco, Santa Fe, NM 87501

State of New Mexico
Energy, Minerals and Natural Resources Department

OIL CONSERVATION DIVISION

PO BOX 2088
Santa Fe, NM 87504-2088

Form C-101

Revised March 17, 1999

Instructions on back

Submit to appropriate District Office

State Lease - 6 Copies

Fee Lease - 5 Copies

☐ AMENDED REPORT

APPLICATION FOR PERMIT TO DRILL, RE-ENTER, DEEPEN, PLUGBACK, OR ADD A ZONE

¹ Operator Name and Address Yates Petroleum Corporation 105 South Fourth Street Artesia, New Mexico 88210		² OGRID Number 025575
		³ API Number 30- 005- 63363
⁴ Property Code 27835	⁵ Property Name Quiniela "AXQ" St.	⁶ Well No. 1

⁷ Surface Location

UL or lot no. E	Section 5	Township 10S	Range 26E	Lot Idn	Feet from the 1980'	North/South Line North	Feet from the 660'	East/West Line West	County Chaves
--------------------	--------------	-----------------	--------------	---------	------------------------	---------------------------	-----------------------	------------------------	------------------

⁸ Proposed Bottom Hole Location If Different From Surface

UL or lot no.	Section	Township	Range	Lot Idn	Feet from the	North/South Line	Feet from the	East/West Line	County
⁹ Proposed Pool 1 Wildcat Precambrian					¹⁰ Proposed Pool 2				

¹¹ Work Type Code N	¹² Well Type Code G	¹³ Cable/Rotary R	¹⁴ Lease Type Code S	¹⁵ Ground Level Elevation 3769'
¹⁶ Multiple N	¹⁷ Proposed Depth 6125'	¹⁸ Formation Basement	¹⁹ Contractor Not Determined	²⁰ Spud Date ASAP

²¹ Proposed Casing and Cement Program

Hole Size	Casing Size	Casing weight/feet	Setting Depth	Sacks of Cement	Estimated TOC
12 1/4"	8 5/8"	24#	1100'	750 sx	Surface
7 7/8"	5 1/2"	15.5#	6125'	500 sx	**

** Cement to cover all oil, gas and waterbearing zones.

²² Describe the proposed program. If this application is to DEEPEN or PLUG BACK give the data on the present productive zone and proposed new productive zone. Describe the blowout prevention program, if any. Use additional sheets if necessary.

Yates Petroleum Corporation proposes to drill and test the Basement and intermediate formations. Approximately 1100' of surface casing will be set and cement circulated to shut off gravel and cavings. If commercial, production casing will be run and cemented, will perforate and stimulate as needed for production.

MUD PROGRAM: 0-1100' FWGel/Paper/LCM; 1100-4210' Brine; 4210-6125' Starch/Salt Gel.

BOPE PROGRAM: A 2000# BOPE will be installed on the 8 5/8" casing and tested daily.

²³ I hereby certify that the information given above is true and complete to the best of my knowledge and belief. Signature: <i>Pat Perez</i>		OIL CONSERVATION DIVISION <i>BK</i>	
Printed name: Pat Perez		Approved by: ORIGINAL SIGNED BY TIM W. GUN DISTRICT II SUPERVISOR	
Title: Regulatory Agent		Title:	
Date: 03/27/01	Phone: (505) 748-1471	Approval Date: MAR 31 2001	Expiration Date: MAR 31 2002
		Conditions of Approval Attached <input type="checkbox"/>	

DISTRICT I
1636 N. French Dr., Hobbs, NM 88240

DISTRICT II
611 South First, Artesia, NM 88210

DISTRICT III
1000 Rio Brazos Rd., Artesia, NM 87410

DISTRICT IV
2040 South Pacheco, Santa Fe, NM 87506

State of New Mexico
Energy, Minerals and Natural Resources Department

Form C-102
Revised March 17, 1999
Instruction on back
Submit to Appropriate District Office
State Lease - 4 Copies
Fee Lease - 3 Copies

OIL CONSERVATION DIVISION
P.O. Box 2088
Santa Fe, New Mexico 87504-2088

☐ AMENDED REPORT

WELL LOCATION AND ACREAGE DEDICATION PLAT

API Number	Pool Code	Pool Name
		Wildcat Precambrian
Property Code	Property Name	Well Number
	QUINIELA "AXQ" STATE	1
OGRID No.	Operator Name	Elevation
025575	YATES PETROLEUM CORPORATION	3769

Surface Location

UL or lot No.	Section	Township	Range	Lot Idn	Feet from the	North/South line	Feet from the	East/West line	County
E	5	10S	26E		1980	NORTH	660	WEST	CHAVES

Bottom Hole Location If Different From Surface

UL or lot No.	Section	Township	Range	Lot Idn	Feet from the	North/South line	Feet from the	East/West line	County
Dedicated Acres	Joint or Infill	Consolidation Code	Order No.						
319.56									

NO ALLOWABLE WILL BE ASSIGNED TO THIS COMPLETION UNTIL ALL INTERESTS HAVE BEEN CONSOLIDATED
OR A NON-STANDARD UNIT HAS BEEN APPROVED BY THE DIVISION

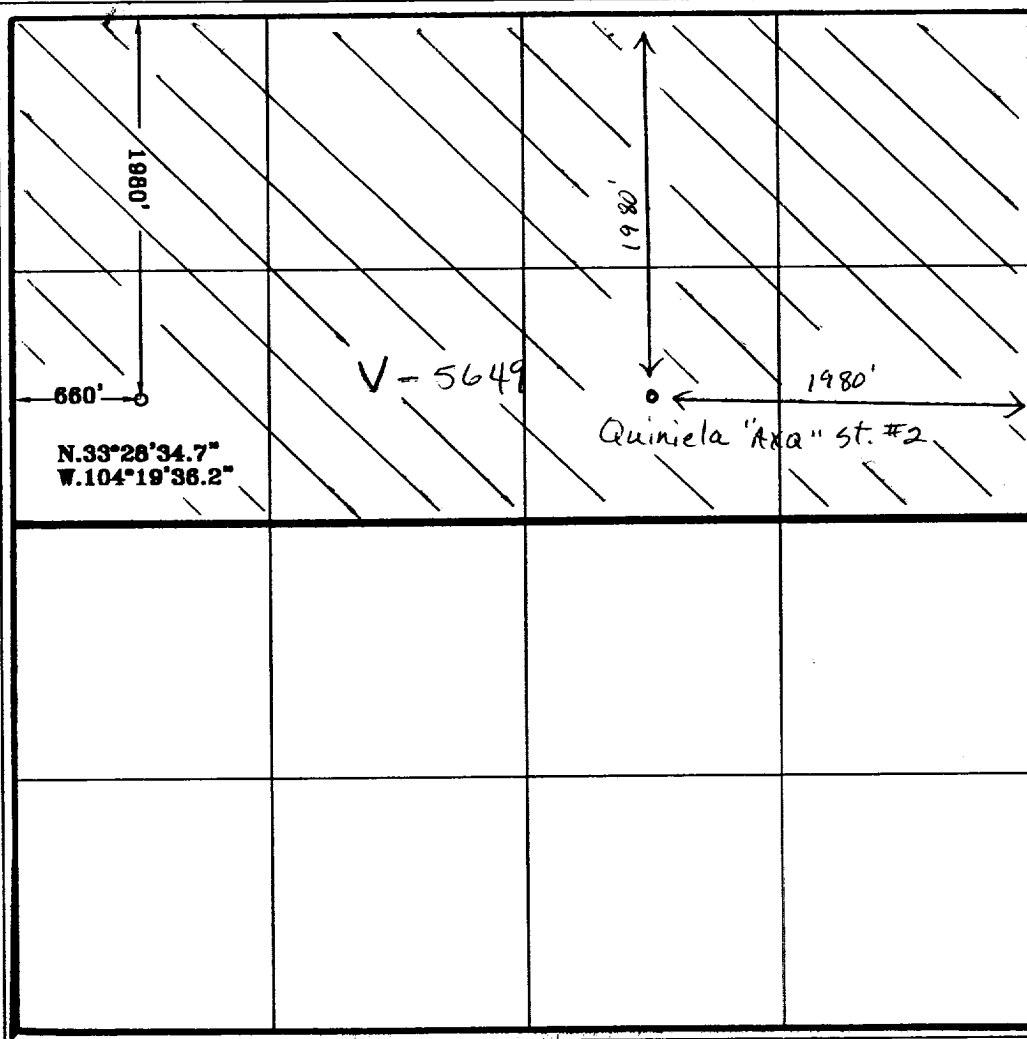

OPERATOR CERTIFICATION

I hereby certify the the information
contained herein is true and complete to the
best of my knowledge and belief.

Pat Perez
Signature
Pat Perez
Printed Name
Regulatory Agent
Title
3-27-01
Date

SURVEYOR CERTIFICATION

I hereby certify that the well location shown
on this plat was plotted from field notes of
actual surveys made by me or under my
supervision, and that the same is true and
correct to the best of my belief.

3/15/2001
Date Surveyed
Signature & Seal of
Professional Surveyor
HERSCHEL JONES
NEW MEXICO
3640
Certificate No. Herschel Jones RLS 3640
QUINIELA
PROFESSIONAL LAND SURVEYOR
GENERAL SURVEYING COMPANY

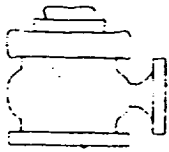

Yates Petroleum Corporation

BOP-2

Typical 2,000 psi Pressure System Schematic Double Ram Preventer Stack

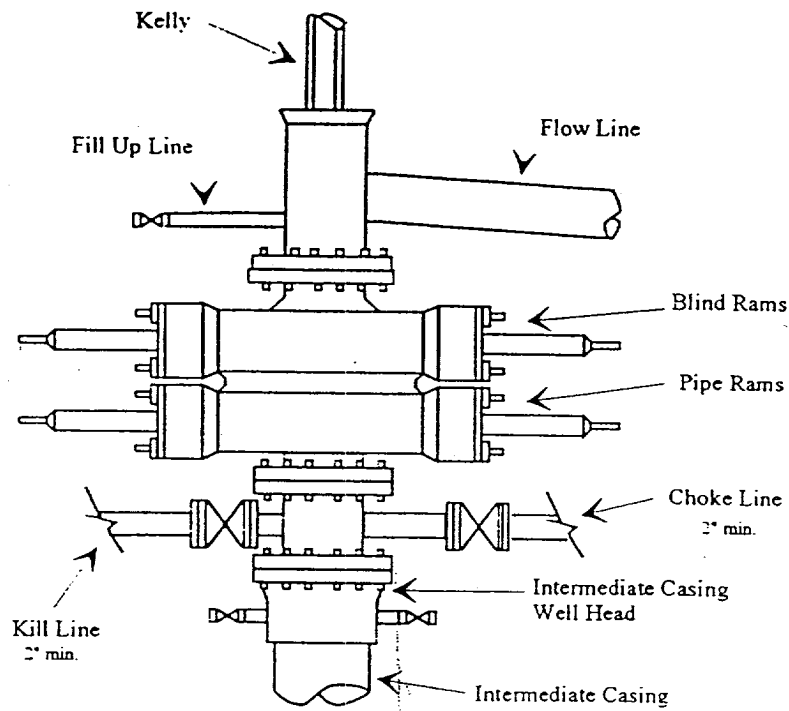

Typical 2,000 psi choke manifold assembly with at least these minimum features

