

Submit 3 Copies to Appropriate District

Office

District I

1625 N. French Dr., Hobbs, NM 88240

District II

811 South First, Artesia, NM 88210

District III

1000 Rio Brazos Rd., Aztec, NM 87410

District IV

2040 South Pacheco, Santa Fe, NM 87505

State of New Mexico

Energy, Minerals and Natural Resources

OIL CONSERVATION DIVISION

2040 South Pacheco St.

Santa Fe, NM 87505

Form C-103

Revised March 25, 1999

WELL API NO.

30-005-63363

5. Indicate Type of Lease

STATE ☒ FEE ☐

6. State Oil & Gas Lease No.

V-5649

7. Lease Name or Unit Agreement Name:

Quiniela AXQ State

SUNDRY NOTICES AND REPORTS ON WELLS

(DO NOT USE THIS FORM FOR PROPOSALS TO DRILL OR TO DEEPEN OR PLUG BACK TO A DIFFERENT RESERVOIR. USE "APPLICATION FOR PERMIT" (FORM C-101) FOR SUCH PROPOSALS.)

1. Type of Well:

Oil Well ☐ Gas ☒ Other

2. Name of Operator

Yates Petroleum Corporation

3. Address of Operator

105 South Fourth Street, Artesia, New Mexico 88210

8. Well No.

1

9. Pool name or Wildcat

Wildcat Precambrian

4. Well Location

Unit Letter: C : 660' feet from the North line and 1980' feet from the West line
Section 5 Township 10S Range 26E NMPM County Chaves

10. Elevation (Show whether DF, RKB, RT, GR, etc.)

3774'

11. Check Appropriate Box to Indicate Nature of Notice, Report, or Other Data

NOTICE OF INTENTION TO:

PERFORM REMEDIAL WORK ☐ PLUG AND ABANDON ☐

TEMPORARILY ABANDON ☐ CHANGE PLANS ☒

PULL OR ALTER CASING ☐ MULTIPLE COMPLETION ☐

OTHER: Move Location ☐

SUBSEQUENT REPORT OF:

REMEDIAL WORK ☐ ALTERING CASING ☐

COMMENCE DRILLING OPNS ☐ PLUG AND ABANDONMENT ☐

CASING TEST AND CEMENT JOB ☐

OTHER: ☐

12. Describe proposed or completed operations. (Clearly state all pertinent details, and give pertinent dates, including estimated date of starting any proposed work). SEE RULE 1103. For Multiple Completions: Attach wellbore diagram of proposed completion or recompletion.

Yates Petroleum Corporation wishes to change the location from 1980' FNL and 660' FWL, Unit Letter-E to

660' FNL and 1980' FWL, Unit Letter-C in Section 5, T10S-R26E.

Thank you.

I hereby certify that the information above is true and complete to the best of my knowledge and belief.

SIGNATURE Pat Perez TITLE Regulatory Agent DATE 01/20/03

Type or print name PahPerez Telephone No. (505) 748-1471

(This space for State use) ORIGINAL SIGNED BY TIM W. GUM

APPROVED BY [Signature] DISTRICT II SUPERVISOR TITLE DATE JAN 23 2003

Conditions of approval, if any:

DISTRICT I
1885 N. French Dr., Hobbs, NM 88240
DISTRICT II
311 South First, Artesia, NM 88210
DISTRICT III
1000 Rio Brazos Rd., Aztec, NM 87410
DISTRICT IV
2040 South Pacheco, Santa Fe, NM 87505

Energy, Minerals and Natural Resources Department

Revised March 17, 1999
Instruction on back
Submit to Appropriate District Office
State Lease - 4 Copies
Fee Lease - 3 Copies

OIL CONSERVATION DIVISION
P.O. Box 2088
Santa Fe, New Mexico 87504-2088

☐ AMENDED REPORT

WELL LOCATION AND ACREAGE DEDICATION PLAT

API Number		Pool Code		Pool Name Wildcat Precambrian	
Property Code		Property Name QUINIELA "AXQ" STATE			Well Number 1
OGRID No. 025575		Operator Name YATES PETROLEUM CORPORATION			Elevation 3774

Surface Location

UL or lot No.	Section	Township	Range	Lot Idn	Feet from the	North/South line	Feet from the	East/West line	County
C	5	10S	26E		660	NORTH	1980	WEST	CHAVES

Bottom Hole Location If Different From Surface

UL or lot No.	Section	Township	Range	Lot Idn	Feet from the	North/South line	Feet from the	East/West line	County
Dedicated Acres 320		Joint or Infill		Consolidation Code		Order No.			

NO ALLOWABLE WILL BE ASSIGNED TO THIS COMPLETION UNTIL ALL INTERESTS HAVE BEEN CONSOLIDATED
OR A NON-STANDARD UNIT HAS BEEN APPROVED BY THE DIVISION

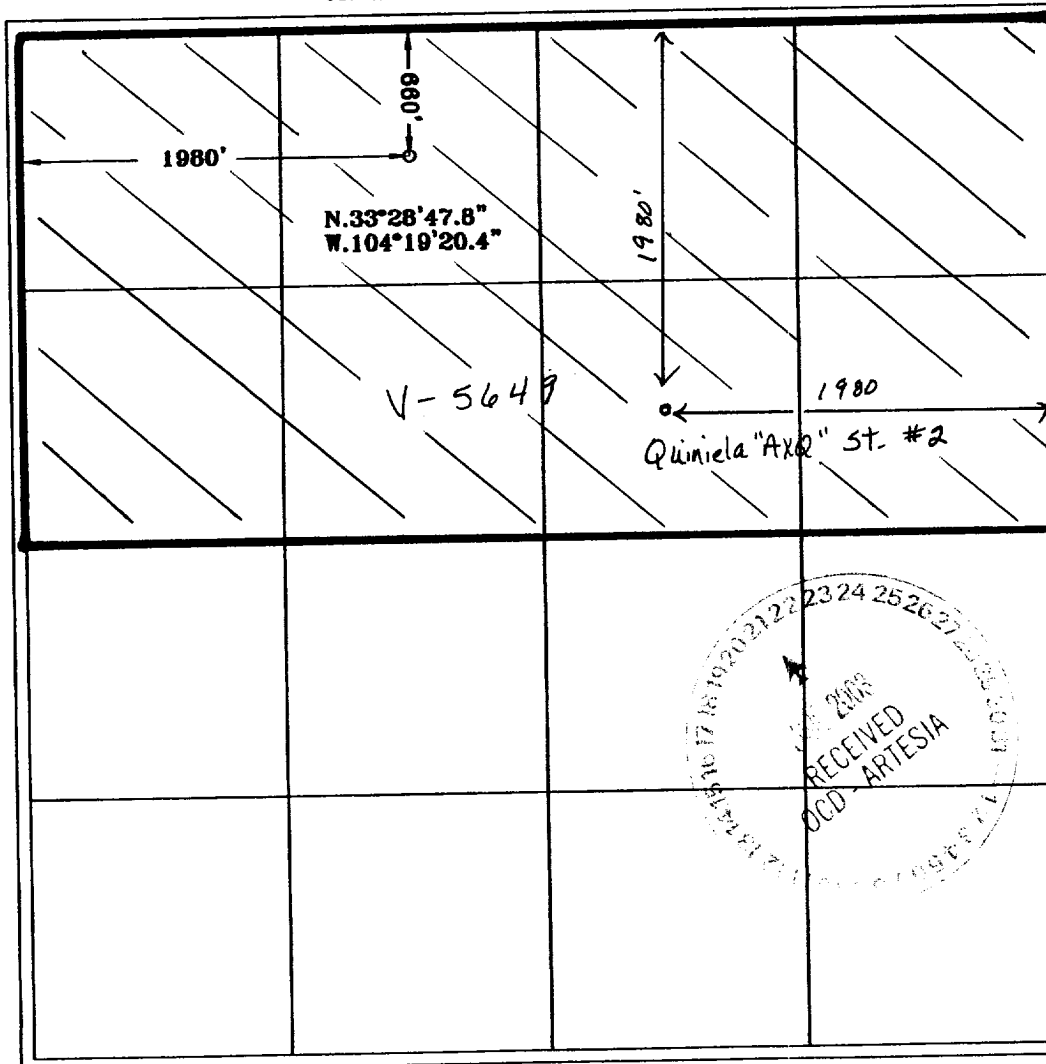

OPERATOR CERTIFICATION

I hereby certify that the information contained herein is true and complete to the best of my knowledge and belief.

Pat Perez
Signature

Pat Perez
Printed Name

Regulatory Agent
Title

1/20/2003
Date

SURVEYOR CERTIFICATION

I hereby certify that the well location shown on this plat was plotted from field notes of actual surveys made by me or under my supervision, and that the same is true and correct to the best of my belief.

1/16/2003

Date Surveyed

HERSCHEL L. JONES
Signature
Professional Surveyor

Certified by: *HERSCHEL L. JONES*
Professional Surveyor
GENERAL SURVEYING COMPANY