

SECTION 9, TOWNSHIP 9 SOUTH, RANGE 26 EAST, NMPM, CHAVES COUNTY, NEW MEXICO.

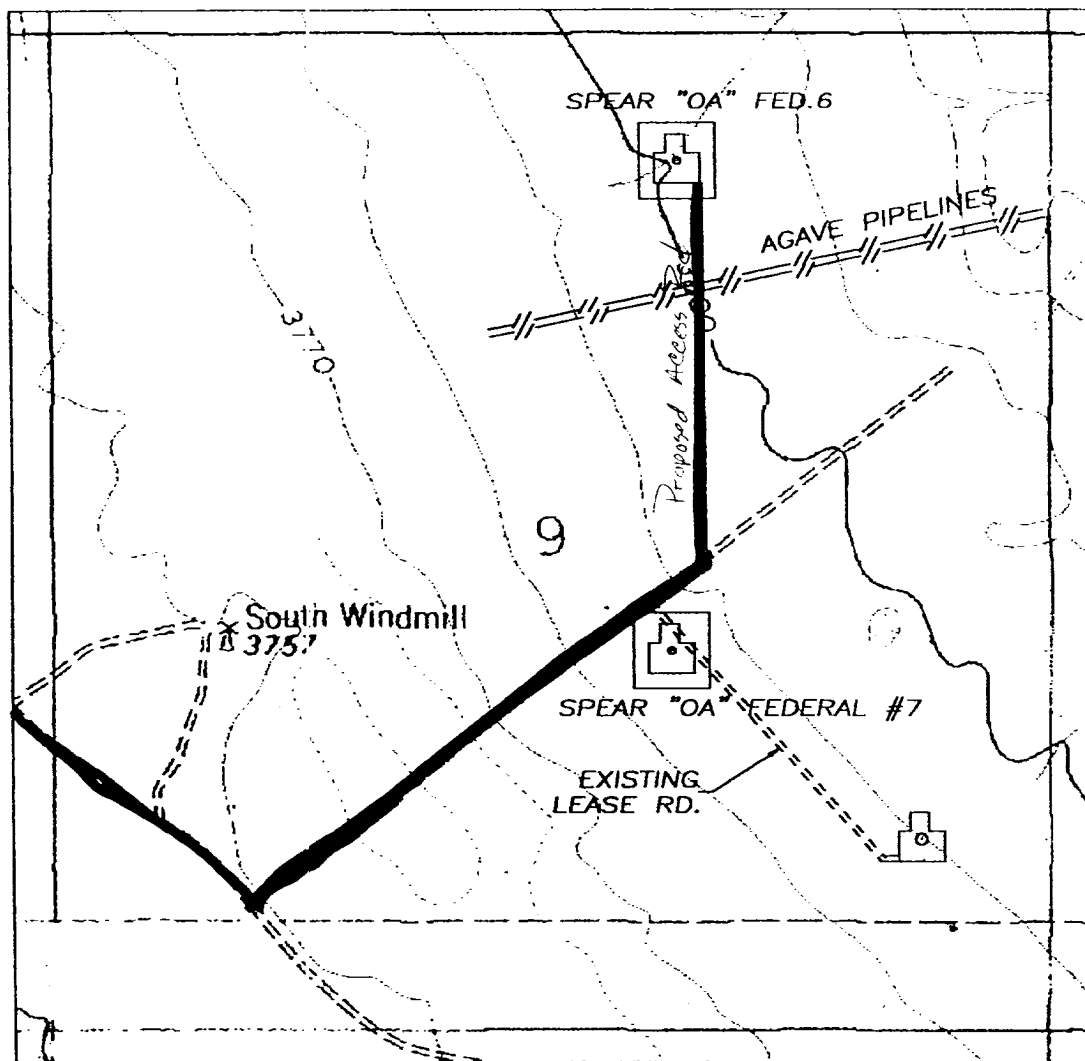

Yates Petroleum Corporation
Spear "OA" Federal #6
660' FNL and 1980' FEL
Sec. 9-T9S-R26E
Chaves County, New Mexico

Exhibit A-1

1000' 0 1000' 2000'
Scale 1" = 1000'

THE PREPARATION OF THIS PLAT AND THE PERFORMANCE OF THE SURVEY UPON WHICH IT IS BASED WERE DONE UNDER MY DIRECTION AND THE PLAT ACCURATELY DEPICTS THE RESULTS OF SAID SURVEY AND MEET THE REQUIREMENTS OF THE STANDARDS FOR LAND SURVEYS IN NEW MEXICO AS ADOPTED BY THE NEW MEXICO STATE BOARD OF REGISTRATION FOR PROFESSIONAL ENGINEERS AND LAND SURVEYORS.

3640
HERSCHEL L. JONES, R.L.S. No. 3640

GENERAL SURVEYING COMPANY P.O. BOX 1928
LOVINGTON, NEW MEXICO 88260

YATES PETROLEUM CORP.

LEASE ROAD TO ACCESS THE YATES SPEAR "OA" FEDERAL #6 & 7, LOCATED IN SECTION 9, TOWNSHIP 9 SOUTH, RANGE 26 EAST, NMPM, CHAVES COUNTY, NEW MEXICO.

Survey Date: 2/21/2001	Sheet 1 of 1 Sheets
Drawn By: Ed Blevins	W.O. Number
Date: 2/21/01	Scale 1" = 1000' SPEAR