

DISTRICT I
P.O. Box 1980, Hobbs, NM 88241-1980

Energy, Minerals and Natural Resources Department

DISTRICT II
P.O. Drawer DD, Artesia, NM 88211-0719

DISTRICT III
1000 Rio Brazos Rd., Artec, NM 87410

DISTRICT IV
P.O. BOX 2068, SANTA FE, N.M. 87504-2068

OIL CONSERVATION DIVISION

P.O. Box 2088
Santa Fe, New Mexico 87504-2088

Form C-102
Revised February 10, 1994
Submit to Appropriate District Office
State Lease - 4 Copies
Fee Lease - 3 Copies

WELL LOCATION AND ACREAGE DEDICATION PLAT

☐ AMENDED REPORT

API Number	Pool Code	Pool Name
Property Code	Property Name ROSE FEDERAL	Well Number 16
OGRID No.	Operator Name EXCO RESOURCES INC.	Elevation 3836'

Surface Location

UL or lot No. M	Section 20	Township 5-S	Range 25-E	Lot Idn	Feet from the 660	North/South line SOUTH	Feet from the 660	East/West line WEST	County CHAVES
--------------------	---------------	-----------------	---------------	---------	----------------------	---------------------------	----------------------	------------------------	------------------

Bottom Hole Location If Different From Surface

UL or lot No.	Section	Township	Range	Lot Idn	Feet from the	North/South line	Feet from the	East/West line	County
---------------	---------	----------	-------	---------	---------------	------------------	---------------	----------------	--------

Dedicated Acres	Joint or Infill	Consolidation Code	Order No.
-----------------	-----------------	--------------------	-----------

NO ALLOWABLE WILL BE ASSIGNED TO THIS COMPLETION UNTIL ALL INTERESTS HAVE BEEN CONSOLIDATED
OR A NON-STANDARD UNIT HAS BEEN APPROVED BY THE DIVISION

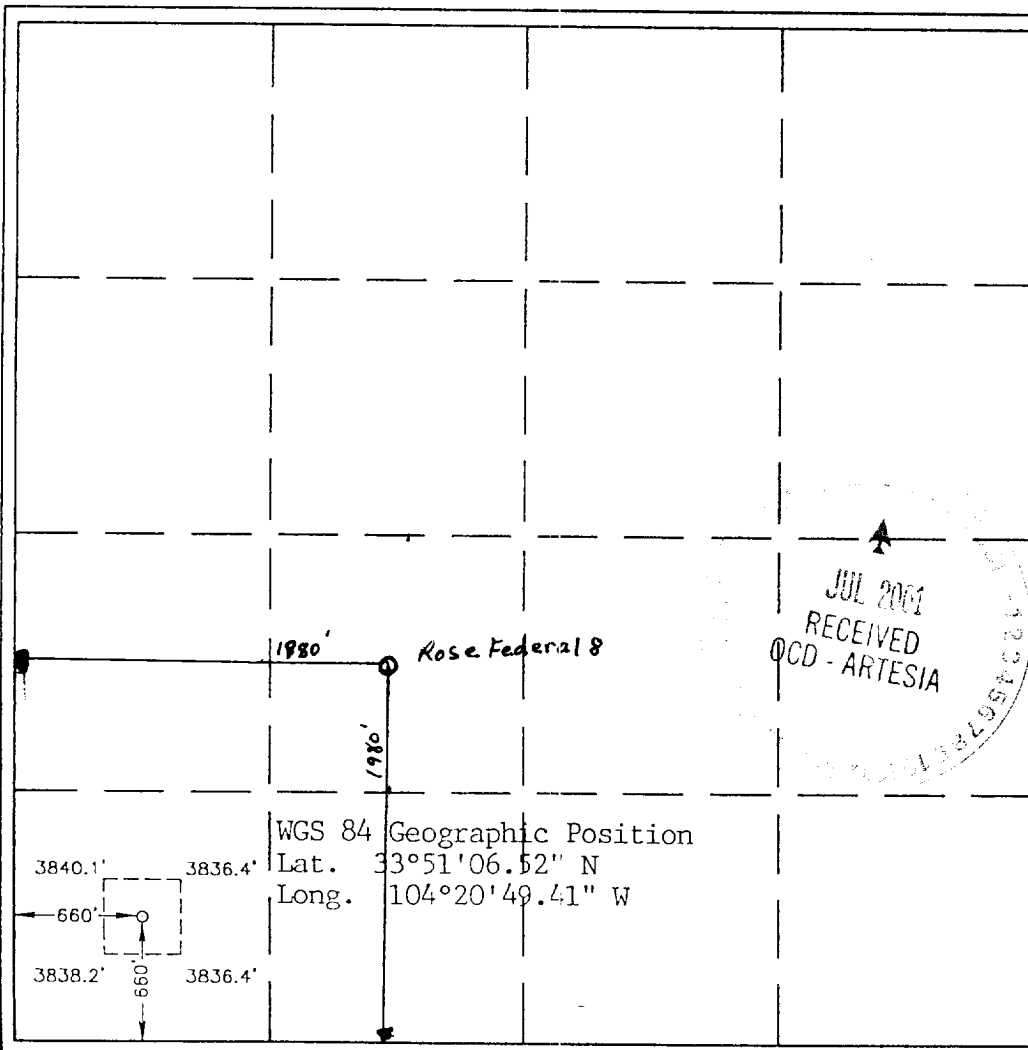

OPERATOR CERTIFICATION

I hereby certify the the information
contained herein is true and complete to the
best of my knowledge and belief.

[Signature]
Signature

F.L. Hilborn
Printed Name

Consulting Engineer
Title

June 28, 2001
Date

SURVEYOR CERTIFICATION

I hereby certify that the well location shown
on this plat was plotted from field notes of
actual surveys made by me or under my
supervision, and that the same is true and
correct to the best of my belief.

MAY 22, 2001

Date Surveyed
Signature & Seal of Professional Surveyor

[Signature] 5/24/01
01-1140649

Certificate No. RONALD J. EIDSON 3239
GARY EIDSON 12641